

NO. OF COPIES REQUIRED		
DISTRIBUTION		
SANTA FE		
FILE		
U.S.G.A.		
LAND OFFICE		
OPERATOR		

3A. Indicate Type of Lease
STATE <input type="checkbox"/> FEE <input checked="" type="checkbox"/>

3. State Oil & Gas Lease No.

APPLICATION FOR PERMIT TO DRILL, DEEPEN, OR PLUG BACK

4. Type of Work		7. Unit Agreement Name	
Type of Well OIL WELL <input checked="" type="checkbox"/> GAS WELL <input type="checkbox"/> OTHER <input type="checkbox"/>		8. Term or Lease Name	
Name of Operator Texaco Producing Inc.		M. B. Weir "B"	
Address of Operator P. O. Box 728, Hobbs, New Mexico 88240		9. Well No. 13	
Location of Well UNIT LETTER <u>O</u> LOCATED <u>740</u> FEET FROM THE <u>South</u> LINE <u>1850</u> FEET FROM THE <u>East</u> LINE OF SEC. <u>12</u> TWP. <u>20-S</u> SEC. <u>37-E</u>		10. Field and Pool, or Wildcat See Attached Page	
12. County Lea			
19. Proposed Depth 7200'		19A. Formation See Attached Pg.	
20. Rotary or C.T. Rotary			
21. Elevations (Show whether DT, RT, etc.) 3553 GR		21A. Kind & Status Plug. Bond Blanket	
21B. Drilling Contractor		22. Approx. Date Work will start October 13, 1987	

PROPOSED CASING AND CEMENT PROGRAM

SIZE OF HOLE	SIZE OF CASING	WEIGHT PER FOOT	SETTING DEPTH	SACKS OF CEMENT	EST. TOP
24"	20"	94#	40'	Redimix	Surface
15"	11-3/4"	42#	1450'	1000	Circulate
11"	8-5/8"	24# & 28#	4000'	1500	Circulate
7-7/8"	5-1/2"	15.5# & 17#	7200'	1200	Circulate

CEMENTING PROGRAM

SURFACE CASING: 1000 sacks Class "H" w/1/4# Flocele, 2% CaCl (15.6 ppg, 1.18 cu. ft./sx.).

INTERMEDIATE CASING: 1300 sacks Light Weight w/15# Salt, 1/4# Flocele (12.7 ppg, 2.1 cu. ft./sx.) followed by 200 sacks Class "H" w/1/4# Flocele, 2% CaCl (15.6 ppg, 1.18 cu. ft./sx.).

PRODUCTION CASING: 1st Stage: 200 sacks Light Weight w/5#/sx. Gilsonite (12.7 ppg, 1.84 cu. ft./sx., 9.9 Gal/sx), 300 sacks Class "H" w/1/4# Flocele plus .6% Halad-9 (15.6 ppg, 1.18 cu. ft./sx).
2nd Stage: 700 sacks Light Weight w/1/4# Flocele (12.4 ppg, 2.00 cu. ft./sx). DV Tool @ 5250'.

All other wells in this 1/4, 1/4 section are operated by Texaco Producing Inc.

ABOVE SPACE DESCRIBE PROPOSED PROGRAM IF PROPOSAL IS TO DEEPEN OR PLUG BACK, GIVE DATA ON PRESENT PRODUCTIVE ZONE AND PROPOSED NEW PRODUCTION ZONE. GIVE BLOWOUT PREVENTER PROGRAM, IF ANY.

I hereby certify that the information above is true and complete to the best of my knowledge and belief.

L. J. Seeman

and L. J. Seeman Title District Petroleum Engineer Date 10/12/87

(This space for State Use)

ORIGINAL SIGNED BY JERRY SEXTON

APPROVED BY DISTRICT 1 SUPERVISOR

TITLE

DATE

OCT 14 1987

CONDITIONS OF APPROVAL, IF ANY

Permit Expires 6 Months From Approval
Date Unless Drilling Underway.

HOBBES OFFICE

OCT 13 1987

RECEIVED

M. B. WEIR "B" WELL NO. 13
LEA COUNTY, NEW MEXICO

Continuation of Form C-101

10. Field & Pool

East Weir Blinebry
Skaggs Drinkard
Skaggs Glorieta
Monument Tubb

19A. Formation

Blinebry
Drinkard
Glorieta
Tubb

RECEIVED

OCT 13 1967

OCD

HOBBS OFFICE

All distances must be from the outer boundaries of the Section.

Operator Texaco Producing Inc.			Lease M. B. Weir "B"		Well No. 13
Unit Letter 0	Section 12	Township 20 South	Range 37 East	County Lea	
Actual Postage Location of Well: 740' feet from the South line and 1850' feet from the East line					
Ground Level Elev. 3553'	Producing Formation Blinebry/Drinkard/Glorieta		Pool ^{East} Weir Blinebry/ Skaggs Drinkard/Skaggs Glorieta		Dedicated Acreage: 40 Acres

1. Outline the acreage dedicated to the subject well by colored pencil or hatchure marks on the plat below.
2. If more than one lease is dedicated to the well, outline each and identify the ownership thereof (both as to working interest and royalty).
3. If more than one lease of different ownership is dedicated to the well, have the interests of all owners been consolidated by communitization, unitization, force-pooling, etc?

☐ Yes ☐ No If answer is "yes," type of consolidation _____

If answer is "no," list the owners and tract descriptions which have actually been consolidated. (Use reverse side of this form if necessary.) _____

No allowable will be assigned to the well until all interests have been consolidated (by communitization, unitization, forced-pooling, or otherwise) or until a non-standard unit, eliminating such interests, has been approved by the Division.

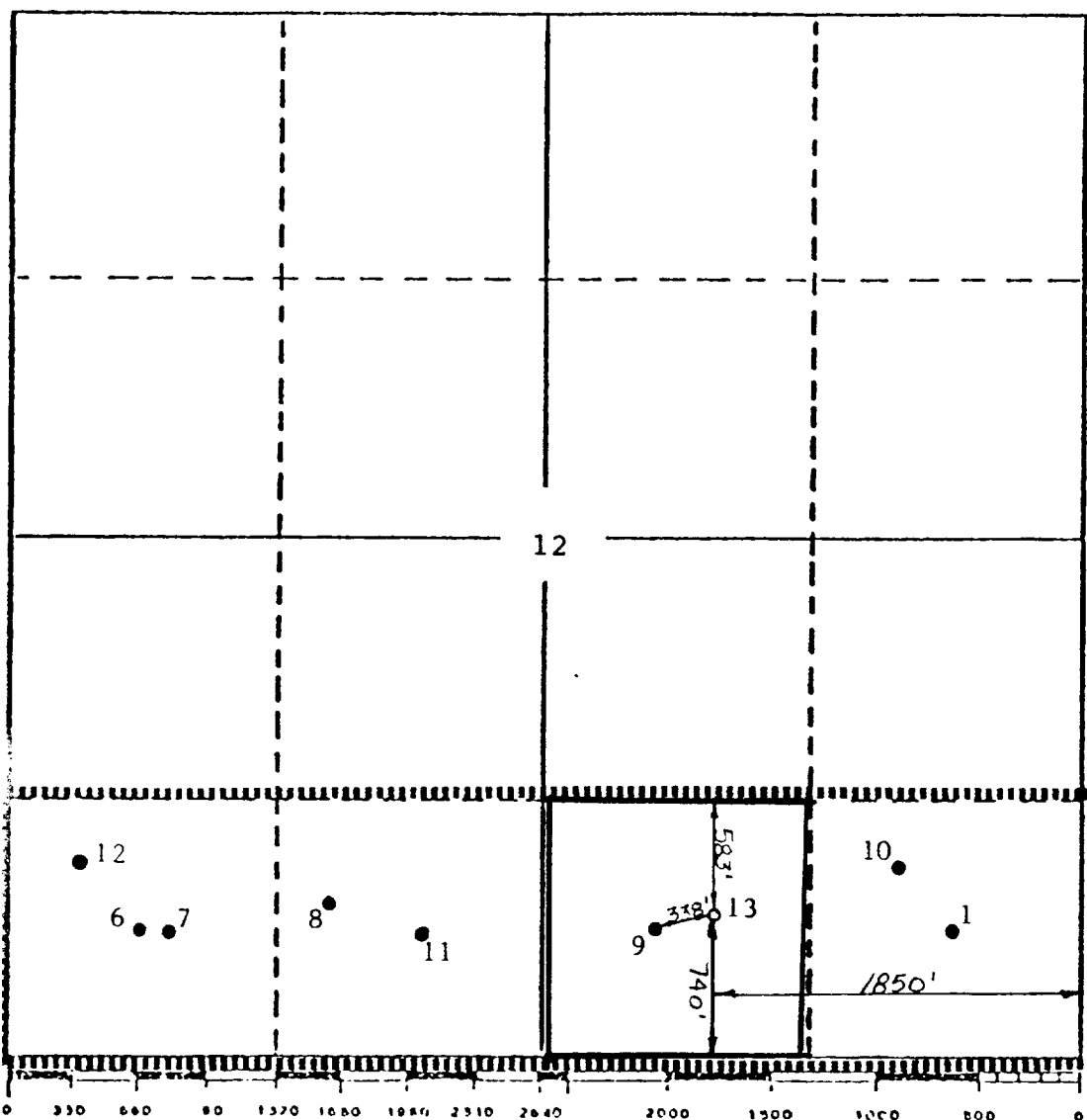

CERTIFICATION

I hereby certify that the information contained herein is true and complete to the best of my knowledge and belief.

B. L. Eiland

Name

B. L. Eiland

Position

Division Surveyor

Company

Texaco Producing Inc.

Date

October 12, 1987

I hereby certify that the well location shown on this plat was plotted from field notes of actual surveys made by me or under my supervision, and that the same is true and correct to the best of my knowledge and belief.

Date Surveyed **NEW**

October 9, 1987

Registered Professional Engineer and/or Land Surveyor

B. L. Eiland
B. L. Eiland

Certificate No.

4386

All distances must be from the outer boundaries of the Section.

Operator Texaco Producing Inc.			Lease M. B. Weir "B"		Well No. 13
Unit Letter 0	Section 12	Township 20 South	Range 37 East	County Lea	
Actual Postage Location of Well:					
740' feet from the		South line and		1850' feet from the East line	
Ground Level Elev. 3553'	Producing Formation Tubb		Pool Monument Tubb		Dedicated Acreage: 80 Acres

1. Outline the acreage dedicated to the subject well by colored pencil or hatchure marks on the plat below.
2. If more than one lease is dedicated to the well, outline each and identify the ownership thereof (both as to working interest and royalty).
3. If more than one lease of different ownership is dedicated to the well, have the interests of all owners been consolidated by communitization, unitization, force-pooling, etc?

☐ Yes ☐ No If answer is "yes," type of consolidation _____

If answer is "no," list the owners and tract descriptions which have actually been consolidated. (Use reverse side of this form if necessary.) _____

No allowable will be assigned to the well until all interests have been consolidated (by communitization, unitization, forced-pooling, or otherwise) or until a non-standard unit, eliminating such interests, has been approved by the Division.

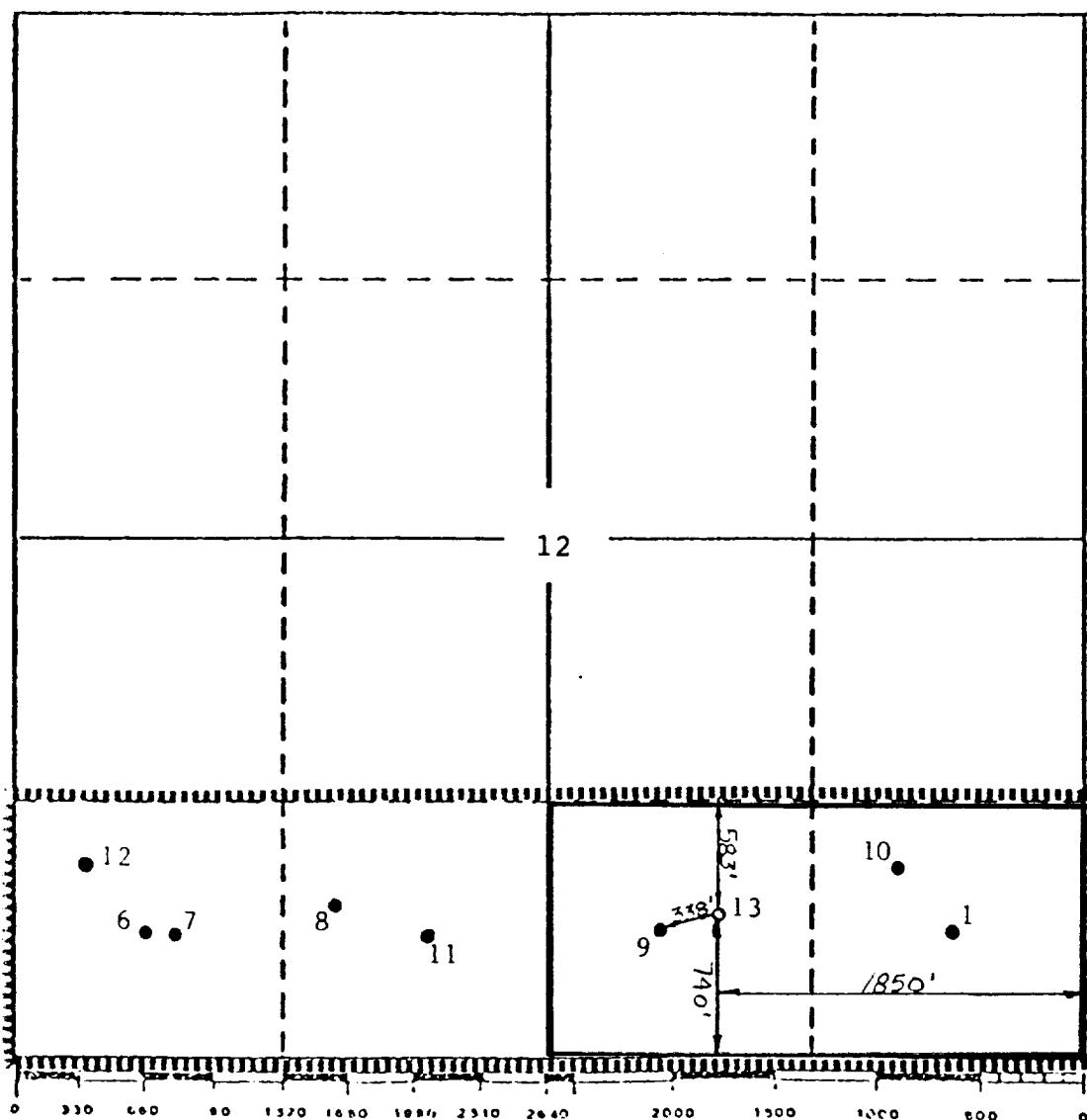

CERTIFICATION

I hereby certify that the information contained herein is true and complete to the best of my knowledge and belief.

B. L. Eiland

Name

B. L. Eiland

Position

Division Surveyor

Company

Texaco Producing Inc.

Date

October 12, 1987

I hereby certify that the well location shown on this plot was plotted from field notes of actual surveys made by me or under my supervision, and that the same is true and correct to the best of my knowledge and belief.

Date Reviewed NEW

October 19, 1987

Registered Professional Engineer
and/or Land Surveyor

B. L. Eiland
B. L. Eiland

Certificate No.

4386

RECEIVED

OCT 13 1961

CCO

HONORARY OFFICE

DRILLING CONTROL
CONDITION II-B 3000 WP
FOR AIR DRILLING OR
WHERE YATES AIR BLOWS ARE EXPECTED

H₂S TRIM REQUIRED
 YES _____ NO _____

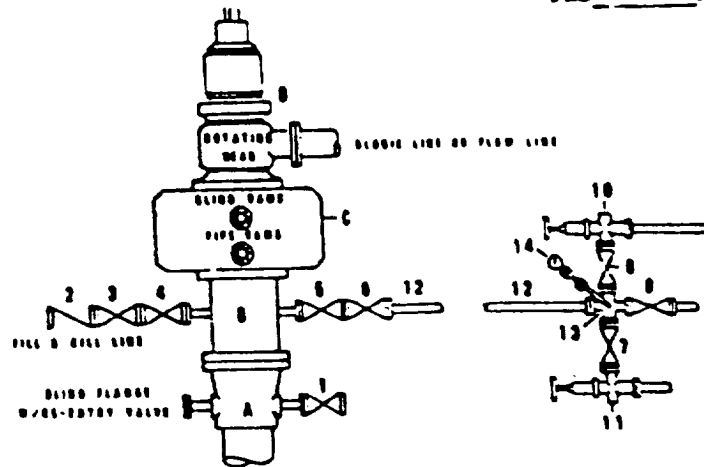

DRILLING CONTROL

MATERIAL LIST - CONDITION II - B
FOR AIR DRILLING

- A Texaco Wellhead
- B 3000# W.P. drilling spool with a 2" minimum flanged outlet for hill-line and 3" minimum flanged outlet for choke line
- C 3000# W.P. Dual ram type preventer, hydraulic operated with 1" steel, 3000# W.P. control lines (where sub-structure height is adequate, 2-3000# W.P. single ram type preventers may be utilized.)
- D Rotating Head and extended Blosie Line.
- 1,3,4, 2" minimum 3000# W.P. flanged full opening steel gate valve, or Halliburton Lo Torc Plug valve.
- 7,8
- 2 2" minimum 3000# W.P. back pressure valve
- 5,6,9 3" minimum 3000# W.P. flanged full opening steel gate valve, or Halliburton Lo Torc Plug valve.
- 12 3" minimum schedule 80, Grade "B", seamless line pipe
- 13 2" minimum x 3" minimum 3000# W.P. flanged cross
- 10, 11 2" minimum 3000# W.P. adjustable choke bodies
- 14 Cameron Mud Gauge or equivalent (location optional in choke line.)



TEXACO, INC.
 MIDLAND DIVISION
 MIDLAND, TEXAS



SCALE	DATE	EST NO	DWG NO
DRAWN BY			
CHECKED BY			
APPROVED BY			

EXHIBIT C

RECEIVED
OCT 13 1961
OCD
HOBBS OFFICE