

NO. OF COPIES RECEIVED	
DISTRIBUTION	
SANTA FE	
FILE	
U.S.G.S.	
LAND OFFICE	
OPERATOR	

3A. Indicate Type of Lease
STATE ☒ REC ☐
3. State Oil & Gas Lease No.
LG - 6555

APPLICATION FOR PERMIT TO DRILL, DEEPEN, OR PLUG BACK

1a. Type of Work b. Type of Well OIL WELL <input type="checkbox"/> GAS WELL <input checked="" type="checkbox"/> OTHER <input type="checkbox"/> 2. Name of Operator BTA OIL PRODUCERS 3. Address of Operator 104 South Pecos Midland, Texas 79701 4. Location of Well UNIT LETTER -C- LOCATED 660 FEET FROM THE North LINE AND 1830 FEET FROM THE West LINE OF SEC. 14 TWP. 22-S RGE. 34-E NMPW		7. Unit Agreement Name 8. Farm or Lease Name Chiso, 8711 JV-P 9. Well No. 1 10. Field and Pool, or Wildcat Ojo Chiso (Morrow) 12. County Lea	
19. Proposed Depth 13,500'		19A. Formation Morrow	
21. Elevations (Show whether DF, RT, etc.) 3,524' GR		21A. Kind & Status Plug. Band Blanket	
21B. Drilling Contractor Parker Drlg. Co.		22. Approx. Date Work will start 10-19-87	

PROPOSED CASING AND CEMENT PROGRAM

SIZE OF HOLE	SIZE OF CASING	WEIGHT PER FOOT	SETTING DEPTH	SACKS OF CEMENT	EST. TOP
20"	16"	65#	1,700	1200	Surface
14-3/4"	10-3/4"	45.5 & 51 #	5,000	3000	Surface
9-1/2"	7-5/8"	29.7 & 33.7	11,300	2500	3000'
6-1/2"	5" Liner	23.2#	10,900-13,500	300	

Attachment: BOP Stack Diagram

Unorthodox Location Approved - 11-5-87 Order No. NSL - 2437

IN ABOVE SPACE DESCRIBE PROPOSED PROGRAM; IF PROPOSAL IS TO DEEPEN OR PLUG BACK, GIVE DATA ON PRESENT PRODUCTIVE ZONE AND PROPOSED NEW PRODUCTIVE ZONE. GIVE BLOWOUT PREVENTER PROGRAM, IF ANY.

I hereby certify that the information above is true and complete to the best of my knowledge and belief.

Signed Kerethy V. Vought Title Regulatory Supervisor Date 10/12/87

(This space for State Use)

Orig. Signed by
Paul Kautz
Geologist

APPROVED BY _____ TITLE _____ DATE NOV 10 1987

CONDITIONS OF APPROVAL, IF ANY:

Permit Expires 6 Months From Approval
Date Unless Drilling Underway.

MEXICO OIL CONSERVATION COMMISSION
WELL LOCATION AND ACREAGE DEDICATION PLAT

Form C-102
Supersedes C-128
Effective 1-4-65

All distances must be from the outer boundaries of the Section.

Operator BTA OIL PRODUCERS			Lease 8711 JV-P CHISO		Well No. 1
Unit Letter "C"	Section 14	Township 22-S	Range 34-E	County LEA COUNTY, NEW MEXICO	
Actual Footage Location of Well:					
660 feet from the NORTH line and		1830 feet from the WEST line			
Ground Level Elev. 3524'	Producing Formation OJO CHISO	Pool MORROW		Dedicated Acreage: 320 Acres	

1. Outline the acreage dedicated to the subject well by colored pencil or hachure marks on the plat below.
2. If more than one lease is dedicated to the well, outline each and identify the ownership thereof (both as to working interest and royalty).
Farmout from Pogo -LG-6555 -1/8 State Royalty
Farmout from Pogo -V-698 - 1/6 State Royalty
3. If more than one lease of different ownership is dedicated to the well, have the interests of all owners been consolidated by communitization, unitization, force-pooling, etc?

☒ Yes ☐ No If answer is "yes," type of consolidation Communitization

If answer is "no," list the owners and tract descriptions which have actually been consolidated. (Use reverse side of this form if necessary.)

No allowable will be assigned to the well until all interests have been consolidated (by communitization, unitization, forced-pooling, or otherwise) or until a non-standard unit, eliminating such interests, has been approved by the Commission.

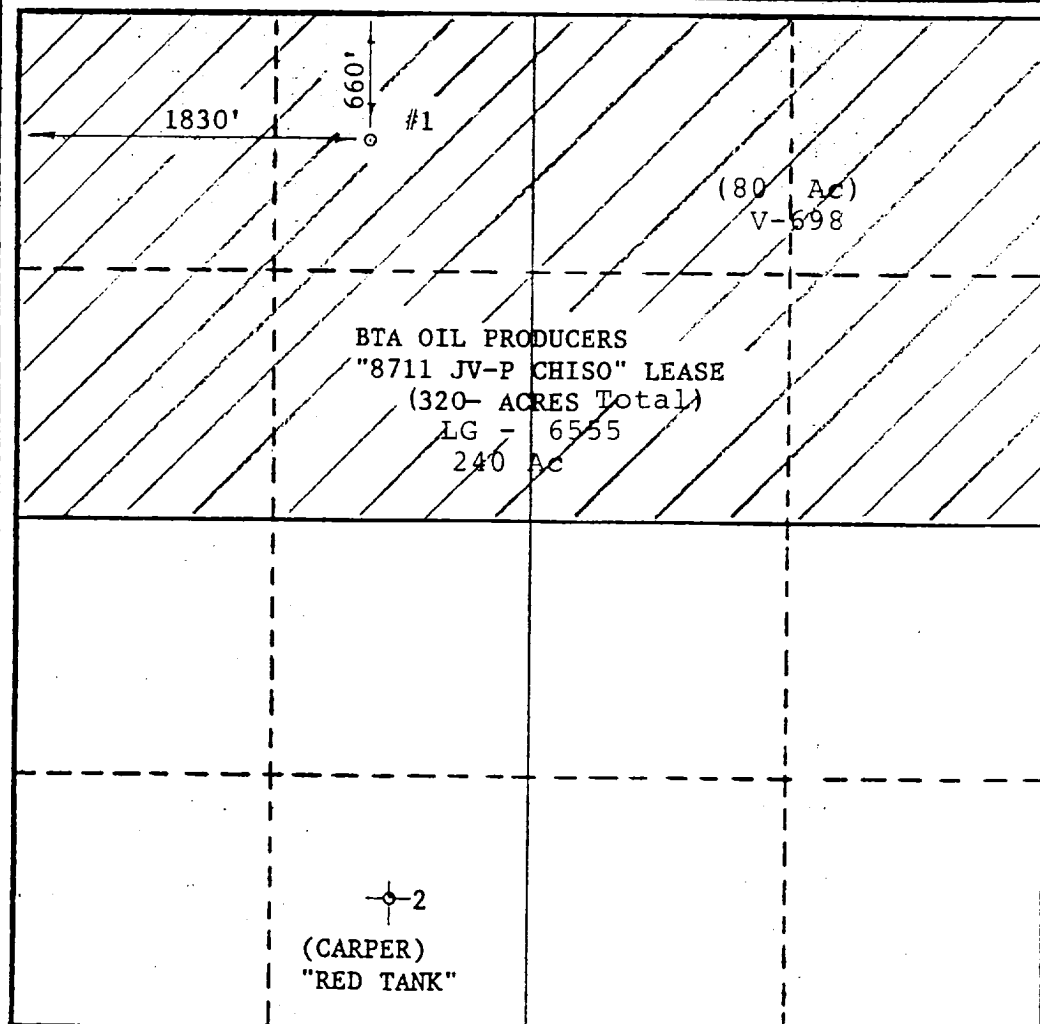

CERTIFICATION

I hereby certify that the information contained herein is true and complete to the best of my knowledge and belief.

Dorothy Houghton

Name

DOROTHY HOUGHTON

Position

Regulatory Supervisor

Company

BTA OIL PRODUCERS

Date

October 12, 1987

I hereby certify that the well location shown on this plat was plotted from field notes of actual surveys made by me or under my supervision, and that the same is true and correct to the best of my knowledge and belief.

Date Surveyed

OCTOBER 9, 1987

Registered Professional Engineer and/or Land Surveyor

Max A. Schumann Jr.

MAX A. SCHUMANN JR.

Certificate No.

1510

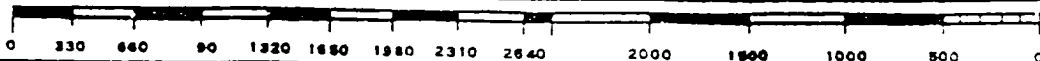

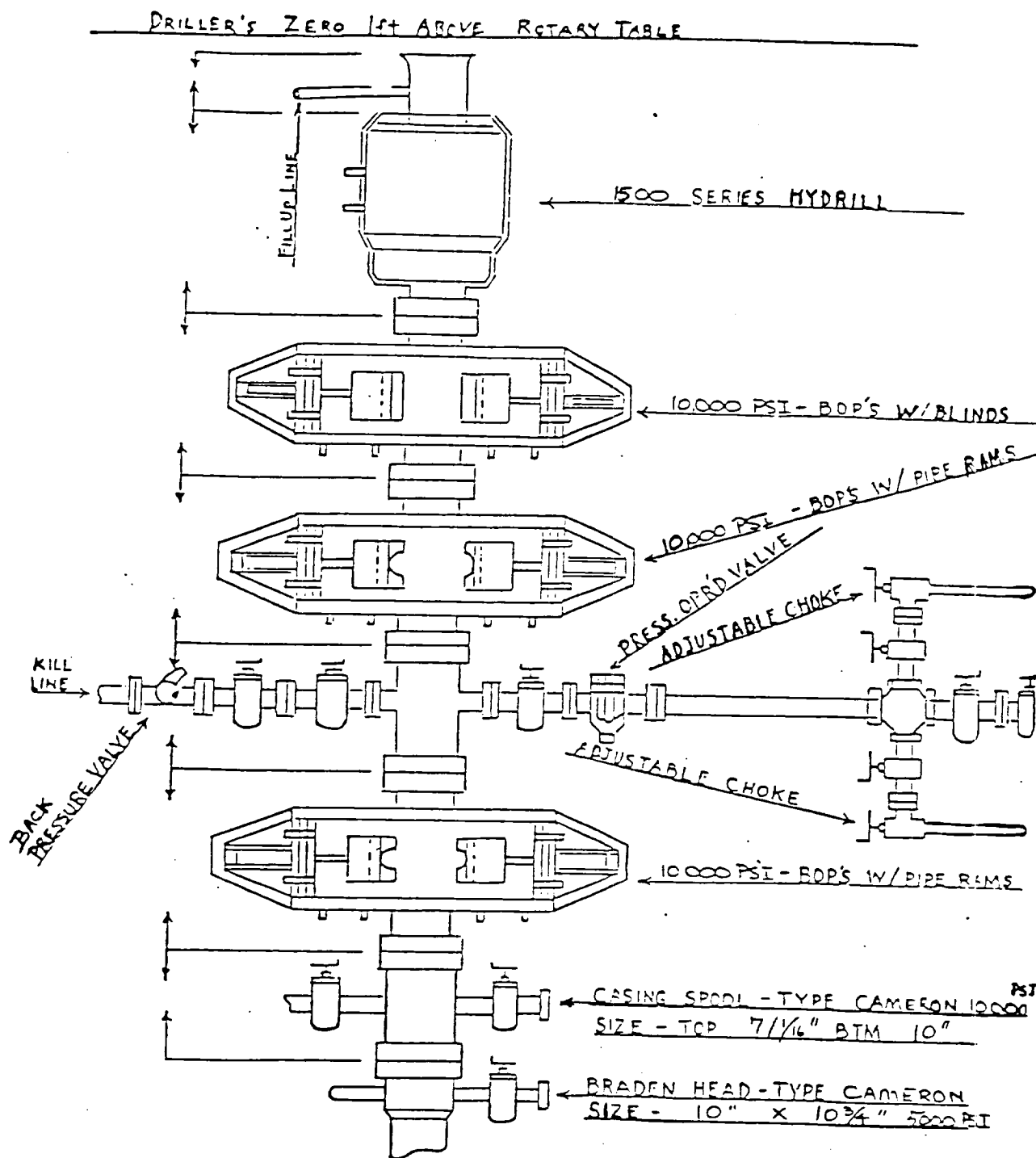

BOP Hook Up AFTER SETTING SURFACE (10 3/4") + INTERMEDIATE (7 5/8") STRINGS. ALL CONNECTIONS FROM THE SPOOL UP WILL BE TESTED TO 10,000

BTA OIL PRODUCERS
Chiso, 8711 JV-P
Well No. 1

715
113

RECEIVED
NOV 10 1987
GOD
GODAS 21/11/87