

STATE OF NEW MEXICO  
ENERGY AND MINERALS DEPARTMENT

OIL CONSERVATION DIVISION

P. O. BOX 2088

SANTA FE, NEW MEXICO 87501

30-025-30317

Form C-101  
Revised 10-1-78

NO. OF COPIES RECEIVED	
DISTRIBUTION	
SANTA FE	
FILE	
U.S.G.S.	
LAND OFFICE	
OPERATOR	

5A. Indicate Type of Lease  
STATE ☐ FEE ☒

5. State Oil & Gas Lease No.

APPLICATION FOR PERMIT TO DRILL, DEEPEN, OR PLUG BACK

1a. Type of Work  
b. Type of Well DRILL ☒ DEEPEN ☐ PLUG BACK ☐  
OIL WELL ☒ GAS WELL ☐ OTHER ☐ SINGLE ZONE ☒ MULTIPLE ZONE ☐

7. Unit Agreement Name

8. Farm or Lease Name  
C. H. Weir "B"

2. Name of Operator  
Texaco Producing Inc.

9. Well No.  
10

3. Address of Operator  
P. O. Box 728, Hobbs, New Mexico 88240

10. Field and Pool, or Wildcat  
\*See Below

4. Location of Well UNIT LETTER I LOCATED 1790 FEET FROM THE South LINE  
AND 410 FEET FROM THE East LINE OF SEC. 11 TWP. 20-S RGE. 37-E NMPM

12. County  
Lea

11. Elevations (show whether DT, KT, etc.) 3571 GR	21A. Kind & Status Plug. Bond Blanket	19. Proposed Depth 7200'	19A. Formation ** See Below	20. Rotary or C.T. Rotary
21B. Drilling Contractor		22. Approx. Date Work will start April 1, 1988		

23. PROPOSED CASING AND CEMENT PROGRAM

SIZE OF HOLE	SIZE OF CASING	WEIGHT PER FOOT	SETTING DEPTH	SACKS OF CEMENT	EST. TOP
20"	16"	65#	40'	Redimix	Surface
14-3/4"	11-3/4"	42#	1450'	1100	Surface
11"	8-5/8"	32#	4000'	1400	Surface
7-7/8"	5-1/2"	15.5# & 17#	7200'	1700	Surface

\*East Weir Blinebry, Monument Tubb, Skaggs Drinkard  
\*\* Blinebry, Tubb, Drinkard

CEMENTING PROGRAM

SURFACE CASING: 1100 sacks Class "H" w/2% CaCl & 1/4# Flocele (15.6 ppg, 1.18 cu. ft./sx., 5.2 gallon water/sack).  
INTERMEDIATE CASING: 1200 sacks Light Weight w/15# Salt/sack., 1/4# Flocele (12.7 ppg, 2.10 cu. ft./sx., 11.0 gallons water/sack) followed by 200 sacks Class "H" w/2% CaCl & 1/4# Flocele (15.6 ppg, 2.10 cu. ft./sack, 5.2 gallons water/sack).  
PRODUCTION CASING: 1st Stage: 900 sacks Class "H", .4% Halad-9, 2.2# Salt, 1/4# Flocele (15.7 ppg, 1.19 cu. ft./sx., 5.2 gallons water/sack).

Continued on Page 2

IN ABOVE SPACE DESCRIBE PROPOSED PROGRAM; IF PROPOSAL IS TO DEEPEN OR PLUG BACK, GIVE DATA ON PRESENT PRODUCTIVE ZONE AND PROPOSED NEW PRODUCTIVE ZONE. GIVE BLOWOUT PREVENTER PROGRAM, IF ANY.

I hereby certify that the information above is true and complete to the best of my knowledge and belief.

Signed W. B. Cade Title District Operations Manager Date 3/11/88

(This space for Signatures)  
ORIGINAL SIGNED BY JERRY SEXTON  
DISTRICT 1 SUPERVISOR

APPROVED BY \_\_\_\_\_ TITLE \_\_\_\_\_ DATE \_\_\_\_\_

CONDITIONS OF APPROVAL, IF ANY:

MAR 17 1988

Permit Expires 6 Months From Approval  
Date Unless Drilling Underway.

C. H. WEIR "B" WELL NO. 10  
EAST WEIR BLINEBRY, MONUMENT TUBB, SKAGGS DRINKARD  
LEA COUNTY, NEW MEXICO

Continuation to Form C-101

CEMENTING PROGRAM

PRODUCTION CASING:

2ND STAGE: 800 sacks Class "H" Light Weight & 1/4# Flocele  
(12.7 ppg, 1.84 cu. ft./sack, 9.9 gallons  
water/sack).

Texaco operates all other wells in this 1/4, 1/4 section.

RECEIVED  
MAR 1 6 1988  
OCD  
HOBBS OFFICE

All distances must be from the outer boundaries of the Section.

Operator <b>Texaco Producing Inc.</b>			Lease <b>C. H. Weir "B"</b>		Well No. <b>10</b>
Unit Letter <b>I</b>	Section <b>11</b>	Township <b>20 South</b>	Range <b>37 East</b>	County <b>Lea</b>	
Actual Footage Location of Well: <b>1790</b> feet from the <b>South</b> line and <b>410</b> feet from the <b>East</b> line					
Ground Level Elev. <b>3571'</b>	Producing Formation <b>Blinebry, Drinkard</b>		Pool <b>East Weir Blinebry, Skaggs Drinkard</b>		Dedicated Acreage: <b>40</b> Acres

1. Outline the acreage dedicated to the subject well by colored pencil or hatchure marks on the plat below.
2. If more than one lease is dedicated to the well, outline each and identify the ownership thereof (both as to working interest and royalty).
3. If more than one lease of different ownership is dedicated to the well, have the interests of all owners been consolidated by communitization, unitization, force-pooling, etc?

☐ Yes ☐ No If answer is "yes," type of consolidation \_\_\_\_\_

If answer is "no," list the owners and tract descriptions which have actually been consolidated. (Use reverse side of this form if necessary.) \_\_\_\_\_

No allowable will be assigned to the well until all interests have been consolidated (by communitization, unitization, forced-pooling, or otherwise) or until a non-standard unit, eliminating such interests, has been approved by the Division.

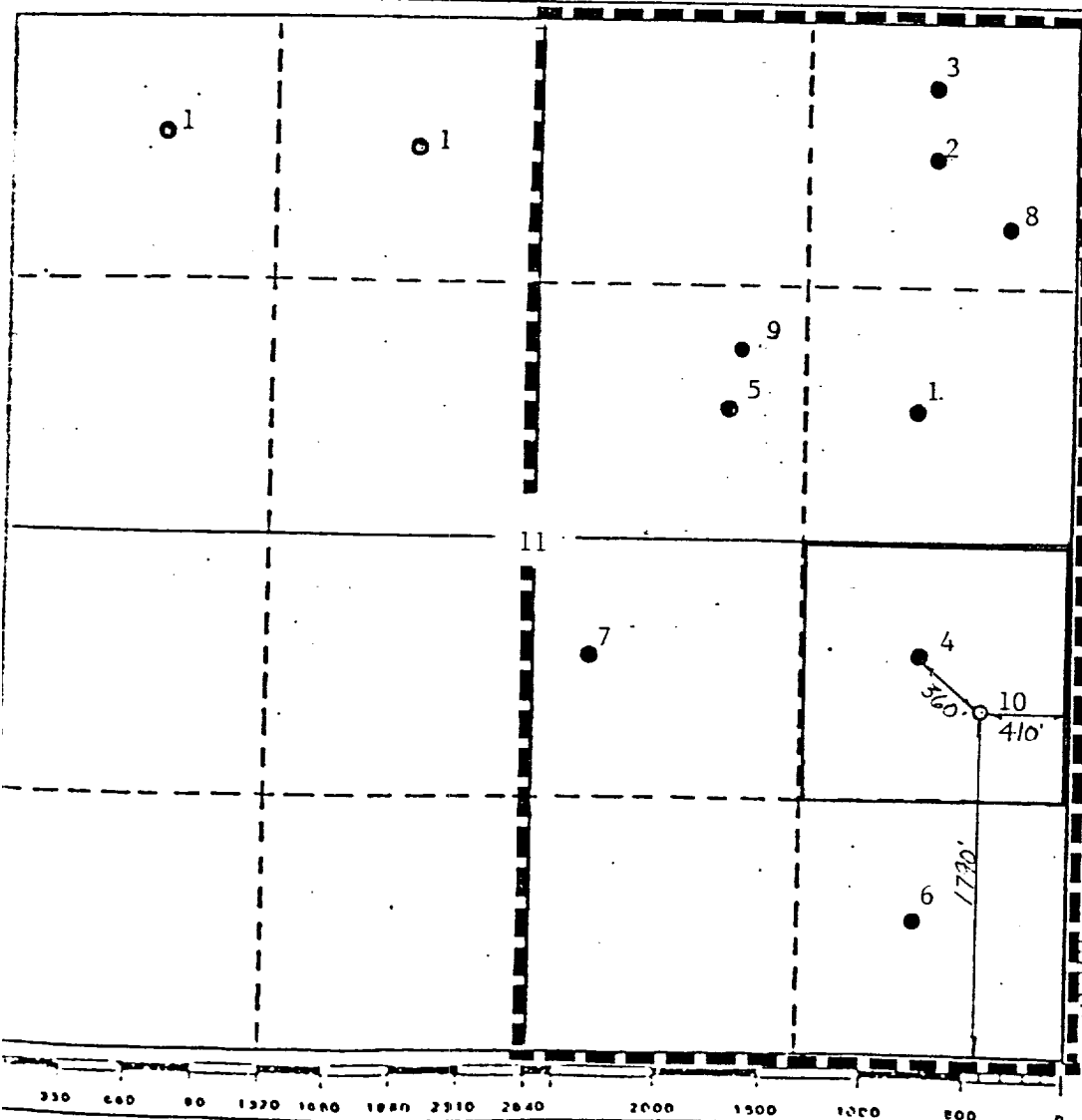

<b>CERTIFICATION</b>	
I hereby certify that the information contained herein is true and complete to the best of my knowledge and belief.	
<i>B. L. Eiland</i>	
Name	<b>B.L. Eiland</b>
Position	<b>Division Surveyor</b>
Company	<b>Texaco Producing Inc.</b>
Date	<b>February 11, 1988</b>
I hereby certify that the well location shown on this plat was plotted from field notes of actual surveys made by me or under my supervision, and that the same is true and correct to the best of my knowledge and belief.	
Date Surveyed	<b>February 10, 1988</b>
Registered Professional Engineer and/or Land Surveyor	
<i>B. L. Eiland</i>	
<b>B.L. Eiland</b>	
Certificate No. <b>4386</b>	

All distances must be from the outer boundaries of the Section.

Operator <b>Texaco Producing Inc.</b>			Lease <b>C. H. Weir "B"</b>			Well No. <b>10</b>		
Unit Letter <b>I</b>	Section <b>11</b>	Township <b>20 South</b>	Range <b>37 East</b>	County <b>Lea</b>				
Actual Postage Location of Well: <b>1790</b> feet from the <b>South</b> line and <b>410</b> feet from the <b>East</b> line								
Ground Level Elev. <b>3571'</b>		Producing Formation <b>Tubb</b>		Pool <b>Monument Tubb</b>			Dedicated Acreage: <b>80</b> Acres	

1. Outline the acreage dedicated to the subject well by colored pencil or hatchure marks on the plat below.
2. If more than one lease is dedicated to the well, outline each and identify the ownership thereof (both as to working interest and royalty).
3. If more than one lease of different ownership is dedicated to the well, have the interests of all owners been consolidated by communitization, unitization, force-pooling, etc?

☐ Yes ☐ No If answer is "yes," type of consolidation \_\_\_\_\_

If answer is "no," list the owners and tract descriptions which have actually been consolidated. (Use reverse side of this form if necessary.) \_\_\_\_\_

No allowable will be assigned to the well until all interests have been consolidated (by communitization, unitization, forced-pooling, or otherwise) or until a non-standard unit, eliminating such interests, has been approved by the Division.

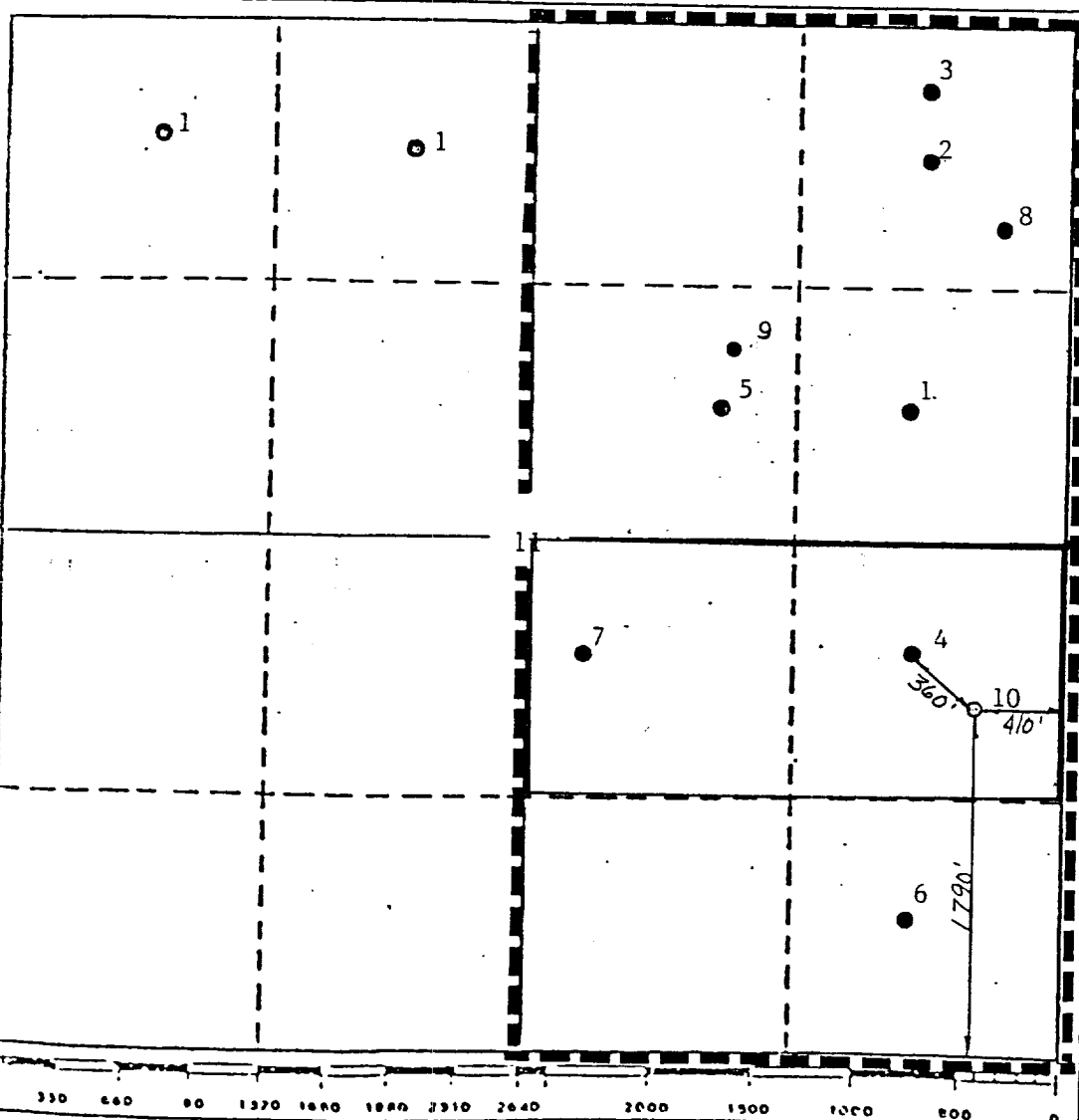

### CERTIFICATION

I hereby certify that the information contained herein is true and complete to the best of my knowledge and belief.

*B. L. Eiland*

Name

**B. L. Eiland**

Position

**Division Surveyor**

Company

**Texaco Prod. Inc.**

Date

**February 11, 1988**

I hereby certify that the well location shown on this plat was plotted from field notes of actual surveys made by me or under my supervision, and that the same is true and correct to the best of my knowledge and belief.

Date Surveyed

**February 10, 1988**

Registered Professional Engineer and/or Land Surveyor

*B. L. Eiland*  
**B. L. Eiland**

Certificate No. **4386**

**DRILLING CONTROL**  
**CONDITION II-B 3000 WP**  
**FOR AIR DRILLING OR**  
**WHERE YATES AIR BLOWS ARE EXPECTED**

H<sub>2</sub>S TRIM REQUIRED  
 YES \_\_\_\_\_ NO \_\_\_\_\_

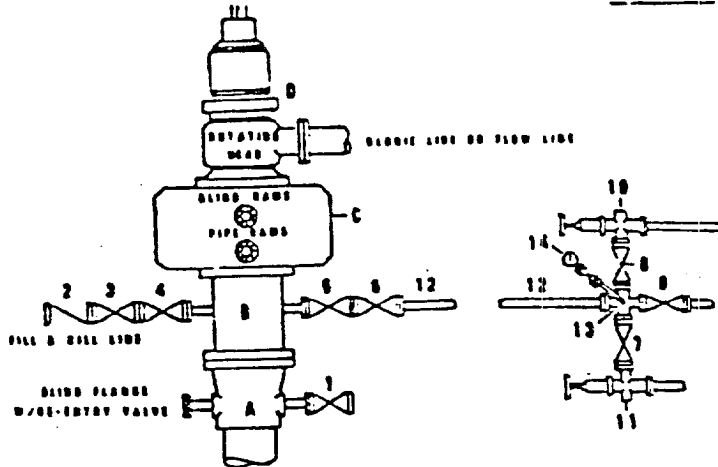

DRILLING CONTROL

MATERIAL LIST - CONDITION II - B  
FOR AIR DRILLING

- A      Texaco Wellhead
- B      3000# W.P. drilling spool with a 2" minimum flanged outlet for kill-line and 3" minimum flanged outlet for choke line
- C      3000# W.P. Dual ram type preventer, hydraulic operated with 1" steel, 3000# W.P. control lines (where sub-structure height is adequate, 2-3000# W.P. single ram type preventers may be utilized.)
- D      Rotating Head and extended Elastic Line.
- 1,3,4, 7,8      2" minimum 3000# W.P. flanged full opening steel gate valve, or Halliburton Lo Torc Plug valve.
- 2      2" minimum 3000# W.P. back pressure valve
- 5,6,9      3" minimum 3000# W.P. flanged full opening steel gate valve, or Halliburton Lo Torc Plug valve.
- 12      3" minimum schedule 80, Grade "B", seamless line pipe
- 13      2" minimum x 3" minimum 3000# W.P. flanged cross
- 10, 11      2" minimum 3000# W.P. adjustable choke bodies
- 14      Cameron Mud Gauge or equivalent (location optional in choke line.)



**TEXACO, INC.**  
 MIDLAND DIVISION  
 MIDLAND, TEXAS



SCALE	DATE	EST. NO.	DWG. NO.
DRAWN BY			
CHECKED BY			
APPROVED BY			

**EXHIBIT C**

RECEIVED  
MAR 16 1988  
OCD  
HOBBS OFFICE

88/919 8224  
473