

30-025-30418

| | |
|------------------------|--|
| NO. OF COPIES RECEIVED | |
| DISTRIBUTION | |
| SANTA FE | |
| FILE | |
| U.S.G.S. | |
| LAND OFFICE | |
| OPERATOR | |

NEW MEXICO OIL CONSERVATION COMMISSION

Form C-101
Revised 1-4-65

| | |
|--------------------------------|---|
| 5A. Indicate Type of Lease | |
| STATE <input type="checkbox"/> | FEE <input checked="" type="checkbox"/> |
| 5. State Oil & Gas Lease No. | |

APPLICATION FOR PERMIT TO DRILL, DEEPEN, OR PLUG BACK

| | | | | | |
|--|--|--|--|--|--|
| 1a. Type of Work | | | 7. Unit Agreement Name | | |
| b. Type of Well DRILL <input checked="" type="checkbox"/> DEEPEN <input type="checkbox"/> PLUG BACK <input type="checkbox"/> OIL WELL <input checked="" type="checkbox"/> GAS WELL <input type="checkbox"/> OTHER <input type="checkbox"/> SINGLE ZONE <input type="checkbox"/> MULTIPLE ZONE <input type="checkbox"/> | | | Central Drinkard Unit | | |
| 2. Name of Operator Chevron U.S.A. Inc. | | | 8. Farm or Lease Name | | |
| 3. Address of Operator P.O. Box 670 Hobbs, N.M. | | | 9. Well No. 433 | | |
| 4. Location of Well UNIT LETTER <u>L</u> LOCATED <u>1600</u> FEET FROM THE <u>South</u> LINE AND <u>1100</u> FEET FROM THE <u>West</u> LINE OF SEC. <u>29</u> TWP. <u>21S</u> RGE. <u>37E</u> NMPM | | | 10. Field and Pool, or Wildcat Drinkard | | |
| | | | 12. County Lea | | |
| | | | | | |
| 19. Proposed Depth 6800 | | 19A. Formation Drinkard | | 20. Rotary or C.T. rotary | |
| 21. Elevations (Show whether DF, RT, etc.) 3471 | | 21A. Kind & Status Plug. Bond blanket | | 21B. Drilling Contractor NYK | |
| | | | | 22. Approx. Date Work will start ASAP | |

PROPOSED CASING AND CEMENT PROGRAM

| SIZE OF HOLE | SIZE OF CASING | WEIGHT PER FOOT | SETTING DEPTH | SACKS OF CEMENT | EST. TOP |
|--------------|----------------|-----------------|---------------|-----------------|----------|
| 14 3/4" | 11 3/4" | 42# | 500' | 500sx | circ. |
| 11 " | 8 5/8" | 32# | 2800' | 1500sx | circ. |
| 7 7/8" | 5 1/2" | 15.5# | 6820' | 1200sx | circ. |

Mud Program:

0 - 500 FW Spud
 500 - 2800' BW, 10ppg.
 2800 - 6800' Cut BW/Starch 8.9-9.3

See Attached BOP Drawing.

IN ABOVE SPACE DESCRIBE PROPOSED PROGRAM; IF PROPOSAL IS TO DEEPEN OR PLUG BACK, GIVE DATA ON PRESENT PRODUCTIVE ZONE AND PROPOSED NEW PRODUCTIVE ZONE. GIVE BLOWOUT PREVENTER PROGRAM, IF ANY.

I hereby certify that the information above is true and complete to the best of my knowledge and belief.

Signed L. K. Elmore Title Drilling Tech. Asst. Date July 5, 1988

(This space for State Use)

APPROVED BY _____ TITLE _____ DATE JUL 28 88

CONDITIONS OF APPROVAL, IF ANY:

Permit Expires 6 Months From Approval
 Date Unless Drilling Underway.

NAF-2537

REC'D

JUL 6 1988

OCD
HOBBS OFFICE

NEW MEXICO OIL CONSERVATION COMMISSION
WELL LOCATION AND ACREAGE DEDICATION PLAT

Form C-102
Supersedes C-128
Effective 1-1-65

All distances must be from the outer boundaries of the Section

| | | | | |
|--|---------------------------------|--------------------------------|--------------------------------|-----------------|
| Operator Chevron U.S.A., Inc. | | Lease Central Drinkard Unit | | Well No. 433 |
| Section Letter L | Section 29 | Township 21 South | Range 37 East | County Lea |
| Actual Plot Date Location of Well: 1600 feet from the south line and 1100 feet from the west line | | | | |
| Ground Level Elev. 3471.0 | Producing Formation Drinkard | Pool Drinkard | Dedicated Acreage: 40 Acres | |

1. Outline the acreage dedicated to the subject well by colored pencil or hatchure marks on the plat below.
2. If more than one lease is dedicated to the well, outline each and identify the ownership thereof (both as to working interest and royalty).
3. If more than one lease of different ownership is dedicated to the well, have the interests of all owners been consolidated by communitization, unitization, force-pooling, etc?

☐ Yes ☐ No If answer is "yes," type of consolidation _____

If answer is "no," list the owners and tract descriptions which have actually been consolidated. (Use reverse side of this form if necessary.) _____

No allowable will be assigned to the well until all interests have been consolidated (by communitization, unitization, forced-pooling, or otherwise) or until a non-standard unit, eliminating such interests, has been approved by the Commission.

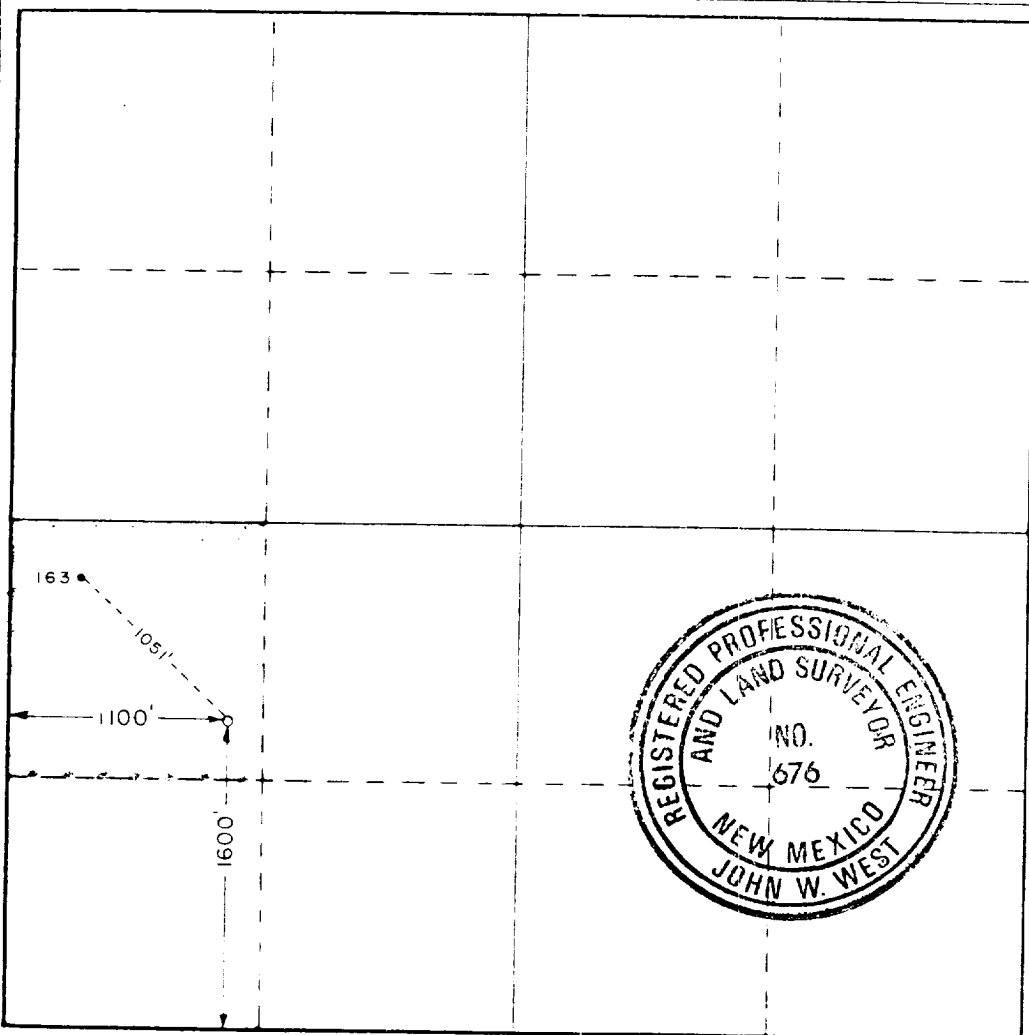

CERTIFICATION

I hereby certify that the information contained herein is true and complete to the best of my knowledge and belief.

L.K. Elmore
Date

L.K. ELMORE

Position

DRLG. TA

Company

CHEVRON U.S.A. INC.

Date

JULY 5, 1988

I hereby certify that the well location shown on this plat was plotted from field notes of actual surveys made by me or under my supervision, and that the same is true and correct to the best of my knowledge and belief.

Date Surveyed

June 30, 1988

Registered Professional Engineer and Land Surveyor

John W. West

Certificate No. JOHN W. WEST,

676

RONALD J. EIDSON,

3239

HOBBS DIVISION CLASS III PREVENTER

MANUAL OR HYDRAULICALLY OPERATED
FLOW LINE VALVE

FIGURE III-4
THREE PREVENTER HOOKUP
CLASS III

* Spacesaver preventers
are acceptable

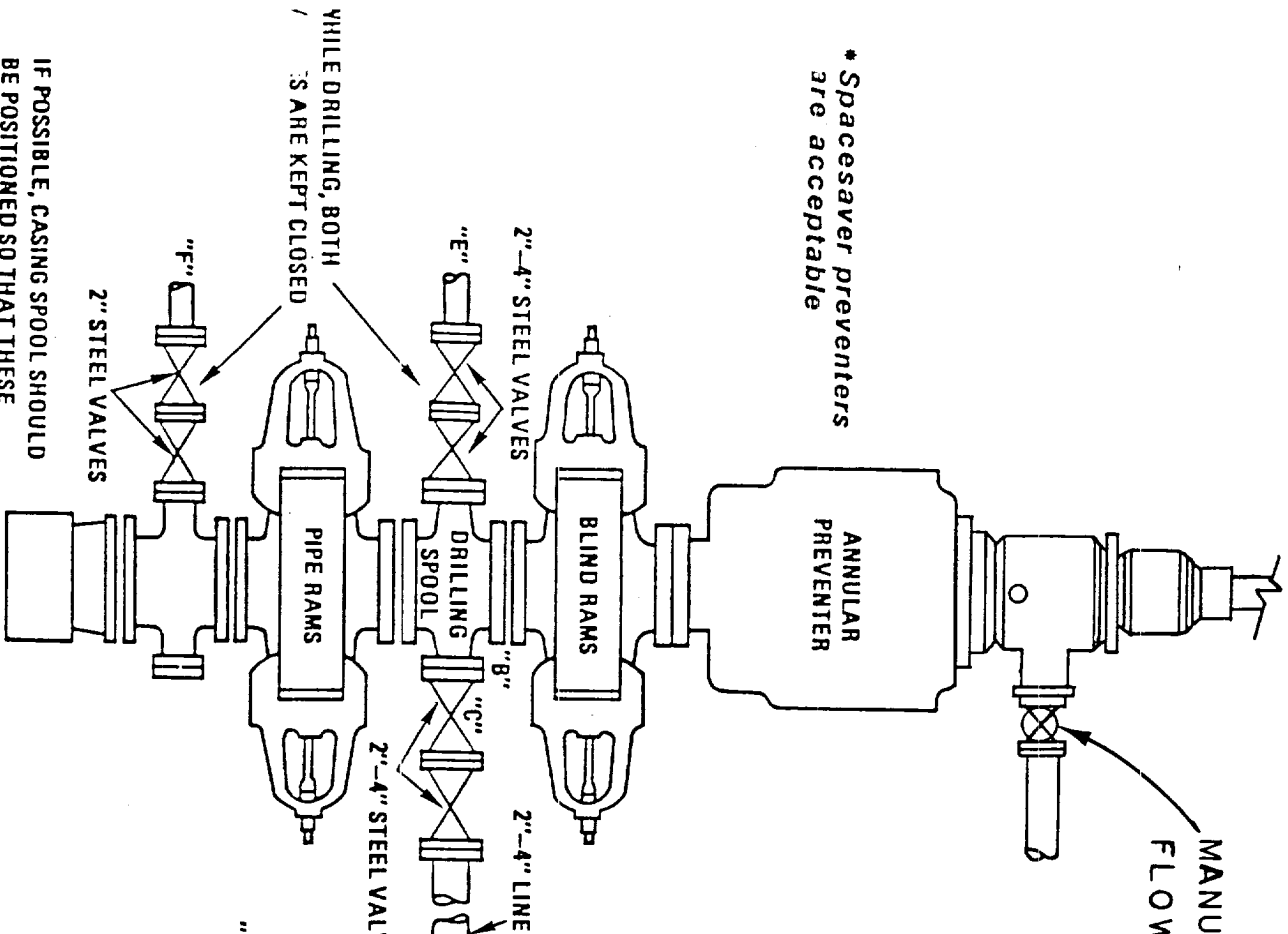

CHOKE MANIFOLD

ALTERNATE CHOKE MANIFOLD

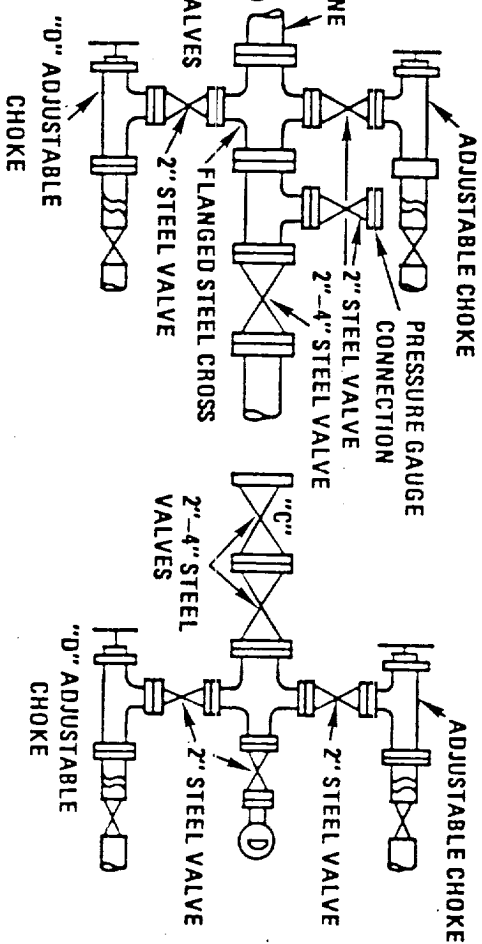

GENERAL INSTRUCTIONS ON PAGE FOLLOWING FIGURE III-7

ELF
2/12/03
ABOVE DATE DOES NOT
INDICATE WHEN
CONFIDENTIAL LOGS
WILL BE RELEASED