

UNITED STATES  
DEPARTMENT OF THE INTERIOR  
GEOLOGICAL SURVEY

## APPLICATION FOR PERMIT TO DRILL, DEEPEN, OR PLUG BACK

1a. TYPE OF WORK <b>DRILL</b> <input checked="" type="checkbox"/> <b>DEEPEN</b> <input type="checkbox"/> <b>PLUG BACK</b> <input checked="" type="checkbox"/>			5. FIELD DEVELOPMENT AND SERIAL NO. NEW-43564		
b. TYPE OF WELL OIL WELL <input type="checkbox"/> GAS WELL <input checked="" type="checkbox"/> OTHER Amended SINGLE ZONE <input type="checkbox"/> MULTIPLE ZONE <input type="checkbox"/>			6. IF INDIAN, ALLOTTEE OR TRIBE NAME		
2. NAME OF OPERATOR Oryx Energy Company			7. UNIT AGREEMENT NAME		
3. ADDRESS OF OPERATOR P. o. Box 1861, Midland, Texas 79702			8. FARM OR LEASE NAME Ojo Chiso Federal		
4. LOCATION OF WELL (Report location clearly and in accordance with any State requirements.)* At surface 0, 2030' FEL & 990' FSL At proposed prod. zone			9. WELL NO. 2		
14. DISTANCE IN MILES AND DIRECTION FROM NEAREST TOWN OR POST OFFICE* 15 miles West from Eunice			10. FIELD AND POOL, OR WILDCAT Antelope Ridge-Atoka Gas		
15. DISTANCE FROM PROPOSED* LOCATION TO NEAREST PROPERTY OR LEASE LINE, FT. (Also to nearest drig. unit line, if any) 990'			11. SEC., T., R., M., OR BLK. AND SURVEY OR AREA 26, T-22-S, R-34-E		
16. NO. OF ACRES IN LEASE 1920			12. COUNTY OR PARISH Lea		
17. NO. OF ACRES ASSIGNED TO THIS WELL 320			13. STATE New Mexico		
18. DISTANCE FROM PROPOSED LOCATION* TO NEAREST WELL, DRILLING, COMPLETED, OR APPLIED FOR, ON THIS LEASE, FT.			20. ROTARY OR CABLE TOOLS Rotary		
21. ELEVATIONS (Show whether DF, RT, GR, etc.) 3415.0' GR			22. APPROX. DATE WORK WILL START* ASAP		

## PROPOSED CASING AND CEMENTING PROGRAM

SIZE OF HOLE	SIZE OF CASING	WEIGHT PER FOOT	SETTING DEPTH	QUANTITY OF CEMENT	
17-1/2"	13-3/8"	54.5#	1800'	1700 sxs	Surface
12-1/4"	9-5/8"	36#	4850'	2050 sxs	Surface
8-3/4"	7"	26#	11,835'	1100 sxs	TOC 5800' T.S.
6-1/8"	4-1/2" Liner		TOL 11,530', BOL 13,648'	315 sxs	

Amend permit to drill from the Ojo Chiso (Morrow) Gas Pool to the Antelope Ridge-Atoka Gas. Morrow is dry. Set CIBP @ 13,382' w/2 sxs cmt on top PBTD @ 13,263'. See Sundry notice reporting commence operations of this well.

Also, change 320-acre proration unit from S $\frac{1}{2}$  laydown to E $\frac{1}{2}$  standup of Sec. 26. This re-assignment will throw well into unorthodox location. This re-assignment will allow us to drill Well No. 3 on the W $\frac{1}{2}$  on the Section.

Hearing being set up by Kellahin, Kellahin & Aubrey in Santa Fe.

Will be submitted on FORM 3160-5.

IN ABOVE SPACE DESCRIBE PROPOSED PROGRAM: If proposal is to deepen or plug back, give data on present productive zone and proposed new productive zone. If proposal is to drill or deepen directionally, give pertinent data on subsurface locations and measured and true vertical depths. Give blowout preventer program, if any.

24. SIGNED Mary J. Perry TITLE Proration Analyst DATE 4-5-90  
(This space for Federal or State office use)

PERMIT NO. \_\_\_\_\_ APPROVAL DATE \_\_\_\_\_

APPROVED BY \_\_\_\_\_ TITLE \_\_\_\_\_ DATE 4-24-90  
CONDITIONS OF APPROVAL, IF ANY: \_\_\_\_\_

Submit to Appropriate  
District Office  
State Lease - 4 copies  
Fee Lease - 3 copies

State of New Mexico  
Energy, Minerals and Natural Resources Department

Form C-102  
Revised 1-1-89

OIL CONSERVATION DIVISION

DISTRICT I  
P.O. Box 1980, Hobbs, NM 88240

P.O. Box 2088  
Santa Fe, New Mexico 87504-2088

DISTRICT II  
P.O. Drawer DD, Artesia, NM 88210

DISTRICT III  
1000 Rio Brazos Rd., Aztec, NM 87410

WELL LOCATION AND ACREAGE DEDICATION PLAT

All Distances must be from the outer boundaries of the section

Operator Oryx Energy Company			Lease Ojo Chiso Federal		Well No. 2
Unit Letter 0	Section 26	Township 22 South	Range 34 East	County Lea	
Actual Footage Location of Well: 2030 feet from the East line and 990 feet from the South line					
Ground level Elev. 3415.0		Producing Formation Atoka		Pool Antelope Ridge-Atoka Gas	Dedicated Acreage: 320 Acres

- Outline the acreage dedicated to the subject well by colored pencil or hatchure marks on the plat below.
- If more than one lease is dedicated to the well, outline each and identify the ownership thereof (both as to working interest and royalty).
- If more than one lease of different ownership is dedicated to the well, have the interest of all owners been consolidated by communitization, unitization, force-pooling, etc?  
☐ Yes ☐ No If answer is "yes" type of consolidation voluntary Pooling  
If answer is "no" list the owners and tract descriptions which have actually been consolidated. (Use reverse side of this form if necessary.)  
No allowable will be assigned to the well until all interests have been consolidated (by communitization, unitization, forced-pooling, or otherwise) or until a non-standard unit, eliminating such interest, has been approved by the Division.

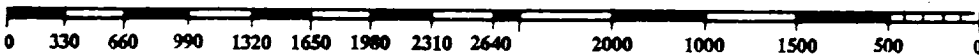
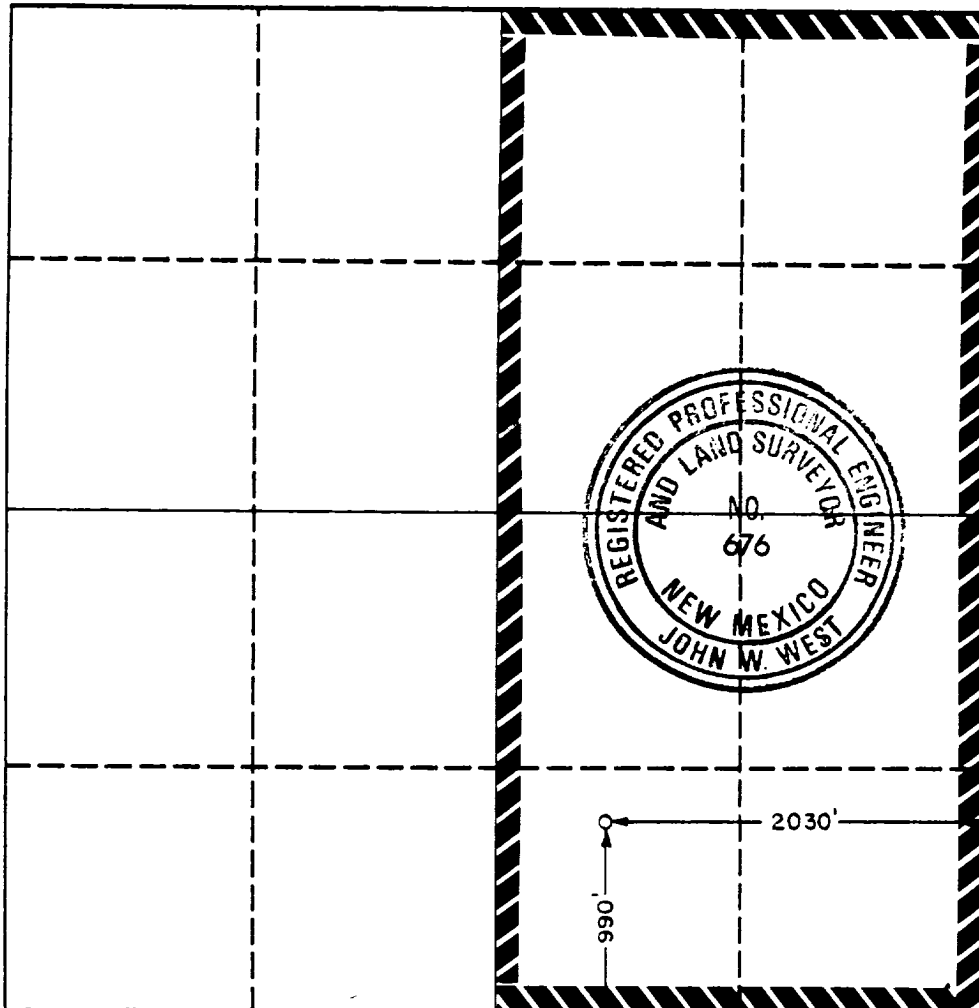

OPERATOR CERTIFICATION

I hereby certify that the information contained herein is true and complete to the best of my knowledge and belief.

Signature Maria L. Perez  
Printed Name Maria L. Perez  
Position Proration Analyst  
Company Oryx Energy Company  
Date 3-30-90

SURVEYOR CERTIFICATION

I hereby certify that the well location shown on this plat was plotted from field notes of actual surveys made by me or under my supervision, and that the same is true and correct to the best of my knowledge and belief.

Date Surveyed August 28, 1989  
Signature & Seal of Professional Surveyor

John W. West  
Certification No. JOHN W. WEST, 676  
RONALD J. EIDSON, 3239