

UNITED STATES
DEPARTMENT OF THE INTERIOR
BUREAU OF LAND MANAGEMENT

CONTACT RECEIVING
OFFICE FOR NUMBER
OF COPIES REQUIRED
(Other instructions on
reverse side)

30-025-31076

5. LEASE DESIGNATION AND SERIAL NO.

NM 59995 84840
OCT 25 1990

6. IF INDIAN, ALLOTTEE OR TRIBE NAME

7. UNIT AGREEMENT NAME

8. FARM OR LEASE NAME

Flamenco Federal

9. WELL NO.

#1

10. FIELD AND POOL OR WILDCAT

Livingston Ridge Delaware

11. SEC., T., R., M., OR BLK.
AND SURVEY OR AREA

Sec. 7, T-22-S, R-32-

12. COUNTY OR PARISH

Lea

13. STATE

NM

APPLICATION FOR PERMIT TO DRILL, DEEPEN, OR PLUG BACK

1a. TYPE OF WORK

DRILL ☒

DEEPEN ☐

PLUG BACK ☐

b. TYPE OF WELL

OIL
WELL ☒

GAS
WELL ☐

OTHER

SINGLE
ZONE ☒

MULTIPLE
ZONE ☐

2. NAME OF OPERATOR

Strata Production Company

3a. Area Code & Phone No.

505 622-1127

3. ADDRESS OF OPERATOR

648 Petroleum Building Roswell, NM 88201

4. LOCATION OF WELL (Report location clearly and in accordance with any State requirements.)*

At surface
660' FWL and 1650' FSL

At proposed prod. zone

same

14. DISTANCE IN MILES AND DIRECTION FROM NEAREST TOWN OR POST OFFICE*

10 miles South of the Halfway Bar

15. DISTANCE FROM PROPOSED*

LOCATION TO NEAREST
PROPERTY OR LEASE LINE, FT.
(Also to nearest drlg. unit line, if any)

660'

16. NO. OF ACRES IN LEASE

240 ac.

17. NO. OF ACRES ASSIGNED
TO THIS WELL

40 ac.

18. DISTANCE FROM PROPOSED LOCATION*

TO NEAREST WELL, DRILLING, COMPLETED,
OR APPLIED FOR, ON THIS LEASE, FT.

n/a

19. PROPOSED DEPTH

8500'

20. ROTARY OR CABLE TOOLS

Rotary

21. ELEVATIONS (Show whether DF, RT, GR, etc.)

3642.8' C.L.

22. APPROX. DATE WORK WILL START*

A.S.A.P.

PROPOSED CASING AND CEMENTING PROGRAM

HOLE SIZE	CASING SIZE	WEIGHT/FOOT	GRADE	THREAD TYPE	SETTING DEPTH	QUANTITY OF CEMENT
12-1/4"	8-5/8"	24#	J-55	LTC	800'	circulate
7-7/8"	5-1/2"	15.5 & 17#	J-55	LTC	8500'	circulate

1.) Drill 12-1/4" hole to 800' or top of salt, set 800' of 8-5/8", 24# casing to TD and circulate approximately 300 sx class "C" cement to surface.

2.) Drill 7-7/8" hole to 8500' or a depth sufficient to test the Delaware formation, evaluate well with logs and side wall cores. If necessary, run 8500' of 5-1/2", 15.5 and 17# casing to TD and lead-in with 600 sx of foamed synthetic pozzolan, fly ash cement and tail-in with 350 sx of "neat" cement and attempt to circulate cement to surface. Complete cementing with a "top" job pumping 10 - 50 sx "neat" down the backside of the 5 1/2" from the surface.

3.) Logging program - see hole prognosis.

4.) Mud program - see Exhibit "F".

5.) Surface use plan attached.

IN ABOVE SPACE DESCRIBE PROPOSED PROGRAM: If proposal is to deepen or plug back, give data on present productive zone and proposed new productive zone. If proposal is to drill or deepen directionally, give pertinent data on subsurface locations and measured and true vertical depths. Give blowout preventer program, if any.

SIGNED

James G. Mc Clelland

TITLE

Vice President

DATE

Oct. 10, 1990

(This space for Federal or State office use)

PERMIT NO.

APPROVAL DATE

APPROVED BY

TITLE

DATE

CONDITIONS OF APPROVAL, IF ANY:

APPROVAL SUBJECT TO

GENERAL REQUIREMENTS AND

SPECIAL STIPULATIONS

*See Instructions On Reverse Side

OIL CONSERVATION DIVISION

P.O. Box 2088

Santa Fe, New Mexico 87504-2088

DISTRICT I
P.O. Box 1980, Hobbs, NM 88240

DISTRICT II
P.O. Drawer DD, Artesia, NM 88210

DISTRICT III
1000 Rio Brazos Rd., Aztec, NM 87410

WELL LOCATION AND ACREAGE DEDICATION PLAT

All Distances must be from the outer boundaries of the section

Operator Strata Production Company			Lease Flamenco Federal		Well No. 1
Unit Letter L	Section 7	Township 22 South	Range 32 East	County Lea	
Actual Footage Location of Well: 1650 feet from the South line and 660 feet from the West line					
Ground level Elev. 3642.8	Producing Formation SALINAS		Pool Levingston Ridge Delaware	Dedicated Acreage: 4.0 Acres	

1. Outline the acreage dedicated to the subject well by colored pencil or hatchure marks on the plat below.

2. If more than one lease is dedicated to the well, outline each and identify the ownership thereof (both as to working interest and royalty).

3. If more than one lease of different ownership is dedicated to the well, have the interest of all owners been consolidated by communitization, unitization, force-pooling, etc.?

☐ Yes

☐ No

If answer is "yes" type of consolidation

If answer is "no" list the owners and tract descriptions which have actually been consolidated. (Use reverse side of this form if necessary.)

No allowable will be assigned to the well until all interests have been consolidated (by communitization, unitization, forced-pooling, or otherwise) or until a non-standard unit, eliminating such interest, has been approved by the Division.

OPERATOR CERTIFICATION

I hereby certify that the information contained herein is true and complete to the best of my knowledge and belief.

Signature

James G. McCulland

Printed Name

JAMES G. McCULLAND

Position

STRATA PRODUCTION CO.

Company

1100 P. 210311

Date

10-17-90

SURVEYOR CERTIFICATION

I hereby certify that the well location shown on this plat was plotted from field notes of actual surveys made by me or under my supervision, and that the same is true and correct to the best of my knowledge and belief.

Date Surveyed

October 17, 1990

Signature & Seal of
Professional Surveyor

P.R. Patton

Certificate No.

8112

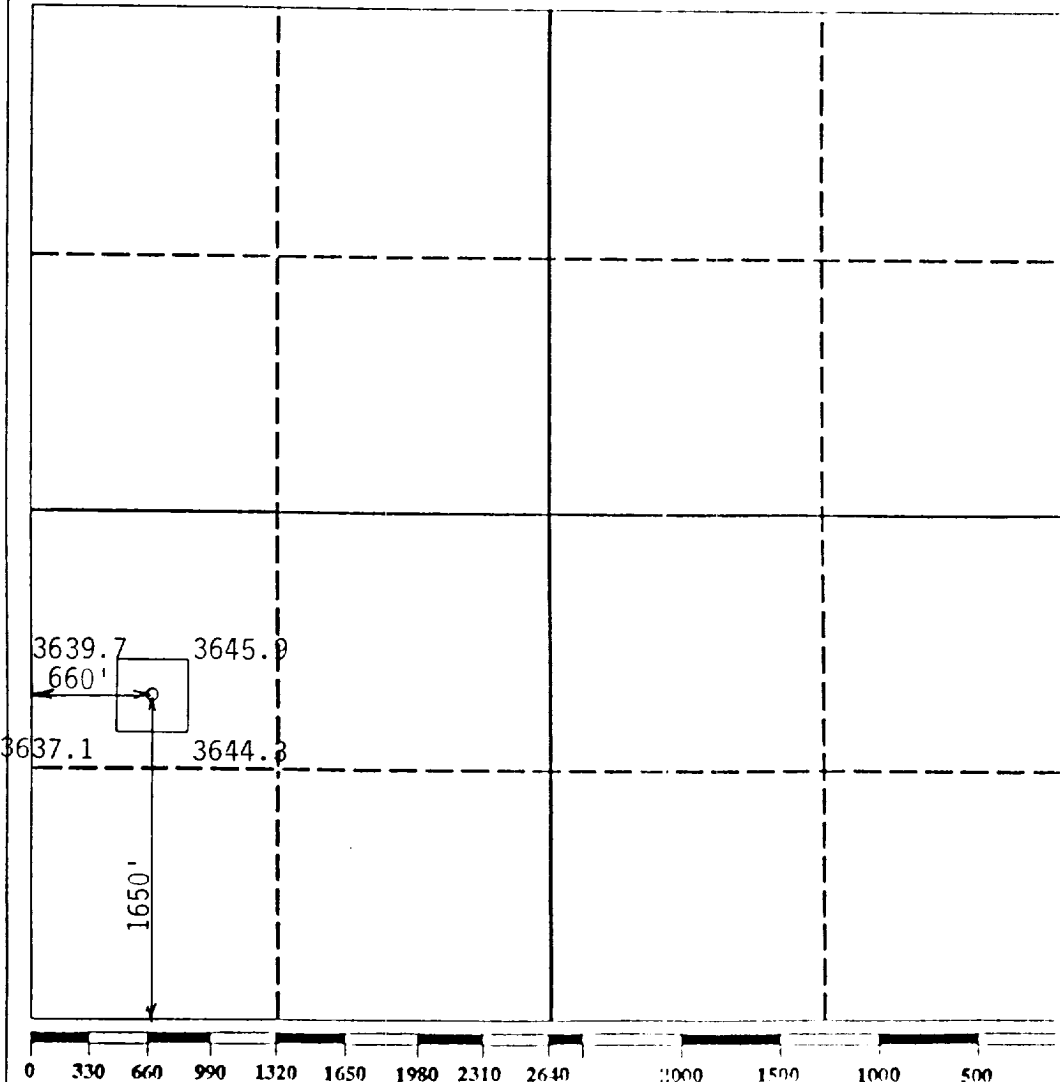

EXHIBIT "A"

RECEIVED

NOV 19 1990

LIBRARY
HOBBSVILLE



DRILLING CO., INC. - OIL WELL DRILLING CONTRACTORS

KEN REYNOLDS, PRESIDENT
ARNIE NEWKIRK, VICE PRESIDENT

P. O. Box 1490 ROSWELL, NEW MEXICO 80702-1490
808/622-5070
808/644-2719
ROSWELL, NM 80702-1490

RIG #1

BLOWOUT PREVENTOR ARRANGEMENT

11" SHAFFER TYPE LWS, 5000 psi WP
11" GK HYDRIL, 5000 psi WP
80 GALLON, 4 STATION PAYNE ACCUMULATOR
3000 psi WP CHOKES MANIFOLD

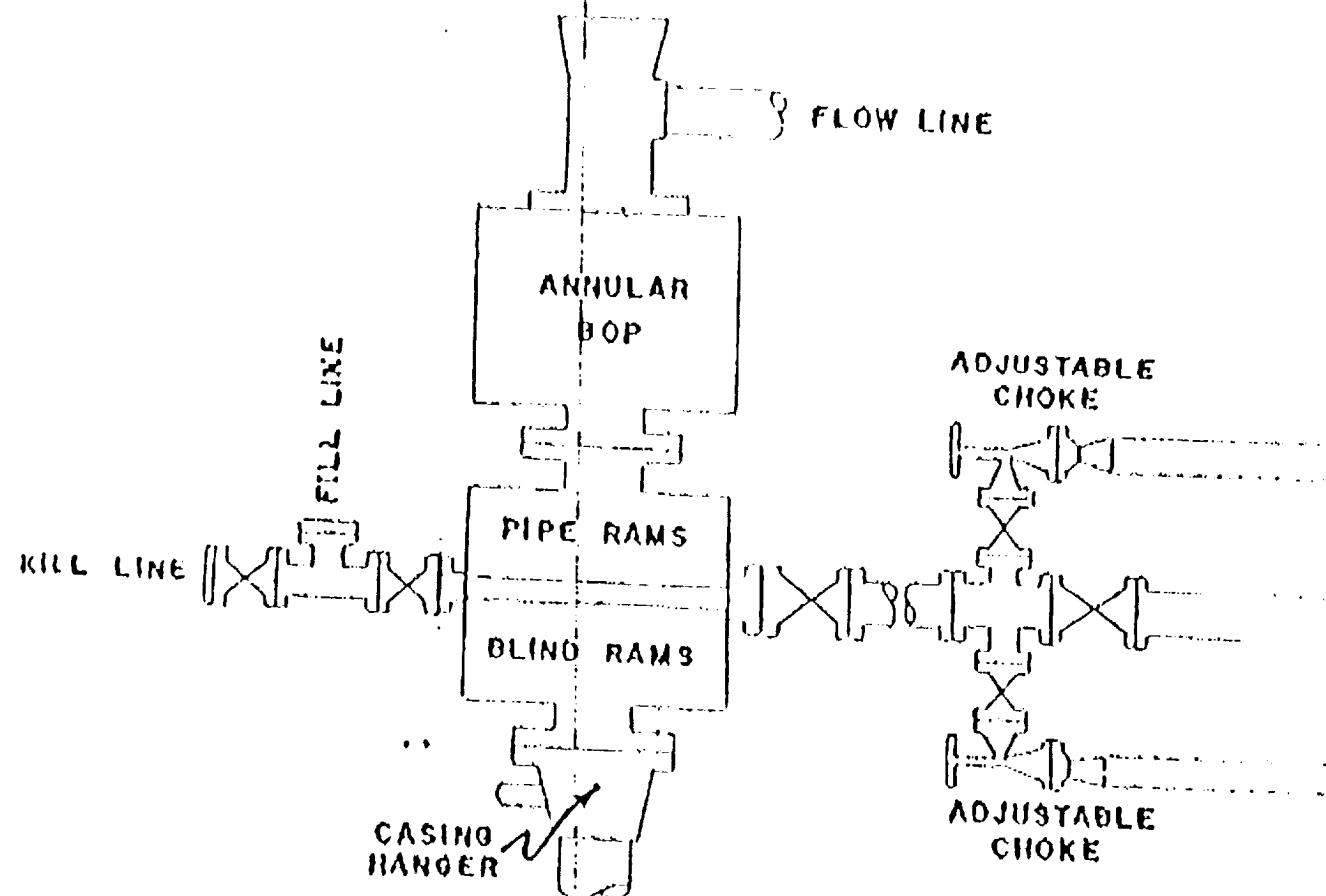

ADAM @ BLM
FACED TO APR 10-10-90
LAWRENCE FERGUSON #1

707 Drilling Corp.
BOP. manifold

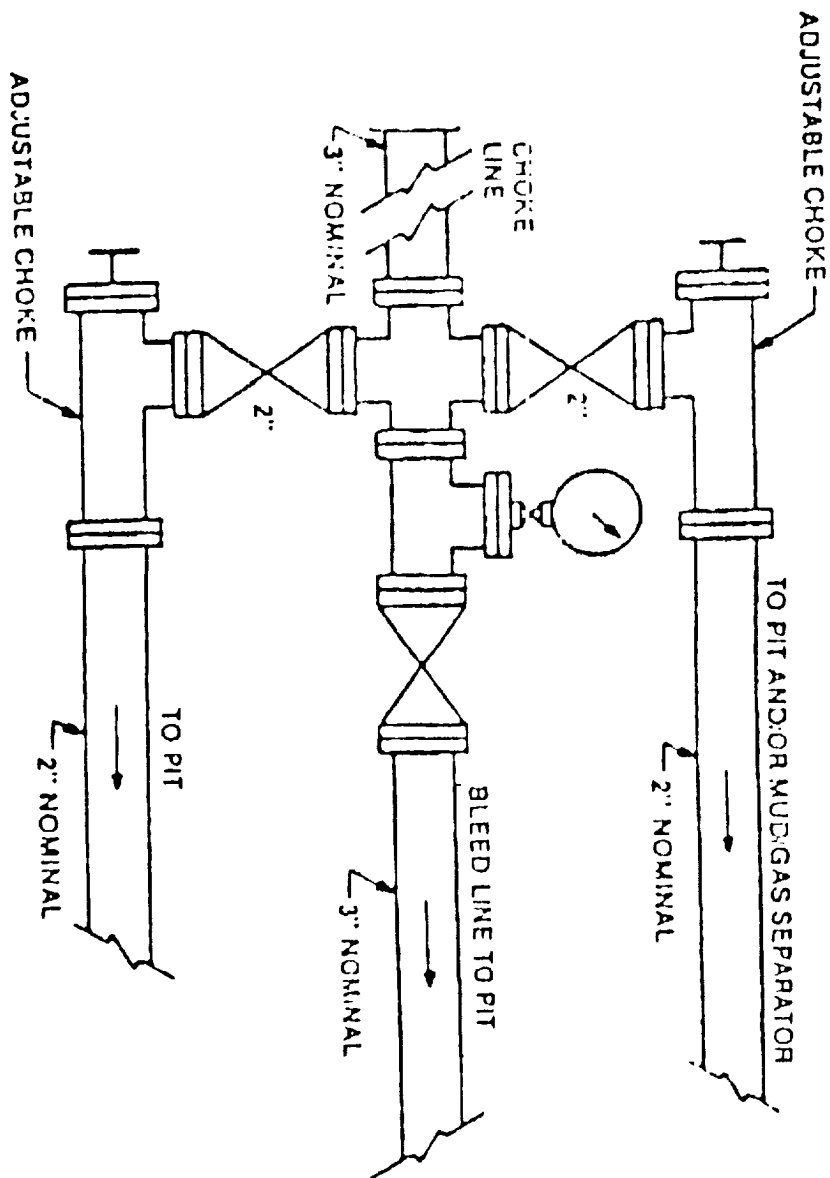

EXHIBIT "E"

16-98-7-26-91

ELF

Injection Fracture 10-23-92

08/10/1980

STATE OF TEXAS
COUNTY OF DALLAS