

Submit to Appropriate
District Office
State Lease - 6 copies
Fee Lease - 5 copies

State of New Mexico
Energy, Minerals and Natural Resources Department

Form C-101
Revised 1-1-89

OIL CONSERVATION DIVISION

P.O. Box 2088
Santa Fe, New Mexico 87504-2088

DISTRICT I
P.O. Box 1980, Hobbs, NM 88240

DISTRICT II
P.O. Drawer DD, Artesia, NM 88210

DISTRICT III
1000 Rio Brazos Rd., Aztec, NM 87410

API NO. (assigned by OCD on New Wells)

30-025-31140

5. Indicate Type of Lease

STATE ☐

FEE ☒

6. State Oil & Gas Lease No.

APPLICATION FOR PERMIT TO DRILL, DEEPEN, OR PLUG BACK

1a. Type of Work:

DRILL ☒

RE-ENTER ☐

DEEPEN ☐

PLUG BACK ☐

b. Type of Well:

OIL
WELL ☒

GAS
WELL ☐

OTHER ☐

SINGLE
ZONE ☒

MULTIPLE
ZONE ☐

7. Lease Name or Unit Agreement Name

M. B. WEIR -B-

2. Name of Operator

TEXACO PRODUCING INC.

8. Well No.

14

3. Address of Operator

P. O. Box 3109, Midland, Texas 79702

9. Pool name or Wildcat

*

4. Well Location

Unit Letter N : 990 Feet From The SOUTH Line and 2310 Feet From The WEST Line

Section 12 Township 20-SOUTH Range 37-EAST NMPM LEA County

10. Proposed Depth

6300'

11. Formation

BLINEBRY, GLORIETA

12. Rotary or C.T.

ROTARY

13. Elevations (Show whether DF, RT, GR, etc.)

GR-3565'

14. Kind & Status Plug. Bond

BLANKET

15. Drilling Contractor

16. Approx. Date Work will start

FEBRUARY 18, 1990

17. PROPOSED CASING AND CEMENT PROGRAM

SIZE OF HOLE	SIZE OF CASING	WEIGHT PER FOOT	SETTING DEPTH	SACKS OF CEMENT	EST. TOP
20	16	94#	40'	REDI-MIX	SURFACE
14 3/4	11 3/4	42#	1420'	950	SURFACE
11	8 5/8	32#	4000'	1300	SURFACE
7 7/8	5 1/2	15.5# & 17#	6300'	1300	SURFACE

* EAST WEIR BLINEBRY, SKAGGS GLORIETA

CEMENTING PROGRAM: CONDUCTOR - REDI-MIX

SURFACE CSG. - 700 SACKS CLASS H w/ 2% GEL & 2% CaCl₂ (14.8ppg, 1.36f3/s, 6.5gw/s). F/B 250 SACKS CLASS H w/ 2% CaCl₂ (15.6ppg, 1.19f3/s, 5.2gw/s).

INTERMEDIATE CSG. - 1050 SACKS 35/65 POZ CLASS H w/ 6% GEL & 5% SALT (12.8ppg, 1.87f3/s, 9.9gw/s). F/B 250 SACKS CLASS H w/ 2% CaCl₂ (15.6ppg, 1.19f3/s, 5.2gw/s).

PRODUCTION CSG. - 1st STAGE: 450 SACKS 50/50 POZ CLASS H w/ 2% GEL, 5% SALT & 1/4# FLOCELE (14.2ppg, 1.28f3/s, 5.75gw/s). 2nd STAGE: 600 SACKS 35/65 POZ CLASS H w/ 6% GEL & 5% SALT (12.8ppg, 1.87f3/s, 9.9gw/s). F/B 250 SACKS CLASS H (15.6ppg, 1.18f3/s, 5.2gw/s). DV TOOL @ 5000'.

THERE ARE NO OTHER OPERATORS IN THIS QUARTER SECTION.

IN ABOVE SPACE DESCRIBE PROPOSED PROGRAM: IF PROPOSAL IS TO DEEPEN OR PLUG BACK, GIVE DATA ON PRESENT PRODUCTIVE ZONE AND PROPOSED NEW PRODUCTIVE ZONE. GIVE BLOWOUT PREVENTER PROGRAM, IF ANY.

I hereby certify that the information above is true and complete to the best of my knowledge and belief.

SIGNATURE C. P. Basham /cwH TITLE DRILLING SUPERINTENDENT DATE 01-23-91

TYPE OR PRINT NAME C. P. BASHAM

TELEPHONE NO. (915) 688-4620

(This space for State Use)

APPROVED BY _____ TITLE _____ DATE 1/24/91

CONDITIONS OF APPROVAL, IF ANY:

Permit Expires 6 Months From Approval
Date Unless Drilling Underway.

Submit to Appropriate
District Office
State Lease - 4 copies
Fee Lease - 3 copies

State of New Mexico
Energy, Minerals and Natural Resources Department

Form C-102
Revised 1-1-89

OIL CONSERVATION DIVISION

P.O. Box 2088

Santa Fe, New Mexico 87504-2088

DISTRICT I

P.O. Box 1980, Hobbs, NM 88240

DISTRICT II

P.O. Drawer DD, Artesia, NM 88210

DISTRICT III

1000 Rio Brazos Rd., Aztec, NM 87410

WELL LOCATION AND ACREAGE DEDICATION PLAT

All Distances must be from the outer boundaries of the section

Operator Texaco Producing Inc.			Lease M. B. Weir "B"		Well No. 14
Unit Letter N	Section 12	Township 20 South	Range 37 East	County Lea	
Actual Footage Location of Well: 990 feet from the South line and 2310 feet from the West line					
Ground level Elev. 3565	Producing Formation Glorieta; Blinbry		Pool Skaggs Glorieta East Weir Blinbry		Dedicated Acreage: 40 Acres

1. Outline the acreage dedicated to the subject well by colored pencil or hatchure marks on the plat below.

2. If more than one lease is dedicated to the well, outline each and identify the ownership thereof (both as to working interest and royalty).

3. If more than one lease of different ownership is dedicated to the well, have the interest of all owners been consolidated by communitization, unitization, force-pooling, etc.?

☐ Yes ☐ No If answer is "yes" type of consolidation

If answer is "no" list the owners and tract descriptions which have actually been consolidated. (Use reverse side of this form if necessary.)

No allowable will be assigned to the well until all interests have been consolidated (by communitization, unitization, forced-pooling, or otherwise) or until a non-standard unit, eliminating such interest, has been approved by the Division.

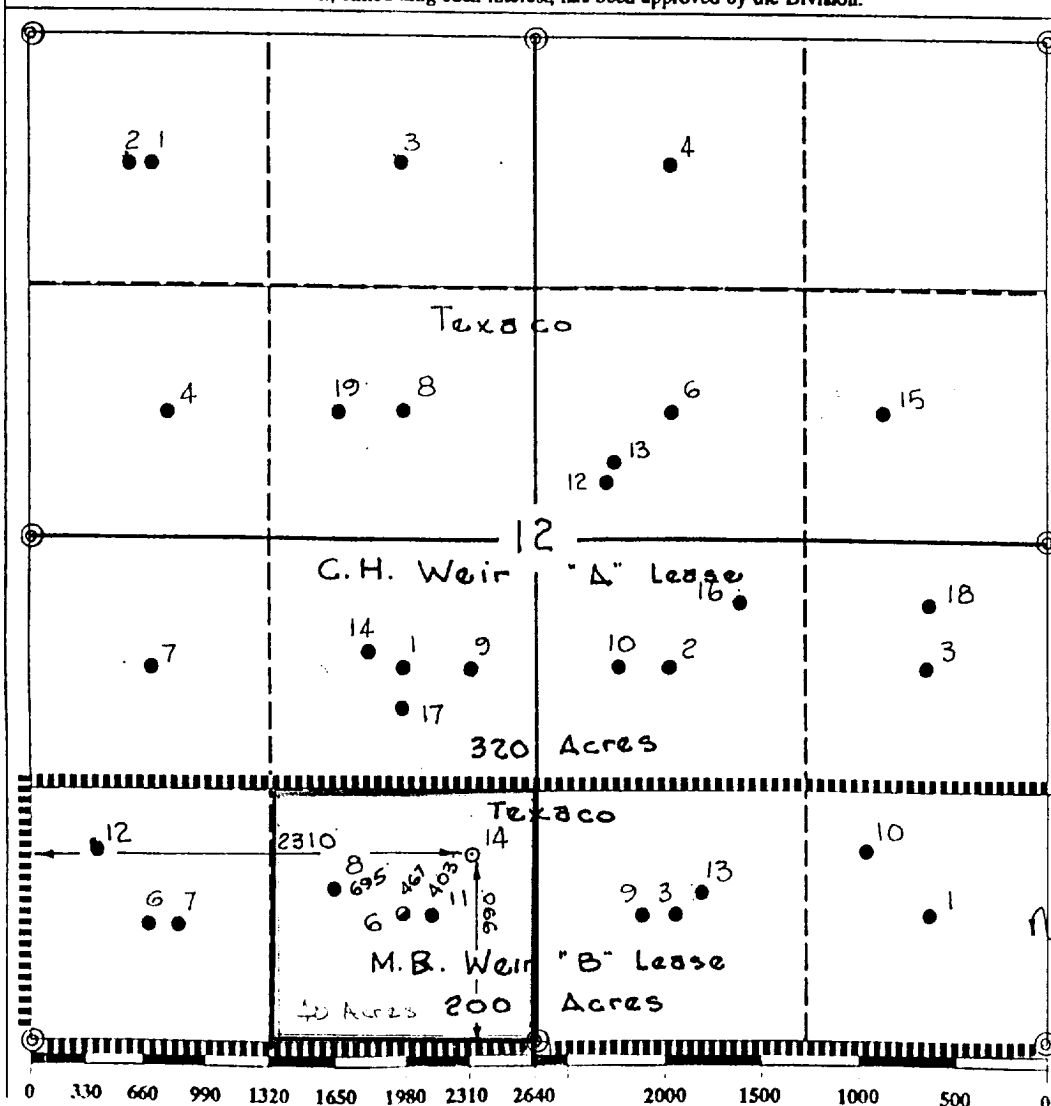

OPERATOR CERTIFICATION

I hereby certify that the information contained herein is true and complete to the best of my knowledge and belief.

Signature

Royce D. Mariott

Printed Name

Royce D. Mariott

Position

Division Surveyor

Company

Texaco Producing Inc.

Date

January 18, 1991

SURVEYOR CERTIFICATION

I hereby certify that the well location shown on this plat was plotted from field notes of actual surveys made by me or under my supervision, and that the same is true and correct to the best of my knowledge and belief.

Date Surveyed

January 15, 1991

Signature & Seal of
Professional Surveyor

John S. Piper

Certificate No.

7254 John S. Piper

© = 2" or 1" Iron Pipe w/ G.L.O.B.C. Foundations Shown. O = Staked Location • = Producer Well @ = Skaggs Grayburn

**DRILLING CONTROL
CONDITION II-B 3000 WP
FOR AIR DRILLING OR
WHERE NITROGEN OR AIR BLOWS ARE EXPECTED**

H₂S TRIM REQUIRED
YES _____ NO _____

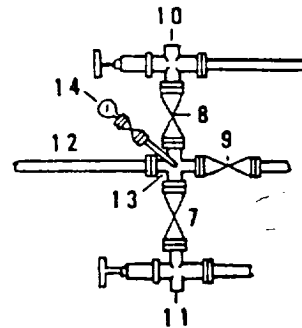
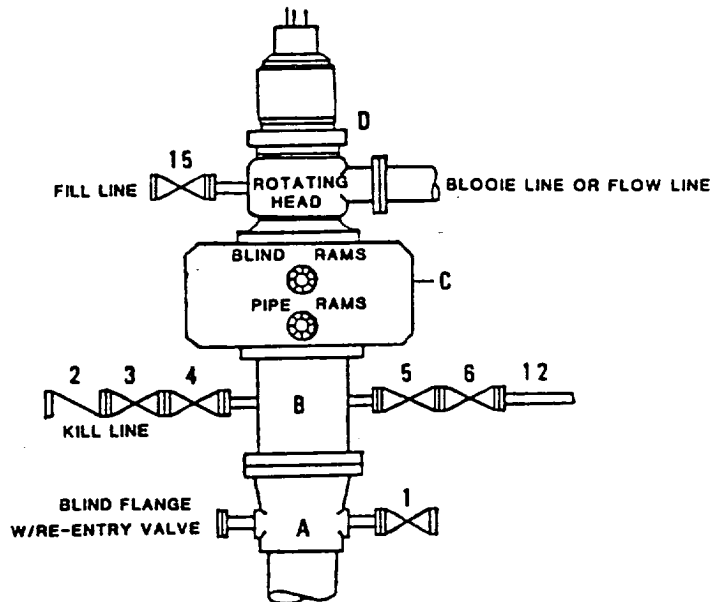

DRILLING CONTROL

MATERIAL LIST - CONDITION II - B

- | | |
|----------------|---|
| A | Texaco Wellhead |
| B | 3000# W.P. drilling spool with a 2" minimum flanged outlet for kill line and 3" minimum flanged outlet for choke line. |
| C | 3000# W.P. Dual ram type preventer, hydraulic operated with 1" steel, 3000# W.P. control lines (where sub-structure height is adequate, 2 - 3000# W.P. single ram type preventers may be utilized). |
| D | Rotating Head with fill up outlet and extended Blooie Line. |
| 1,3,4,
7,8, | 2" minimum 3000# W.P. flanged full opening steel gate valve, or Halliburton Lo Torc Plug valve. |
| 2 | 2" minimum 3000# W.P. back pressure valve. |
| 5,6,9 | 3" minimum 3000# W.P. flanged full opening steel gate valve, or Halliburton Lo Torc Plug valve. |
| 12 | 3" minimum schedule 80, Grade "B", seamless line pipe. |
| 13 | 2" minimum x 3" minimum 3000# W.P. flanged cross. |
| 10,11 | 2" minimum 3000# W.P. adjustable choke bodies. |
| 14 | Cameron Mud Gauge or equivalent (location optional in choke line). |
| 15 | 2" minimum 3000# W.P. flanged or threaded full opening steel gate valve, or Halliburton Lo Torc Plug valve. |



TEXACO, INC.
MIDLAND DIVISION
MIDLAND, TEXAS



SCALE	DATE	EST. NO.	DRG. NO.
DRAWN BY:			
CHECKED BY:			
APPROVED BY:			

EXHIBIT C