

OIL CONSERVATION DIVISION

P.O. Box 2088
Santa Fe, New Mexico 87504-2088

DISTRICT I
P.O. Box 1980, Hobbs, NM 88240

DISTRICT II
P.O. Drawer DD, Artesia, NM 88210

DISTRICT III
1000 Rio Brazos Rd., Aztec, NM 87410

WELL LOCATION AND ACREAGE DEDICATION PLAT

All Distances must be from the outer boundaries of the section

Operator Marathon Oil Co.			Lease McDonald St. WSW		Well No. 49
Unit Letter K	Section 16	Township 22-South	Range 36-East	County Lea	
Actual Footage Location of Well: 1680 feet from the South line and 2632 feet from the West line					
Ground level Elev. 3546.0	Producing Formation SAN ANDRES		Pool	Dedicated Acreage: Acres	

1. Outline the acreage dedicated to the subject well by colored pencil or hatchure marks on the plat below.

2. If more than one lease is dedicated to the well, outline each and identify the ownership thereof (both as to working interest and royalty).

3. If more than one lease of different ownership is dedicated to the well, have the interest of all owners been consolidated by communitization, unitization, force-pooling, etc.?

☐ Yes

☐ No

If answer is "yes" type of consolidation

If answer is "no" list the owners and tract descriptions which have actually been consolidated. (Use reverse side of this form if necessary.)

No allowable will be assigned to the well until all interests have been consolidated (by communitization, unitization, forced-pooling, or otherwise) or until a non-standard unit, eliminating such interest, has been approved by the Division.

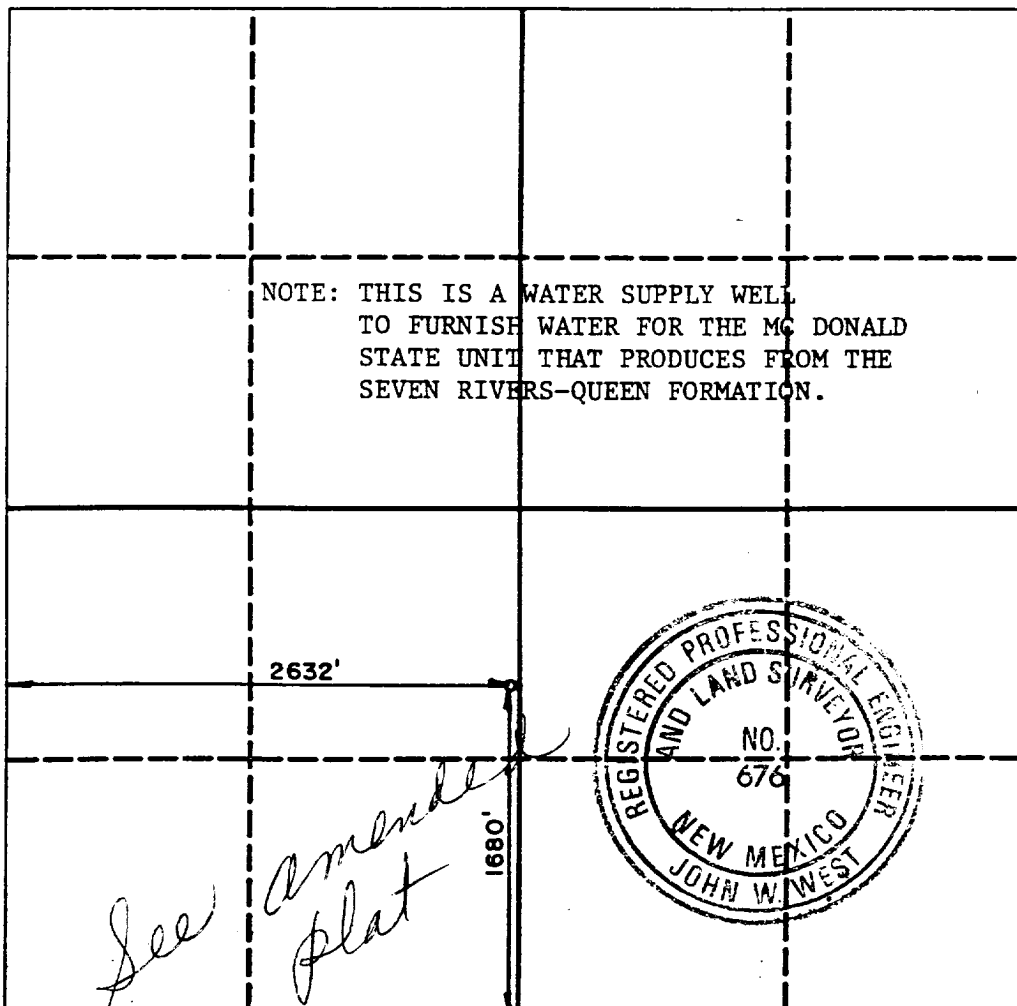

OPERATOR CERTIFICATION

I hereby certify that the information contained herein is true and complete to the best of my knowledge and belief.

Signature

W. J. DUEASE FOR S. L. ATNIPP

Printed Name

W. J. DUEASE FOR S. L. ATNIPP

Position

DRILLING SUPERINTENDENT

Company

MARATHON OIL COMPANY

Date

5/29-91

SURVEYOR CERTIFICATION

I hereby certify that the well location shown on this plat was plotted from field notes of actual surveys made by me or under my supervision, and that the same is true and correct to the best of my knowledge and belief.

Date Surveyed

May 25, 1991

Signature & Seal of Professional Surveyor

Certificate No. JOHN W. WEST, 676

RONALD J. ENDSON, 3239

Rec'd 12-6-91

ELF

RECEIVED

MAY 29 1991

038
FOODS OFFICE