

30-025-31298

BLM Roswell District
Modified Form No.
NM60-3160-2

UNITED STATES
DEPARTMENT OF THE INTERIOR
BUREAU OF LAND MANAGEMENT

APPLICATION FOR PERMIT TO DRILL, DEEPEN, OR PLUG BACK

1a. TYPE OF WORK DRILL <input checked="" type="checkbox"/> DEEPEN <input type="checkbox"/> PLUG BACK <input type="checkbox"/>		5. LEASE DESIGNATION AND SERIAL NO. LC 031670B	
b. TYPE OF WELL OIL WELL <input checked="" type="checkbox"/> GAS WELL <input type="checkbox"/> OTHER <input type="checkbox"/>		6. IF INDIAN, ALLOTTEE OR TRIBE NAME	
2. NAME OF OPERATOR Conoco Inc.		7. UNIT AGREEMENT NAME	
3. ADDRESS OF OPERATOR 10 Desta Drive, Suite 100W, Midland, TX 79705		8. FARM OR LEASE NAME Burger B-20	
4. LOCATION OF WELL (Report location clearly and in accordance with any State requirements.)* At surface unit F 2310' FNL & 2010' FWL At proposed prod. zone McKee		9. WELL NO. 4	
14. DISTANCE IN MILES AND DIRECTION FROM NEAREST TOWN OR POST OFFICE*		10. FIELD AND POOL, OR WILDCAT Warren McKee	
15. DISTANCE FROM PROPOSED* LOCATION TO NEAREST PROPERTY OR LEASE LINE, FT. (Also to deepest drlg. unit line, if any)		11. SEC., T., R., M., OR BLK. AND SURVEY OR AREA Sec. 20, T-20S, R-38E	
16. NO. OF ACRES IN LEASE		12. COUNTY OR PARISH Lea	
17. NO. OF ACRES ASSIGNED TO THIS WELL		13. STATE NM	
18. DISTANCE FROM PROPOSED LOCATION* TO NEAREST WELL, DRILLING, COMPLETED, OR APPLIED FOR, ON THIS LEASE, FT.		20. ROTARY OR CABLE TOOLS 40	
19. PROPOSED DEPTH 9300'		21. ELEVATIONS (Show whether DF, RT, GR, etc.) 3551.3' GR	
22. APPROX. DATE WORK WILL START*		23. PROPOSED CASING AND CEMENTING PROGRAM	

PROPOSED CASING AND CEMENTING PROGRAM						
HOLE SIZE	CASING SIZE	WEIGHT/FOOT	GRADE	THREAD TYPE	SETTING DEPTH	QUANTITY OF CEMENT
17-1/2"	13-3/8"	54.5 #	K-55	ST & C	450'	950 sxs
* 12-1/4"	9-5/8"	36 #	K-55	ST & C	4200'	1000 sxs
8-3/4"	7"	26 #	K-55	ST & C	9300'	2190 sxs

*If no waterflow is encountered, intermediate string will not be set. It is proposed to drill this well as a producer in the McKee Waterflood Project.

Attachments

- 1) Well Location and Acreage Dedication Plat
- 2) Attachment to Form 3160-3.
- 3) Proposed Well Plan Outline.
- 4) Surface Use Plan.
- 5) EXHIBIT A - New Mexico road map.
- 6) EXHIBIT B - Lease road map.
- 7) EXHIBIT B.1 - Location facility plat.
- 8) EXHIBIT C - Rig layout plat.
- 9) BOP Specifications.
- 10) H₂S Drilling Operations Plan.

IN ABOVE SPACE DESCRIBE PROPOSED PROGRAM: If proposal is to deepen or plug back, give data on present productive zone and proposed new productive zone. If proposal is to drill or deepen directionally, give pertinent data on subsurface locations and measured and true vertical depths. Give blowout preventer program, if any.

SIGNED Jerry W. Brown TITLE Regulatory Coordinator DATE 4-18-91
(This space for Federal or State office use)

PERMIT NO. _____ APPROVAL DATE _____
APPROVED BY _____ TITLE _____ DATE 6-14-91
SUBJECT TO: _____

GENERAL REQUIREMENTS AND
SPECIAL STIPULATIONS
ATTACHED

*See Instructions On Reverse Side

RECEIVED

JUN 17 1991

OIL CONSERVATION DIVISION

P.O. Box 2082

Santa Fe, New Mexico 87504-2082

DISTRICT I

P.O. Box 1700, Hobbs, NM 88240

DISTRICT II

P.O. Box 202, Aztec, NM 88210

DISTRICT III

1000 Rio Rancho Rd., Aztec, NM 87430

WELL LOCATION AND ACREAGE DEDICATION PLAT

All Distances must be from the outer boundaries of the section.

Operator CONOCO, INC.			Lease BURGER B-20		Well No. 4
Unit Letter F	Section 20	Township 20 SOUTH	Range 38 EAST	County LEA	
Actual Footage Location of Well: 2010 feet from the WEST line and 2310 feet from the NORTH line					
Ground level Elev. 3549.6	Producing Formation McKee		Pool Warren McKee	Dedicated Acreage 40 Acres	

1. Outline the acreage dedicated to the subject well by colored pencil or ink on the plat below.

2. If more than one lease is dedicated to the well, outline each and identify the ownership thereof (both as to working interest and royalty).

3. If more than one lease of different ownership is dedicated to the well, have the interest of all owners been consolidated by communitization, unitization, forced-pooling, etc.?

☐ Yes ☐ No If answer is "yes" type of consolidation

If answer is "no" list the owners and tract descriptions which have actually been consolidated. (Use reverse side of this form if necessary).

No acreage will be assigned to the well until all interests have been consolidated (by communitization, unitization, forced-pooling, or otherwise) or until a non-standard unit, eliminating such interest, has been approved by the Division.

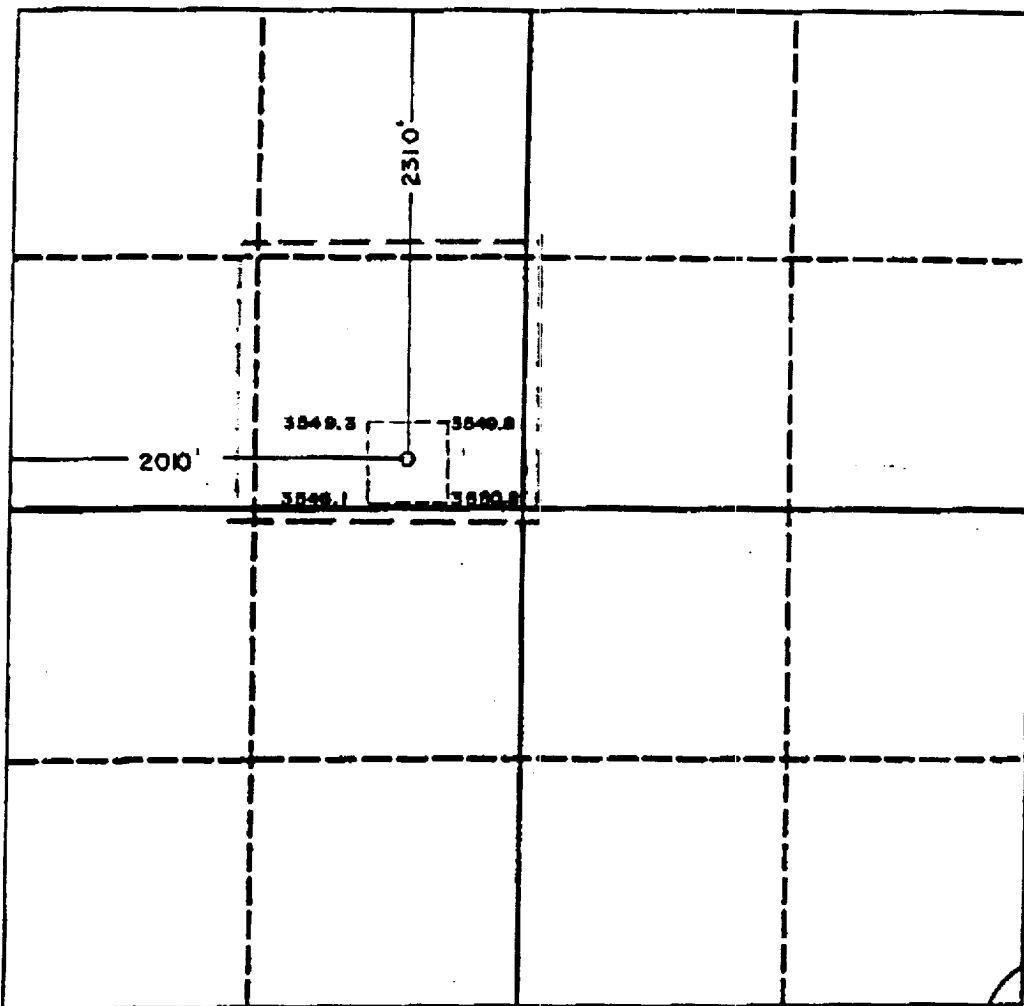

OPERATOR CERTIFICATION

I hereby certify that the information contained herein is true and complete to the best of my knowledge and belief.

Signature
Jerry W. Hoover

Print Name
Jerry W. Hoover

Position
Sr. Conservation Coordinator

Company
Conoco, Inc.

Date
June 13, 1991

SURVEYOR CERTIFICATION

I hereby certify that the well location shown on this plat was placed from field notes of actual surveys made by me or under my supervision, and that the same is true and correct to the best of my knowledge and belief.

Date Surveyed
6-10-91

Signature & Seal of
Professional Surveyor

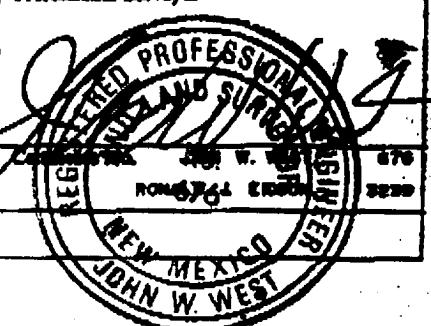

ATTACHMENT TO FORM 3160-3
APPLICATION FOR PERMIT TO DRILL

Conoco Inc.

Burger B-20 No. 4
Sec. 20, T-20S, R-38E
Lea County, New Mexico

1. The estimated tops of important geologic markers are shown on the attached Proposed Well Plan Outline.
2. The estimated depths at which anticipated water, oil, gas or other mineral-bearing formations to be encountered are shown on the attached Proposed Well Plan Outline.
3. A drawing of Blowout Preventer Specifications is attached. Pipe rams and blinds will be checked to the working pressure of the stack or 70% of the minimum internal yield strength of the casing whichever is less. BOPE will be checked when casing string is set.
4. The proposed casing program is as follows:
 ^{450'}
 0-1450': 13-3/8", 54.5# K-55
 ^{4200'}
 0-3200': 9-5/8", 36# K-55
 0-9300': 7" 26# K-55
5. The proposed mud program is as follows:
 0-1450': 8.4-8.6# Fresh Water
 1450'-5800': 10.0# Brine
 5800'-9300': 10.0# Salt Gel/Starch
6. Run open-hole logs from 2650'-9300'. The log suite will include the following:
 1) GR-CAL-DLL-MSFL, 2) GR-LDT-CNL-PE. A temperature survey will be run to determine the top of cement on each casing string where cement is not circulated.
7. Special Drilling Problems:
 a) Possible water flows from 2400'-3000.
 b) Possible lost circulation at 5300' and 9000'.
8. The anticipated starting date is 6-12-91 with a duration of approximately 30 days.

BOP SPECIFICATIONS

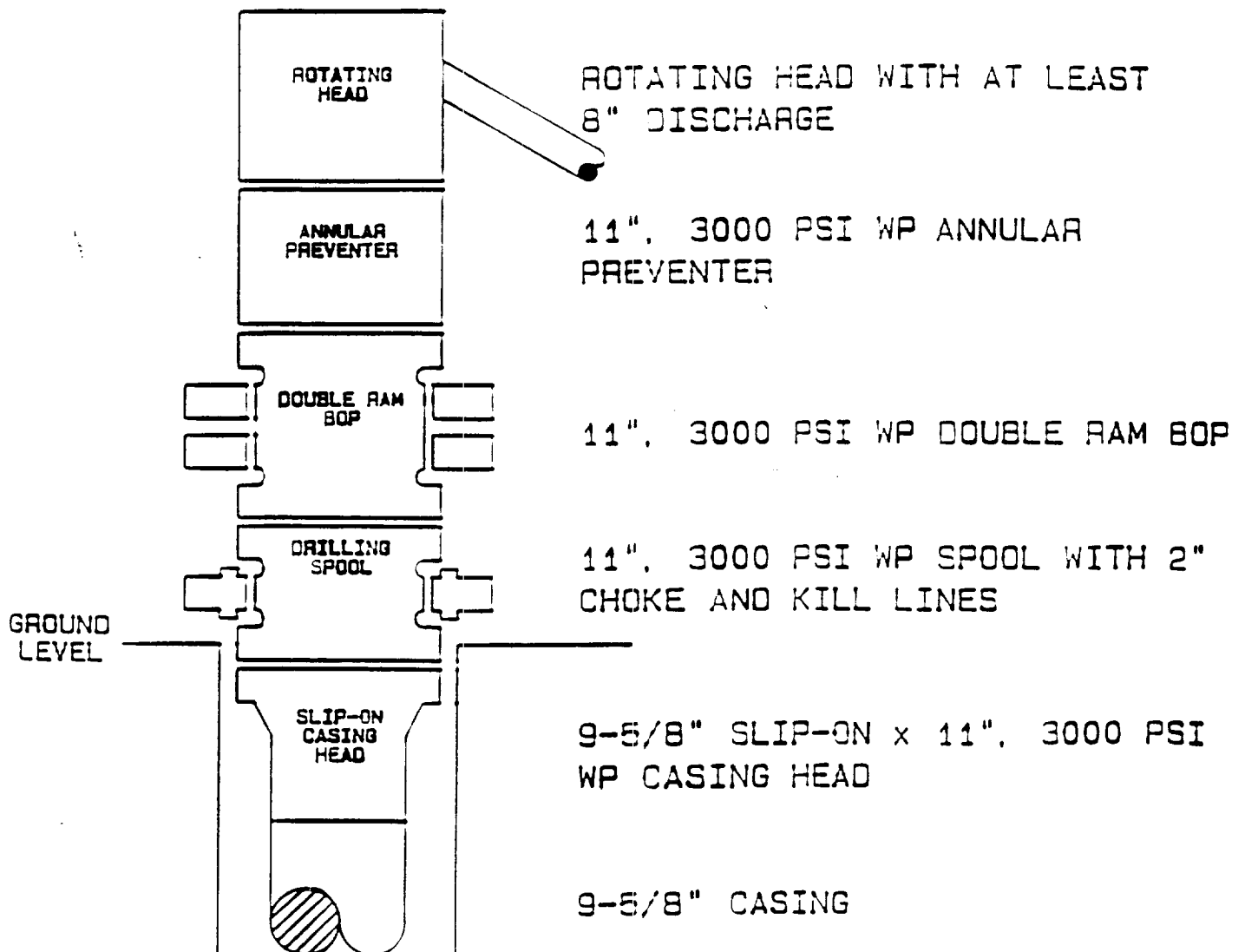

5-17-19
RECEIVED
FBI

RECEIVED

JUN 17 1991

MOBILE