

Submit to Appropriate  
District Office  
State Lease - 4 copies  
Fee Lease - 3 copies

State of New Mexico  
Energy, Minerals and Natural Resources Department

Form C-102  
Revised 1-1-89

OIL CONSERVATION DIVISION

DISTRICT I  
P.O. Box 1980, Hobbs, NM 88240

P.O. Box 2088

Santa Fe, New Mexico 87504-2088

DISTRICT II  
P.O. Drawer DD, Artesia, NM 88210

DISTRICT III  
1000 Rio Brazos Rd., Aztec, NM 87410

WELL LOCATION AND ACREAGE DEDICATION PLAT

All Distances must be from the outer boundaries of the section

Operator Yates Petroleum Corporation			Lease VB-134 Kiwi AKY State		Well No. 5
Unit Letter J	Section 16	Township 22 South	Range 32 East	County Lea	

Actual Footage Location of Well:

1980 feet from the South line and 1650 feet from the East line  
Ground level Elev. 3728' Producing Formation DELAWARE Pool East Livingston Ridge  
Dedicated Acreage: 40 Acres

1. Outline the acreage dedicated to the subject well by colored pencil or hatchure marks on the plat below.
2. If more than one lease is dedicated to the well, outline each and identify the ownership thereof (both as to working interest and royalty).
3. If more than one lease of different ownership is dedicated to the well, have the interest of all owners been consolidated by communitization, unitization, force-pooling, etc?  
☐ Yes ☐ No If answer is "yes" type of consolidation \_\_\_\_\_  
If answer is "no" list the owners and tract descriptions which have actually been consolidated. (Use reverse side of this form if necessary). \_\_\_\_\_  
No allowable will be assigned to the well until all interests have been consolidated (by communitization, unitization, forced-pooling, or otherwise) or until a non-standard unit, eliminating such interest, has been approved by the Division.

OPERATOR CERTIFICATION

I hereby certify that the information contained herein is true and complete to the best of my knowledge and belief.

Signature  
Clifton R. May  
Printed Name  
Clifton R. May

Position  
Permit Agent

Company  
Yates Petroleum Corporation

Date  
7/10/92

SURVEYOR CERTIFICATION

I hereby certify that the well location shown on this plat was plotted from field notes of actual surveys made by me or under my supervision, and that the same is true and correct to the best of my knowledge and belief.

7/10/92

Date Surveyed

Signature & Seal of  
Professional Surveyor  
HERSHEL JONES  
Certificate No.  
3640  
REGISTERED LAND SURVEYOR  
STATE OF NEW MEXICO

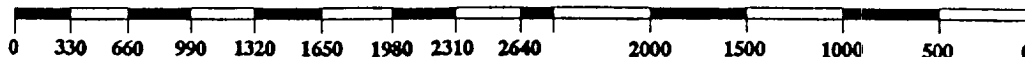
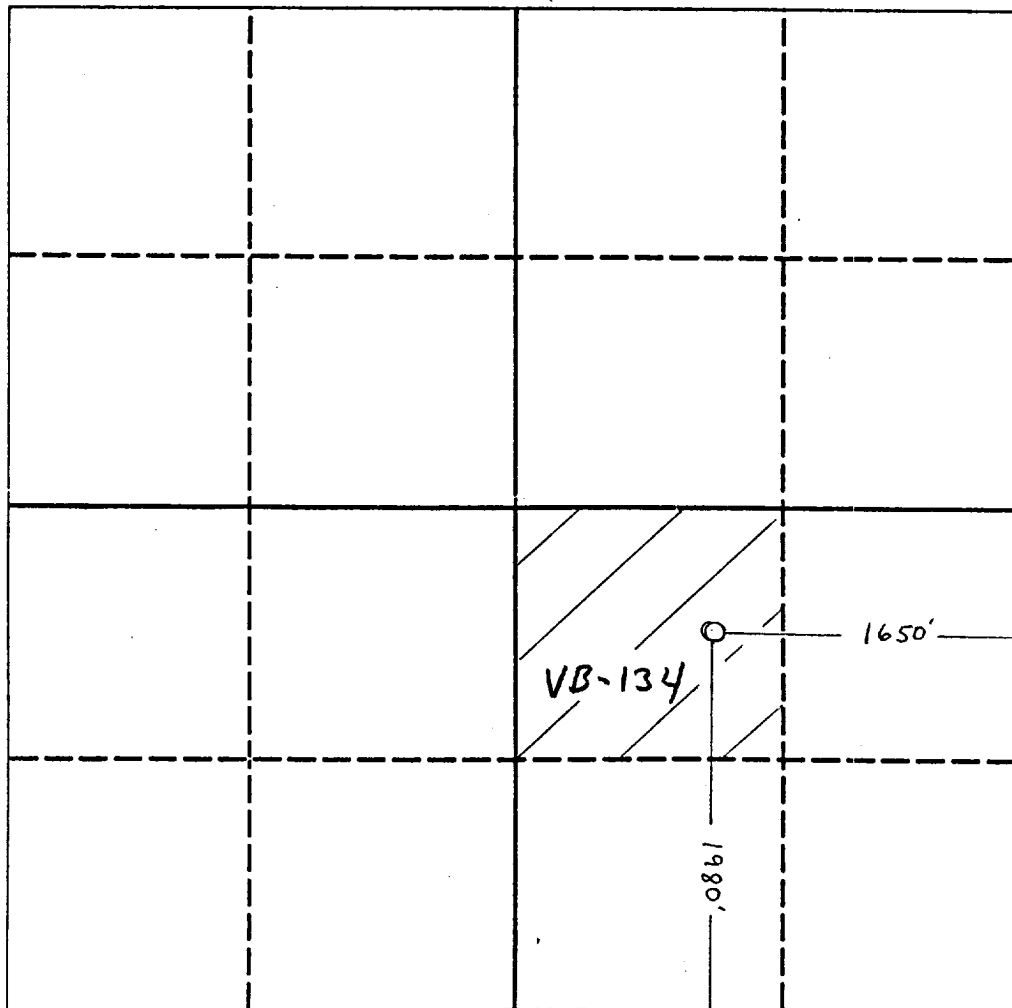

RECEIVED

JUL 10 1992

GOO HOBBS OFFICE