

Submit to Appropriate
District Office
State Lease - 6 copies
Fee Lease - 5 copies

State of New Mexico
Oil, Minerals and Natural Resources Department

Form C-101
Revised 1-1-89

OIL CONSERVATION DIVISION

P.O. Box 2088
Santa Fe, New Mexico 87504-2088

DISTRICT I
P.O. Box 1980, Hobbs, NM 88240

DISTRICT II
P.O. Drawer DD, Artesia, NM 88210

DISTRICT III
1000 Rio Brazos Rd., Aztec, NM 87410

API NO. (assigned by OCD on New Wells)

30-025-31694

5. Indicate Type of Lease

STATE ☒

FEE ☐

6. State Oil & Gas Lease No.

V-2443

APPLICATION FOR PERMIT TO DRILL, DEEPEN, OR PLUG BACK

1a. Type of Work:

DRILL ☒

RE-ENTER ☐

DEEPEN ☐

PLUG BACK ☐

b. Type of Well:

OIL
WELL ☒

GAS
WELL ☐

OTHER ☐

SINGLE
ZONE ☐

MULTIPLE
ZONE ☐

7. Lease Name or Unit Agreement Name

Lotus "ALT" State

2. Name of Operator

Yates Petroleum Corporation

8. Well No.

2

3. Address of Operator

105 South Fourth Street, Artesia, New Mexico 88210

9. Pool name or Wildcat

Undesignated Delaware

4. Well Location

Unit Letter

G

: 1980

Feet From The

North

Line and

1980

Feet From The

East

Line

Section

32

Township

22 South

Range

32 East

NMPM

Lea

County

10. Proposed Depth

8900'

11. Formation

Delaware

12. Rotary or C.T.

Rotary

13. Elevations (Show whether DF, RT, GR, etc.)

3538' GR

14. Kind & Status Plug Bond

Blanket

15. Drilling Contractor

Undesignated

16. Approx. Date Work will start

ASAP

17.

PROPOSED CASING AND CEMENT PROGRAM

SIZE OF HOLE	SIZE OF CASING	WEIGHT PER FOOT	SETTING DEPTH	SACKS OF CEMENT	EST. TOP
17 1/2"	13 3/8"	54.50#	850'	850	Circulated
11"	8 5/8"	32#	4450'	1500	Circulated
7 7/8"	5 1/2"	15.5# & 17#	TD	800	

Yates Petroleum Corporation proposes to drill and test the Delaware and intermediate formations. Approximately 850' of surface casing will be set and cement circulated. Approximately 4500' of intermediate casing will be set and cement circulated. If commercial, production casing will be set and cemented back to 8 5/8" casing, will perforate and stimulate as needed for production.

MUD PROGRAM: 0 - 850' Navite mud; 850' - 4450' will be Brine; 4450' - TD with cut Brine/Starch.

BOPE PROGRAM: BOPE will be installed at the offset and tested daily for operational.

IN ABOVE SPACE DESCRIBE PROPOSED PROGRAM: IF PROPOSAL IS TO DEEPEN OR PLUG BACK, GIVE DATA ON PRESENT PRODUCTIVE ZONE AND PROPOSED NEW PRODUCTIVE ZONE. GIVE BLOWOUT PREVENTER PROGRAM, IF ANY.

I hereby certify that the information above is true and complete to the best of my knowledge and belief.

SIGNATURE

Clifton R. May

TITLE

Permit Agent

DATE

8-20-92

TYPE OR PRINT NAME

Clifton R. May

TELEPHONE NO. 748-1471

(This space for State Use)

ORIGINAL SIGNED BY JERRY SEXTON
DISTRICT I SUPERVISOR

AUG 24 '92

APPROVED BY

TITLE

DATE

CONDITIONS OF APPROVAL, IF ANY:

Permit Expires 6 Months From Approval
Date Unless Drilling Underway.

Submit to Appropriate
District Office
State Lease - 4 copies
Fee Lease - 3 copies

State of New Mexico
Energy, Minerals and Natural Resources Department

Form C-102
Revised 1-1-89

OIL CONSERVATION DIVISION

P.O. Box 2088
Santa Fe, New Mexico 87504-2088

DISTRICT I
P.O. Box 1980, Hobbs, NM 88240

DISTRICT II
P.O. Drawer DD, Artesia, NM 88210

DISTRICT III
1000 Rio Brazos Rd., Aztec, NM 87410

WELL LOCATION AND ACREAGE DEDICATION PLAT

All Distances must be from the outer boundaries of the section

Operator YATES PETROLEUM CORPORATION			Lease LOTUS "ALT" STATE		Well No. 2
Unit Letter G	Section 32	Township 22 SOUTH	Range 32 EAST	County NMPM LEA	
Actual Footage Location of Well: 1980 feet from the NORTH line and 1980 feet from the EAST line					
Ground level Elev. 3538	Producing Formation DELAWARE		Pool WILDCAT DELAWARE		Dedicated Acreage: 40 Acres

1. Outline the acreage dedicated to the subject well by colored pencil or hatchure marks on the plat below.
2. If more than one lease is dedicated to the well, outline each and identify the ownership thereof (both as to working interest and royalty).
3. If more than one lease of different ownership is dedicated to the well, have the interest of all owners been consolidated by communitization, unitization, force-pooling, etc.?
☐ Yes ☐ No If answer is "yes" type of consolidation _____

If answer is "no" list the owners and tract descriptions which have actually been consolidated. (Use reverse side of this form if necessary.) _____

No allowable will be assigned to the well until all interests have been consolidated (by communitization, unitization, forced-pooling, or otherwise) or until a non-standard unit, eliminating such interest, has been approved by the Division.

OPERATOR CERTIFICATION

I hereby certify that the information contained herein is true and complete to the best of my knowledge and belief.

Signature Clifton R. May
Printed Name Clifton R. May
Position Permit Agent
Company Yates Petroleum Corporation
Date August 20, 1992

SURVEYOR CERTIFICATION

I hereby certify that the well location shown on this plat was plotted from field notes of actual surveys made by me or under my supervision, and that the same is true and correct to the best of my knowledge and belief.

Date Surveyed 8/12/92
Signature & Seal of Professional Surveyor _____

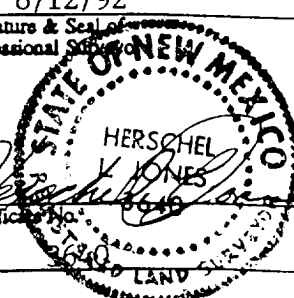
Certificate No. 16940

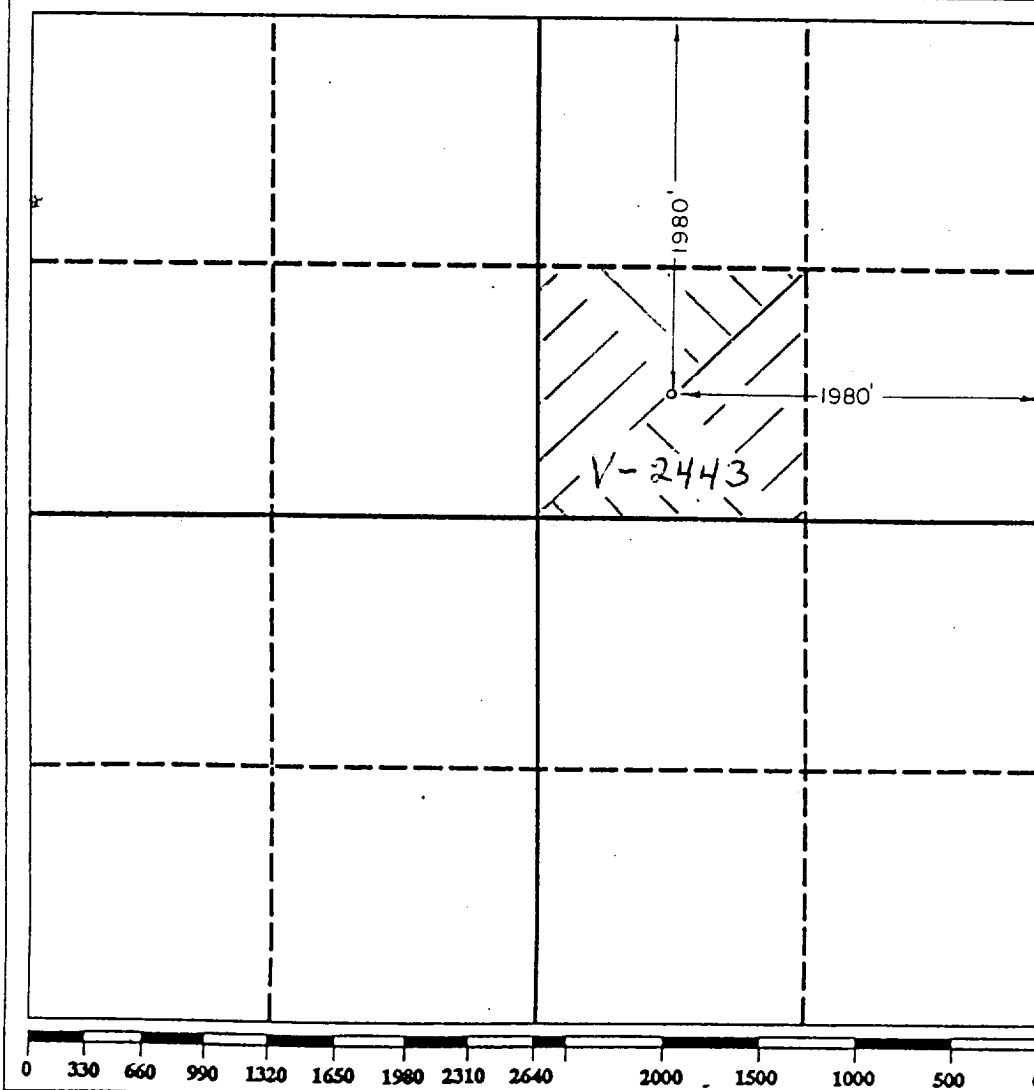

RECEIVED

AUG 21 1992

NSA MOBILE OFFICE

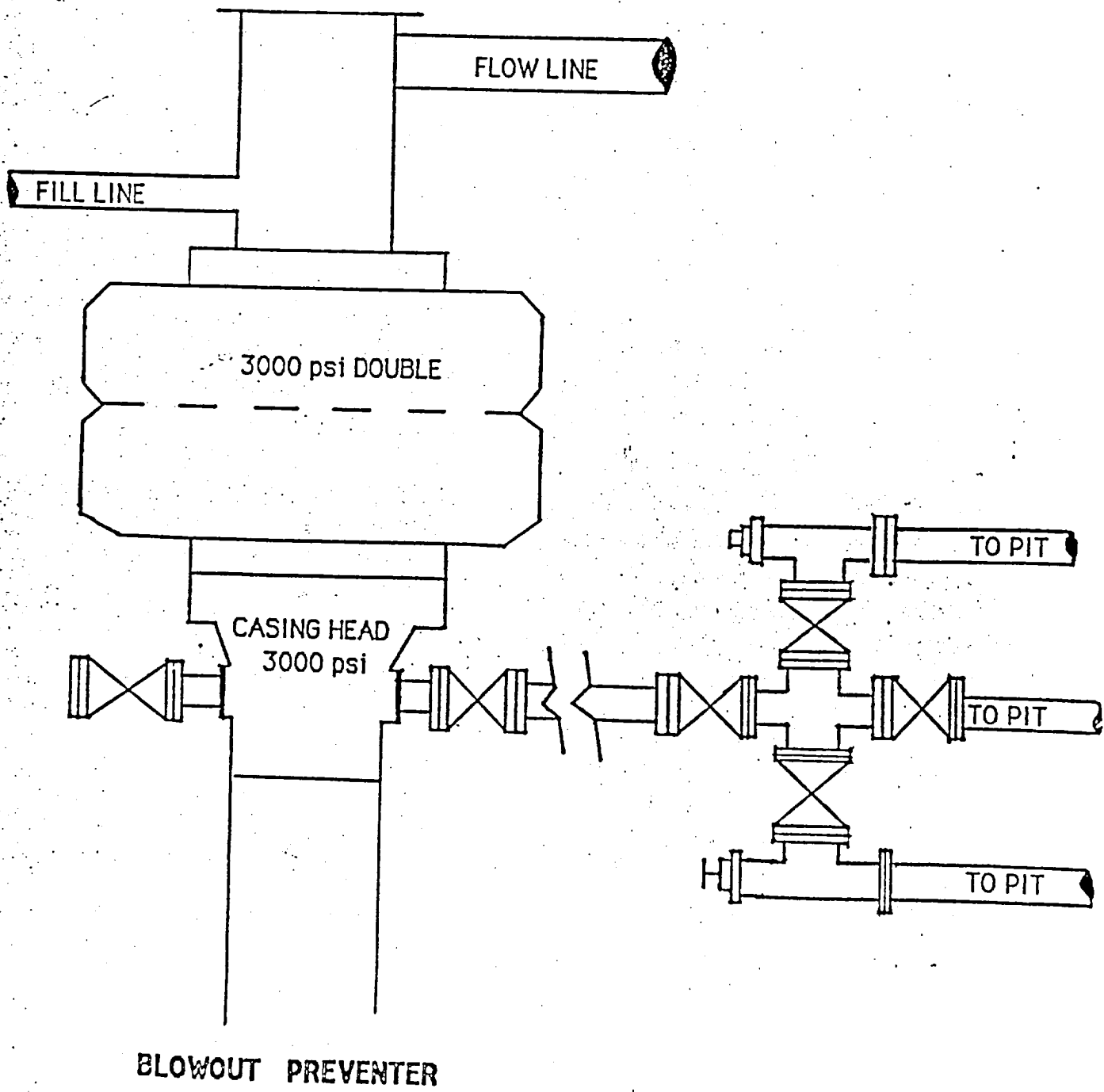

10-28-92

ELF

RECEIVED

AUG 21 1992

NOV 1992