

UNITED STATES  
DEPARTMENT OF THE INTERIOR  
BUREAU OF LAND MANAGEMENT

CONTACT REPLYING  
OFFICE FOR  
OF COPIES REQUIRED  
(Other instructions on  
reverse side)

30-025-31800

BLM Roswell District  
Modified Form No.  
NMD60-3160-2

APPLICATION FOR PERMIT TO DRILL, DEEPEN, OR PLUG BACK

1a. TYPE OF WORK

DRILL ☒

DEEPEN ☐

PLUG BACK ☐

b. TYPE OF WELL

OIL  
WELL ☒

GAS  
WELL ☐

OTHER ☐

SINGLE  
ZONE ☐

MULTIPLE  
ZONE ☐

2. NAME OF OPERATOR

Strata Production Company

021712

3a. Area Code & Phone No.

505-622-1127

3. ADDRESS OF OPERATOR

P. O. Box 1030, Roswell, New Mexico 88202-1030

4. LOCATION OF WELL (Report location clearly and in accordance with any State requirements.)\*

At surface

660' FSL & 1650' FWL

Unit IV

At proposed prod. zone

14. DISTANCE IN MILES AND DIRECTION FROM NEAREST TOWN OR POST OFFICE\*

35 miles east of Carlsbad, New Mexico

15. DISTANCE FROM PROPOSED\*

LOCATION TO NEAREST  
PROPERTY OR LEASE LINE, FT.  
(Also to nearest drilg. unit line, if any)

660'

16. NO. OF ACRES IN LEASE

640.00

17. NO. OF ACRES ASSIGNED

40.00

18. DISTANCE FROM PROPOSED LOCATION\*

TO NEAREST WELL, DRILLING, COMPLETED,  
OR APPLIED FOR, ON THIS LEASE, FT.

990'

19. PROPOSED DEPTH

8950'

20. ROTARY OR CABLE TOOLS

Rotary

21. ELEVATIONS (Show whether DF, RT, GR, etc.)

3703' GL

22. APPROX. DATE WORK WILL START\*

December 20, 1992

23.

PROPOSED CASING AND CEMENTING PROGRAM Carlsbad Controlled Water

HOLE SIZE	CASING SIZE	WEIGHT/FOOT	GRADE	THREAD TYPE	SETTING DEPTH	QUANTITY OF CEMENT
17 1/2"	13 3/8"	48#	H-40	8 RD ST&C	600'	Circulated
11"	8 5/8"	24# & 32#	J-55	8 RD ST&C	4460'	Circulated
7 7/8"	5 1/2"	17.5#	J-55	8 RD ST&C	8950'	Sufficient to tie back to 8 5/8" csg

- A. Will drill to a depth sufficient to test Delaware formation.  
B. Cementing Program: See Supplemental Information attached hereto.  
C. BOP will be installed: See Exhibit "D"  
D. Logs to be run: CNL/FDC, DLL/MSFL, GR/Neutron

APPROVAL SUBJECT TO  
GENERAL REQUIREMENTS AND  
SPECIAL STIPULATIONS  
ATTACHED

IN ABOVE SPACE DESCRIBE PROPOSED PROGRAM: If proposal is to deepen or plug back, give data on present productive zone and proposed new productive zone. If proposal is to drill or deepen directionally, give pertinent data on subsurface locations and measured and true vertical depths. Give blowout preventer program, if any.

24.

SIGNED

Carol J. Garcia

TITLE

Production Supervisor

DATE

11/4/92

(This space for Federal or State office use)

PERMIT NO.

APPROVAL DATE

APPROVED BY

TITLE

DATE

11-17-92

CONDITIONS OF APPROVAL, IF ANY:

\*See Instructions On Reverse Side

Submit to Appropriate  
District Office  
State Lease - 4 copies  
Fee Lease - 3 copies

State of New Mexico  
Energy, Minerals and Natural Resources Department

Form C-102  
Revised 1-1-89

**OIL CONSERVATION DIVISION**

P.O. Box 2088  
Santa Fe, New Mexico 87504-2088

**DISTRICT I**  
P.O. Box 1980, Hobbs, NM 88240

**DISTRICT II**  
P.O. Drawer DD, Artesia, NM 88210

**DISTRICT III**  
1000 Rio Brazos Rd., Aztec, NM 87410

**WELL LOCATION AND ACREAGE DEDICATION PLAT**

All Distances must be from the outer boundaries of the section

Operator <b>STRATA PRODUCTION</b>			Lease <b>LECHUZA FEDERAL</b>		Well No. <b>4</b>
Unit Letter <b>N</b>	Section <b>15</b>	Township <b>22 SOUTH</b>	Range <b>32 EAST</b>	County <b>LEA COUNTY, NM</b>	
Actual Footage Location of Well: <b>660</b> feet from the <b>SOUTH</b> line and <b>1650</b> feet from the <b>WEST</b> line					
Ground level Elev. <b>3703.</b>	Producing Formation <b>Delaware</b>		Pool <b>Livingston Ridge Delaware East</b>		Dedicated Acreage: <b>40.00</b> Acres

1. Outline the acreage dedicated to the subject well by colored pencil or hachure marks on the plat below.

2. If more than one lease is dedicated to the well, outline each and identify the ownership thereof (both as to working interest and royalty).

3. If more than one lease of different ownership is dedicated to the well, have the interest of all owners been consolidated by communitization, unitization, force-pooling, etc.?

☐ Yes

☐ No

If answer is "yes" type of consolidation \_\_\_\_\_

If answer is "no" list the owners and tract descriptions which have actually been consolidated. (Use reverse side of this form if necessary.) \_\_\_\_\_

No allowable will be assigned to the well until all interests have been consolidated (by communitization, unitization, forced-pooling, or otherwise) or until a non-standard unit, eliminating such interest, has been approved by the Division.

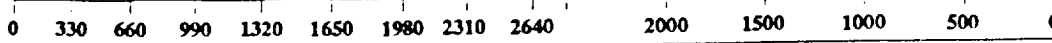
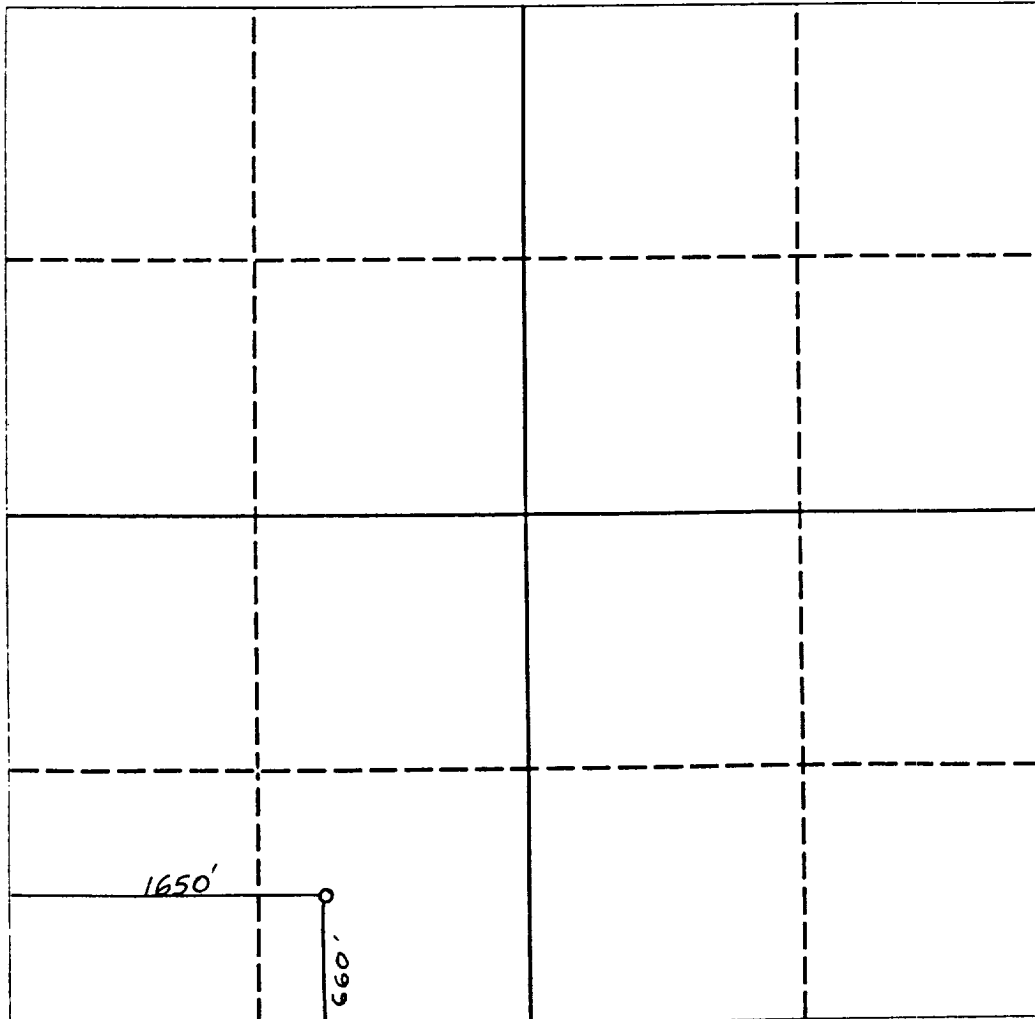

**OPERATOR CERTIFICATION**

I hereby certify that the information contained herein is true and complete to the best of my knowledge and belief.

Signature

*Carol J. Garcia*

Printed Name

Carol J. Garcia

Position

Production Supervisor

Company

Strata Production Company

Date

November 4, 1992

**SURVEYOR CERTIFICATION**

I hereby certify that the well location shown on this plat was plotted from field notes of actual surveys made by me or under my supervision, and that the same is true and correct to the best of my knowledge and belief.

Date Surveyed

OCTOBER 13, 1992

Signature & Seal of  
Professional Surveyor

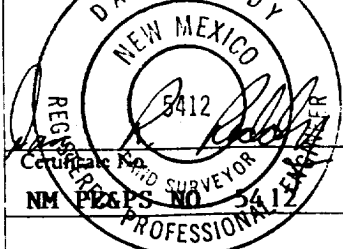

HOLE PROGNOSIS  
APPLICATION FOR PERMIT TO DRILL  
STRATA PRODUCTION COMPANY  
LECHUZA FEDERAL #4 WELL  
660' FSL & 1650' FWL  
SECTION 15-T22S-R32E

In conjunction with form 3160-3, Application for Permit to Drill, Strata Production Company submits the following items in accordance with Onshore Oil and Gas Order Numbers 1 & 2, and with all other applicable federal and state regulations.

1. The Geologic surface formation is of Permian Age.
2. Estimated tops of geologic markers are as follows:

Rustler	900'	Lamar	4780'
Top of Salt	1050'	Bone Spring	8700'
Base of Salt	4450'	T.D.	8950'

3. The estimated depths at which water, oil or gas formations are expected to be encountered are:

\*Water: 150'  
\*\*Oil or Gas: Delaware 4780' - 8700'

\* NOTE: Groundwater to be protected by 13 3/8" surface casing with cement circulated to the surface.

\*\*NOTE: Potentially productive horizons to be protected by 5 1/2" production casing with cement tied back to intermediate casing.

4. Casing Program: See Form 3160-3 attached hereto.
5. Pressure Control Equipment: See Exhibit "D", BOP diagram.
6. Mud Program:

0' to 600'	Native mud consisting of fresh water and native muds are used for drilling purposes.
600' to 4460'	Brine water purchased from commercial sources will be utilized.
4460' to 6800'	Brine and fresh water purchased from commercial sources will be utilized. Salt gel will be used to build viscosity.
6800' to TD	Brine and fresh water with salt gel and starch will be used to maintain a viscosity of approximately 31 and a water loss of 15 to 25.

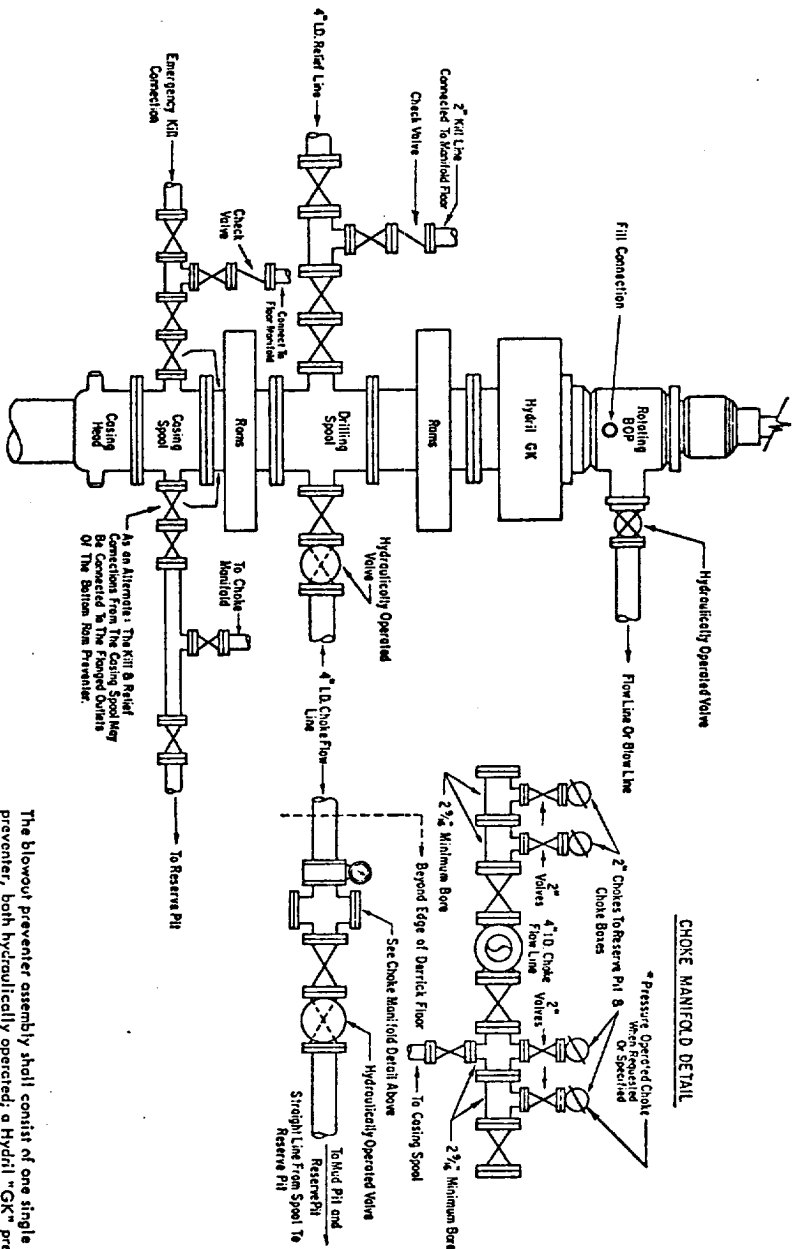

# 5000 # PSI WORKING PRESSURE BLOWOUT PREVENTER HOOK-UP

hydraulic operating system which is to be a closed system. (2) Accumulators with a precharge of nitrogen of not less than 750 PSI and connected so as to receive the aforementioned fluid charge. With the charging pumps shut down, the pressurized fluid volume stored in the accumulators must be sufficient to close all the pressure-operated devices simultaneously within \_\_\_\_\_ seconds; after closure, the remaining accumulator pressure shall be not less than 1000 PSI with the remaining accumulator fluid volume of at least \_\_\_\_\_ percent of the original. (3) When requested, an additional source of power, remote and equivalent, is to be available to operate the above pumps; or there shall be additional pumps operated by separate power and equal in performance capabilities.

The closing manifold and remote closing manifold shall have a separate control for each pressure-operated device. Controls are to be labeled, with control handles indicating open and closed positions. A pressure reducer and regulator must be provided for operating the Hydril preventer. When requested, a second pressure reducer shall be available to limit operating fluid pressures to ram preventers. Gulf Legion No. 38 hydraulic oil, an equivalent or better, is to be used as the fluid to operate the hydraulic equipment.

The choke manifold, choke flow line, relief line, and choke lines are to be supported by metal stands and adequately anchored. The choke flow line, relief line, and choke lines shall be constructed as straight as possible and without sharp bends. Easy and safe access is to be maintained to the choke manifold. If deemed necessary, walkways and stairways shall be erected in and around the choke manifold. All valves are to be selected for operation in the presence of oil, gas, and drilling fluids. The choke flow line valves and relief line valves connected to the drilling spool and all ram type preventers must be equipped with stem extensions, universal joints if needed, and hand wheels which are to extend beyond the edge of the derrick substructure. All other valves are to be equipped with handles.

\* To include derrick floor mounted controls.

Recd 4-19-93

ET

1000  
1000