

UNITED STATES
DEPARTMENT OF THE INTERIOR
BUREAU OF LAND MANAGEMENT

N.M. OIL CONS. COMMISSION
P.O. BOX 1980
HOBBS, NEW MEXICO 88240

FORM APPROVED
Budget Bureau No. 1004-0135
Expires: March 31, 1993

SUNDRY NOTICES AND REPORTS ON WELLS

Do not use this form for proposals to drill or to deepen or reentry to a different reservoir.
Use "APPLICATION FOR PERMIT—" for such proposals

SUBMIT IN TRIPLICATE

1. Type of Well

☒ Oil Well ☐ Gas Well ☐ Other

2. Name of Operator

MERIDIAN OIL INC.

3. Address and Telephone No.

P.O. BOX 51810 MIDLAND, TEXAS 79710

915-688-6943

4. Location of Well (Footage, Sec., T., R., M., or Survey Description)

SEC. 23, T22S, R32E

Unit J
198D/S & E

5. Lease Designation and Serial No.

NM 81633

6. If Indian, Allottee or Tribe Name

7. If Unit or CA, Agreement Designation

8. Well Name and No.

CHECKERBOARD 23 FEDERAL

9. API Well No.

30-025-31906

10. Field and Pool, or Exploratory Area

11. County or Parish, State

LEA COUNTY, NM

12. CHECK APPROPRIATE BOX(S) TO INDICATE NATURE OF NOTICE, REPORT, OR OTHER DATA

TYPE OF SUBMISSION

- ☐ Notice of Intent
☒ Subsequent Report
☐ Final Abandonment Notice

TYPE OF ACTION

- ☐ Abandonment
☐ Recompletion
☐ Plugging Back
☐ Casing Repair
☐ Altering Casing
☒ Other AMEND SURFACE COMMINGLING & MEASUREMENT APPROVAL PERMIT
☐ Change of Plans
☐ New Construction
☐ Non-Routine Fracturing
☐ Water Shut-Off
☐ Conversion to Injection
☐ Dispose Water

(Note: Report results of multiple completion on Well Completion or Recompletion Report and Log form.)

13. Describe Proposed or Completed Operations (Clearly state all pertinent details, and give pertinent dates, including estimated date of starting any proposed work. If well is directionally drilled, give subsurface locations and measured and true vertical depths for all markers and zones pertinent to this work.)*

APPLICATION TO AMEND SURFACE COMMINGLING AND MEASUREMENT APPROVAL OF HYDROCARBON PRODUCTION FROM THE WEST RED TANK DELAWARE POOL AND THE RED TANK BONE SPRING POOL ON FEDERAL LEASE NO. NM 81633, CHECKERBOARD 23 FEDERAL LEASE.

SEE ATTACHED FORMAT

RECEIVED
DEC 21 10 45 AM '93

14. I hereby certify that the foregoing is true and correct

Signed

Donna Williams

Title

Production Assistant

Date 12/20/93

(This space for Federal or State office use)

Approved by Orig. Signed by Adam Salemah

Title

Petroleum Engineer

Date 12/23/93

Conditions of approval, if any: Subject to

ASL approval

By State

Title 18 U.S.C. Section 1001, makes it a crime for any person knowingly and willfully to make to any department or agency of the United States any false, fictitious or fraudulent statements or representations as to any matter within its jurisdiction.

*See instruction on Reverse Side

APPLICATION FOR SURFACE COMMINGLING AND MEASUREMENT APPROVAL FOR TWO POOLS ON THE SAME LEASE.

**TO: BUREAU OF LAND MANAGEMENT
P.O. BOX 1778
CARLSBAD, NEW MEXICO 88221-1778**

MERIDIAN OIL INC. IS REQUESTING APPROVAL FOR SURFACE COMMINGLING AND MEASUREMENT OF HYDROCARBON PRODUCTION FROM THE WEST RED TANK DELAWARE POOL AND THE RED TANK BONE SPRING POOL ON LEASE NO. NM 81633; CHECKERBOARD 23 FEDERAL LEASE IN LEA COUNTY, NEW MEXICO.

<u>WELL NO.</u>	<u>LOC.</u>	<u>SEC.</u>	<u>TWP.</u>	<u>RNG.</u>	<u>FORMATION</u>
1	J	23	22S	32E	DELAWARE
2	O	23	22S	32E	BONE SPRING
3	F	23	22S	32E	DELAWARE
4 (PROPOSED)	C	23	22S	32E	BONE SPRING
5 (PROPOSED)	L	23	22S	32E	BONE SPRING
6 (PROPOSED)	M	23	22S	32E	BONE SPRING

PRODUCTION FROM THE WELLS INVOLVED IS AS FOLLOWS:

<u>WELL NAME AND NO.</u>	<u>BOPD</u>	<u>OIL GRAVITY</u>	<u>MCFPD</u>
CHECKERBOARD 23 FED # 1	230	39.1	230
CHECKERBOARD 23 FED # 2	92	45.0	190
CHECKERBOARD 23 FED # 3	100	39.1	200
CHECKERBOARD 23 FED # 4 (PRO)	100	45.0	190
CHECKERBOARD 23 FED # 5 (PRO)	100	45.0	190
CHECKERBOARD 23 FED # 6 (PRO)	100	45.0	190

THE PROPOSED OPERATION IS DESCRIBED IN DETAIL ON THE ATTACHED DIAGRAM.

A MAP IS ENCLOSED SHOWING THE LEASE NUMBER AND LOCATION OF ALL WELLS THAT WILL CONTRIBUTE PRODUCTION TO THE PROPOSED COMMINGLING/COMMON STORAGE FACILITY. ALL UNITIZED/COMMUNITIZED AREAS, PRODUCING ZONES/POOLS ARE ALSO CLEARLY ILLUSTRATED.

A SCHEMATIC DIAGRAM IS ALSO ATTACHED WHICH CLEARLY IDENTIFIES ALL EQUIPMENT THAT WILL BE UTILIZED.

THE STORAGE AND MEASURING FACILITY IS LOCATED AT THE SW4/SE4 OF SEC. 23, T22S, R32E ON LEASE NO NM 81633, LEA COUNTY, NEW MEXICO. THE BLM WILL BE NOTIFIED IF THERE IS ANY FUTURE CHANGE IN THE FACILITY LOCATION.

DETAILS OF THE PROPOSED METHOD FOR ALLOCATING PRODUCTION TO CONTRIBUTING SOURCES IS AS FOLLOWS:

**WELL NO. 1 OIL AND GAS WILL BE METERED
WELL NO. 2 OIL WILL BE METERED AND GAS WILL BE CALCULATED
WELL NO. 3 OIL AND GAS WILL BE METERED WITH THE # 1 AND ALLOCATED BY WELL TESTS
WELL NO. 4 OIL WILL BE METERED AND GAS WILL BE CALCULATED
WELL NO. 5 OIL WILL BE METERED AND GAS WILL BE CALCULATED
WELL NO. 6 OIL WILL BE METERED AND GAS WILL BE CALCULATED**

EACH WELL HAS ITS OWN 3-PHASE HEATER TREATER. BOTH TREATERS ARE EQUIPPED WITH HALLIBURTON'S TURBINE FLOW METERS ON THE OIL DUMPS AND WATER DUMPS TO CONTINUOUSLY MEASURE THE OIL AND WATER VOLUMES FOR EACH WELL. WELL NO. 1 IS ALSO EQUIPPED WITH AN ORIFICE TEST METER TO MEASURE THE GAS VOLUMES. WELL NO. 2, 4, 5 & 6 GAS VOLUMES WILL BE CALCULATED BY SUBTRACTING THE VOLUME FOR WELL NO. 1 FROM THE TOTAL LEASE SALES VOLUME. WELL NO 3 IS COMMINGLED WITH WELL NO. 1 AND WILL BE ALLOCATED BY MONTHLY WELL TESTS.

THE WORKING INTEREST OWNERS HAVE BEEN NOTIFIED OF THE PROPOSAL.

THE PROPOSED COMMINGLING OF PRODUCTION IS IN THE INTEREST OF CONSERVATION AND WILL NOT RESULT IN REDUCED ROYALTY OR IMPROPER MEASUREMENT OF PRODUCTION.

THE PROPOSED COMMINGLING IS NECESSARY FOR CONTINUED OPERATION OF THE ABOVE REFERENCED FEDERAL LEASE.

WE UNDERSTAND THAT THE REQUESTED APPROVAL WILL NOT CONSTITUTE THE GRANTING OF ANY RIGHT OF WAY OR CONSTRUCTION RIGHTS NOT GRANTED BY THE LEASE INSTRUMENT. AND, WE WILL SUBMIT WITHIN 30 DAYS AN APPLICATION FOR RIGHT OF WAY APPROVAL TO THE BLM'S REALTY SECTION IN YOUR OFFICE IF WE HAVE NOT ALREADY DONE SO.

SIGNATURE:

NAME:

TITLE:

DATE:

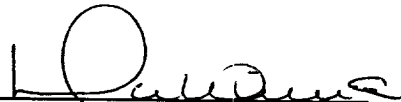
Donna Williams
Production Assistant
December 20, 1993

MERIDIAN OIL INC.
CHECKERBOARD 23 FEDERAL LEASE
LEASE NO. NM-81633
SEC. 23, T-22-S, R-32-E
LEA COUNTY, NEW MEXICO

LEASE DESCRIPTION: 560 ACRES IN LEASE
ALL OF SECTION 23 EXCEPT FOR THE E/2 OF THE SE/4

WEST RED TANK DELAWARE POOL AND RED TANK BONE SPRING POOL

WELL NO. 1, J, 1980' FSL & 1980' FEL
WELL NO. 2, O, 330' FSL & 1650' FEL
WELL NO. 3, F, 2310' FNL & 2295' FWL

WELL NO. 4, C, 990' FNL & 1980' FWL
WELL NO. 5, L, 990' FWL & 2310' FSL
WELL NO. 6, M, 403' FWL & 879' FSL

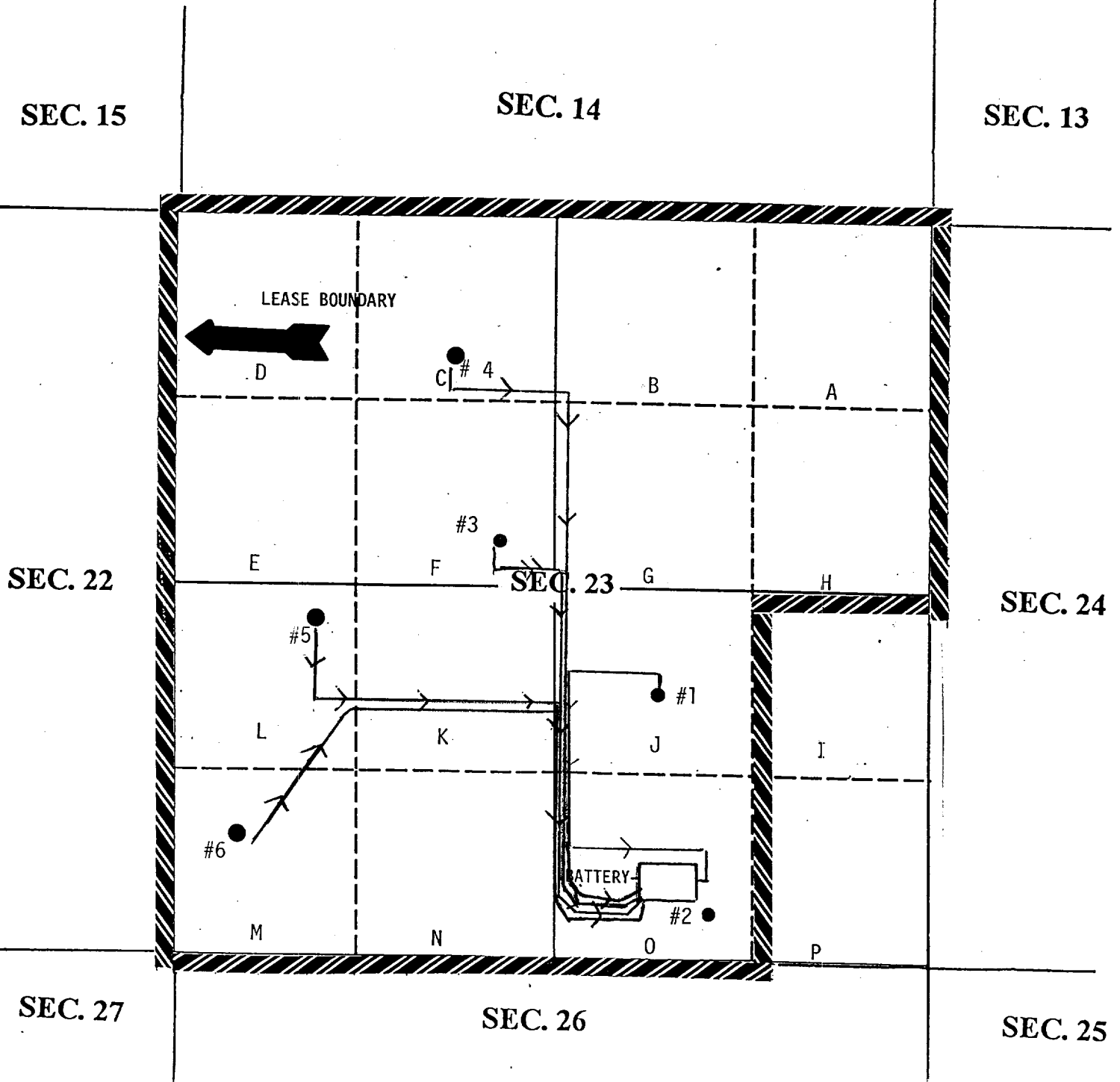

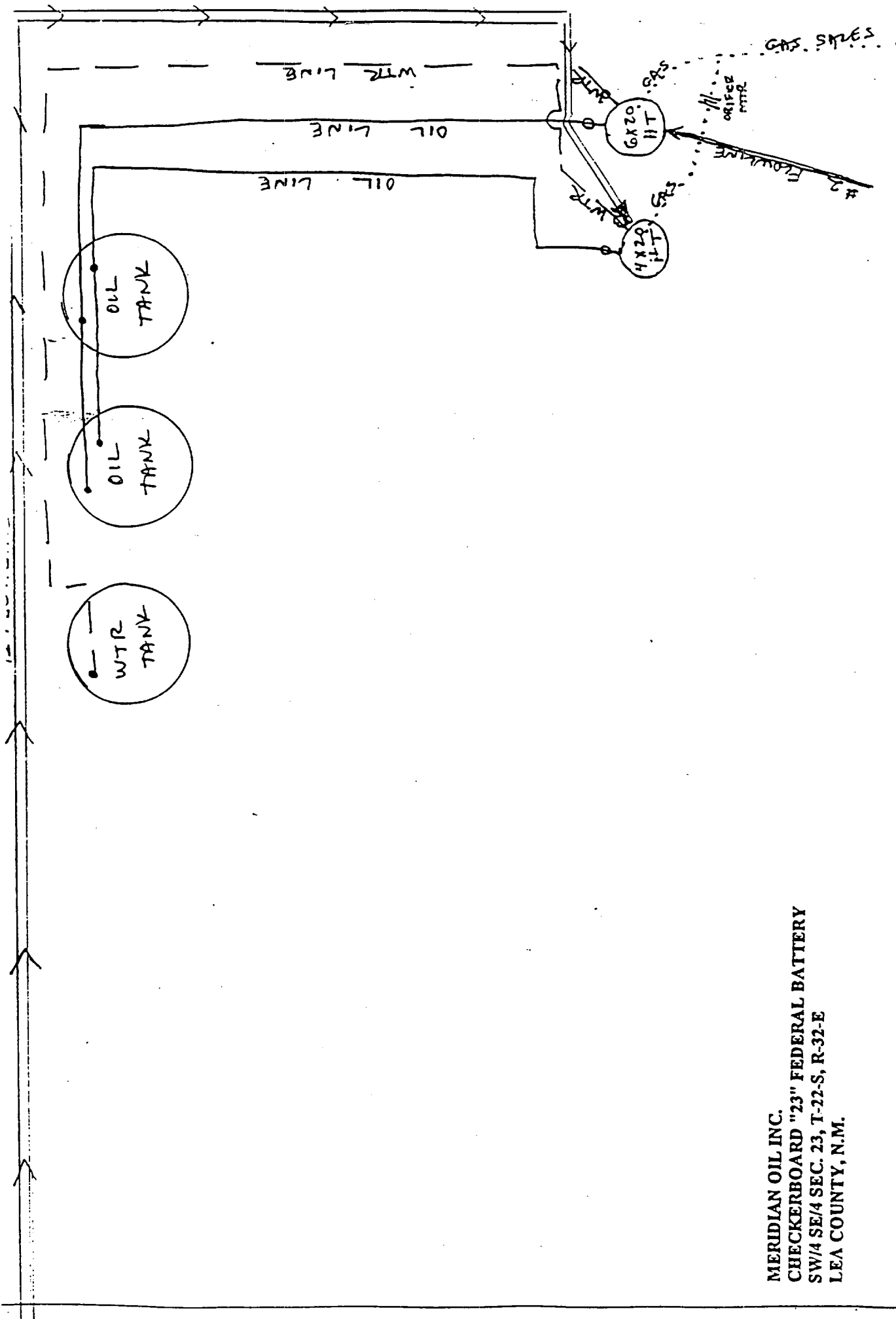

MERIDIAN OIL INC.
 CHECKERBOARD "23" FEDERAL BATTERY
 SW/4 SE/4 SEC. 23, T-22-S, R-32-E
 LEA COUNTY, N.M.

(NOT TO SCALE)

100' 0" 100' 0" 100' 0" 100' 0"
 100' 0" 100' 0" 100' 0" 100' 0"
 100' 0" 100' 0" 100' 0" 100' 0"
 100' 0" 100' 0" 100' 0" 100' 0"

100' 0" 100' 0" 100' 0" 100' 0"
 100' 0" 100' 0" 100' 0" 100' 0"
 100' 0" 100' 0" 100' 0" 100' 0"
 100' 0" 100' 0" 100' 0" 100' 0"

N.M. OIL CONS. COMMISSION
P.O. BOX 1980
HOBBS, NEW MEXICO 88240

Form 3160-5
(June 1990)

UNITED STATES
DEPARTMENT OF THE INTERIOR
BUREAU OF LAND MANAGEMENT

FORM APPROVED
Budget Bureau No. 1004-0135
Expires: March 31, 1993

SUNDRY NOTICES AND REPORTS ON WELLS

Do not use this form for proposals to drill or to deepen or reentry to a different reservoir.
Use "APPLICATION FOR PERMIT—" for such proposals

5. Lease Designation and Serial No.

NM 81633

6. If Indian, Allottee or Tribe Name

7. If Unit or CA, Agreement Designation

8. Well Name and No. #1
CHECKERBOARD 23 FEDERAL

9. API Well No.
30-025-31906

10. Field and Pool, or Exploratory Area

11. County or Parish, State
LEA COUNTY, NM

SUBMIT IN TRIPLICATE

1. Type of Well

☒ Oil Well ☐ Gas Well ☐ Other

2. Name of Operator

MERIDIAN OIL INC.

3. Address and Telephone No.

P.O. BOX 51810 MIDLAND, TEXAS 79710 915-683-6943

4. Location of Well (Footage, Sec., T., R., M., or Survey Description)

SEC. 23, T22S, R32E Unit J
1980/SE

12. CHECK APPROPRIATE BOX(s) TO INDICATE NATURE OF NOTICE, REPORT, OR OTHER DATA

TYPE OF SUBMISSION

- ☒ Notice of Intent
☐ Subsequent Report
☐ Final Abandonment Notice

TYPE OF ACTION

- ☐ Abandonment
☐ Recompletion
☐ Plugging Back
☐ Casing Repair
☐ Altering Casing
☒ Other SURFACE COMMINGLING & MEASUREMENT APPROVAL
☐ Change of Plans
☐ New Construction
☐ Non-Routine Fracturing
☐ Water Shut-Off
☐ Conversion to Injection
☐ Dispose Water

(Note: Report results of multiple completion on Well Completion or Recompletion Report and Log form.)

13. Describe Proposed or Completed Operations (Clearly state all pertinent details, and give pertinent dates, including estimated date of starting any proposed work. If well is directionally drilled, give subsurface locations and measured and true vertical depths for all markers and zones pertinent to this work.)*

APPLICATION FOR SURFACE COMMINGLING AND MEASUREMENT APPROVAL OF HYDROCARBON PRODUCTION FROM THE WEST RED TANK DELAWARE POOL AND THE RED TANK BONE SPRING POOL ON FEDERAL LEASE NO. NM 81633; CHECKERBOARD 23 FEDERAL LEASE.

SEE ATTACHED FORMAT

14. I hereby certify that the foregoing is true and correct

Signed Donna Williams

Title PRODUCTION ASSISTANT

Date 12/17/93

(This space for Federal or State office use)

Orig. Signed by Adam Salameh

Title Petroleum Engineer

Date 12/23/93

Approved by State
Conditions of approval, if any: State

Like Approval
By State

Title 18 U.S.C. Section 1001, makes it a crime for any person knowingly and willfully to make to any department or agency of the United States any false, fictitious or fraudulent statements or representations as to any matter within its jurisdiction.

*See Instruction on Reverse Side

APPLICATION FOR SURFACE COMMINGLING AND MEASUREMENT APPROVAL FOR TWO POOLS WITHIN THE SAME LEASE.

**TO: BUREAU OF LAND MANAGEMENT
P.O. BOX 1778
CARLSBAD, NEW MEXICO 88221-1778**

MERIDIAN OIL INC., IS REQUESTING APPROVAL FOR SURFACE COMMINGLING AND MEASUREMENT OF HYDROCARBON PRODUCTION FROM THE WEST RED TANK DELAWARE POOL AND THE RED TANK BONE SPRING POOL ON LEASE NO. NM 81633; CHECKERBOARD 23 FEDERAL LEASE IN LEA COUNTY, NM.

<u>WELL NO.</u>	<u>LOC.</u>	<u>SEC.</u>	<u>TWP.</u>	<u>RNG.</u>	<u>FORMATION</u>
1	J	23	22S	32E	DELAWARE
2	O	23	22S	32E	BONE SPRING
3	F	23	22S	32E	DELAWARE

PRODUCTION FROM THE WELLS INVOLVED IS AS FOLLOWS:

<u>WELL NAME AND NO.</u>	<u>BOPD</u>	<u>OIL GRAVITY</u>	<u>MCFPD</u>
CHECKERBOARD 23 FED. # 1	230	39.1	230
CHECKERBOARD 23 FED. # 2	92	45.0	190
CHECKERBOARD 23 FED. # 3	100	39.1	200

THE PROPOSED OPERATION IS DESCRIBED IN DETAIL ON THE ATTACHED DIAGRAM.

A MAP IS ENCLOSED SHOWING THE LEASE NUMBER AND LOCATION OF ALL WELLS THAT WILL CONTRIBUTE PRODUCTION TO THE PROPOSED COMMINGLING/COMMON STORAGE FACILITY. ALL UNITIZED/COMMUNITIZED AREAS, PRODUCING ZONES/POOLS ARE ALSO CLEARLY ILLUSTRATED.

A SCHEMATIC DIAGRAM IS ALSO ATTACHED WHICH CLEARLY IDENTIFIES ALL EQUIPMENT THAT WILL BE UTILIZED.

THE STORAGE AND MEASURING FACILITY IS LOCATED AT THE SW4/SE4 OF SEC. 23, T22S, R32E, ON LEASE NO. NM-81633, LEA COUNTY, NEW MEXICO. THE BLM WILL BE NOTIFIED IF THERE IS ANY FUTURE CHANGE IN THE FACILITY LOCATION.

DETAILS OF THE PROPOSED METHOD FOR ALLOCATING PRODUCTION TO CONTRIBUTING SOURCES IS AS FOLLOWS:

WELL NO. 1 OIL AND GAS WILL BE METERED.

WELL NO. 2 OIL WILL BE METERED AND GAS WILL BE CALCULATED.

WELL NO. 3 OIL AND GAS WILL BE METERED WITH THE # 1 AND ALLOCATED BY WELL TESTS.

EACH WELL HAS ITS OWN 3-PHASE HEATER TREATER. BOTH TREATERS ARE EQUIPPED WITH HALLIBURTON'S TURBINE FLOW METERS ON THE OIL DUMPS AND WATER DUMPS TO CONTINUOUSLY MEASURE THE OIL AND WATER VOLUMES FOR EACH WELL. WELL NO. 1 IS ALSO EQUIPPED WITH AN ORIFICE TEST METER TO MEASURE THE GAS VOLUMES. WELL NO. 2 GAS VOLUME WILL BE CALCULATED BY SUBTRACTING THE VOLUME FOR WELL NO. 1 FROM THE TOTAL LEASE SALES VOLUME. WELL NO. 3 IS COMMINGLED WITH WELL NO. 1 AND WILL BE ALLOCATED BY MONTHLY WELL TESTS.

THE WORKING INTEREST OWNERS HAVE BEEN NOTIFIED OF THE PROPOSAL.

THE PROPOSED COMMINGLING OF PRODUCTION IS IN THE INTEREST OF CONSERVATION AND WILL NOT RESULT IN REDUCED ROYALTY OR IMPROPER MEASUREMENT OF PRODUCTION.

THE PROPOSED COMMINGLING IS NECESSARY FOR CONTINUED OPERATION OF THE ABOVE REFERENCED FEDERAL LEASE.

WE UNDERSTAND THAT THE REQUESTED APPROVAL WILL NOT CONSTITUTE THE GRANTING OF ANY RIGHT-OF-WAY OR CONSTRUCTION RIGHTS NOT GRANTED BY THE LEASE INSTRUMENT. AND, WE WILL SUBMIT WITHIN 30 DAYS AN APPLICATION FOR RIGHT OF WAY APPROVAL TO THE BLM'S REALTY SECTION IN YOUR OFFICE IF WE HAVE NOT ALREADY DONE SO.

SIGNATURE: 

NAME: Donna Williams

TITLE: Production Assistant

DATE: December 17, 1993

MERIDIAN OIL INC.

CHECKERBOARD 23 FEDERAL LEASE

LEASE NO. NM-81633

SEC. 23, T-22-S, R-32-E

LEA COUNTY, NEW MEXICO

LEASE DESCRIPTION: 560 ACRES IN LEASE

ALL OF SECTION 23 EXCEPT FOR THE E/2 OF THE SE/4

WEST RED TANK DELAWARE POOL AND RED TANK BONE SPRING POOL

WELL NO. 1, J, 1980' FSL & 1980' FEL

WELL NO. 2, O, 330' FSL & 1650' FEL

WELL NO. 3, F, 2310' FNL & 2295' FWL

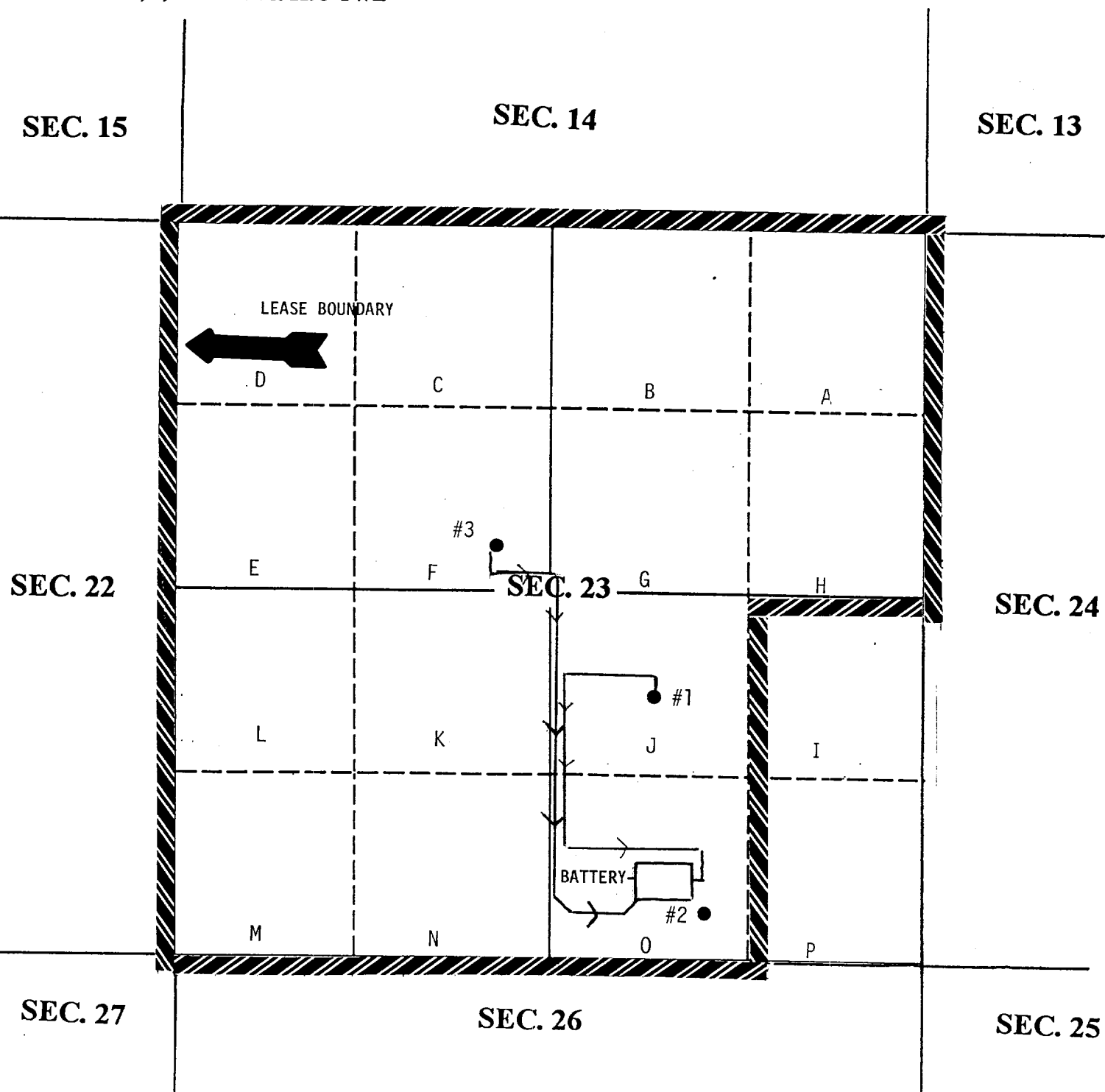

**MERIDIAN OIL INC.
CHECKERBOARD "23" FEDERAL BATTERY
SW/4 SE/4 SEC. 23, T-22-S, R-32-E
LEA COUNTY, N.M.**

(NOT TO SCALE)

