

UNITED STATES
DEPARTMENT OF THE INTERIOR
BUREAU OF LAND MANAGEMENT

SUBMIT IN TRIPLICATE*
(Other instructions on
reverse side)

Form approved.
Budget Bureau No. 1004-0136
Expires: December 31, 1991

APPLICATION FOR PERMIT TO DRILL OR DEEPEN

1a. TYPE OF WORK

DRILL ☐

DEEPEN ☐

b. TYPE OF WELL

OIL
WELL ☒

GAS
WELL ☐

OTHER

SINGLE
ZONE ☐

MULTIPLE
ZONE ☐

2. NAME OF OPERATOR

Meridian Oil Inc.

3. ADDRESS AND TELEPHONE NO.

P.O. Box 51810, Midland, TX 79710-1810

4. LOCATION OF WELL (Report location clearly and in accordance with any State requirements.)*

At surface

0, 330 FSL & 1650 FEL

At proposed prod. zone

14. DISTANCE IN MILES AND DIRECTION FROM NEAREST TOWN OR POST OFFICE*

28 miles West of Eunice, New Mexico

15. DISTANCE FROM PROPOSED*

LOCATION TO NEAREST

PROPERTY OR LEASE LINE, FT.

(Also to nearest drig. unit line, if any)

330'

16. NO. OF ACRES IN LEASE

920

17. NO. OF ACRES ASSIGNED
TO THIS WELL

40

18. DISTANCE FROM PROPOSED LOCATION*

TO NEAREST WELL, DRILLING, COMPLETED,
OR APPLIED FOR, ON THIS LEASE, FT.

19. PROPOSED DEPTH

10,050'

20. ROTARY OR CABLE TOOLS

rotary

21. ELEVATIONS (Show whether DF, RT, GR, etc.)

3729.9'

22. APPROX. DATE WORK WILL START*

1-29-92

23.

PROPOSED CASING AND CEMENTING PROGRAM

SIZE OF HOLE	GRADE SIZE OF CASING	WEIGHT PER FOOT	SETTING DEPTH	QUANTITY OF CEMENT
17 1/2"	13 3/8", H-40	48	850'	925 SX CIRCULATE
12 1/4"	8 5/8", K-55	28&32	4600'	2150 SX (tie back)
7 7/8"	5 1/2", K-55 N-80	17	10050'	1180 SX (tie back)

APPROVAL SUBJECT TO
GENERAL REQUIREMENTS AND
SPECIAL STIPULATIONS
ATTACHED

IN ABOVE SPACE DESCRIBE PROPOSED PROGRAM: If proposal is to deepen, give data on present productive zone and proposed new productive zone. If proposal is to drill or deepen directionally, give pertinent data on subsurface locations and measured and true vertical depths. Give blowout preventer program, if any.

24.

SIGNED

La W...

TITLE Production Assistant

DATE

1-14-93

(This space for Federal or State office use)

PERMIT NO.

APPROVAL DATE

Application approval does not warrant or certify that the applicant holds legal or equitable title to those rights in the subject lease which would entitle the applicant to conduct operations thereon.
CONDITIONS OF APPROVAL, IF ANY:

Orig. Signed by Richard...

APPROVED BY

TITLE

DATE

2/23/93

*See Instructions On Reverse Side

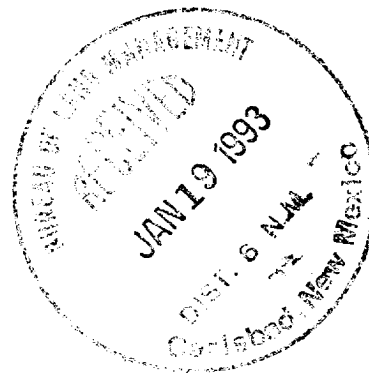

Submit to Appropriate
District Office
State Lease - 4 copies
Fee Lease - 3 copies

State of New Mexico
Energy, Minerals and Natural Resources Department

Form C-102
Revised 1-1-89

OIL CONSERVATION DIVISION

P.O. Box 2088
Santa Fe, New Mexico 87504-2088

DISTRICT I

P.O. Box 1980, Hobbs, NM 88240

DISTRICT II

P.O. Drawer DD, Artesia, NM 88210

DISTRICT III

1000 Rio Braxos Rd., Aztec, NM 87410

WELL LOCATION AND ACREAGE DEDICATION PLAT

All Distances must be from the outer boundaries of the section

Operator MERIDIAN OIL INC.		Lease CHECKERBOARD "23" FEDERAL		Well No. 2
Unit Letter O	Section 23	Township 22 SOUTH	Range 32 EAST NMPM	County LEA
Actual Footage Location of Well: 330 feet from the SOUTH line and 1650 feet from the EAST line				
Ground Level Elev. 3729.9'	Producing Formation Wildcat BONE SPRING	Pool Red Tank Bone Spring Wildcat	Dedicated Acreage: 40 Acres	

- Outline the acreage dedicated to the subject well by colored pencil or hachure marks on the plat below.
- If more than one lease is dedicated to the well, outline each and identify the ownership thereof (both as to working interest and royalty).
- If more than one lease of different ownership is dedicated to the well, have the interest of all owners been consolidated by communitization, unitization, force-pooling, etc.?
☐ Yes ☐ No If answer is "yes" type of consolidation _____

If answer is "no" list of owners and tract descriptions which have actually been consolidated. (Use reverse side of this form necessary.)

No allowable will be assigned to the well unit all interests have been consolidated (by communitization, unitization, forced-pooling, otherwise) or until a non-standard unit, eliminating such interest, has been approved by the Division.

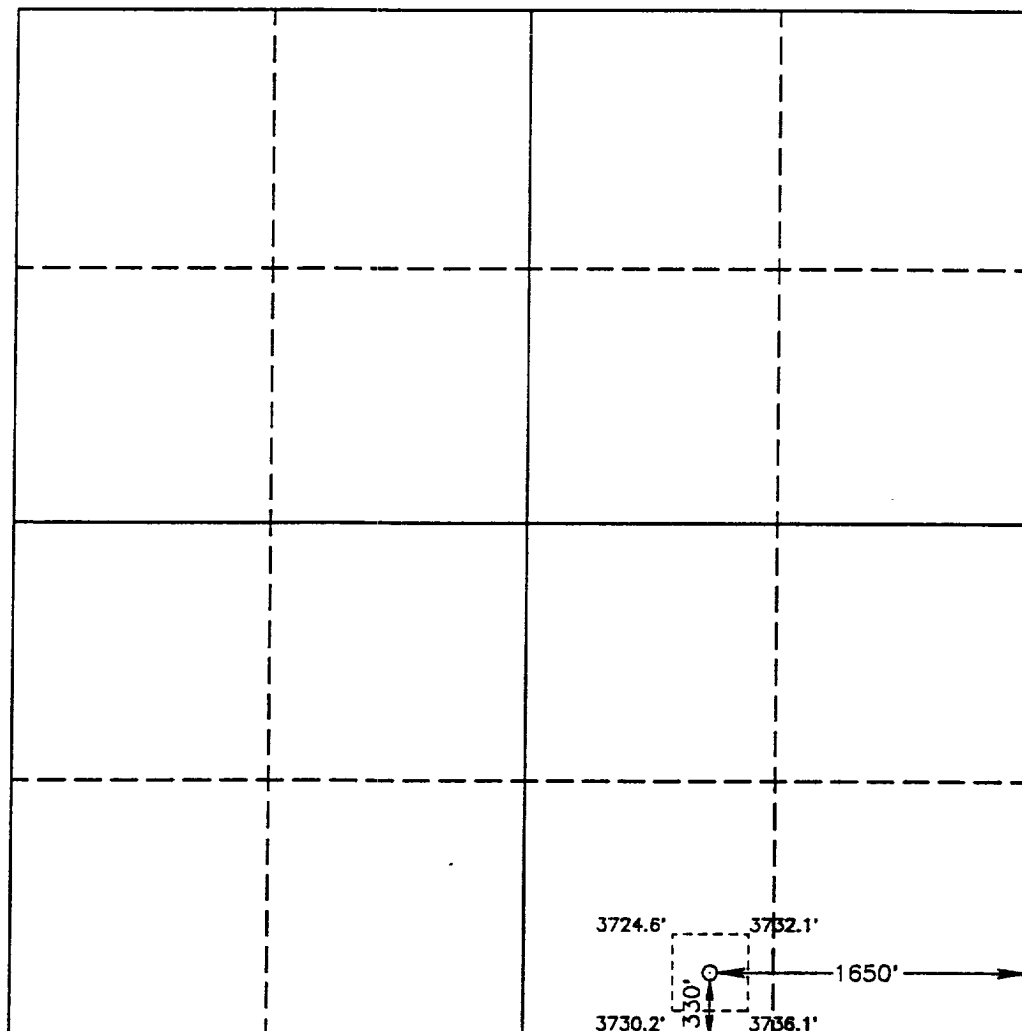

OPERATOR CERTIFICATION

I hereby certify the the information
contained herein is true and complete to the
best of my knowledge and belief.

Donna Williams

Signature

Donna Williams

Printed Name

Production Assistant

Position

Meridian Oil Inc.

Company

1/14/93

Date

SURVEYOR CERTIFICATION

I hereby certify that the well location shown
on this plat was plotted from field notes of
actual surveys made by me or under my
supervision, and that the same is true and
correct to the best of my knowledge and
belief.

Date Surveyed

NOVEMBER 28, 1992

Signature & Seal of
Professional Surveyor

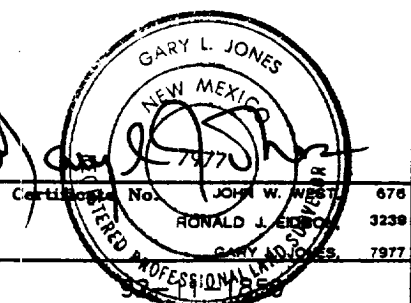

OPERATORS NAME:	MERIDIAN OIL INC.
LEASE NAME AND WELL NO.:	CHECKERBOARD "23" FEDERAL #2
LOCATION:	UNIT O, 330' FSL& 1650' FEL, SEC. 23, T22S, R32E
FIELD NAME:	EAST LIVINGSTON RIDGE/WILDCAT
COUNTY:	LEA COUNTY, NM
LEASE NUMBER:	NM-81633

The following information is to supplement BLM form 3160-3 Application for permit to deepen in accordance with Onshore Oil and Gas Order No. 1:

9 - POINT DRILLING PLAN

1. Name and estimated tops of important geologic formation/marker horizons.

Rustler	900'	Delaware Lime	4700"
B/Salt	4500'	Bone Springs	3650'
Cherry Canyon	5700'	Brushy Canyon	7450'

2. Estimated depths at which the top and bottom of formations potentially containing usable water, oil, gas, or prospectively valuable deposits of other minerals are expected to be encountered and the operator's plans for protecting such resources.

Bone Springs 8650'-10050'(Oil)

3. The operator's minimum specifications for Blowout Preventer (BOP) and related equipment to be used and schematic diagrams thereof showing sizes, pressure ratings, and the testing procedures and testing frequency. BOP and BOP - related equipment (BOPE) schematics shall include schematics of choke manifold equipment. Accumulator systems and remote controls shall be utilized.

$13\frac{3}{8}"$ 

10" - 3M BOP stack to be installed on the ~~8 5/8"~~ csg & left for the remainder of drlg. Tested to 1500 psi before drlg the 8 5/8" casing shoe. The BOP stack will consist of one blind ram BOP & one pipe ram BOP, and one annular BOP.

4. The proposed casing program including size, grade, weights, type of thread and coupling, and the setting depth of each string and its condition (new or acceptably reconditioned). For exploratory wells, or for wells as otherwise specified by the authorized officer, the operator shall include the minimum design factors for tensions, burst, and collapse that are incorporated into the casing design. In cases where tapered casing strings are utilized, the operator shall also include and/or setting depths of each portion.

DOUBLE RAM & Annular

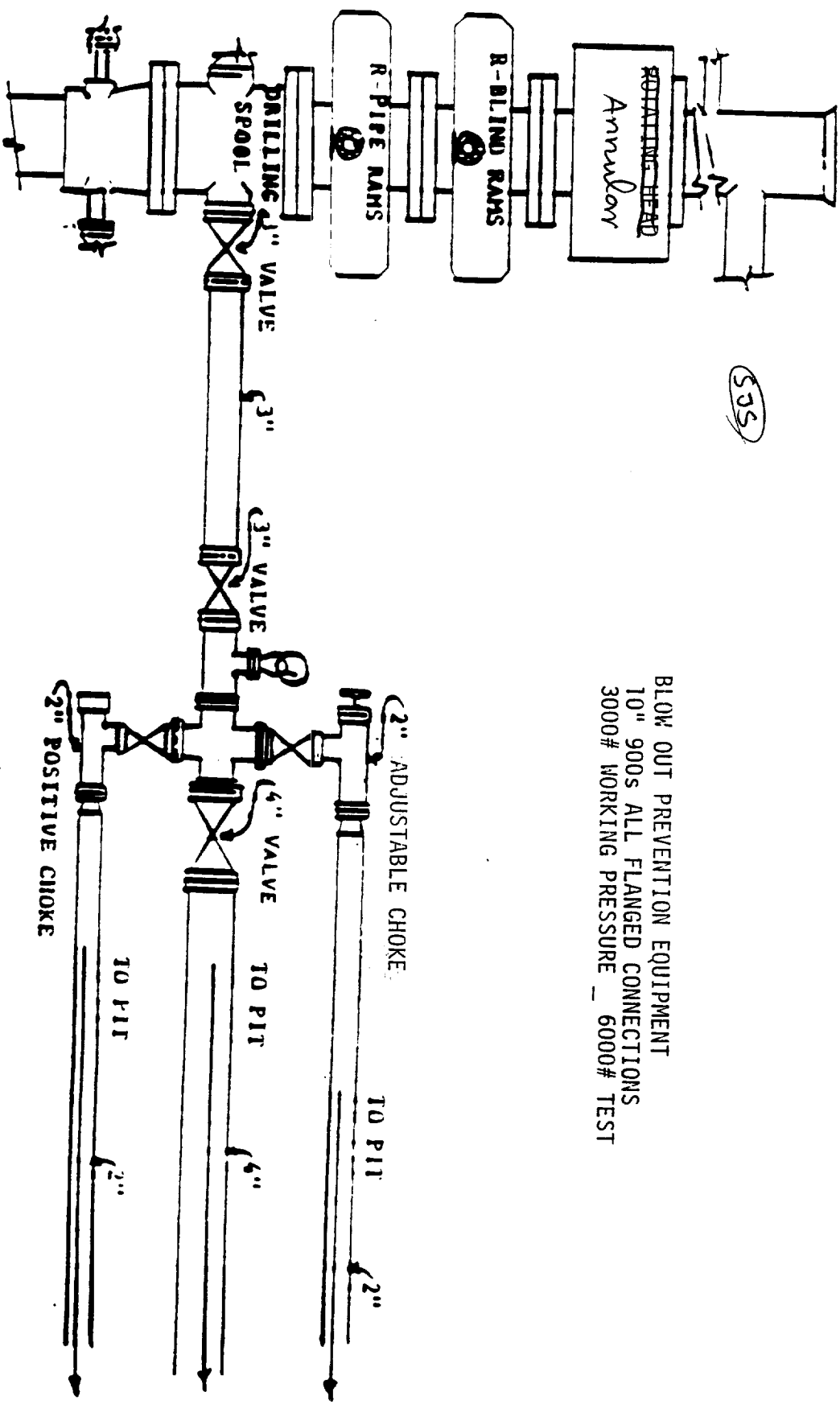

535

BLOW OUT PREVENTION EQUIPMENT
 10" 900S ALL FLANGED CONNECTIONS
 3000# WORKING PRESSURE _ 6000# TEST