

GRID ELEVATIONS

JOHN D. JAGUESS & ASSOCIATES

CONSULTING ENGINEERS

NO GRID STAKED DUE TO STATE LOCATION

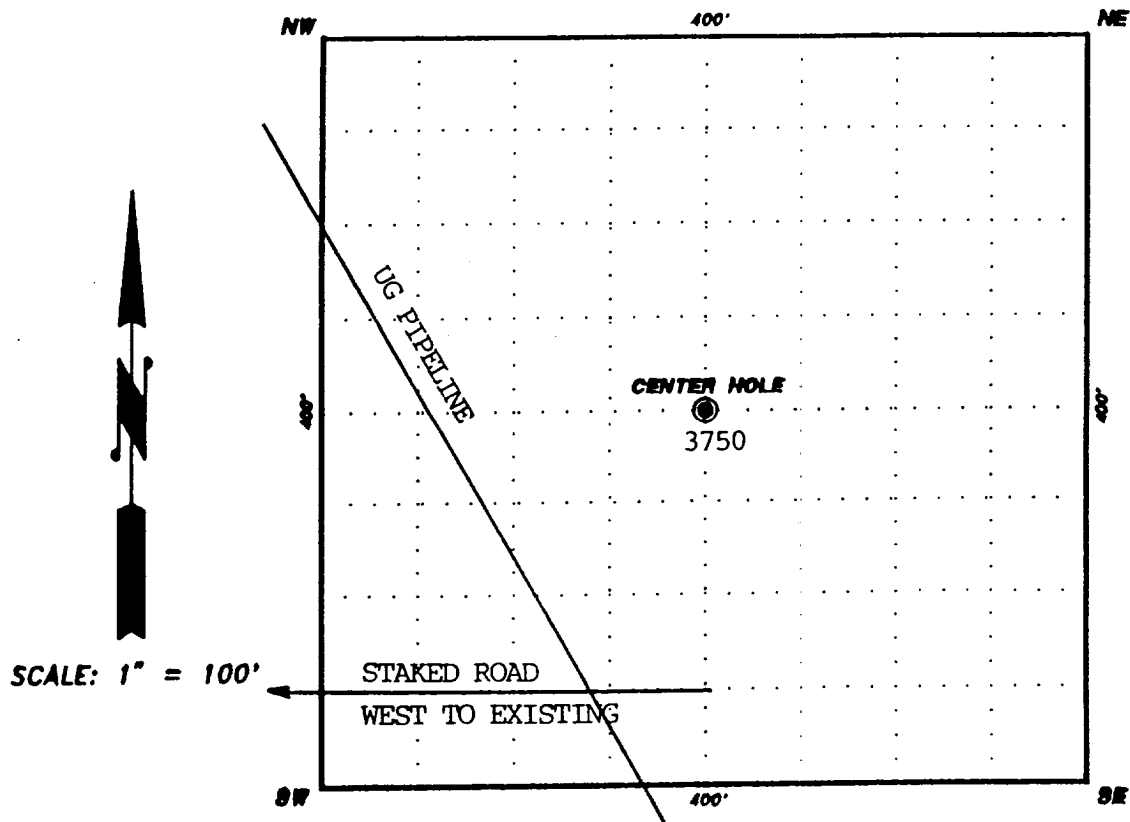

WELL INFORMATION

BIGHORN 30 STATE #3
2310 FSL, 330 FWL
SECTION 30, T.22S., R.33E.
LEA COUNTY, NEW MEXICO