

UNITED STATES
DEPARTMENT OF THE INTERIOR
BUREAU OF LAND MANAGEMENT

SUBMITTED BY: **N.M. O. CONS. COMMISSION**
(Other instructions on Form 3160-3)
P.O. BOX 1980
HOBBS, NEW MEXICO 88240
Budget Bureau No. 1004-0136
Expires August 31, 1985

APPLICATION FOR PERMIT TO DRILL, DEEPEN, OR PLUG BACK

1a. TYPE OF WORK

DRILL ☒

DEEPEN ☐

PLUG BACK ☐

b. TYPE OF WELL

OIL WELL ☐

GAS WELL ☒

OTHER

SINGLE ZONE ☒

MULTIPLE ZONE ☐

2. NAME OF OPERATOR

POGO PRODUCING COMPANY

3. ADDRESS OF OPERATOR

P. O. BOX 10340, MIDLAND, TEXAS 79702

4. LOCATION OF WELL (Report location clearly and in accordance with any State requirements.)*

At surface

1980' FNL AND 660' FWL OF SECTION 35

At proposed prod. zone

UNIT E

14. DISTANCE IN MILES AND DIRECTION FROM NEAREST TOWN OR POST OFFICE*

30 MILES WEST OF EUNICE, NEW MEXICO

10. DISTANCE FROM PROPOSED* LOCATION TO NEAREST PROPERTY OR LEASE LINE, FT. (Also to nearest drig. unit line, if any)

660'

16. NO. OF ACRES IN LEASE

320

17. NO. OF ACRES ASSIGNED TO THIS WELL

320

18. DISTANCE FROM PROPOSED LOCATION* TO NEAREST WELL, DRILLING, COMPLETED, OR APPLIED FOR, ON THIS LEASE, FT.

--

19. PROPOSED DEPTH

15,500'

20. ROTARY OR CABLE TOOLS

ROTARY

21. ELEVATIONS (Show whether DF, RT, GR, etc.)

3707.8' GR

Carlsbad Central and Water Basin

22. APPROX. DATE WORK WILL START*

UPON APPROVAL

23. PROPOSED CASING AND CEMENTING PROGRAM

SIZE OF HOLE	SIZE OF CASING	WEIGHT PER FOOT	SETTING DEPTH	QUANTITY OF CEMENT
17-1/2"	13-3/8"	54.5#	850'	SUFFICIENT TO CIRCULATE
12-1/4"	9-5/8"	43.5#	4550'	SUFFICIENT TO CIRCULATE
8-1/2"	7"	29#	12,500'	1100 SACKS - TO TIE BACK
6-1/8"	5" LINER	18#	12,200'-15,500'	325 SACKS

AFTER SETTING PRODUCTION CASING, PAY ZONE WILL BE PERFORATED AND STIMULATED AS NECESSARY.

SEE ATTACHED FOR: SUPPLEMENTAL DRILLING DATA
BOP SKETCHES
SURFACE USE AND OPERATIONS PLAN

Approval Subject to
General Requirements and
Special Regulations
APR 1993

IN ABOVE SPACE DESCRIBE PROPOSED PROGRAM: If proposal is to deepen or plug back, give data on present productive zone and proposed new productive zone. If proposal is to drill or deepen directionally, give pertinent data on subsurface locations and measured and true vertical depths. Give blowout preventer program, if any.

24.

SIGNED

Richard L. Wright

TITLE Division Operations Mgr.

DATE Sept. 15, 1993

(This space for Federal or State office use)

PERMIT NO.

APPROVAL DATE

Ron Dunton

TITLE AREA MANAGER

DATE OCT 14 1993

APPROVED BY
CONDITIONS OF APPROVAL, IF ANY:

*See Instructions On Reverse Side

OIL CONSERVATION DIVISION

P.O. Box 2088
Santa Fe, New Mexico 87504-2088

DISTRICT I

P.O. Box 1980, Hobbs, NM 88240

DISTRICT II

P.O. Drawer DD, Artesia, NM 88210

DISTRICT III

1000 Rio Brazos Rd., Aztec, NM 87410

WELL LOCATION AND ACREAGE DEDICATION PLAT

All Distances must be from the outer boundaries of the section

Operator POGO PRODUCING CO.			Lease RED TANK "35" FEDERAL		Well No. 2
Unit Letter E	Section 35	Township 22 SOUTH	Range 32 EAST NMPM	County LEA	
Actual Footage Location of Well: 1980 feet from the NORTH line and 660 feet from the WEST line					
Ground Level Elev. 3707.8'	Producing Formation MORROW		Pool WILDCAT	Dedicated Acreage: 320 Acres	

- Outline the acreage dedicated to the subject well by colored pencil or hachure marks on the plat below.
- If more than one lease is dedicated to the well, outline each and identify the ownership thereof (both as to working interest and royalty).
- If more than one lease of different ownership is dedicated to the well, have the interest of all owners been consolidated by communitization, unitization, force-pooling, etc.?
☐ Yes ☐ No If answer is "yes" type of consolidation _____

If answer is "no" list of owners and tract descriptions which have actually been consolidated. (Use reverse side of this form necessary.)

No allowable will be assigned to the well unit all interests have been consolidated (by communitization, unitization, forced-pooling, otherwise) or until a non-standard unit, eliminating such interest, has been approved by the Division.

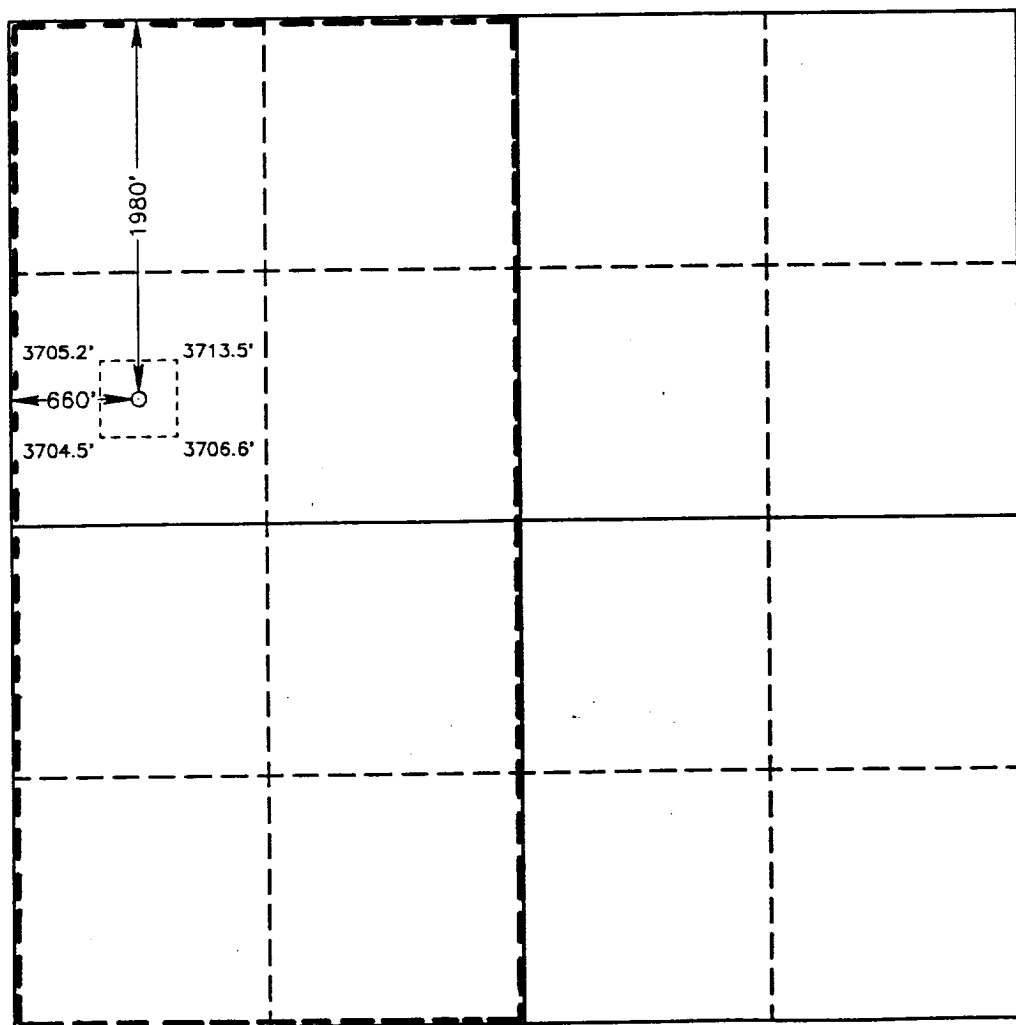

OPERATOR CERTIFICATION

I hereby certify the the information contained herein is true and complete to the best of my knowledge and belief.

Signature: *Richard L. Wright*
Printed Name: Richard L. Wright
Position: Division Operations Mgr.
Company: POGO PRODUCING COMPANY
Date: September 3, 1993

SURVEYOR CERTIFICATION

I hereby certify that the well location shown on this plat was plotted from field notes of actual surveys made by me or under my supervision, and that the same is true and correct to the best of my knowledge and belief.

Date Surveyed: APRIL 26, 1993

Signature & Seal of Professional Surveyor

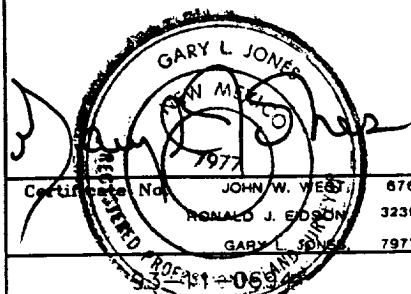

SUPPLEMENTAL DRILLING DATA
POGO PRODUCING COMPANY
RED TANK 35 FEDERAL WELL NO. 2

1. SURFACE FORMATION: Quaternary.

2. ESTIMATED TOPS OF GEOLOGIC MARKERS:

Rustler Anhydrite	800'
Delaware Lime	4800'
Bone Springs	8650'
Wolfcamp	11,800'
Atoka	13,750'
Morrow	14,550'

3. ANTICIPATED POSSIBLE HYDROCARBON BEARING ZONES:

Delaware	Oil
Atoka	Gas
Morrow	Gas

4. PROPOSED CASING AND CEMENTING PROGRAM:

CASING SIZE	SETTING DEPTH		WEIGHT	GRADE	JOINT
	FROM	TO			
13-3/8"	0	850'	54.5#	J-55	STC
9-5/8"	0	4550'	43.5#	N-80	LTC
7"	0	7200'	29#	P-110	LTC
7"	7200'	12,250'	29#	N-80	LTC
7"	12,250'	12,500'	29#	P-110	LTC
5" LINER	12,200'	15,500'	18#	P-110	PREMIUM

MINIMUM

DESIGN FACTORS: COLLAPSE 1.1 BURST 1.1 TENSION 2.2

13-3/8" casing to be cemented with 500 sacks of light cement followed by 200 sacks of Class "C" with 2% CaCl. Cement to circulate.

9-5/8" casing to be cemented with 1200 sacks of light cement with 10% salt followed by 200 sacks of premium cement. Cement to circulate.

7" casing to be cemented with approximately 500 sacks of light cement followed by approximately 600 sacks of premium cement. Cement to tie back 1000 feet into the 9-5/8" casing to 3550 feet.

5" liner to be cemented with 325 sacks of premium cement. Cement to circulate the liner.

If indications are that stage cementing of casing is needed to attain projected cement tops, staging tool(s) will be run and positioned to best suit hole conditions at the time casing is run.

Cement volumes may be adjusted and cement may have lost circulation and/or other additives depending on hole conditions at the time casing is run.

5. PRESSURE CONTROL EQUIPMENT:

Blowout prevention equipment, while drilling below the surface casing will be a 3000 psi working pressure stack.

The BOP stack, while drilling below the first intermediate casing will be a 5000 psi working pressure stack and manifold, and, while drilling below the the second intermediate casing, a 10,000 psi working pressure stack and manifold will be in use.

BOP sketches are attached.

6. CIRCULATING MEDIUM:

Surface to 850 feet: Fresh water gel spud mud. Weight 8.6 to 8.8. Viscosity 34 to 36 as required for hole cleaning.

850 feet to 4550 feet: Brine conditioned as necessary for control of viscosity and seepage. Weight 8.8 to 10. pH 9 to 10. Viscosity 30 to 32.

4550 feet to 12,500 feet: Brine cut with fresh water to adjust weight to control seepage or Wolfcamp pressure. Weight 8.8 to 9.0. Viscosity 28 to 29. pH 9 to 10.

12,500 feet to T.D.: Water base drilling fluid conditioned as necessary for control of viscosity, pH, and water-loss. Weight 12 to 15. Viscosity 40 to 50. pH 9 to 9.5. Filtrate 12 to 5.

7. AUXILIARY EQUIPMENT:

Geolograph from surface to total depth.

Mud logging trailer to be in use below 4550 feet.

8. TESTING, LOGGING, AND CORING PROGRAMS:

Drill stem tests will be run when data indicate a test is warranted.

It is planned that electric logs will include GR-CNL-Density logs and GR-DLL logs.

No coring is planned.

9. ABNORMAL PRESSURES, TEMPERATURES, OR HYDROGEN SULFIDE GAS:

Abnormal gas pressure may be present in the Atoka formation. Maximum expected bottom hole pressure is about 9800 psi.

Bottom hole temperature should be normal. Expected bottom hole temperature is about 210 degrees Fahr.

No hydrogen sulfide gas is expected. The production streams of wells in this area have been tested specifically for hydrogen sulfide gas and results were negative. However, since it is possible that low-volume hydrogen sulfide gas may be present in permeable water zones of the Castile formation, drilling operations below the surface casing will be in accordance with the attached "HYDROGEN SULFIDE DRILLING OPERATIONS PLAN" until intermediate casing is set and cemented and this possible source of hydrogen sulfide gas is cased off.

10. ANTICIPATED STARTING DATE:

It is planned that operations will commence upon approval of this application, with drilling and completion operations lasting about 60 days.

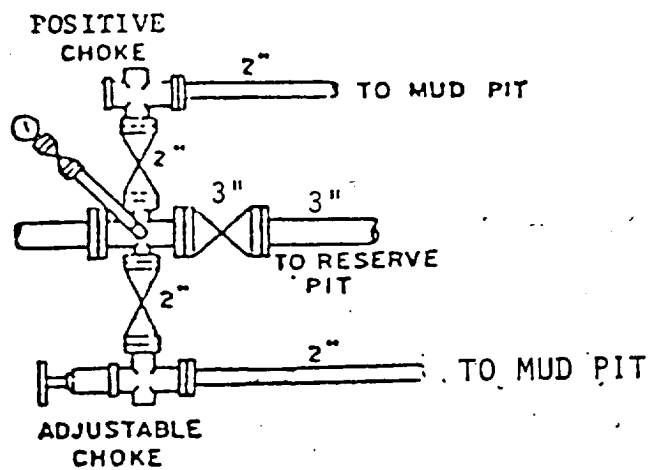
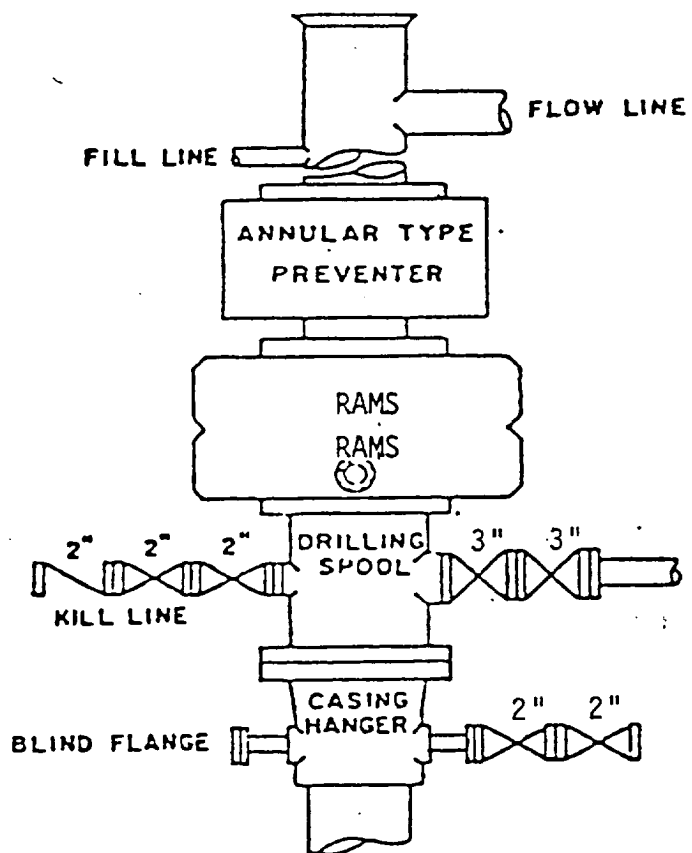

BOP STACK

3000 PSI WORKING PRESSURE

BOP ARRANGEMENT