

UNITED STATES
DEPARTMENT OF THE INTERIOR
BUREAU OF LAND MANAGEMENT

RECEIVED

FORM APPROVED
Budget Bureau No. 1004-0135
Expires: March 31, 1993

SUNDRY NOTICES AND REPORTS ON WELLS

Do not use this form for proposals to drill or to deepen or reentry to a different reservoir.
Use "APPLICATION FOR PERMIT—" for such proposals

SUBMIT IN TRIPLICATE

1. Type of Well

☒ Oil Well ☐ Gas Well ☐ Other

2. Name of Operator

POGO PRODUCING COMPANY

3. Address and Telephone No.

P.O. BOX 10340, MIDLAND, TEXAS 79702 (915-682-6822)

4. Location of Well (Footage, Sec., T., R., M., or Survey Description)

660' FROM SOUTH LINE AND 1980' FROM EAST LINE
OF SECTION 25, T.22 S., R.32 E., NMPM

5. Lease Designation and Serial No.

NM-2379

6. If Indian, Allottee or Tribe Name

7. If Unit or CA, Agreement Designation

8. Well Name and No.

COVINGTON "A" FEDERAL #10

9. API Well No.

30-025-32581

10. Field and Pool, or Exploratory Area UNDES.

RED TANK BONE SPRINGS

11. County or Parish, State

LEA COUNTY, NEW MEXICO

12. CHECK APPROPRIATE BOX(S) TO INDICATE NATURE OF NOTICE, REPORT, OR OTHER DATA

TYPE OF SUBMISSION

☒ Notice of Intent
☐ Subsequent Report
☐ Final Abandonment Notice

TYPE OF ACTION

☐ Abandonment
☐ Recompletion
☐ Plugging Back
☐ Casing Repair
☐ Altering Casing
☒ Other TO AMEND APD TO
CHANGE WELL LOCATION

☐ Change of Plans
☐ New Construction
☐ Non-Routine Fracturing
☐ Water Shut-Off
☐ Conversion to Injection
☐ Dispose Water

(Note: Report results of multiple completion on Well Completion or Recompletion Report and Log form.)

13. Describe Proposed or Completed Operations (Clearly state all pertinent details, and give pertinent dates, including estimated date of starting any proposed work. If well is directionally drilled, give subsurface locations and measured and true vertical depths for all markers and zones pertinent to this work.)*

PROPOSAL IS TO CHANGE THE LOCATION OF THIS PROPOSED WELL -

FROM: 330' FSL AND 2310' FEL OF SECTION 25 AS PROPOSED IN THE APD
TO: 660' FSL AND 1980' FEL OF SECTION 25 AS SET OUT IN ITEM 4 ABOVE.

THE FOLLOWING ITEMS ARE ATTACHED:

1. A REVISED WELL LOCATION AND ACREAGE DEDICATION PLAT.
2. A PLAT SHOWING THE ACCESS ROUTE AND PLANNED NEW ROAD EXTENDING FROM WELL NO. 9 TO THE PROPOSED WELL NO. 10, THE PLANNED 12,470 VOLT ELECTRIC POWER LINE EXTENDING FROM THE EXISTING LINE AT WELL NO. 9 NORTH AND EAST TO THE PROPOSED WELL NO. 10, AND THE PLANNED FLOW LINE ROUTE EXTENDING FROM THE PROPOSED WELL WEST ALONGSIDE THE PLANNED NEW ROAD TO THE EXISTING TANK BATTERY AT WELL NO. 9.
3. A REVISED EXHIBIT "C" SHOWING THE DRILLING RIG TO V-DOOR SOUTH.

AN ARCHAEOLOGICAL RECONNAISSANCE WILL BE ACCOMPLISHED AND A REPORT FURNISHED.

14. I hereby certify that the foregoing is true and correct.

Signed Richard A. Wright Title Division Operations Mgr. Date May 5, 1995

(This space for Federal or State office use)

Approved by Gary Baum Title Acting Area Manager Date 5/12/95

Conditions of approval, if any:

DISTRICT I
P.O. Box 1980, Hobbs, NM 88241-1980

DISTRICT II
P.O. Drawer ED, Artesia, NM 88211-0719

DISTRICT III
1000 Rio Brazos Rd., Artesia, NM 87410

DISTRICT IV
P.O. Box 2088, Santa Fe, NM 87504-2088

State of New Mexico
Energy, Minerals and Natural Resources Department

Form C-102
Revised February 10, 1994
Submit to Appropriate District Office
State Lease - 4 Copies
Fee Lease - 3 Copies

OIL CONSERVATION DIVISION

P.O. Box 2088
Santa Fe, New Mexico 87504-2088

☐ AMENDED REPORT

WELL LOCATION AND ACREAGE DEDICATION PLAT

API Number 30-025-32581	Pool Code 51683	Pool Name UNDES. RED TANK BONE SPRINGS
Property Code 9316	Property Name COVINGTON "A" FEDERAL	Well Number 10
OCRD No. 17891	Operator Name POGO PRODUCING COMPANY	Elevation 3772

Surface Location

UL or lot No. 0	Section 25	Township 22 S	Range 32 E	Lot Idn	Feet from the 660	North/South line SOUTH	Feet from the 1980	East/West line EAST	County LEA
--------------------	---------------	------------------	---------------	---------	----------------------	---------------------------	-----------------------	------------------------	---------------

Bottom Hole Location If Different From Surface

UL or lot No.	Section	Township	Range	Lot Idn	Feet from the	North/South line	Feet from the	East/West line	County
Dedicated Acres 40	Joint or Infill N	Consolidation Code	Order No.						

NO ALLOWABLE WILL BE ASSIGNED TO THIS COMPLETION UNTIL ALL INTERESTS HAVE BEEN CONSOLIDATED
OR A NON-STANDARD UNIT HAS BEEN APPROVED BY THE DIVISION

	OPERATOR CERTIFICATION <i>I hereby certify the the information contained herein is true and complete to the best of my knowledge and belief.</i> Signature Richard L. Wright Printed Name Division Operations Mgr. Title May 8, 1995 Date
	SURVEYOR CERTIFICATION <i>I hereby certify that the well location shown on this plat was plotted from field notes of actual surveys made by me or under my supervision, and that the same is true and correct to the best of my belief.</i> Date Surveyed Signature & Seal of Professional Surveyor Certificate No. 5-4-95 W.O. Nm. 95-11-0705 JLP
	Professional Surveyor RONALD J. EIDSON, 676 GARY G. EIDSON, 12841

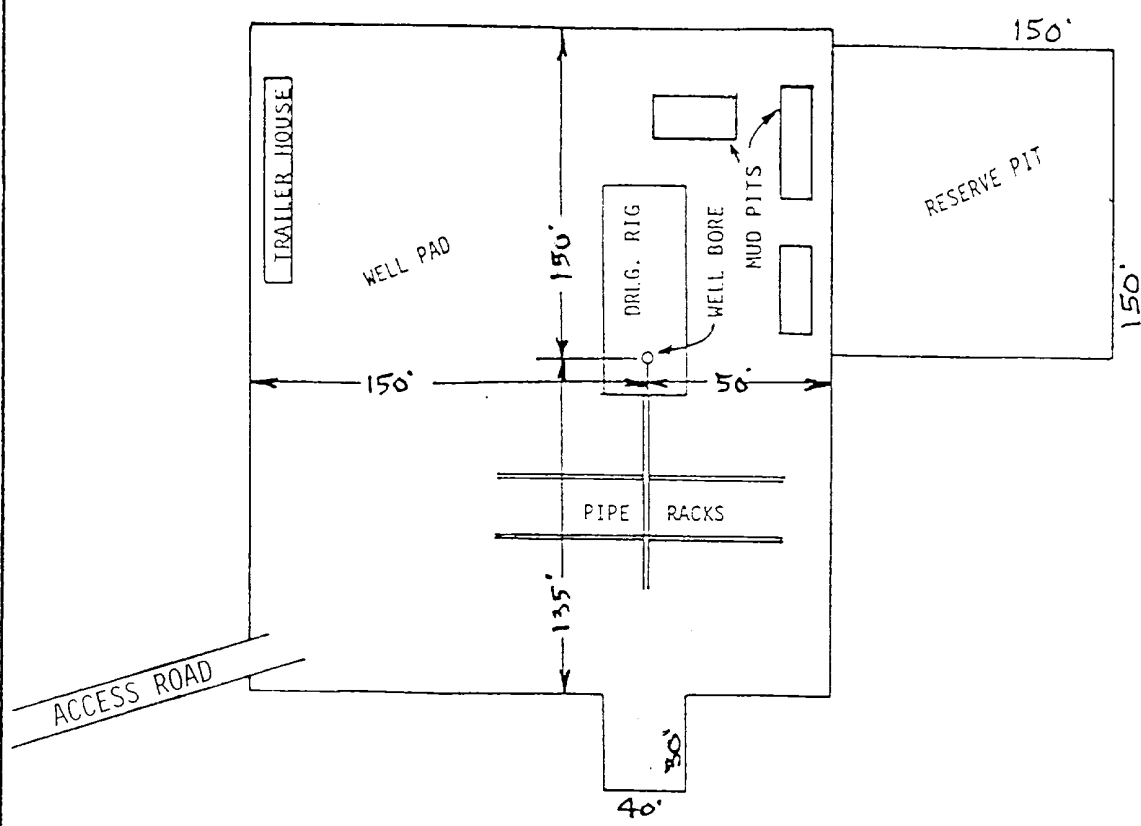

EXHIBIT "C"

POGO PRODUCING COMPANY
COVINGTON "A" FEDERAL WELL NO.10

DRILLING RIG LAYOUT
SCALE: None