

P.O. BOX 1980
HC 15, NEW MEXICO 88240

Form 3160-3
(November 1983)
(formerly 9-331C)

SUBMIT IN TR. LOCATE*
(Other instructions on
reverse side)

Form approved.
Budget Bureau No. 1004-0136
Expires August 31, 1985

UNITED STATES
DEPARTMENT OF THE INTERIOR
BUREAU OF LAND MANAGEMENT

APPLICATION FOR PERMIT TO DRILL, DEEPEN, OR PLUG BACK

1a. TYPE OF WORK

DRILL ☒

DEEPEN ☐

PLUG BACK ☐

b. TYPE OF WELL

OIL
WELL ☒

GAS
WELL ☐

OTHER

SINGLE
ZONE ☒

MULTIPLE
ZONE ☐

2. NAME OF OPERATOR

POGO PRODUCING COMPANY

17891

3. ADDRESS OF OPERATOR

P. O. BOX 10340, MIDLAND, TEXAS

4. LOCATION OF WELL (Report location clearly and in accordance with any State requirements.)

At surface

660' FNL AND 1650' FEL OF SECTION 27

At proposed prod. zone

14. DISTANCE IN MILES AND DIRECTION FROM NEAREST TOWN OR POST OFFICE*

30 AIR MILES WEST OF EUNICE, NEW MEXICO

15. DISTANCE FROM PROPOSED*
LOCATION TO NEAREST
PROPERTY OR LEASE LINE, FT.
(Also to nearest drlg. unit line, if any)

990'

16. NO. OF ACRES IN LEASE

640

17. NO. OF ACRES ASSIGNED
TO THIS WELL

40

18. DISTANCE FROM PROPOSED LOCATION*
TO NEAREST WELL, DRILLING, COMPLETED,
OR APPLIED FOR, ON THIS LEASE, FT.

990'

19. PROPOSED DEPTH

9000'

20. ROTARY OR CABLE TOOLS

ROTARY

21. ELEVATIONS (Show whether DF, RT, GR, etc.)

3651' GR

Carlsbad Controlled Water Basin

22. APPROX. DATE WORK WILL START*

UPON APPROVAL

23. PROPOSED CASING AND CEMENTING PROGRAM

SIZE OF HOLE	SIZE OF CASING	WEIGHT PER FOOT	SETTING DEPTH	QUANTITY OF CEMENT
17-1/2"	13-3/8"	54.5#	800'	SUFFICIENT TO CIRCULATE
11"	8-5/8"	32#	4600'	200 SACKS
7-7/8"	5-1/2"	17#	9000'	TO TIE BACK 200' INTO 8-5/8"

ALTERNATE CASING-CEMENTING PROGRAM: IF WATER FLOW OCCURS WHILE DRILLING CASTLE FORMATION

17-1/2"	13-3/8"	54.5#	800'	SUFFICIENT TO CIRCULATE
11"	8-5/8"	32#	4600'	SUFFICIENT TO CIRCULATE
7-7/8"	5-1/2"	17#	9000'	TO TIE BACK 200' INTO 8-5/8"

AFTER SETTING PRODUCTION CASING, PAY ZONE WILL BE PERFORATED
AND STIMULATED AS NECESSARY.

SEE ATTACHED FOR: SUPPLEMENTAL DRILLING DATA

BOP SKETCH

SURFACE USE AND OPERATIONS PLAN

HYDROGEN SULFIDE DRILLING OPERATIONS PLAN

APPROVED FOR
CUTTING OPERATIONS
AND
HYDROGEN SULFIDE
OPERATIONS

IN ABOVE SPACE DESCRIBE PROPOSED PROGRAM: If proposal is to deepen or plug back, give data on present productive zone and proposed new productive zone. If proposal is to drill or deepen directionally, give pertinent data on subsurface locations and measured and true vertical depths. Give blowout preventer program, if any.

24.

SIGNED

Richard L. Wright

TITLE

Division Operations Mgr.

DATE

July 22, 1994

(This space for Federal or State office use)

PERMIT NO.

APPROVED BY

Scott Powers

TITLE

AREA MANAGER

DATE

8-31-94

CONDITIONS OF APPROVAL, IF ANY:

APPROVAL OF THIS APPLICATION DOES NOT WARRANT
OR CERTIFY THAT THE APPLICANT HOLDS LEGAL OR

EQUITABLE TITLE TO THOSE RIGHTS IN THE LAND OR
LEASE WHICH WOULD ENTITLE THE APPLICANT TO

See Instructions On Reverse Side

Title 18, U.S.C. § 2381 makes it a crime for any person knowingly and willfully to make to any department or agency of the United States any false, fictitious or fraudulent statements or representations as to any matter within its jurisdiction.

5. LEASE DESIGNATION AND SERIAL NO.

NM-81272

6. IF INDIAN, ALLOTTEE OR TRIBE NAME

7. UNIT AGREEMENT NAME

8. FARM OR LEASE NAME

PRIZE FEDERAL

9. WELL NO.

6

10. FIELD AND POOL, OR WILDCAT UNDES.

RED TANK BONE SPRINGS

11. SEC. T. R. M., OR BLK.
AND SURVEY OR AREA

SEC. 27, T. 22 S., R. 32 E.

12. COUNTY OR PARISH

13. STATE

LEA COUNTY

NEW MEXICO

DISTRICT I
P.O. Box 1980, Hobbs, NM 88240

DISTRICT II
P.O. Drawer DD, Artesia, NM 88210

DISTRICT III
1000 Rio Brazos Rd., Aztec, NM 87410

State of New Mexico
Energy, Minerals and Natural Resources Department

Form C-102
Revised February 10, 1994
Instruction on back
Submit to Appropriate District Office
State Lease - 4 Copies
Fee Lease - 3 Copies

OIL CONSERVATION DIVISION

P.O. Box 2088
Santa Fe, New Mexico 87504-2088

☐ AMENDED REPORT

WELL LOCATION AND ACREAGE DEDICATION PLAT

API Number	Pool Code	Pool Name
		UNDES. RED TANK BONE SPRINGS
Property Code	Property Name	Well Number
	PRIZE FEDERAL	6
OGRID No.	Operator Name	Elevation
17891	POGO PRODUCING COMPANY	3651'

Surface Location

UL or lot No.	Section	Township	Range	Lot Idn	Feet from the	North/South line	Feet from the	East/West line	County
B	27	22 S	32 E		660	NORTH	1650	EAST	LEA

Bottom Hole Location If Different From Surface

UL or lot No.	Section	Township	Range	Lot Idn	Feet from the	North/South line	Feet from the	East/West line	County
Dedicated Acres	Joint or Infill	Consolidation Code	Order No.						
40	N								

NO ALLOWABLE WILL BE ASSIGNED TO THIS COMPLETION UNTIL ALL INTERESTS HAVE BEEN CONSOLIDATED
OR A NON-STANDARD UNIT HAS BEEN APPROVED BY THE DIVISION

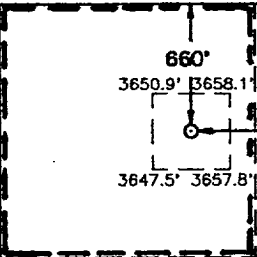
	<p>OPERATOR CERTIFICATION</p> <p>I hereby certify the the information contained herein is true and complete to the best of my knowledge and belief.</p> <p><i>Richard L. Wright</i> Signature</p> <p>Richard L. Wright Printed Name</p> <p>Division Operations Mgr. Title</p> <p>July 18, 1994 Date</p>
	<p>SURVEYOR CERTIFICATION</p> <p>I hereby certify that the well location shown on this plat was plotted from field notes of actual surveys made by me or under my supervision and that the same is true and correct to the best of my belief.</p> <p>JUNE 23, 1994 Date Surveyed</p> <p><i>W. O. Jones</i> Signature & Seal of Professional Surveyor</p> <p>W. O. JONES 94-11-1079 Certificate No.</p> <p>PROFESSIONAL SURVEYOR RONALD J. EIDSON, 676 GARY L. JONES, 7977</p>

SUPPLEMENTAL DRILLING DATA

POGO PRODUCING COMPANY

PRIZE FEDERAL WELL NO. 6

1. SURFACE FORMATION: Quaternary.

2. ESTIMATED TOPS OF GEOLOGIC MARKERS:

Anhydrite	800'
Delaware Lime	4700'
Cherry Canyon	6100'
Brushy Canyon	7400'
Bone Springs	8800'

3. ANTICIPATED POSSIBLE HYDROCARBON BEARING ZONES:

Delaware	Oil
Bone Springs	Oil

4. PROPOSED CASING AND CEMENTING PROGRAM:

CASING SIZE	SETTING DEPTH		WEIGHT	GRADE	JOINT
	FROM	TO			
13-3/8"	0	800'	54.5#	J-55	STC
8-5/8"	0	4300'	32#	J-55	STC
"	4300'	4600'	32#	S-80	STC
5-1/2"	0	1000'	17#	N-80	LTC
"	1000'	7000'	17#	J-55	LTC
"	7000'	9000'	17#	N-80	LTC

MINIMUM
DESIGN FACTORS: COLLAPSE 1.125 BURST 1.1 TENSION 1.7

13-3/8" casing to be cemented with 500 sacks of light cement tailed in with 200 sacks of Class "C" with 2% CaCl. Cement to circulate.

8-5/8" casing to be cemented with 200 sacks of premium cement with salt and 2% CaCl.

5-1/2" casing to be cemented with 750 sacks of premium cement. Cement to tie back 200 feet into the 8-5/8" casing.

- * Alternate Cementing Program if Water Flow Occurs While Drilling Castile
- *
- * 13-3/8" casing to be cemented with 500 sacks of light cement tailed in
- * with 200 sacs of Class "C" with 2% CaCl.
- *
- * 8-5/8" casing to be cemented with 1200 sacks of light cement with 10% salt
- * tailed in with 200 sacks of premium with 1% CaCl. Cement to circulate.
- *
- * 5-1/2" production casing to be cemented with 200 sacks of light cement
- * tailed in with 400 sacks of premium cement. Cement to tie back 200
- * feet into the 8-5/8" casing.

If, during drilling operations, need for stage cementing of casing is indicated, staging tool(s) will be run and positioned to best suit hole conditions at time casing is run.

Cement volumes may be adjusted and cement may have lost circulation and/or other additives depending on hole conditions at the time casing is run.

5. PRESSURE CONTROL EQUIPMENT:

Blowout prevention equipment, while drilling the 11" hole, will be either a 3000 psi working pressure double ram type preventer or a 3000 psi working pressure annular type preventer.

Blow out prevention equipment, while drilling below the 8-5/8" casing seat, will be a 3000 psi working pressure BOP stack. A BOP sketch is attached.

6. CIRCULATING MEDIUM:

Surface to 800 feet: Fresh water spud mud. Viscosity 30 to 36 as required for hole cleaning.

800 feet to 4600 feet: Brine conditioned as necessary for control of viscosity. Weight 9.8 to 10. pH 9 to 10. Viscosity 32 to 36.

4600 feet to T.D.: Water base drilling fluid conditioned as necessary for control of weight, viscosity, pH and water-loss. Weight 9 to 10. Viscosity 38-45. pH 9 to 10. Filtrate while drilling pay zone 6 to 15.

7. AUXILIARY EQUIPMENT:

A mud logging trailer will be in use while drilling below the intermediate casing.

8. TESTING, LOGGING, AND CORING PROGRAM:

Drill stem tests will be made when well data indicate a test is warranted.

It is planned that electric logs will include GR-CNL-Density logs and GR-DLL logs.

No coring is planned.

9. ABNORMAL PRESSURES, TEMPERATURES, OR HYDROGEN SULFIDE GAS:

No abnormal pressures or temperatures are expected.

Expected bottom hole pressure is about 3600 psi.

Expected bottom hole temperature is about 125 degrees Fahr.

No hydrogen sulfide gas is expected. The production stream of Pogo Producing Company's wells in this area have been tested specifically for hydrogen sulfide gas and test results were negative. However, since it is possible that low-volume hydrogen sulfide gas may be present in permeable water zones of the Castile formation, drilling operations below the surface casing will be in accordance with the attached "HYDROGEN SULFIDE DRILLING OPERATIONS PLAN" until intermediate casing is set and cemented and this possible source of hydrogen sulfide gas is cased off.

10. ANTICIPATED STARTING DATE:

It is planned that operations will commence upon approval of this application, with drilling and completion operations lasting about 30 days.

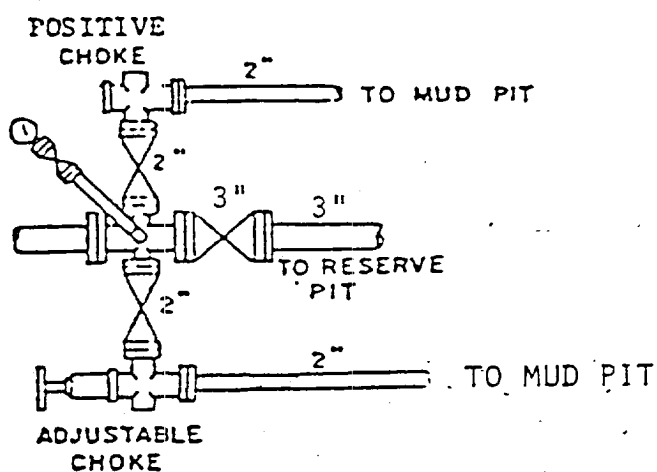
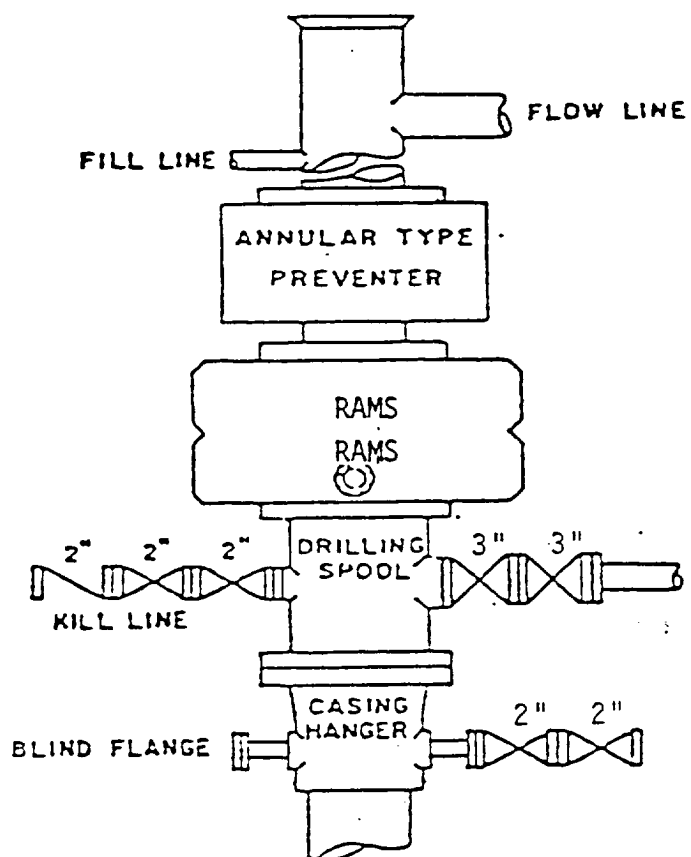

BOP STACK

3000 PSI WORKING PRESSURE

BOP ARRANGEMENT

Handwritten signature or mark.

SEP - 2 1994