

UNITED STATES  
DEPARTMENT OF THE INTERIOR  
BUREAU OF LAND MANAGEMENT

APPLICATION FOR PERMIT TO DRILL OR DEEPEN

1a. TYPE OF WORK

DRILL ☒

DEEPEN ☐

b. TYPE OF WELL

OIL  
WELL ☒

GAS  
WELL ☐

OTHER ☐

SINGLE  
ZONE ☒

MULTIPLE  
ZONE ☐

2. NAME OF OPERATOR

POGO PRODUCING COMPANY

3. ADDRESS AND TELEPHONE NO.

P.O. BOX 10340, MIDLAND, TEXAS 79702 (915-682-6822)

4. LOCATION OF WELL (Report location clearly and in accordance with any State requirements.)\*

At surface

2310' FSL AND 990' FWL OF SECTION 35

At proposed prod. zone

14. DISTANCE IN MILES AND DIRECTION FROM NEAREST TOWN OR POST OFFICE\*

30 MILES WEST OF EUNICE, NEW MEXICO

15. DISTANCE FROM PROPOSED\*

LOCATION TO NEAREST  
PROPERTY OR LEASE LINE, FT.  
(Also to nearest drlg. unit line, if any)

990'

16. NO. OF ACRES IN LEASE

320

17. NO. OF ACRES ASSIGNED  
TO THIS WELL

40

18. DISTANCE FROM PROPOSED LOCATION\*  
TO NEAREST WELL, DRILLING, COMPLETED,  
OR APPLIED FOR, ON THIS LEASE, FT.

2310'

19. PROPOSED DEPTH

6600'

20. ROTARY OR CABLE TOOLS

ROTARY

21. ELEVATIONS (Show whether DF, RT, GR, etc.)

3726' GR

22. APPROX. DATE WORK WILL START\*

UPON APPROVAL

23.

535

PROPOSED CASING AND CEMENTING PROGRAM

SIZE OF HOLE	GRADE SIZE OF CASING	WEIGHT PER FOOT	SETTING DEPTH	QUANTITY OF CEMENT
12 1/4"	8-5/8"	24#	800'	SUFFICIENT TO CIRCULATE
7-7/8"	5-1/2"	15.5#	6600'	SUFFICIENT TO CIRCULATE

AFTER SETTING PRODUCTION CASING, PAY ZONE WILL BE PERFORATED  
AND STIMULATED AS NECESSARY.

SEE ATTACHED FOR: SUPPLEMENTAL DRILLING DATA

BOP SKETCH

SURFACE USE AND OPERATIONS PLAN

HYDROGEN SULFIDE DRILLING OPERATIONS PLAN

OPER. OGRND NO. 17891

PROPERTY NO. 13275

POOL CODE 51689

EFF. DATE 10/20/95

API NO. 30-025-33149

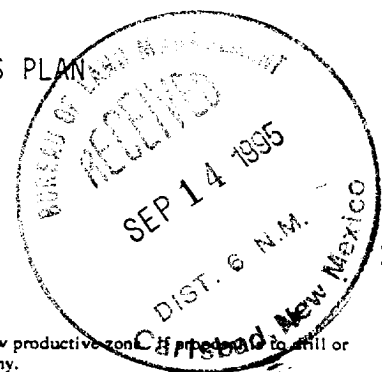

IN ABOVE SPACE DESCRIBE PROPOSED PROGRAM: If proposal is to deepen, give data on present productive zone and proposed new productive zone. If proposal is to drill or deepen directionally, give pertinent data on subsurface locations and measured and true vertical depths. Give blowout preventer program, if any.

24.

SIGNED

Richard L. Wright  
Richard L. Wright

TITLE Division Operations Mgr.

DATE Sept. 12, 1995

(This space for Federal or State office use)

PERMIT NO. \_\_\_\_\_

APPROVAL DATE \_\_\_\_\_

APPROVAL SUBJECT TO  
GENERAL REQUIREMENTS AND  
SPECIAL STIPULATIONS  
ATTACHED

Application approval does not warrant or certify that the applicant holds legal or equitable title to those rights in the subject lease which would entitle the applicant to conduct operations thereon.  
CONDITIONS OF APPROVAL, IF ANY:

APPROVED BY /s/ Yolanda Vega

TITLE ASSISTANT AREA MANAGER

DATE 10-16-95

\*See Instructions On Reverse Side



DISTRICT I  
P.O. Box 1980, Hobbs, NM 88240

DISTRICT II  
P.O. Drawer DD, Artesia, NM 88210

DISTRICT III  
1000 Rio Brazos Rd., Axtec, NM 87410

DISTRICT IV  
PO BOX 2088, SANTA FE, NM 87504-2088

State of New Mexico  
Energy, Minerals and Natural Resources Department

Form C-102  
Revised February 10, 1994  
Instruction on back  
Submit to Appropriate District Office  
State Lease - 4 Copies  
Fee Lease - 3 Copies

OIL CONSERVATION DIVISION

P.O. Box 2088  
Santa Fe, New Mexico 87504-2088

☐ AMENDED REPORT

WELL LOCATION AND ACREAGE DEDICATION PLAT

API Number <b>30-025-33149</b>	Pool Code <b>51689</b>	Pool Name <b>UNDES. WEST RED TANK DELAWARE</b>
Property Code <b>13275</b>	Property Name <b>RED TANK "35" FEDERAL</b>	Well Number <b>3</b>
OGRID No. <b>17891</b>	Operator Name <b>POGO PRODUCING CO.</b>	Elevation <b>3726</b>

Surface Location

UL or lot No. <b>L</b>	Section <b>35</b>	Township <b>22 S</b>	Range <b>32 E</b>	Lot Idn	Feet from the <b>2310</b>	North/South line <b>SOUTH</b>	Feet from the <b>990</b>	East/West line <b>WEST</b>	County <b>LEA</b>
---------------------------	----------------------	-------------------------	----------------------	---------	------------------------------	----------------------------------	-----------------------------	-------------------------------	----------------------

Bottom Hole Location If Different From Surface

UL or lot No.	Section	Township	Range	Lot Idn	Feet from the	North/South line	Feet from the	East/West line	County
Dedicated Acres <b>40</b>	Joint or Infill <b>N</b>	Consolidation Code	Order No.						

NO ALLOWABLE WILL BE ASSIGNED TO THIS COMPLETION UNTIL ALL INTERESTS HAVE BEEN CONSOLIDATED  
OR A NON-STANDARD UNIT HAS BEEN APPROVED BY THE DIVISION

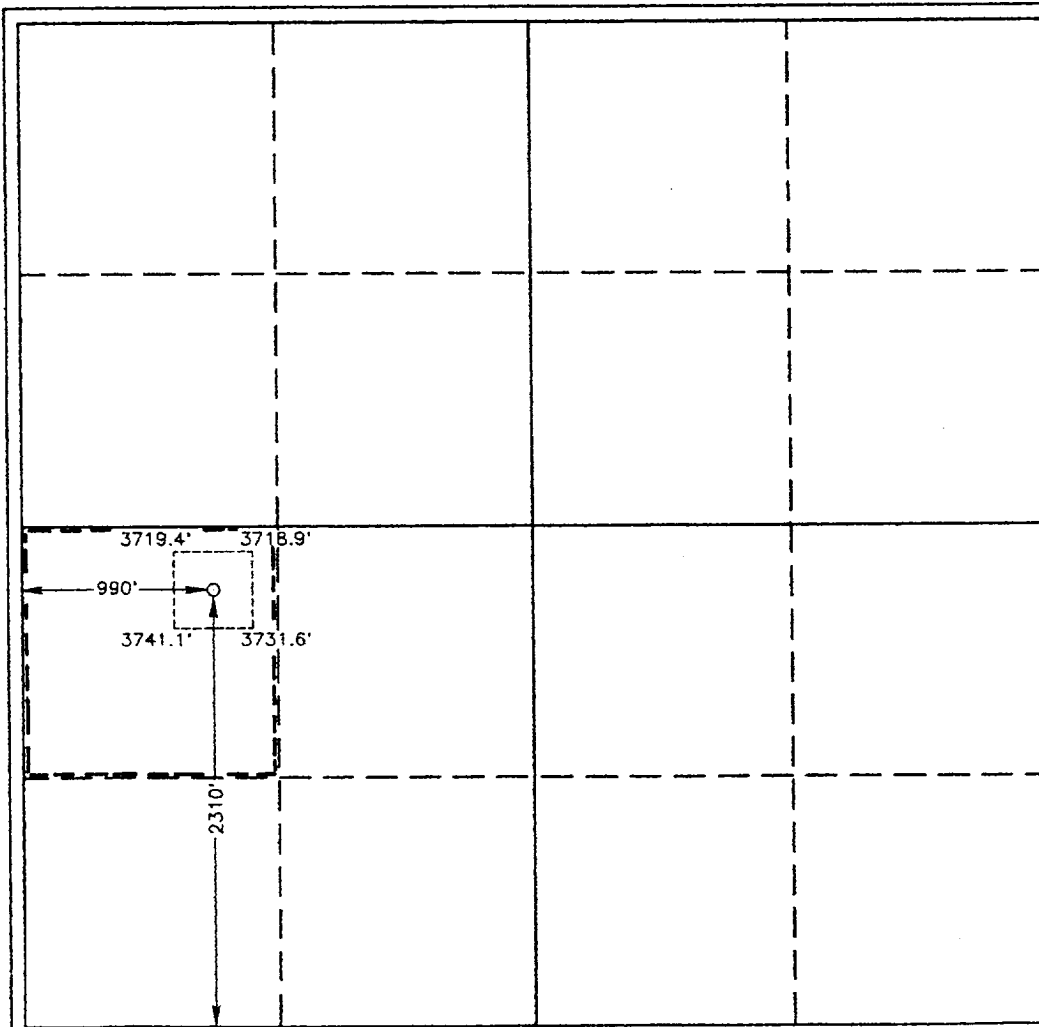

OPERATOR CERTIFICATION

I hereby certify the the information  
contained herein is true and complete to the  
best of my knowledge and belief.

Signature

Printed Name **Richard E. Wright**

Division Operations Mgr.

Title

Date **August 31, 1995**

Date

SURVEYOR CERTIFICATION

I hereby certify that the well location shown  
on this plat was plotted from field notes of  
actual surveys made by me or under my  
supervision, and that the same is true and  
correct to the best of my belief.

AUGUST 10, 1995

Date Surveyed

SJA

Signature & Seal of  
Professional Surveyor

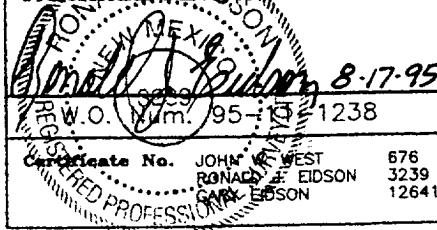

Certificate No. **JOHN C. WEST**  
**RONALD E. EIDSON**  
**GARY EIDSON**

676  
3239  
12641



SUPPLEMENTAL DRILLING DATA  
POGO PRODUCING COMPANY  
RED TANK 35 FEDERAL WELL NO. 3

1. SURFACE FORMATION: Quaternary.

2. ESTIMATED TOPS OF GEOLOGIC MARKERS:

Anhydrite	850'
Delaware Lime	4800'
Bell Canyon	4870'
Cherry Canyon	6000'

3. ANTICIPATED POSSIBLE HYDROCARBON BEARING ZONES:

Cherry Canyon (Delaware)

4. PROPOSED CASING AND CEMENTING PROGRAM:

CASING SIZE	SETTING DEPTH		WEIGHT	GRADE	JOINT
	FROM	TO			
8-5/8"	0	800'	24#	J-55	STC
5-1/2"	0	6600'	15.5#	J-55	STC

MINIMUM

DESIGN FACTORS: COLLAPSE 1.1 BURST 1.1 TENSION 1.2

8-5/8" casing to be cemented with 200 sacks of light cement followed by 200 sacks of premium cement with 2% CaCl. Cement to circulate.

5-1/2" production casing to be cemented with approximately 800 sacks of light cement and 400 sacks of premium cement. Cement to circulate.

If, during drilling operations, need for stage cementing of casing is indicated, staging tool(s) will be run and positioned to best suit hole conditions at time casing is run.

Cement volumes may be adjusted and cement may have lost circulation and/or other additives depending on hole conditions at the time casing is run.



5. PRESSURE CONTROL EQUIPMENT:

Blowout prevention equipment, while drilling below the 8-5/8" casing seat, will be a 3000 psi working pressure BOP stack. A BOP sketch is attached.

6. CIRCULATING MEDIUM:

Surface to 800 feet: Fresh water base fluid with gel and paper sweeps for hole cleaning.  
Mud wgt 8.4 ppg - 8.6 ppg  
Viscosity 28 - 32 seconds per quart.

800 feet to T.D.: Brine water base fluid with salt gel and paper sweeps for hole cleaning.  
Mud wgt 10.0 ppg - 10.2 ppg  
Viscosity 28 - 32 seconds per quart.

7. AUXILIARY EQUIPMENT:

A mud logging trailer will be in use while drilling the last 300 feet of hole.

8. TESTING, LOGGING, AND CORING PROGRAM:

Drill stem tests will be made when well data indicate a test is warranted.

It is planned that electric logs will include GR-CNL-Density logs and GR-DLL logs.

No coring is planned.

9. ABNORMAL PRESSURES, TEMPERATURES, OR HYDROGEN SULFIDE GAS:

No abnormal pressures or temperatures are anticipated.

Expected bottom hole pressure is about 2700 psi.

Expected bottom hole temperature is about 118 degrees Fahr.

No hydrogen sulfide gas is expected. The production stream of Pogo

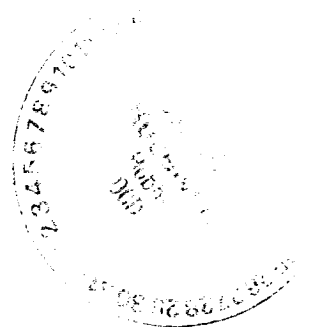



Producing Company's wells in this area have been tested specifically for hydrogen sulfide gas and test results were negative. However, since it is possible that low-volume hydrogen sulfide gas may be present in permeable water zones of the Castile formation, drilling operations below the surface casing will be in accordance with the attached "HYDROGEN SULFIDE DRILLING OPERATIONS PLAN".

10. ANTICIPATED STARTING DATE:

It is planned that operations will commence upon approval of this application, with drilling and completion operations lasting about 30 days.



POGO PRODUCING COMPANY  
RED TANK 35 FEDERAL WELL NO. 3

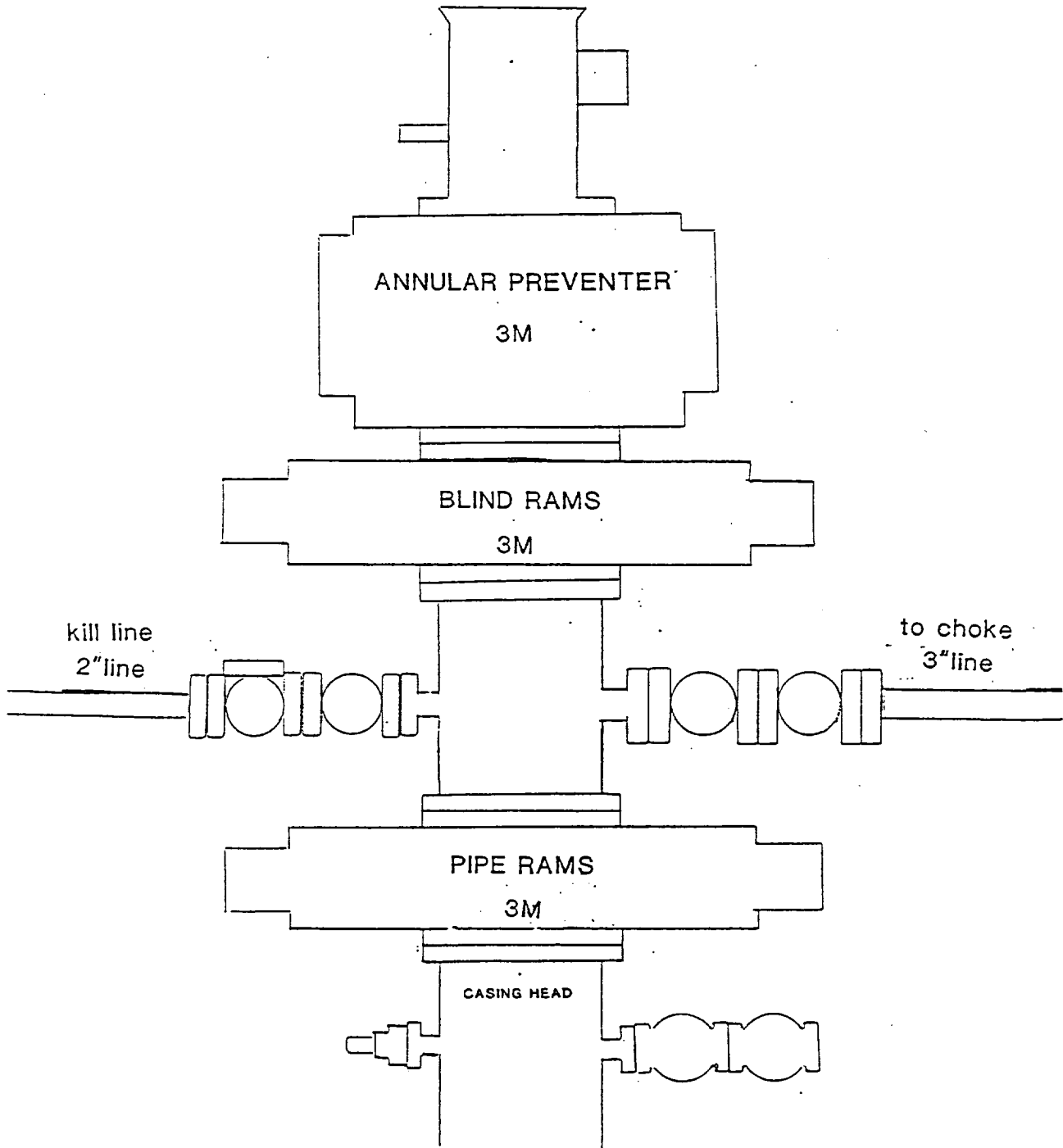

1/11/96

