

District I
PO Box 1980, Hobbs, NM 88241-1980
District II
PO Drawer DD, Artesia, NM 88211-0719
District III
1000 Rio Brazos Rd., Aztec, NM 87410
District IV
PO Box 2088, Santa Fe, NM 87504-2088

State of New Mexico
Energy, Minerals & Natural Resources Department
OIL CONSERVATION DIVISION
P.O. Box 2088
Santa Fe, NM 87504-2088

Form C-101
Revised February 10, 1994
Instructions on back
submit to Appropriate District Office
State Lease - 6 Copies
Fee Lease - 5 Copies

☒ AMENDED REPORT

APPLICATION FOR PERMIT TO DRILL, RE-ENTER, DEEPEN, PLUGBACK, OR ADD A ZONE

Operator Name and Address. ARCH PETROLEUM, INC. 10 DESTA DRIVE, STE. 420E MIDLAND, TX 79705		OGRID Number 000962
Property Code 14920	Property Name MATTERN	API Number 30-025- 33544
		Well No. 4

7 Surface Location

UL or lot no. SK	Section 30	Township 21S	Range 37E	Lot Idn	Feet from the 2310'	North / South line South	Feet from the 2310	East / West line WEST	County Lea
----------------------------	----------------------	------------------------	---------------------	---------	-------------------------------	------------------------------------	------------------------------	---------------------------------	----------------------

8 Proposed Bottom Hole Location if Different From Surface

UL or lot no.	Section	Township	Range	Lot Idn	Feet from the	North / South line	Feet from the	East / West line	County
Proposed Pool 1 DRINKARD					Proposed Pool 2				

Work Type Code N	Well Type Code O	Cable / Rotary R	Lease Type Code P	Ground Level Elevation 3491'
Multiple No	Proposed Depth 6,800'	Formations DRINKARD	Contractor UNKNOWN	Spud Date 9/1/96

Proposed Casing and Cement Program

Hole Size	Casing Size	Casing weight / foot	Setting Depth	Sacks of Cement	Estimated TOC
11"	8-5/8"	24#	1250'	600 sx.Cl.'C'	SURFACE
7-7/8"	5-1/2"	15.5#	6,800'	1650 sx.Cl.'C'	1075'

Describe the proposed program. If this application is to DEEPEN or PLUG BACK give the data on the present productive zone and proposed new productive zone. Describe the blowout prevention program, if any. Use additional sheets if necessary.

MUD PROGRAM;
O-1075' FW/Spud Mud 8.8-9.0 #/gal., 32 visc., 10 pH
1250'-6,800' BW 10#/gal., 28 visc., 10 pH
6800'-6800 BW/Starch 10#/gal., 30 visc., 10 pH

See attached BOP drawing for 3000 psi system.

*Move Location
from 2310/S & 2310/E*

Permit Expires 1 Year From Approval
Date Unless Drilling Underway

I hereby certify that the information given above is true and complete to the best of my knowledge and belief.

Signature: *Bobbie Brooks*
Print name: **Bobbie Brooks**

Title: **Production Analyst**

Date: **9-5-96** Phone: **685-1961**

OIL CONSERVATION DIVISION

Approved by: **ORIGINAL SIGNED BY JERRY SEXTON**
Title: **DISTRICT I SUPERVISOR**

Approval Date: **SEP 09 1996** Expiration Date:

Conditions of Approval:
Attached ☐

C-101 Instructions

Measurements and dimensions are to be in feet / inches. Well locations will refer to the New Mexico Principal Meridian.

If THIS IS AN AMENDED REPORT CHECK THE BOX LABELED "AMENDED REPORT" AT THE TOP OF THIS DOCUMENT.

1. Operator OGRID number. If you do not have one it will be assigned and filed in by the District office.

2. Operator's name and address.

3. API number of this well. If this is a new drill the OCD will assign the number and fill it in.

4. Property code. If this is a new property the OCD will assign the number and fill it in.

5. Property name that used to be called 'well name'.

6. The number of this well on the property.

7. The surveyed location of this well New Mexico principal Meridian NOTE: If the United States government survey designates a Lot Number for this location use that number in the UL or lot no. box. Otherwise use the OCD Unit letter.

8. The proposed bottom hole location of this well at TD.

9 and 10. The proposed pool(s) to which this well is being drilled.

11. Work type code from the following table:

N	New Well
E	Re-entry
D	Drill deeper
P	Plugback
A	Add a zone

12. Well type code from the following table:

O	Single oil completion
G	Single gas completion
M	multiple completion
I	Injection well
S	SWD well
W	Water supply well
C	Carbon dioxide well

13. Cable or rotary code

C	Propose cable tool drill
R	Propose to rotary drill

14. Lease type code from the following table:

F	Federal
S	State
P	Private
N	Navajo
J	Jicarilla
U	Ute
I	Other indian tribe

15. Ground level elevation above sea level

16. Intend to mutiple complete? Yes or No.

17. Proposed total depth of this well.

18. Geologic formation at TD.

19. Name of the intended drilling company if known.

20. Anticipated spud date.

21. Proposed hole size ID inches, proposed casing OD inches, casing weight in pounds per foot, setting depth of the casing or depth and top of liner, proposed cementing volume, and estimated top of cement.

22. Brief description of the proposed drilling program and BOP program. Attach additional sheets if necessary.

23. The signature, printed name, and title of the person authorized to make this report. The data this report was signed and the telephone number to call for questions about this report.

<p>LOT 1 36.95 AC.</p>			
<p>LOT 2 36.97 AC.</p>			
<p>LOT 3 36.99 AC.</p>			
<p>LOT 4 37.01 AC.</p>			

OPERATOR CERTIFICATION

I hereby certify the information contained herein is true and complete to the best of my knowledge and belief.

Bobbie Brooks
Signature

BOBBIE BROOKS
Printed Name

PRODUCTION ANALYST
Title

9/5/96
Date

SURVEYOR CERTIFICATION

I hereby certify that the well location shown on this plat was plotted from field notes of actual surveys made by me or under my supervision, and that the same is true and correct to the best of my belief.

AUGUST 29, 1996

Date Surveyed

RES

Signature & Seal of Professional Surveyor

W.O. Num. 96-114115

Certificate No.	JOHN W. WEST	676
	RONALD W. EDSON	3238
	GARY EDSON	12641

LOCATION VERIFICATION MAP

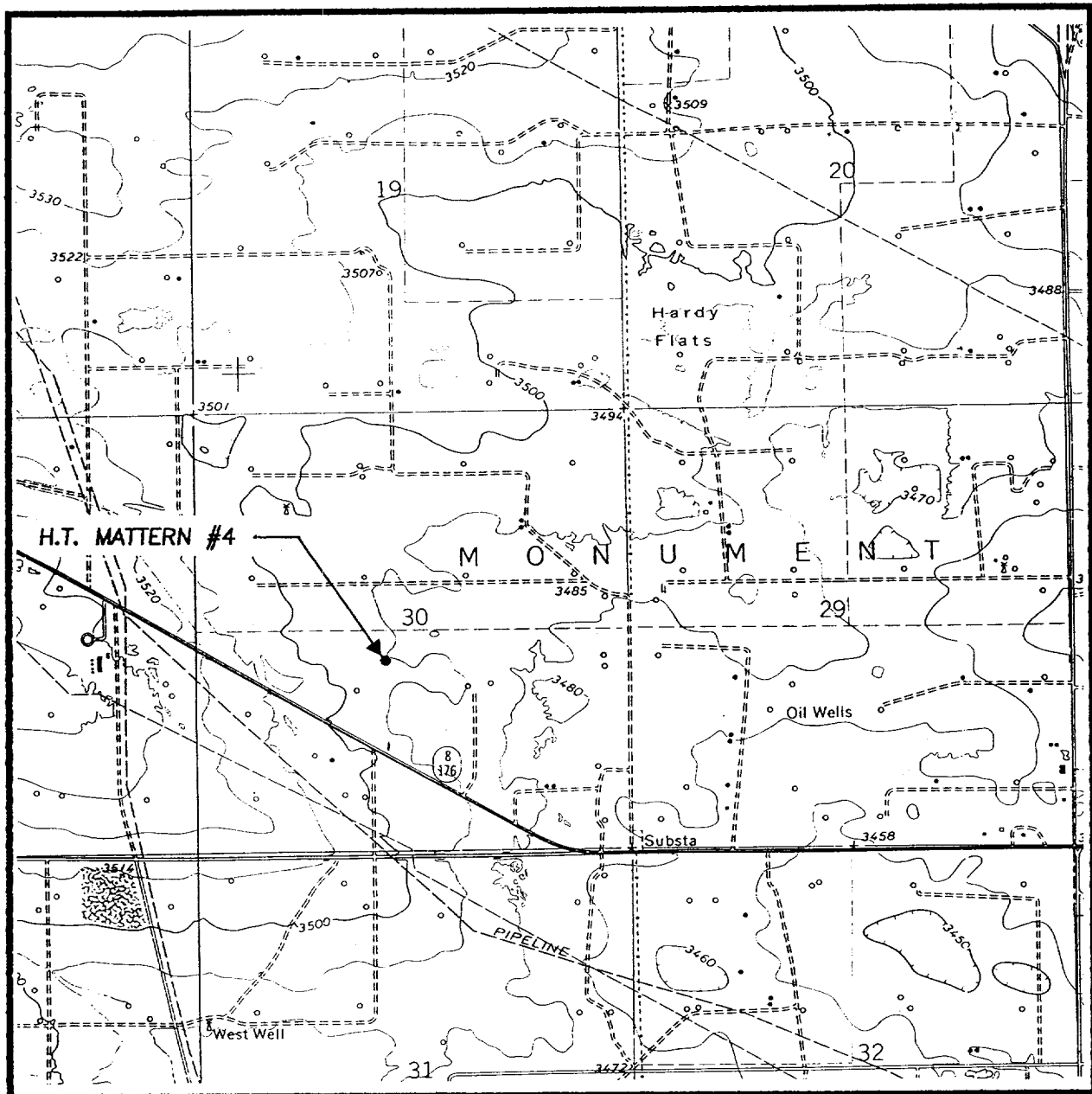

SCALE: 1" = 2000'

CONTOUR INTERVAL:
EUNICE - 10'

SEC. 30 TWP. 21-S RGE. 37-E

SURVEY N.M.P.M.

COUNTY LEA

DESCRIPTION 2310' FSL & 2310' FWL

ELEVATION 3494'

OPERATOR ARCH PETROLEUM, INC.

LEASE H.T. MATTERN

U.S.G.S. TOPOGRAPHIC MAP

EUNICE, N.M.

JOHN WEST ENGINEERING
HOBBS, NEW MEXICO
(505) 393-3117