

SECTION 32, TOWNSHIP 20 SOUTH, RANGE 37 EAST, N.M.P.M.
LEA COUNTY, NEW MEXICO

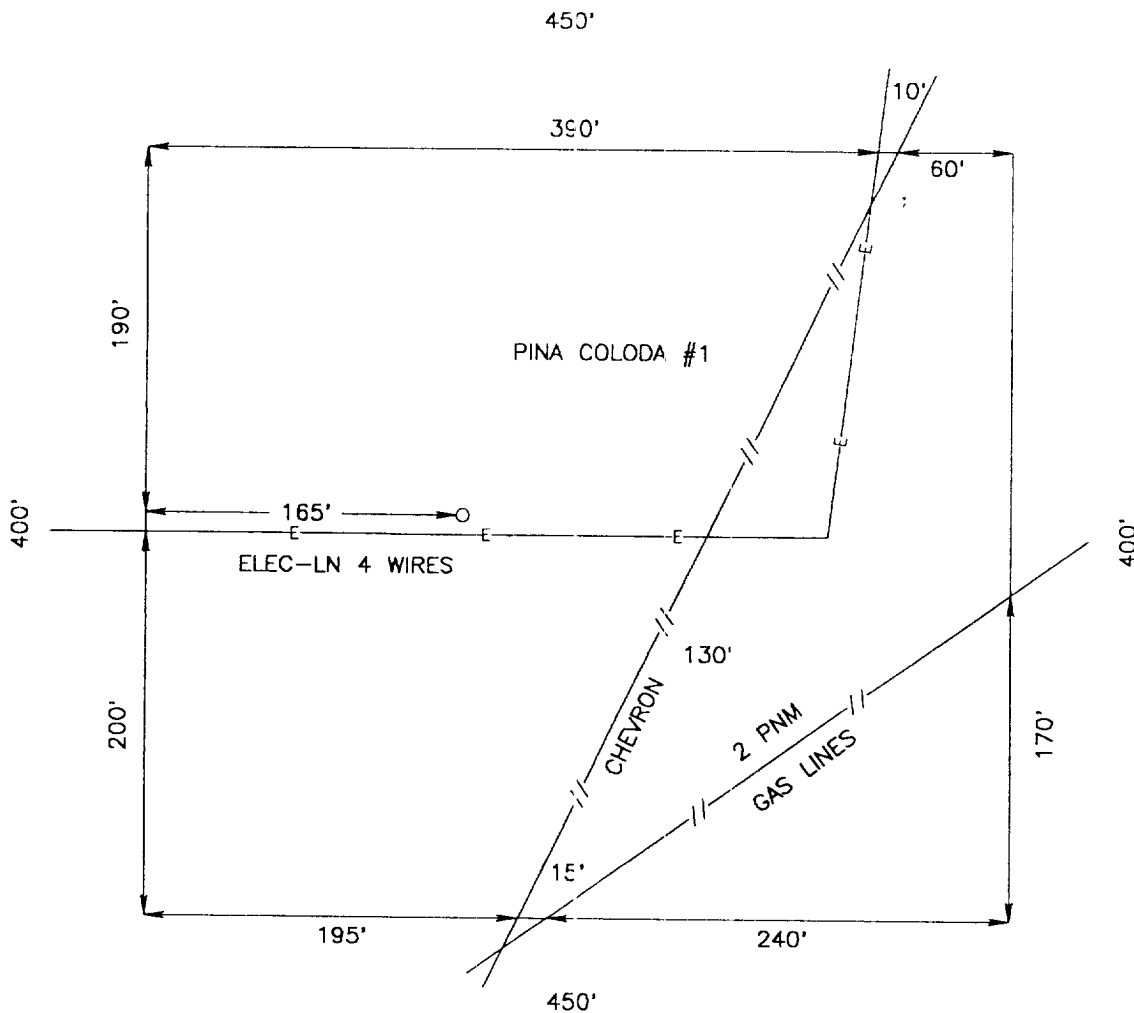

100 0 100 200 FEET

SHELL WESTERN E & P, INC.

THE PINA COLODA NO. 1 IS LOCATED 1000 FEET FROM THE SOUTH LINE AND 2370 FEET FROM THE EAST LINE OF SECTION 32, TOWNSHIP 20 SOUTH, RANGE 37 EAST, N.M.P.M., LEA COUNTY, NEW MEXICO.

Survey Date: 10-03-1996	Sheet 1 of 1 Sheets
W.O. Number: 96-11-1221	Drawn By: RES
Date: 10-04-96 96111221	BS-14 Scale: 1"=100'