

State Lease - 6 copies
Fee Lease - 5 copies
District I
1625 N. French Dr., Hobbs, NM 88240
District II
811 South First, Artesia, NM 88210
District III
1000 Rio Brazos Rd., Aztec, NM 87410
District IV
2040 South Pacheco, Santa Fe, NM 87505

Energy, Minerals and Natural Resources

Revised March 25, 1999

OIL CONSERVATION DIVISION
2040 South Pacheco
Santa Fe, NM 87505

| | |
|---|--------------|
| WI | API NO. |
| | 30-025-33927 |
| 5. Indicate Type of Lease STATE <input type="checkbox"/> FEE <input checked="" type="checkbox"/> | |
| State Oil & Gas Lease No. | |

WELL COMPLETION OR RECOMPLETION REPORT AND LOG

| | | | |
|--|----------------------------------|--|---|
| 1a. Type of Well: OIL WELL <input checked="" type="checkbox"/> GAS WELL <input type="checkbox"/> DRY <input type="checkbox"/> OTHER _____ | | 7. Lease Name or Unit Agreement Name Kyte | |
| b. Type of Completion: NEW <input type="checkbox"/> WORK <input type="checkbox"/> DEEPEN <input type="checkbox"/> PLUG <input checked="" type="checkbox"/> BACK <input type="checkbox"/> DIFF. <input type="checkbox"/> RESVR. <input type="checkbox"/> OTHER _____ | | 8. Well No. 5 | |
| 2. Name of Operator Falcon Creek Resources | | 9. Pool name or Wildcat D-K Abo | |
| 3. Address of Operator 621 17th Street, Suite 1800, Denver, CO 80293 | | | |
| 4. Well Location Unit Letter <u>G</u> : 1980 Feet From The <u>North</u> Line and 1980 Feet From The <u>East</u> Line Section <u>23</u> Township <u>20-S</u> Range <u>38-E</u> NMPM Lea County | | | |
| 10. Date Spudded 4-24-97 | 11. Date T.D. Reached 5-11-97 | 12. Date Compl. (Ready to Prod.) 6-10-97 | 13. Elevations (DF& RKB, RT, GR, etc.) 3570 GR |
| 14. Elev. Casinghead 3570 | | | |
| 15. Total Depth 7800 | 16. Plug Back T.D. 7550 | 17. If Multiple Compl. How Many Zones? | 18. Intervals Drilled By RT |
| 19. Producing Interval(s), of this completion - Top, Bottom, Name 7325-7460 Abo | | | 20. Was Directional Survey Made Yes |
| 21. Type Electric and Other Logs Run Platform Express, CNL - DLL | | | 22. Was Well Cored No |

CASING RECORD (Report all strings set in well)

| CASING SIZE | WEIGHT LB./FT. | DEPTH SET | HOLE SIZE | CEMENTING RECORD | AMOUNT PULLED |
|-------------|----------------|-----------|-----------|------------------|---------------|
| 8 5/8" | 24 | 1631 | 12 1/2" | 750 sx "C" | |
| 5 1/2" | 17 | 7791 | 7 7/8" | 1230 sx "H" | |
| | | | | | |
| | | | | | |
| | | | | | |

LINER RECORD

| SIZE | TOP | BOTTOM | SACKS CEMENT | SCREEN |
|------|-----|--------|--------------|--------|
| | | | | |
| | | | | |
| | | | | |

TUBING RECORD

| SIZE | DEPTH SET | PACKER SET |
|--------|-----------|------------|
| 2 7/8" | 7232 | 7236 |
| | | |
| | | |

| | | |
|--|---|-------------------------------|
| 26. Perforation record (interval, size, and number) 7325-40, 7385-7400, 7456-60, 2 JSPF | 27. ACID, SHOT, FRACTURE, CEMENT, SQUEEZE, ETC. | |
| | DEPTH INTERVAL | AMOUNT AND KIND MATERIAL USED |
| | 7235-7460 | 925 gals. 15% NEFE |
| | | 5550 gals. 28% SXE |

PRODUCTION

| | | | | | | | |
|--|---------------------------|--|------------------------|---|-------------------|-------------------------------------|-----------------|
| 28. Date First Production 2-6-00 | | Production Method (Flowing, gas lift, pumping - Size and type pump) Pumping | | Well Status (Prod. or Shut-in) Prod. | | | |
| Date of Test 3-13-00 | Hours Tested 24 | Choke Size open | Prod'n For Test Period | Oil - Bbl 256 | Gas - MCF 213 | Water - Bbl. 0 | Gas - Oil Ratio |
| Flow Tubing Press. | Casing Pressure 40 psi | Calculated 24-Hour Rate | Oil - Bbl. 256 | Gas - MCF 213 | Water - Bbl. 0 | Oil Gravity - API - (Corr.) 41.4 | |
| 29. Disposition of Gas (Sold, used for fuel, vented, etc.) Sold | | | | | | Test Witnessed By Donny Money | |
| 30. List Attachments | | | | | | | |

31 I hereby certify that the information shown on both sides of this form as true and complete to the best of my knowledge and belief

Signature Gerald Lucero Printed Gerald Lucero Title Manager Operations Date 3-13-00

INSTRUCTIONS

This form is to be filed with the appropriate District Office of the Division not later than 20 days after the completion of any newly-drilled or deepened well. It shall be accompanied by one copy of all electrical and radio-activity logs run on the well and a summary of all special tests conducted, including drill stem tests. All depths reported shall be measured depths. In the case of directionally drilled wells, true vertical depths shall also be reported. For multiple completions, items 25 through 29 shall be reported for each zone. The form is to be filed in quintuplicate except on state land, where six copies are required. See Rule 1105.

INDICATE FORMATION TOPS IN CONFORMANCE WITH GEOGRAPHICAL SECTION OF STATE

Southeastern New Mexico

| | |
|--------------------|------------------|
| T. Anhy | T. Canyon |
| T. Salt | T. Strawn |
| B. Salt | T. Atoka |
| T. Yates 2870 | T. Miss |
| T. 7 Rivers 3130 | T. Devonian |
| T. Queen | T. Silurian |
| T. Grayburg | T. Montoya |
| T. San Andres 4250 | T. Simpson |
| T. Glorieta | T. McKee |
| T. Paddock | T. Ellenburger |
| T. Blinberry 5980 | T. Gr. Wash |
| T. Tubb | T. Delaware Sand |
| T. Drinkard 6910 | T. Bone Springs |
| T. Abo 7130 | T. |
| T. Wolfcamp | T. |
| T. Penn | T. |
| T. Cisco (Bough C) | T. |

Northwestern New Mexico

| | |
|-----------------------------|------------------------|
| T. Ojo Alamo _____ | T. Penn. "B" _____ |
| T. Kirtland-Fruitland _____ | T. Penn. "C" _____ |
| T. Pictured Cliffs _____ | T. Penn. "D" _____ |
| T. Cliff House _____ | T. Leadville _____ |
| T. Menefee _____ | T. Madison _____ |
| T. Point Lookout _____ | T. Elbert _____ |
| T. Mancos _____ | T. McCracken _____ |
| T. Gallup _____ | T. Ignacio Otzte _____ |
| Base Greenhorn _____ | T. Granite _____ |
| T. Dakota _____ | T. _____ |
| T. Morrison _____ | T. _____ |
| T. Todilto _____ | T. _____ |
| T. Entrada _____ | T. _____ |
| T. Wingate _____ | T. _____ |
| T. Chinle _____ | T. _____ |
| T. Permian _____ | T. _____ |
| T. Penn "A" _____ | T. _____ |

OIL OR GAS
SANDS OR ZONES

No. 1, from.....to.....
No. 2, from.....to.....

No. 3, from.....to.....
No. 4, from.....to.....

IMPORTANT WATER SANDS

Include data on rate of water inflow and elevation to which water rose in hole.

No. 1, from.....to.....feet.....

No. 2, from.....to.....feet.....

No. 3, from.....to.....feet.....

LITHOLOGY RECORD (Attach additional sheet if necessary)

| From | To | Thickness In Feet | Lithology |
|------|----|----------------------|-----------|
| | | | |

| From | To | Thickness In Feet | Lithology |
|------|----|----------------------|-----------|
| | | | |

DISTRICT II
P.O. Drawer DD, Artesia, NM 88211-0719

DISTRICT III
1000 Rio Brazos Rd., Aztec, NM 87410

DISTRICT IV
P.O. BOX 2088, SANTA FE, N.M. 87504-2088

Energy, Minerals and Natural Resources Department

Revised February 10, 1994
Submit to Appropriate District Office
State Lease - 4 Copies
Fee Lease - 3 Copies

OIL CONSERVATION DIVISION
P.O. Box 2088
Santa Fe, New Mexico 87504-2088

☐ AMENDED REPORT

WELL LOCATION AND ACREAGE DEDICATION PLAT

| | | |
|----------------------------|---|----------------------|
| API Number 30-025-33927 | Pool Code 15200 | Pool Name D-K Abo |
| Property Code 23402 | Property Name KYTE | Well Number 5 |
| GRID No. 169415 | Operator Name Falcon Creek Resources, Inc. | Elevation 3570' |

Surface Location

| | | | | | | | | | |
|--------------------|---------------|------------------|---------------|---------|-----------------------|---------------------------|-----------------------|------------------------|---------------|
| UL or lot No. G | Section 23 | Township 20 S | Range 38 E | Lot Idn | Feet from the 1980 | North/South line NORTH | Feet from the 1980 | East/West line EAST | County LEA |
|--------------------|---------------|------------------|---------------|---------|-----------------------|---------------------------|-----------------------|------------------------|---------------|

Bottom Hole Location If Different From Surface

| | | | | | | | | | |
|---------------|---------|----------|-------|---------|---------------|------------------|---------------|----------------|--------|
| UL or lot No. | Section | Township | Range | Lot Idn | Feet from the | North/South line | Feet from the | East/West line | County |
|---------------|---------|----------|-------|---------|---------------|------------------|---------------|----------------|--------|

| | | | |
|-----------------------|-----------------|--------------------|-----------|
| Dedicated Acres 40 | Joint or Infill | Consolidation Code | Order No. |
|-----------------------|-----------------|--------------------|-----------|

NO ALLOWABLE WILL BE ASSIGNED TO THIS COMPLETION UNTIL ALL INTERESTS HAVE BEEN CONSOLIDATED
OR A NON-STANDARD UNIT HAS BEEN APPROVED BY THE DIVISION

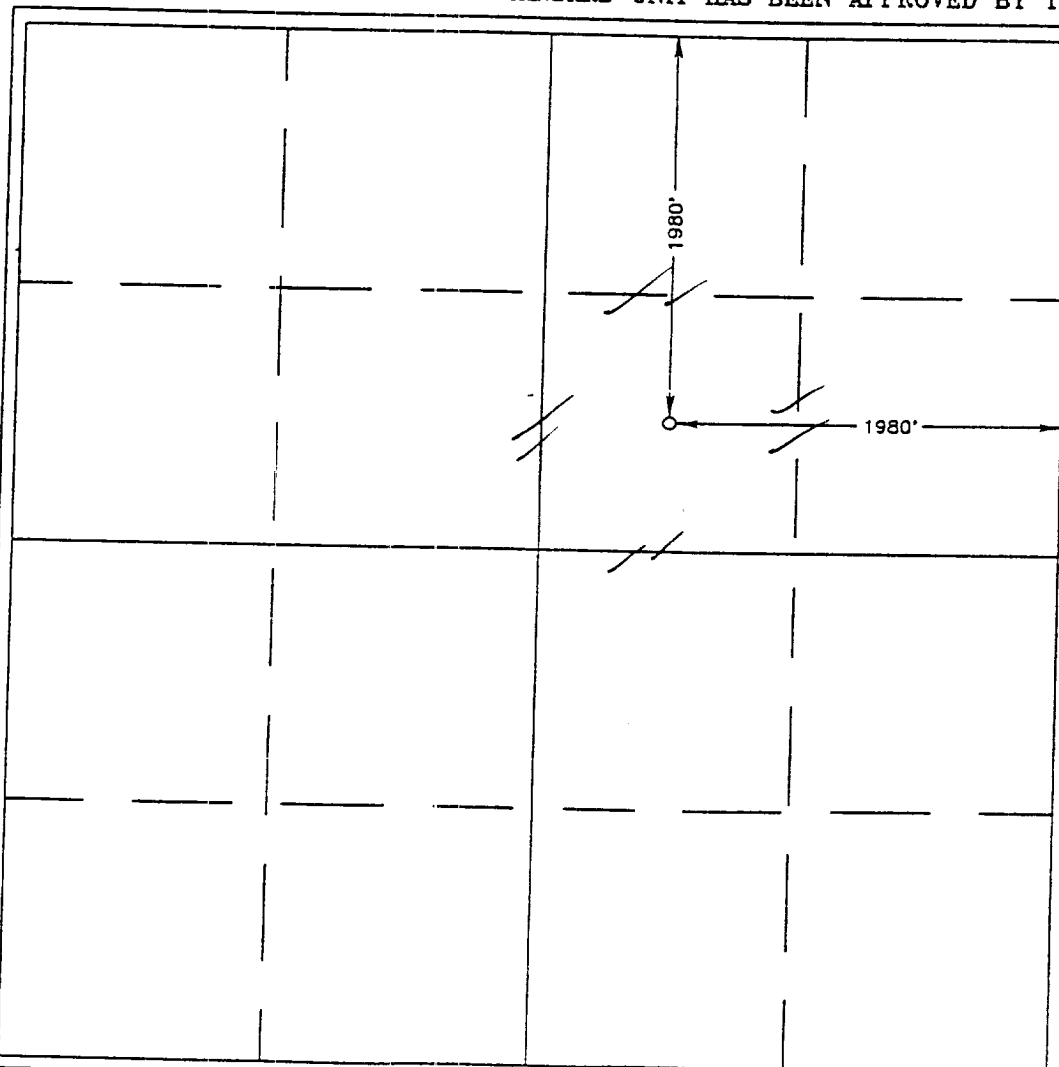

OPERATOR CERTIFICATION

I hereby certify the the information
contained herein is true and complete to the
best of my knowledge and belief.

Gerald Lucero
Signature

Gerald Lucero
Printed Name

Manager of Operations
Title

March 28, 00
Date

SURVEYOR CERTIFICATION

I hereby certify that the well location shown
on this plat was plotted from field notes of
actual surveys made by me or under my
supervision and that the same is true and
correct to the best of my belief.

APRIL 15, 1997

Date Surveyed CDG

Signature, & Seal of
Professional Surveyor

Ronald G. Edson
RONALD G. EDSON 4-16-97
67-11-0670

Certificate No. JOHN X. WES 676
RONALD G. EDSON 3239
GARY EDSON 12641