

DISTRICT I  
P. O. Box 1980  
Hobbs, NM 88241-1980

State of New Mexico  
Energy, Minerals, and Natural Resource Department

Form C-102  
Revised 12-10-94  
Instructions on back

DISTRICT II  
P. O. Drawer DD  
Artesia, NM 88211-0719

OIL CONSERVATION DIVISION  
P. O. Box 2088  
Santa Fe, New Mexico 87504-2088

Submit to the Appropriate  
District Office  
State Lease - 4 copies  
Fee Lease - 3 copies

DISTRICT III  
1000 Rio Brazos Rd.  
Aztec, NM 87410

☐ AMENDED REPORT

DISTRICT IV  
P. O. Box 2088  
Santa Fe, NM 87507-2088

WELL LOCATION AND ACREAGE DEDICATION PLAT

<sup>1</sup> API Number 30-025-33930	<sup>2</sup> Pool Code 96665	<sup>3</sup> Pool Name West Rio Chiso <del>North Bell Lake</del> (Morrow)
<sup>4</sup> Property Code 18928	<sup>5</sup> Property Name GAUCHO UNIT FEDERAL	<sup>6</sup> Well Number 4
<sup>7</sup> OGRID No. 20305	<sup>8</sup> Operator Name SANTA FE ENERGY RESOURCES, INC.	<sup>9</sup> Elevation 3454'

<sup>10</sup> SURFACE LOCATION

UL or lot no.	Section	Township	Range	Lot Ida	Feet from the	North/South line	Feet from the	East/West line	County
G	20	22 SOUTH	34 EAST, N.M.P.M.		1650'	NORTH	2310'	EAST	LEA

"BOTTOM HOLE LOCATION IF DIFFERENT FROM SURFACE

UL or lot no.	Section	Township	Range	Lot Ida	Feet from the	North/South line	Feet from the	East/West line	County

<sup>12</sup> Dedicated Acres 320	<sup>13</sup> Joint or Infill	<sup>14</sup> Consolidation Code	<sup>15</sup> Order No.
--------------------------------------	-------------------------------	----------------------------------	-------------------------

NO ALLOWABLE WELL BE ASSIGNED TO THIS COMPLETION UNTIL ALL INTERESTS HAVE BEEN  
CONSOLIDATED OR A NON-STANDARD UNIT HAS BEEN APPROVED BY THE DIVISION

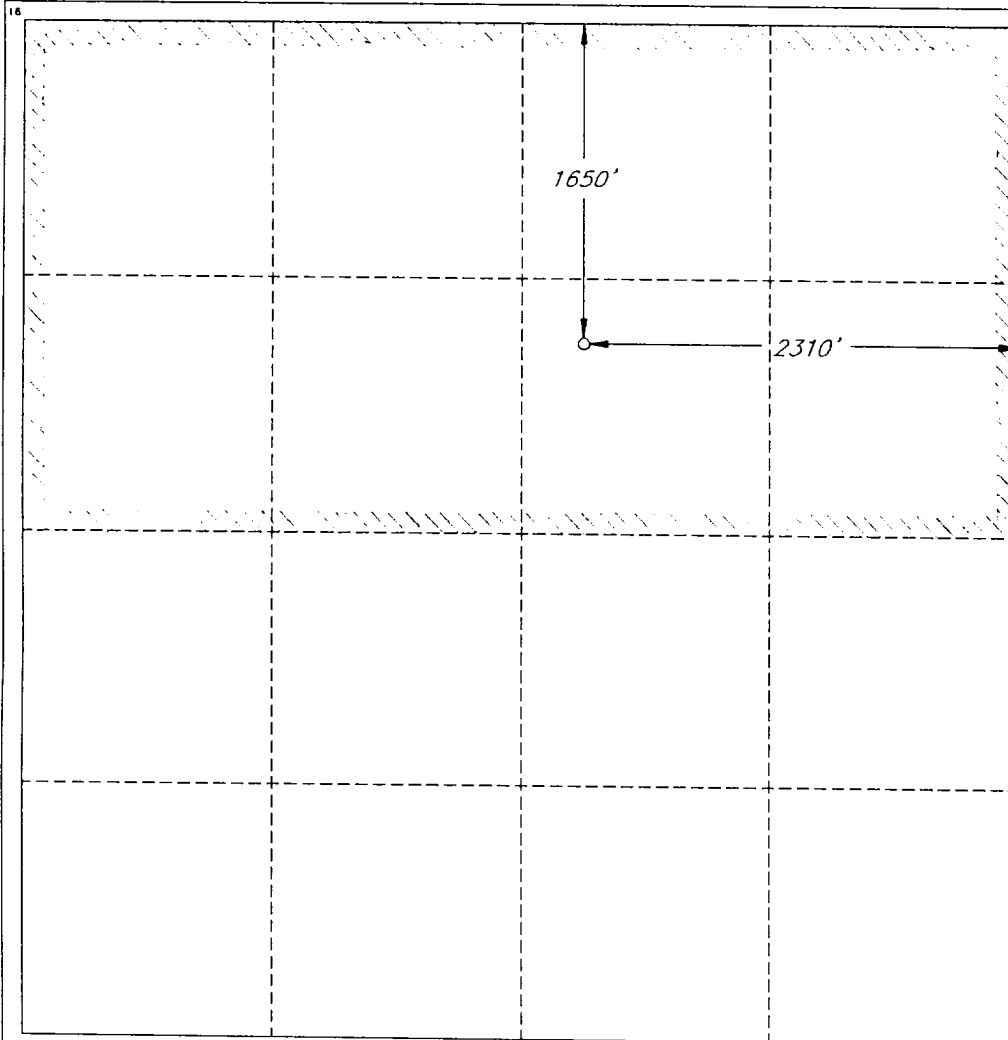

OPERATOR CERTIFICATION

I hereby certify that the information  
contained herein is true and complete  
to the best of my knowledge and belief.

Signature *James P. "Phil" Stinson*  
Printed Name  
James P. "Phil" Stinson  
Title  
Agent for Santa Fe Energy  
Date  
3-12-97

SURVEYOR CERTIFICATION

I hereby certify that the well  
location shown on this plat was  
plotted from field notes of actual  
surveys made by me or under  
my supervision, and that the  
same is true and correct to the  
best of my belief.

Date of Survey  
FEBRUARY 22, 1997

Signature and Seal of  
Professional Surveyor  
*Roger M. Robbins*  
Certificate No. 12128  
ROGER M. ROBBINS P.S. #12128  
JOB #50096-2 / 46NW / VHB