

District I
PO Box 1980, Hobbs, NM 88241-1980
District II
811 S. 1st Street, Artesia, NM 88210-2834
District III
1000 Rio Brazos Rd., Aztec, NM 87410
District IV
PO Box 2088, Santa Fe, NM 87504-2088

State of New Mexico
Energy, Minerals & Natural Resources Department

OIL CONSERVATION DIVISION
P.O. Box 2088
Santa Fe, NM 87504-2088

Form C-101
Revised February 10, 1994
Instructions on back
Submit to Appropriate District Office
State Lease - 6 Copies
Fee Lease - 5 Copies

☐ AMENDED REPORT

APPLICATION FOR PERMIT TO DRILL, RE-ENTER, DEEPEN, PLUGBACK, OR ADD A ZONE

¹ Operator name and Address Marathon Oil Company P.O. Box 552 Midland, Texas 79702		² OGRID Number 14021
⁴ Property Code 6398	⁵ Property Name HANSEN STATE	³ API Number 30-0 25-33967
		⁶ Well Number 7

⁷ Surface Location									
UL or lot no.	Section	Township	Range	Lot. Idn	Feet from the	North/South Line	Feet from the	East/West line	County
B	16	20-S	37-E	330	330	NORTH	1650	EAST	Lea

⁸ Proposed Bottom Hole Location If Different From Surface									
UL or lot no.	Section	Township	Range	Lot. Idn	Feet from the	North/South Line	Feet from the	East/West line	County
⁹ Proposed Pool 1 MONUMENT (PADDOCK)					¹⁰ Proposed Pool 2 Weir (Blinebry) Eunice Monument (Grayburg/SA)				

¹¹ Work Type Code N	¹² Well Type Code O	¹³ Cable/Rotary ROTARY	¹⁴ Lease Type Code S	¹⁵ Ground Level Elevation 3341
¹⁶ Multiple NO	¹⁷ Proposed Depth 6000'	¹⁸ Formations PADDOCK	¹⁹ Contractor UNKNOWN	²⁰ Spud Date 5/22/97

²¹ Proposed Casing and Cement Program					
Hole Size	Casing Size	Casing weight/foot	Setting Depth	Sacks of Cement	Estimated TOC
17 1/2"	16"	CONDUCTOR	40	REDI-MIX	SURFACE
12 1/4"	8 5/8"	24	1150'	400	SURFACE
7 7/8"	5 1/2"	15.5, 17	6000'	1200	SURFACE

²² Describe the proposed program. If this application is to DEEPEN or PLUG BACK give the data on the present productive zone and proposed new productive zone. Describe the blowout prevention program, if any. Use additional sheets if necessary

Proposed BOPE - 11" 3m dual ram, annular & rotating head. All BOPE shall be tested and installed according to NMOCD Rules #109 & #114.

All casing shall be run & cemented according to NMOCD Rule #107.

Permit Expires 1 Year From Approval
Date Unless Drilling Underway

²³ I hereby certify that the information given above is true and complete to the best of my knowledge and belief. Signature: <i>Walter J. Nordt</i> Printed name: D. P. NORDT Title: DRILLING SUPERINTENDENT Date: 5/13/97 Phone: 915/687-3327		OIL CONSERVATION DIVISION Approved by: <i>Paul Kautz</i> Title: Geologist Approval Date: MAY 19 1997 Expiration Date: Conditions of Approval: Attached <input type="checkbox"/>
--	--	--

DISTRICT I
P.O. Box 1980, Hobbs, NM 88241-1980

DISTRICT II
P.O. Drawer DD, Artesia, NM 88211-0719

DISTRICT III
1000 Rio Brazos Rd., Aztec, NM 87410

DISTRICT IV
P.O. BOX 2088, SANTA FE, N.M. 87504-2088

State of New Mexico
Energy, Minerals and Natural Resources Department

Form C-102
Revised February 10, 1994
Submit to Appropriate District Office
State Lease 4 Copies
Fee Lease - 3 Copies

OIL CONSERVATION DIVISION

P.O. Box 2088
Santa Fe, New Mexico 87504-2088

12 AMENDED REPORT

WELL LOCATION AND ACREAGE DEDICATION PLAT

API Number 30-025-33967	Pool Code 63780	Pool Name Weir (Blinebry)
Property Code 6398	Property Name HANSEN STATE	Well Number 1
OGRID No. 14021	Operator Name MARATHON OIL COMPANY	Elevation 5341

Surface Location

UL or lot No. 8	Section 16	Township 20 S	Range 37 E	Lot Idn	Feet from the 330	North/South line NORTH	Feet from the 1650	East/West line EAST	County LEA
---------------------------	----------------------	-------------------------	----------------------	---------	-----------------------------	----------------------------------	------------------------------	-------------------------------	----------------------

Bottom Hole Location If Different From Surface

UL or lot No.	Section	Township	Range	Lot Idn	Feet from the	North/South line	Feet from the	East/West line	County
---------------	---------	----------	-------	---------	---------------	------------------	---------------	----------------	--------

Dedicated Acres 40	Joint or Infill	Consolidation Code	Order No.
------------------------------	-----------------	--------------------	-----------

NO ALLOWABLE WILL BE ASSIGNED TO THIS COMPLETION UNTIL ALL INTERESTS HAVE BEEN CONSOLIDATED
OR A NON-STANDARD UNIT HAS BEEN APPROVED BY THE DIVISION

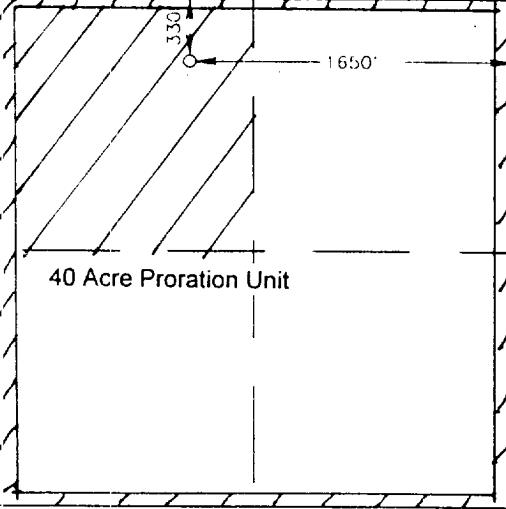
	40 Acre Proration Unit
	160 Acre Lease Boundary

OPERATOR CERTIFICATION

I hereby certify the the information contained herein is true and complete to the best of my knowledge and belief.

Walter J. Nordt
Signature

D. P. Nordt
Printed Name

Drilling Superintendent
Title

5/13/97
Date

SURVEYOR CERTIFICATION

I hereby certify that the well location shown on this plat was plotted from field notes of actual surveys made by me or under my supervision, and that the same is true and correct to the best of my belief.

MAY 7, 1997
Date Surveyed

DMCC

Donald J. Eidson
Signature & Seal of Professional Surveyor

5-0997
Professional Surveyor No.

5-0997
Professional Surveyor No.

JOHN W. WEST
Professional Surveyor No.

RONALD J. EIDSON
Professional Surveyor No.

676
Professional Surveyor No.

5239
Professional Surveyor No.

12641
Professional Surveyor No.

DISTRICT I
P.O. Box 1980, Hobbs, NM 88241-1980

DISTRICT II
P.O. Drawer DD, Artesia, NM 88211-0719

DISTRICT III
1000 Rio Brazos Rd., Aztec, NM 87410

DISTRICT IV
P.O. BOX 2088, SANTA FE, N.M. 87504-2088

State of New Mexico
Energy, Minerals and Natural Resources Department

Form C-102
Revised February 10, 1994
Submit to Appropriate District Office
State Lease - 4 Copies
Fee Lease - 3 Copies

OIL CONSERVATION DIVISION

P.O. Box 2088
Santa Fe, New Mexico 87504-2088

☐ AMENDED REPORT

WELL LOCATION AND ACREAGE DEDICATION PLAT

API Number 38-025-33967	Pool Code 85410	Pool Name Skaggs Abo
Property Code 6398	Property Name HANSEN STATE	Well Number 7
GRID No. 14021	Operator Name VARATHON OIL COMPANY	Elevation 3341

Surface Location

UL or lot No.	Section	Township	Range	Lot Idn	Feet from the	North/South line	Feet from the	East/West line	County
B	16	20 S	37 E		330	NORTH	1650	EAST	LEA

Bottom Hole Location If Different From Surface

UL or lot No.	Section	Township	Range	Lot Idn	Feet from the	North/South line	Feet from the	East/West line	County

Dedicated Acres	Joint or Infill	Consolidation Code	Order No.
40			

NO ALLOWABLE WILL BE ASSIGNED TO THIS COMPLETION UNTIL ALL INTERESTS HAVE BEEN CONSOLIDATED
OR A NON-STANDARD UNIT HAS BEEN APPROVED BY THE DIVISION

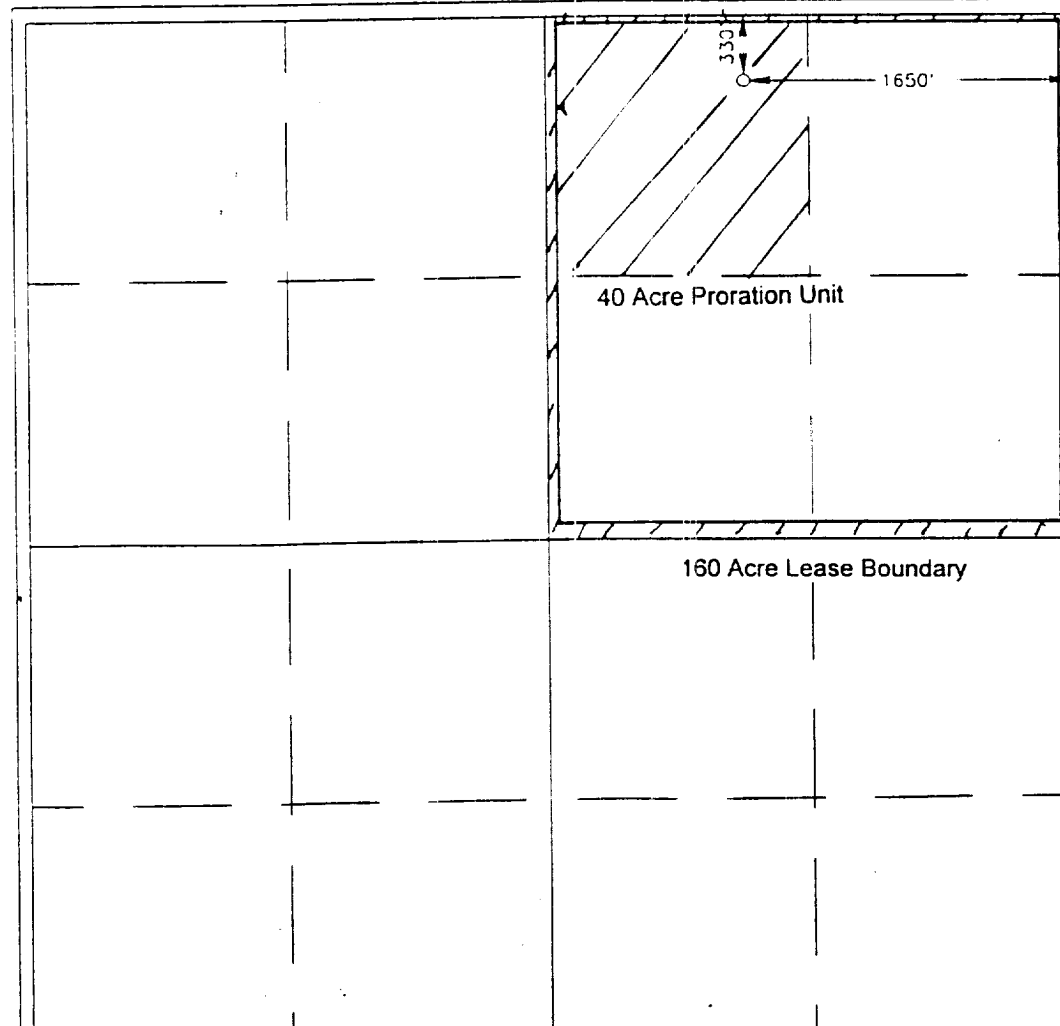

OPERATOR CERTIFICATION

I hereby certify the the information
contained herein is true and complete to the
best of my knowledge and belief.

Walter J. Nordt
Signature

D. P. Nordt

Printed Name

Drilling Superintendent

Title

5/13/97

Date

SURVEYOR CERTIFICATION

I hereby certify that the well location shown
on this plat was plotted from field notes of
actual surveys made by me or under my
supervision and that the same is true and
correct to the best of my belief.

MAY 7, 1997

Date Surveyed

DMCC

Signature & Seal of
Professional Surveyor

Ronald J. Eidson
5-0997
07-11-0799

Certificate No. JOHN W. WEST
RONALD J. EIDSON
MAY 1997

676
3239
12641

DISTRICT I
P.O. Box 1960, Hobbs, NM 88241-1960

DISTRICT II
P.O. Drawer DD, Artesia, NM 88211-0719

DISTRICT III
1000 Rio Brazos Rd., Aztec, NM 87410

DISTRICT IV
P.O. BOX 2088, SANTA FE, N.M. 87504-2088

State of New Mexico
Energy, Minerals and Natural Resources Department

Form C-102
Revised February 10, 1994
Submit to Appropriate District Office
State Lease - 4 Copies
Fee Lease - 3 Copies

OIL CONSERVATION DIVISION

P.O. Box 2088
Santa Fe, New Mexico 87504-2088

☐ AMENDED REPORT

WELL LOCATION AND ACREAGE DEDICATION PLAT

API Number	Pool Code 47080	Pool Name Monument (Paddock)
Property Code	Property Name HANSEN STATE	Well Number 7
GRID No. 14021	Operator Name MARATHON OIL COMPANY	Elevation 3341



Surface Location

UL or lot No.	Section	Township	Range	Lot Idn	Feet from the	North/South line	Feet from the	East/West line	County
6	16	20 S	37 E		330	NORTH	1650	EAST	LEA

Bottom Hole Location If Different From Surface

UL or lot No.	Section	Township	Range	Lot Idn	Feet from the	North/South line	Feet from the	East/West line	County
Dedicated Acres 40	Joint or Infill	Consolidation Code	Order No.						

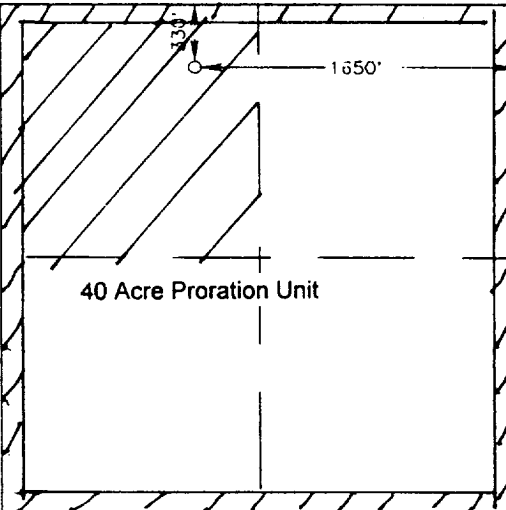
NO ALLOWABLE WILL BE ASSIGNED TO THIS COMPLETION UNTIL ALL INTERESTS HAVE BEEN CONSOLIDATED
OR A NON-STANDARD UNIT HAS BEEN APPROVED BY THE DIVISION

	OPERATOR CERTIFICATION I hereby certify the the information contained herein is true and complete to the best of my knowledge and belief.  Signature D. P. Nordt Printed Name Drilling Superintendent Title 5/13/97 Date
	SURVEYOR CERTIFICATION I hereby certify that the well location shown on this plat was plotted from field notes of actual surveys made by me or under my supervision, and that the same is true and correct to the best of my belief. MAY 7, 1997 Date Surveyed Signature of Seal Professional Surveyor JOHN W. EIDSON NEW MEXICO 5-09-97 5-11-0799 Certified No. JOHN W. EIDSON 676 3239 12641

DISTRICT I
P.O. Box 1980, Hobbs, NM 88241-1980

DISTRICT II
P.O. Drawer DD, Artesia, NM 88211-0719

DISTRICT III
1000 Rio Brazos Rd., Aztec, NM 87410

DISTRICT IV
P.O. BOX 2088, SANTA FE, N.M. 87504-2088

State of New Mexico
Energy, Minerals and Natural Resources Department

Form C-102
Revised February 10, 1994
Submit to Appropriate District Office
State Lease - 4 Copies
Fee Lease - 3 Copies

OIL CONSERVATION DIVISION

P.O. Box 2088
Santa Fe, New Mexico 87504-2088

☐ AMENDED REPORT

WELL LOCATION AND ACREAGE DEDICATION PLAT

API Number	Pool Code 23000	Pool Name Eunice Monument (Grayburg/San Andres)
Property Code	Property Name HANSEN STATE	Well Number 7
OGRID No. 14021	Operator Name MARATHON OIL COMPANY	Elevation 5341

Surface Location

UL or lot No. 3	Section 16	Township 20 N	Range 37 E	Lot Idn	Feet from the 330	North/South line NORTH	Feet from the 1650	East/West line EAST	County LEA
--------------------	---------------	------------------	---------------	---------	----------------------	---------------------------	-----------------------	------------------------	---------------

Bottom Hole Location If Different From Surface

UL or lot No.	Section	Township	Range	Lot Idn	Feet from the	North/South line	Feet from the	East/West line	County
Dedicated Acres 40		Joint or Infill	Consolidation Code	Order No.					

NO ALLOWABLE WILL BE ASSIGNED TO THIS COMPLETION UNTIL ALL INTERESTS HAVE BEEN CONSOLIDATED
OR A NON-STANDARD UNIT HAS BEEN APPROVED BY THE DIVISION

	OPERATOR CERTIFICATION I hereby certify that the information contained herein is true and complete to the best of my knowledge and belief. Signature D. P. Nordt Printed Name Drilling Superintendent Title 5/13/97 Date
	SURVEYOR CERTIFICATION I hereby certify that the well location shown on this plat was plotted from field notes of actual surveys made by me or under my supervision, and that the same is true and correct to the best of my belief. MAY 7, 1997 Date Surveyed Signature of Seal of Professional Surveyor Professional Surveyor 5-09-97 5-09-97 Certificate No. JOHN W. WEST 676 RONALD L. EIDSON 3239 RONALD L. EIDSON 12641



6/6/11

11