

UNITED STATES  
DEPARTMENT OF THE INTERIOR  
BUREAU OF LAND MANAGEMENT

FORM APPROVED  
Budget Bureau No. 1004-0135  
Expires: March 31, 1993

**SUNDRY NOTICES AND REPORTS ON WELLS**

Do not use this form for proposals to drill or to deepen or reentry to a different reservoir.  
Use "APPLICATION FOR PERMIT—" for such proposals

5. Lease Designation and Serial No.

LC 031670A

6. If Indian, Allottee or Tribe Name

7. If Unit or CA, Agreement Designation

8. Well Name and No.

SEMU Burger B # 126

9. API Well No.

30-0125-34127

10. Field and Pool, or Exploratory Area

11. County or Parish, State

Lea Co., NM

**SUBMIT IN TRIPLICATE**

1. Type of Well

☐ Oil Well ☒ Gas Well ☐ Other

2. Name of Operator

CONOCO INC.

3. Address and Telephone No.

10 DESTA DR. STE. 100W, MIDLAND, TX. 79705-4500 (915) 686-5424

4. Location of Well (Footage, Sec., T. R. M. or Survey Description)

Section 19, T-20-S, R-38-E, M  
1310' FSL & 1120' FWL

**CHECK APPROPRIATE BOX(s) TO INDICATE NATURE OF NOTICE, REPORT, OR OTHER DATA**

**TYPE OF SUBMISSION**

- ☒ Notice of Intent  
☐ Subsequent Repon  
☐ Final Abandonment Notice

**TYPE OF ACTION**

- ☐ Abandonment  
☒ Recompletion  
☐ Plugging Back  
☐ Casing Repair  
☐ Altering Casing  
☐ Other \_\_\_\_\_
- ☐ Change of Plans  
☐ New Construction  
☐ Non-Routine Fracrunng  
☐ Water Shut-Off  
☐ Conversion to Injection  
☐ Dispose Water

(Note: Repon results of multiple completion well Completion or Recompletion Report and Log form.)

13. Describe Proposed or Completed Operations (Clearly state all pertinent details, and give pertinent dates, including estimated date of starting any proposed work. If well is directionally drilled, give subsurface locations and measured and true vertical depths for all markers and zones pertinent to this work.)\*

Conoco, Inc proposes to Recomplete this well to the Eumont using the following procedure:

1. MIRU Pull production equipment
2. RIH w/RBP and set at 6700' Dump Bail 35' cement on plug Test plug to 500 psig
3. Perf and stimulate 7 rivers interval from 2759-3331'
4. RIH w/production equipment and put on production

\* NSP Applied for

14. I hereby certify that the foregoing is true and correct

Signed

*Kay Maddox*

Title

Kay Maddox

-Regulatory Agent

Date

December 16, 1999

(This space for Federal or State office use)

Approved by

(ORIG. SGD.) ALEXIS C. SWOBODA

Title

PETROLEUM ENGINEER

Date

DEC 21 1999

Conditions of approval if any:

BLM(6), NMOCD(1), SHEAR, PONCA, COST ASST, FILE ROOM

Title 18 U.S.C. Section 1001, makes it a crime for any person knowingly and willfully to make to any department or agency of the United States any false, fictitious or fraudulent statements or representations as to any matter within its jurisdiction.

\*See Instruction on Reverse Side

District I  
PO Box 1980, Hobbs, NM 88241-1980

District II  
PO Drawer DD, Artesia, NM 88211-0719

District III  
1000 Rio Brazos Rd. Aztec, NM 87410

District IV  
PO Box 2088, Santa Fe, NM 87504-2088

State of New Mexico  
Energy, Minerals & Natural Resources Department

OIL CONSERVATION DIVISION  
PO Box 2088  
Santa Fe, NM 87504-2088

Form C-102

Revised February 21, 1994  
Instructions on back

Submit to Appropriate District Office  
State Lease - 4 Copies  
Fee Lease - 3 Copies

☐ AMENDED REPORT

### WELL LOCATION AND ACREAGE DEDICATION PLAT

API Number 30-025-34127		2 Pool Code 76480		3 Pool Name Eumont Yates Seven Rvrs Qn	
4 Property Code 3078		5 Property Name SEMU Burger B			6 Well Number #126
7 OGRID No. 005073		8 Operator Name Conoco Inc., 10 Desta Drive, Ste. 100W, Midland, TX 79705-4500			9 Elevation 3535'

#### 10 Surface Location

UL or lot no. M	Section 19	Township 20S	Range 38E	Lot Idn	Feet from the 1310	North/South line South	Feet from the 1120'	East/West line West	County Lea
--------------------	---------------	-----------------	--------------	---------	-----------------------	---------------------------	------------------------	------------------------	---------------

#### 11 Bottom Hole Location If Different From Surface

UL or lot no.	Section	Township	Range	Lot Idn	Feet from the	North/South line	Feet from the	East/West line	County
12 Dedicated Acres 440	13 Joint or Infill	14 Consolidation Code		15 Order No.					

NO ALLOWABLE WILL BE ASSIGNED TO THIS COMPLETION UNTIL ALL INTERESTS HAVE BEEN CONSOLIDATED  
OR A NON-STANDARD UNIT HAS BEEN APPROVED BY THE DIVISION

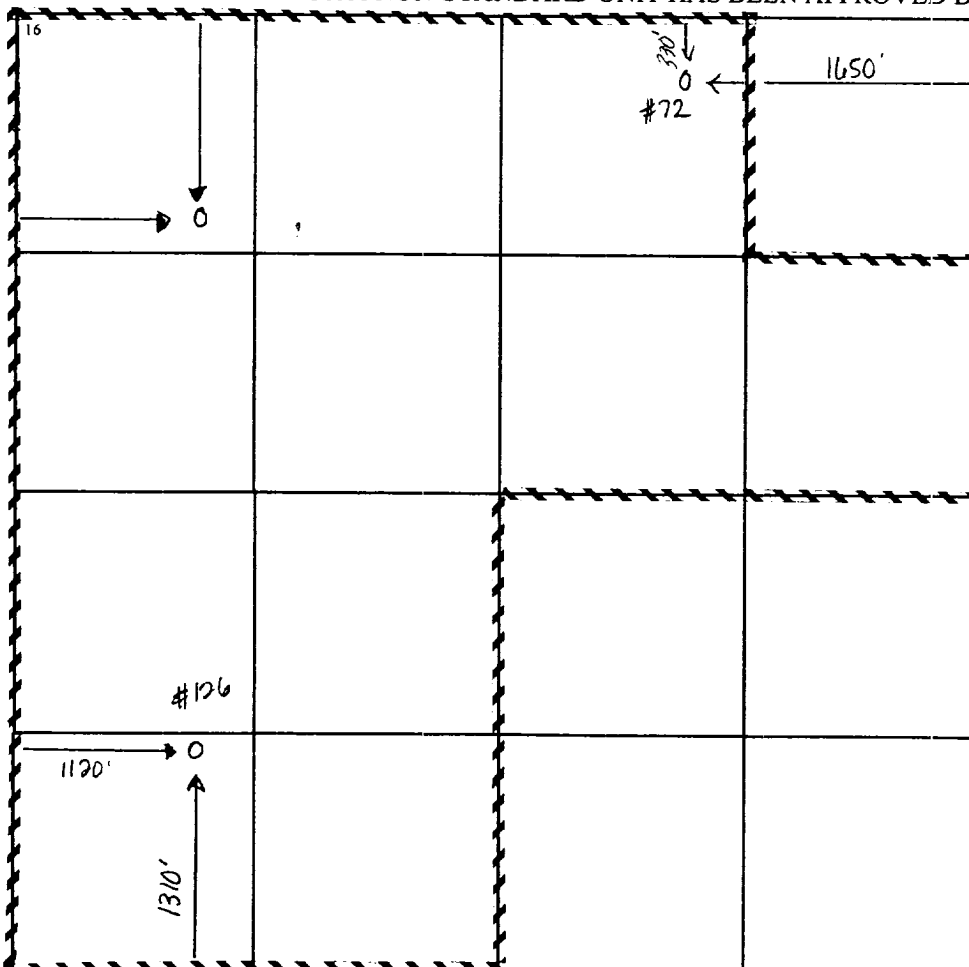

#### 17 OPERATOR CERTIFICATION

I hereby certify that the information contained herein is true and complete to the best of my knowledge and belief

*Kay Maddox*  
Signature  
Kay Maddox

Printed Name  
Regulatory Agent

Title  
December 15, 1999

Date

#### 18 SURVEYOR CERTIFICATION

I hereby certify that the well location shown on this plat was plotted from field notes of actual surveys made by me or under my supervision, and that the same is true and correct to the best of my belief.

Date of Survey  
Signature and Seal of Professional Surveyor:

Certificate Number