

UNITED STATES
DEPARTMENT OF THE INTERIOR
BUREAU OF LAND MANAGEMENT

FORM APPROVED
Budget Bureau No. 1004-0135
Expires: March 31, 1993

SUNDRY NOTICES AND REPORTS ON WELLS

Do not use this form for proposals to drill or to deepen or reentry to a different reservoir.
Use "APPLICATION FOR PERMIT—" for such proposals

SUBMIT IN TRIPLICATE

1. Type of Well

☐ Oil Well ☐ Gas Well ☒ Other

2. Name of Operator

CONOCO INC.

3. Address and Telephone No.

10 DESTA DR. STE. 430E, MIDLAND, TX. 79705-4500

4. Location of Well (Footage, Sec., T. R. M. or Survey Description)

Section 27, T-21-S, R-37-E
660' FNL & 2200' FEL

5. Lease Designation and Serial No.

LC032096A

6. If Indian, Allottee or Tribe Name

7. If Unit or CA, Agreement Designation

Lockhart A 27

8. Well Name and No.

16

9. API Well No.

10. Field and Pool, or Exploratory Area

Tubb Oil & Gas

11. County or Parish, State

Lea County, NM

CHECK APPROPRIATE BOX(s) TO INDICATE NATURE OF NOTICE, REPORT, OR OTHER DATA

TYPE OF SUBMISSION

- ☒ Notice of Intent
☐ Subsequent Repon
☐ Final Abandonment Notice

TYPE OF ACTION

- ☐ Abandonment
☐ Recompletion
☐ Plugging Back
☐ Casing Repair
☐ Altering Casing
☒ Other Move location
☐ Change of Plans
☒ New Construction
☐ Non-Routine Fracrunng
☐ Water Shut-Off
☐ Conversion to Injection
☐ Dispose Water

(Note: Repon results of multiple completion on Well Completion or Recompletion Report and Log form.)

13. Describe Proposed or Completed Operations (Clearly state all pertinent details, and give pertinent dates, including estimated date of starting any proposed work. If well is directionally drilled, give subsurface locations and measured and true vertical depths for all markers and zones pertinent to this work.)*

Due to existing buried pipeline, it is necessary for Conoco to move the location 120' to the west; the new location being 660' FNL & 2200' FEL, Section 27, T-21-S, R-37-E which remains within the 400' x 400' site with previous archeological clearance Desert West Report No. 98-16J.

The attached plats reflect the changes.

14. I hereby certify that the foregoing is true and correct

Signed

Jo Ann Johnson

Title

Jo Ann Johnson

Property Analyst

Date

2/26/98

(This space for Federal or State office use)

Approved by

RODOLFO SOTO GARCIA GOURLEY

Title

PETROLEUM ENGINEER

Date

MAR 03 1998

Conditions of approval if any:

BLM(6), SHEAR, PONCA, COST ASST, FILE ROOM

Title 18 U.S.C. Section 1001, makes it a crime for any person knowingly and willfully to make to any department or agency of the United States any false, fictitious or fraudulent statements or representations as to any matter within its jurisdiction.

*See Instruction on Reverse Side

District I
PO Box 1980, Hobbs, NM 88241-1980
District II
PO Drawer DD, Artesia, NM 88211-0719
District III
1000 Rio Brazos Rd., Aztec, NM 87410
District IV
PO Box 2088, Santa Fe, NM 87504-2088

State of New Mexico
Energy, Minerals & Natural Resources Department
OIL CONSERVATION DIVISION
PO Box 2088
Santa Fe, NM 87504-2088

Form C-102
Revised February 21, 1994
Instructions on back
Submit to Appropriate District Office
State Lease - 4 Copies
Fee Lease - 3 Copies

☐ AMENDED REPORT

WELL LOCATION AND ACREAGE DEDICATION PLAT

*API Number		*Pool Code	*Pool Name
		60240	Tubb Oil and Gas
*Property Code	*Property Name		*Well Number
003039	LOCKHART A-27		16
*OGRID No.	*Operator Name		*Elevation
005073	CONOCO INC.		3404'

¹⁰ Surface Location

UL or lot no.	Section	Township	Range	Lot Idn	Feet from the	North/South line	Feet from the	East/West line	County
B	27	21-S	37-E		660	NORTH	2200	EAST	LEA

¹¹ Bottom Hole Location If Different From Surface

UL or lot no.	Section	Township	Range	Lot Idn	Feet from the	North/South line	Feet from the	East/West line	County
*Dedicated Acres		*Joint or Infill		*Consolidation Code		*Order No.			
40									

NO ALLOWABLE WILL BE ASSIGNED TO THIS COMPLETION UNTIL ALL INTERESTS HAVE BEEN CONSOLIDATED
OR A NON-STANDARD UNIT HAS BEEN APPROVED BY THE DIVISION

16			<p>¹⁷ OPERATOR CERTIFICATION</p> <p>I hereby certify that the information contained herein is true and complete to the best of my knowledge and belief.</p> <p><i>Jo Ann Johnson</i></p> <p>Signature</p> <p>Jo Ann Johnson</p> <p>Printed Name</p> <p>Property Analyst</p> <p>Title</p> <p>2/26/98</p> <p>Date</p>	
				<p>¹⁸ SURVEYOR CERTIFICATION</p> <p>I hereby certify that the well location shown on this plat was plotted from field notes of actual surveys made by me or under my supervision, and that the same is true and correct to best of my belief.</p> <p>FEBRUARY 26, 1998</p> <p>Date of Survey</p> <p>Signature and Seal of Professional Surveyor:</p> <p></p> <p>Certificate Number 8278</p>

Amended

VICINITY MAP

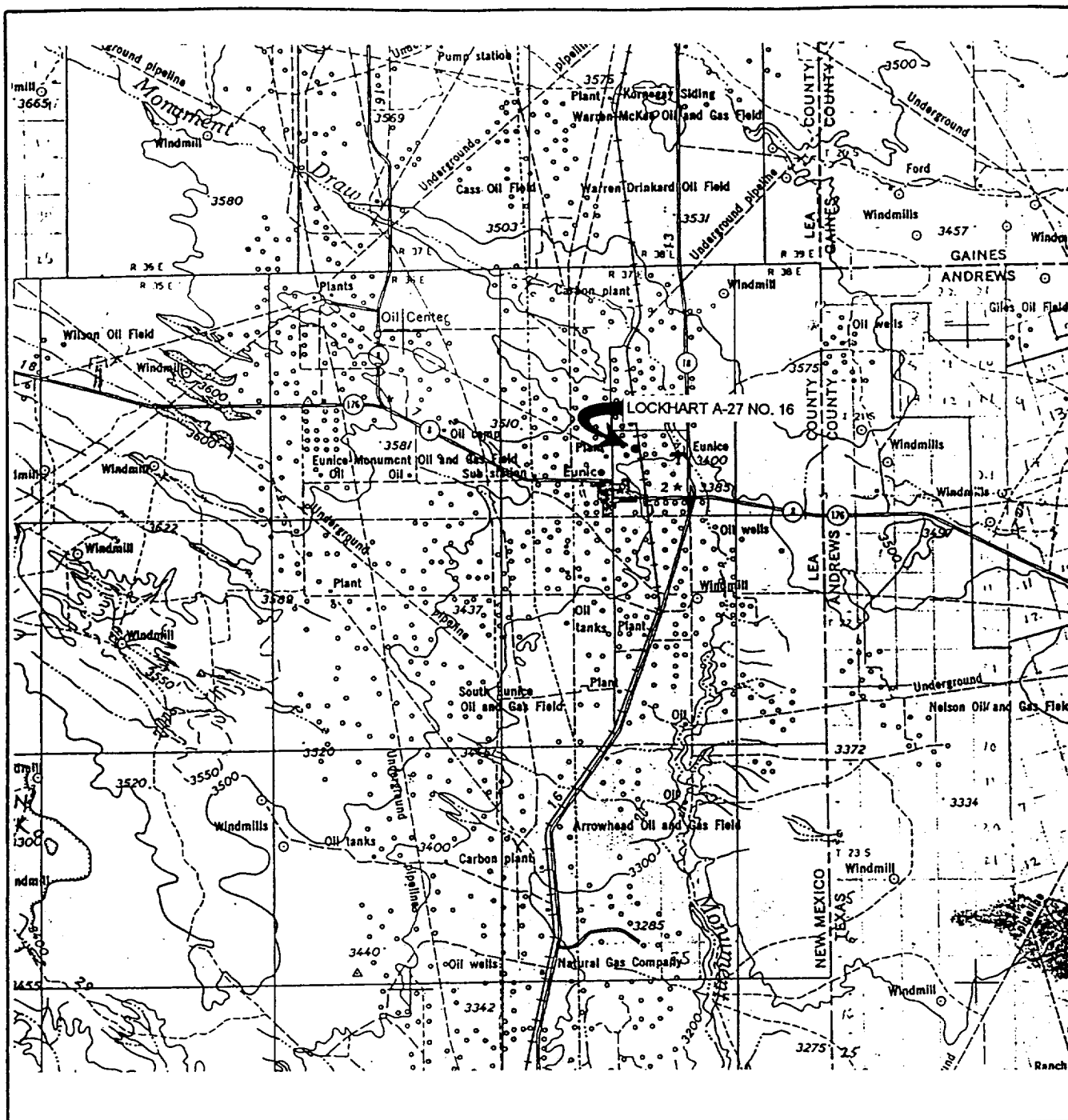

WTC 45075

SCALE: 1" = 4 MILES

SEC. 27 TWP. 21-S RGE. 37-E

SURVEY N.M.P.M

COUNTY LEA STATE NM

DESCRIPTION 660' FNL & 2200' FEL

ELEVATION 3404'

OPERATOR CONOCO INC.

LEASE LOCKHART A-27 NO. 16

WEST TEXAS CONSULTANTS, INC.

ENGINEERS-PLANNERS-SURVEYORS

MIDLAND, TEXAS

915-685-3800

LOCATION VERIFICATION MAP

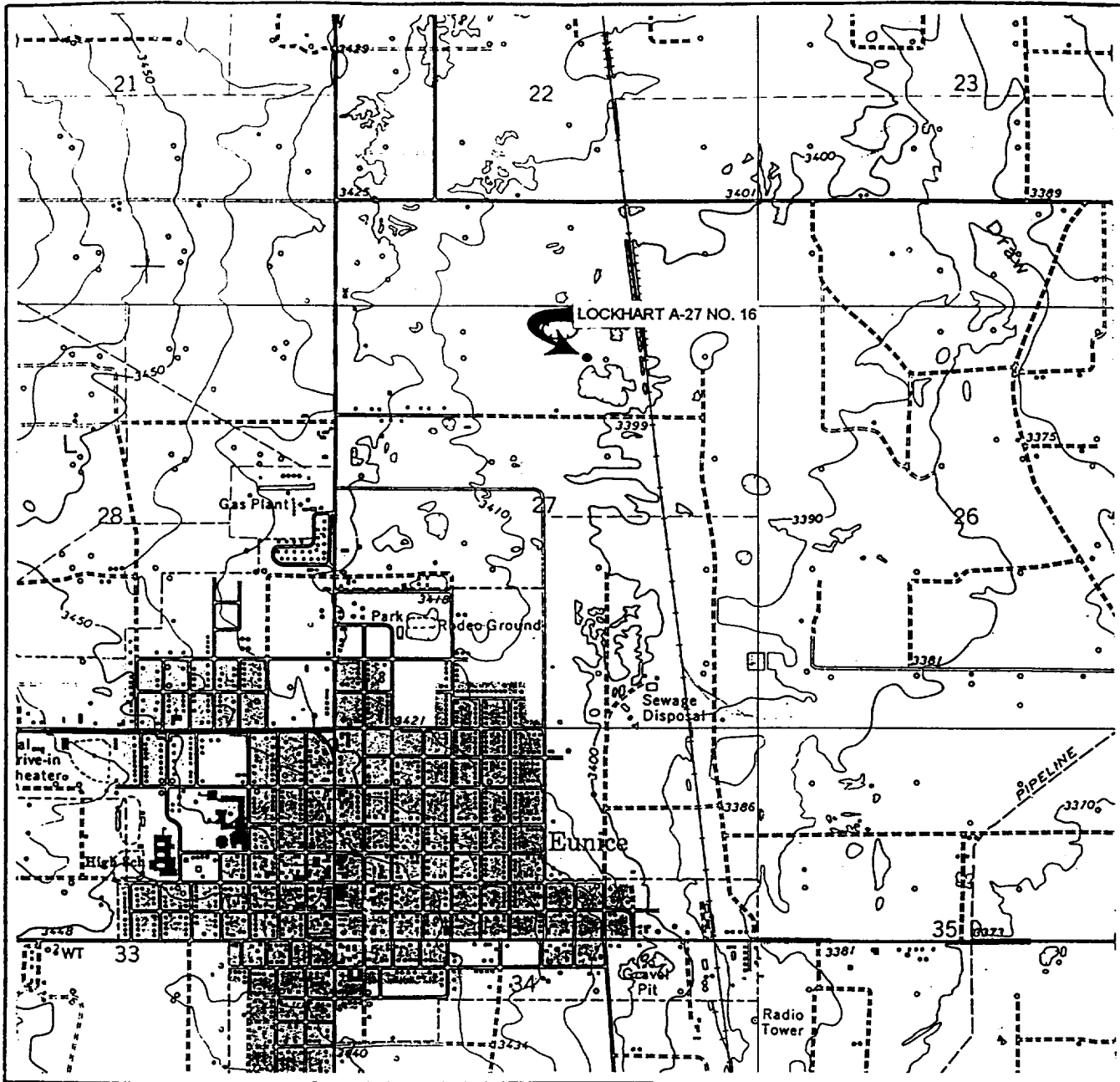

SCALE: 1" = 2000'
WTC 45075

SEC. 27 TWP. 21-S RGE. 37-E

SURVEY N.M.P.M

COUNTY LEA STATE NM

DESCRIPTION 660' FNL & 2200' FEL

ELEVATION 3404'

OPERATOR CONOCO INC.

LEASE LOCKHART A-27 NO. 16

USGS TOPO MAP EUNICE, NEW MEXICO

CONTOUR INTERVAL 10'

WEST TEXAS CONSULTANTS, INC.

ENGINEERS-PLANNERS-SURVEYORS

MIDLAND, TEXAS

915-685-3800