

District I
1625 N. French Dr., Hobbs, NM 88240
District II
811 South First, Artesia, NM 88210
District III
1000 Rio Brazos Rd., Aztec, NM 87410
District IV
2040 South Pacheco, Santa Fe, NM 87505

State of New Mexico
Energy, Minerals & Natural Resources Department

OIL CONSERVATION DIVISION
2040 South Pacheco
Santa Fe, NM 87505

Form C-101
Revised October 18, 1994
Instructions on Back
Submit to Appropriate District Office
State Lease - 6 Copies
Fee Lease - 5 Copies

☐ AMENDED REPORT

APPLICATION FOR PERMIT TO DRILL, RE-ENTER, DEEPEN, PLUGBACK, OR ADD A ZONE

1 Operator Name and Address Apache Corporation 2000 Post Oak Blvd., Suite 100 Houston, Texas 77056-4400		2 OGRID Number 000873
4 Property Code 22879		3 API Number 30-025-34321
5 Property Name Owen 'B'		6 Well No. 6

7 Surface Location									
UL or lot no.	Section	Township	Range	Lot Idn	Feet from the	North/South Line	Feet from the	East/West Line	County
K	34	21S	37E		1980	South	2180	West	Lea

8 Proposed Bottom Hole Location If Different From Surface									
UL or lot no.	Section	Township	Range	Lot Idn	Feet from the	North/South Line	Feet from the	East/West Line	County
9 Proposed Pool 1 Blinebry Oil and Gas (06660)					10 Proposed Pool 2				

11 Work Type Code A	12 Well Type Code M	13 Cable/Rotary	14 Lease Type Code P	15 Ground Level Elevation 3429'
16 Multiple Y (DHC-2068)	17 Proposed Depth 7500 TD	18 Formation Blinebry	19 Contractor	20 Spud Date ASAP

21 Proposed Casing and Cement Program					
Hole Size	Casing Size	Casing weight/foot	Setting Depth	Sacks of Cement	Estimated TOC
12-1/4	9-5/8	32#	1030	415	Circulated 109 sx
7-7/8	5-1/2	17#	5487	1700	TOC @ 1380'
					Bradenhead squeeze
					w/400 sx
5-1/2 casing	4-1/2 liner	11#	5277 - 7500	585	

22 Describe the proposed program. If this application is to DEEPEN or PLUG BACK give the data on the present productive zone and proposed new productive zone. Describe the blowout prevention program, if any. Use additional sheets if necessary.

Well is currently producing under Downhole Commingle Permit DHC-2068 in the Tubb Oil & Gas (86440), Drinkard (19190) and Wantz; Abo (62700) pools. Apache Corporation proposes to add the Blinebry Oil and Gas (06660) pool, test the referenced pool for production capability and if successful, amend the existing Downhole Commingling Permit to include the Blinebry Oil and Gas pool.

Permit Expires 1 Year From Date of Approval
Date Unless Drilling Underway

Adding

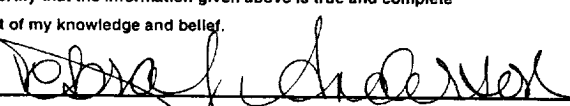
23 I hereby certify that the information given above is true and complete to the best of my knowledge and belief.		OIL CONSERVATION DIVISION	
Signature: 		Approved by: ORIGINAL SIGNED BY CHRIS WILLIAMS DISTRICT I SUPERVISOR	
Printed Name: Debra J. Anderson		Title:	
Title: Sr. Engineering Technician / 713-296-6338		Approval Date: OCT 20 1999 Expiration Date:	

5
C
3

mp



District I
1625 N. French Drive, Hobbs, NM 88240

District II
P O Drawer DD, Artesia, NM 88210

District III
1000 Rio Brazos Rd., Aztec, NM 87410

District IV
2040 South Pacheco, Santa Fe, NM 87505

State of New Mexico
Energy, Minerals and Natural Resources Department

OIL CONSERVATION DIVISION

2040 S. Pacheco
Santa Fe, New Mexico 87505

Form C-102

Revised October 18, 1994

Instruction on Back

Submit to Appropriate District Office

State Lease - 4 Copies

Fee Lease - 3 Copies

☐ AMENDED REPORT

WELL LOCATION AND ACREAGE DEDICATION PLAT

1 API Number 30-025-34321		2 Pool Code 06660		3 Pool Name Blinebry Oil and Gas	
4 Property Code 22879		5 Property Name Owen 'B'			6 Well Number 6
7 OGRID No. 000873		8 Operator Name Apache Corporation			9 Elevation 3429

10 Surface Location									
UL or Lot No. K	Section 34	Township 21S	Range 37E	Lot Idn	Feet from the 1980	North/South line South	Feet from the 2180	East/West line West	County Lea

11 Bottom Hole Location If Different From Surface									
UL or Lot No.	Section	Township	Range	Lot Idn	Feet from the	North/South line	Feet from the	East/West line	County

12 Dedicated Acres 40	13 Joint or Infill	14 Consolidation Code	14 Order No.
---------------------------------	--------------------	-----------------------	--------------

NO ALLOWABLE WILL BE ASSIGNED TO THIS COMPLETION UNTIL ALL INTERESTS HAVE BEEN CONSOLIDATED
OR A NON-STANDARD UNIT HAS BEEN APPROVED BY THE DIVISION

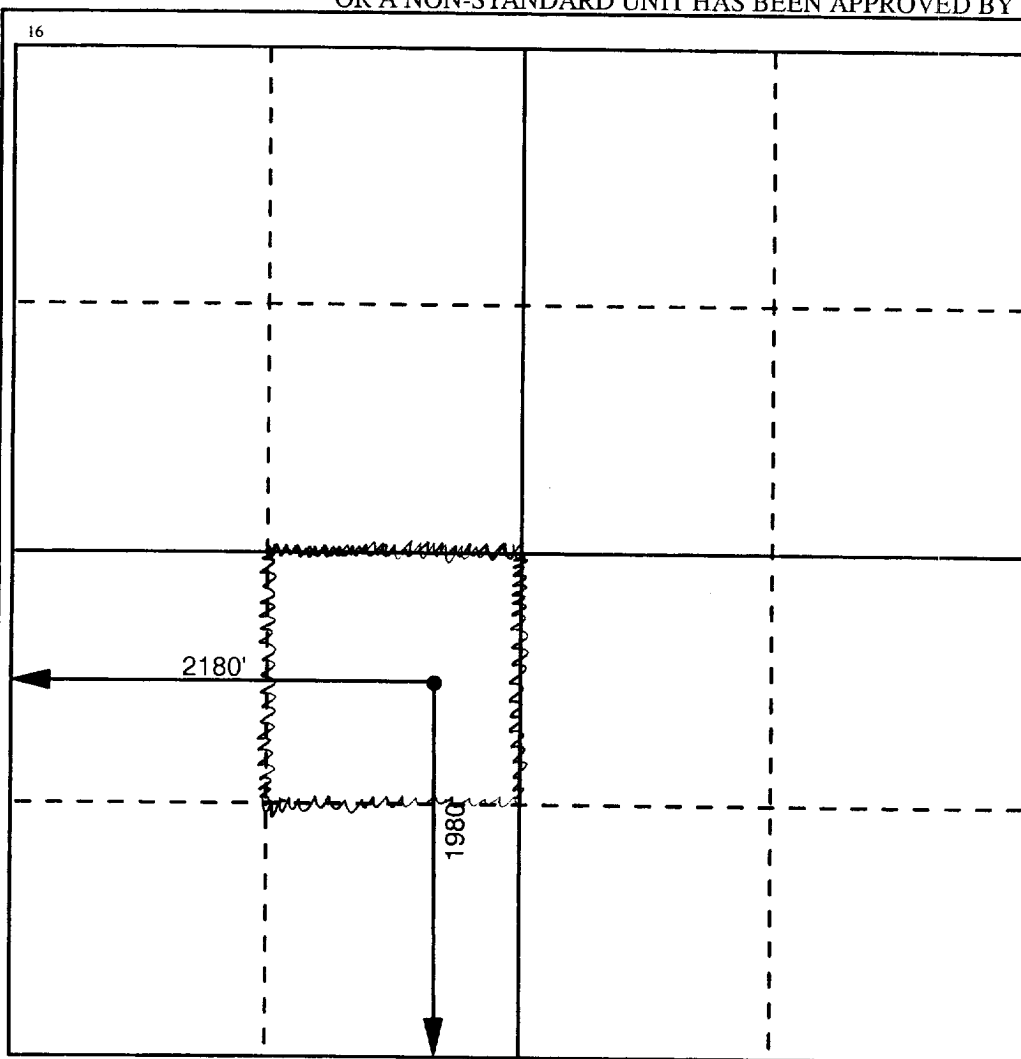

17 OPERATOR CERTIFICATION
I hereby certify that the information contained herein is true and complete to the best of my knowledge and belief.

Signature *Debra J. Anderson*
Printed Name **Debra J. Anderson**
Title **Sr. Engineering Technician**
Date **10/13/99**

18 SURVEYOR CERTIFICATION
I hereby certify that the well location shown on this plat was plotted from field notes of actual surveys made by me or under my supervision, and that the same is true and correct to the best of my belief.

Date Surveyed
Signature and Seal of Professional Surveyor
Certificate Number

RECEIVED
FEB 14 1964
CIVIL
CIVIL