

District I
PO Box 1980, Hobbs, NM 88241-1980
District II
811 South First, Artesia, NM 88210
District III
1000 Rio Brazos Rd., Aztec, NM 87410
District IV
2040 South Pacheco, Santa Fe, NM 87505

State of New Mexico
Energy, Minerals & Natural Resources Department

OIL CONSERVATION DIVISION
2040 South Pacheco
Santa Fe, NM 87505

Form C-1-1
Revised October 18, 1994
Instructions on back
Submit to Appropriate District Office
State Lease - 6 Copies
Fee Lease - 5 Copies

AMENDED REPORT

APPLICATION FOR PERMIT TO DRILL, RE-ENTER, DEEPEN, PLUGBACK, OR ADD A ZONE

¹ Operator Name and Address. Falcon Creek Resources, Inc. 621 17th Street, Suite 1800 Denver, Colorado 80293-0621		² OGRID Number 169415
		³ API Number 30-025-34457
⁴ Property Code 23402	⁵ Property Name Kyte	⁶ Well No. 9

⁷ Surface Location

UL or lot no.	Section	Township	Range	Lot Idn	Feet from the	North/South line	Feet from the	East/West line	County
C	23	20S	38E		660	North	1,980	West	Lea

⁸ Proposed Bottom Hole Location If Different From Surface

UL or lot no.	Section	Township	Range	Lot Idn	Feet from the	North/South line	Feet from the	East/West line	County
⁹ Proposed Pool 1 Blinebry					¹⁰ Proposed Pool 2 East Warren Tubb				

¹¹ Work Type Code N	¹² Well Type Code O	¹³ Cable/Rotary Rotary	¹⁴ Lease Type Code P	¹⁵ Ground Level Elevation 3567
¹⁶ Multiple Y	¹⁷ Proposed Depth 7,950'	¹⁸ Formation Abo	¹⁹ Contractor Unknown	²⁰ Spud Date When approved

²¹ Proposed Casing and Cement Program

Hole Size	Casing Size	Casing weight/foot	Setting Depth	Sacks of Cement	Estimated TOC
12-1/4"	9-5/8"	36 #/Ft	1600'	650	Circ
8-3/4"	7"	23 & 26 #/Ft	7950'	1850	Circ

²² Describe the proposed program. If this application is to DEEPEN or PLUG BACK give the data on the present productive zone and proposed new productive zone. Describe the blowout prevention program, if any. Use additional sheets if necessary.

1. Drill 12-1/4" hole to 1,600' or hard formation. Set 9-5/8" K-55 casing. Cement with 450 sx. of Class "C" +4% gel + 2% CaCl2. Tail with 200 sx. Class "C" + 2% CaCl2.
2. Drill 8-3/4" hole to 7,950'. Run Open Hole logs.
3. Set 7" 23 & 26 #/Ft K-55 at TD. Cement with 1,050 sx. of 35:65 POZ "C" +6% Gel + 5% salt + 1/4#/sx Cellflake. Tail with 800 sx. of Class H + 2% CaCl2. Circulate cement to surface.

²³ I hereby certify that the information given above is true and complete to the best of my knowledge and belief.

Signature: *Oscar L. Peters*

Printed name: Oscar L. Peters

Title: District Operations Engineer

Date: July 13, 1998

Phone: (303) 675-0007

OIL CONSERVATION DIVISION

Approved by: ORIGINAL SIGNED BY

Title: GARY W. WICK
FIELD REPRESENTATIVE

Approval Date: JUL 16 1998

Expiration Date:

Conditions of Approval:
Attached ☐

Permit Expires 1 Year From Approval
Date Unless Drilling Underway

DISTRICT I
P.O. Box 1980, Hobbs, NM 88241-1980

State of New Mexico
Energy, Minerals and Natural Resources Department

Form C-102
Revised February 10, 1994
Submit to Appropriate District Office
State Lease - 4 Copies
Fee Lease - 3 Copies

DISTRICT II
P.O. Drawer DD, Artesia, NM 88211-0719

DISTRICT III
1000 Rio Brazos Rd., Aztec, NM 87410

DISTRICT IV
P.O. BOX 2088, SANTA FE, N.M. 87504-2088

OIL CONSERVATION DIVISION
P.O. Box 2088
Santa Fe, New Mexico 87504-2088

☐ AMENDED REPORT

WELL LOCATION AND ACREAGE DEDICATION PLAT

API Number 30-D25-34457	Pool Code 60240 87085	Pool Name East Warren TUBB
Property Code 23402	Property Name KYTE	Well Number 9
OGRID No. 169415	Operator Name FALCON CREEK RESOURCES	Elevation 3567

Surface Location

UL or lot No. C	Section 23	Township 20 S	Range 38 E	Lot Idn	Feet from the 660	North/South line NORTH	Feet from the 1980	East/West line WEST	County LEA
---------------------------	----------------------	-------------------------	----------------------	---------	-----------------------------	----------------------------------	------------------------------	-------------------------------	----------------------

Bottom Hole Location If Different From Surface

UL or lot No.	Section	Township	Range	Lot Idn	Feet from the	North/South line	Feet from the	East/West line	County
Dedicated Acres 40	Joint or Infill	Consolidation Code	Order No.						

NO ALLOWABLE WILL BE ASSIGNED TO THIS COMPLETION UNTIL ALL INTERESTS HAVE BEEN CONSOLIDATED
OR A NON-STANDARD UNIT HAS BEEN APPROVED BY THE DIVISION

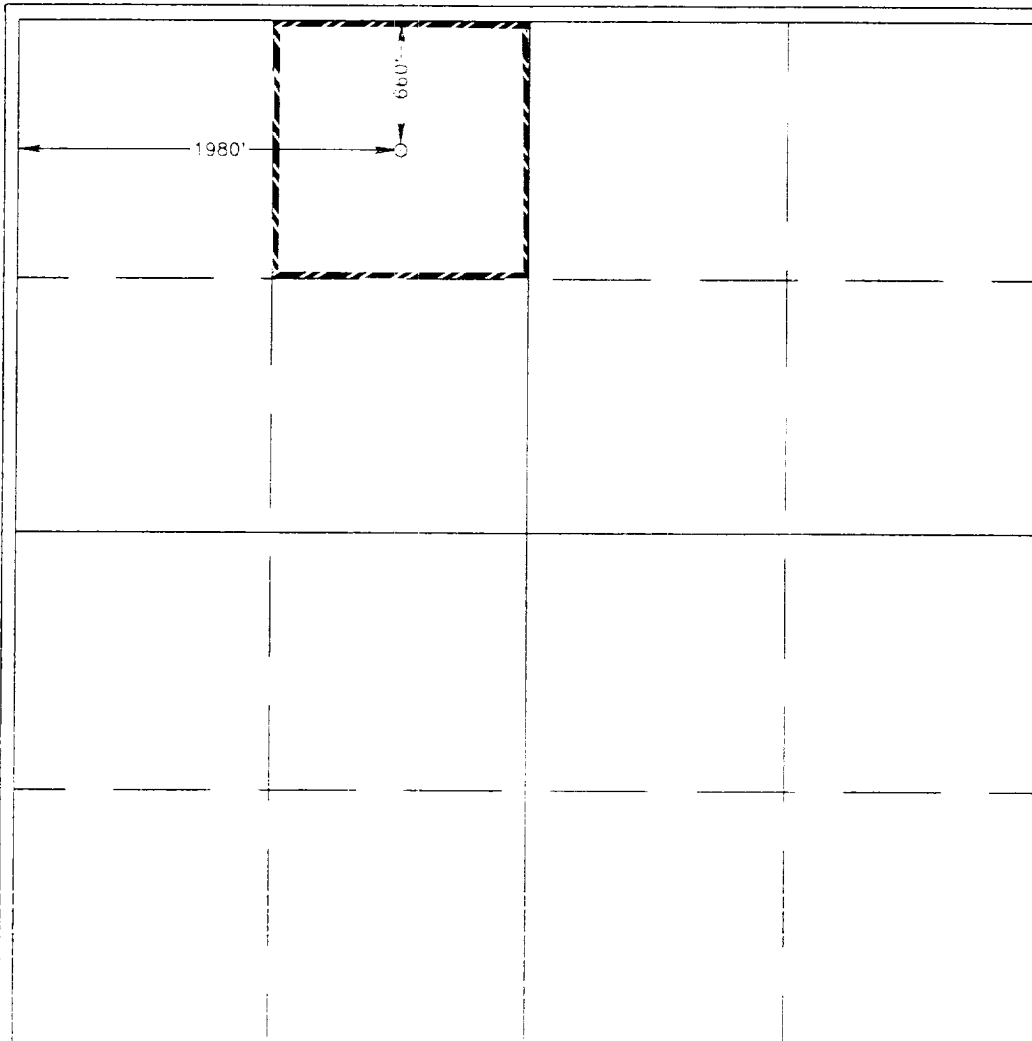

OPERATOR CERTIFICATION

I hereby certify the the information
contained herein is true and complete to the
best of my knowledge and belief.

Signature

Joe T. Janica
Printed Name
Agent

Title

07/15/98
Date

SURVEYOR CERTIFICATION

I hereby certify that the well location shown
on this plat was plotted from field notes of
actual surveys made by me or under my
supervision, and that the same is true and
correct to the best of my belief.

JUNE 29, 1998

Date Surveyed..... DMCC

Signature & Seal of
Professional Surveyor

Ronald J. Edson 7-02-98
7-11-09-98

Certificate No. RONALD J. EDSON 3239
GARY EDSON 1264
MACON McDONALD 12185





HOBBS SE, HOBBS SW, N.M.

(505) 393-3117

VICINITY MAP

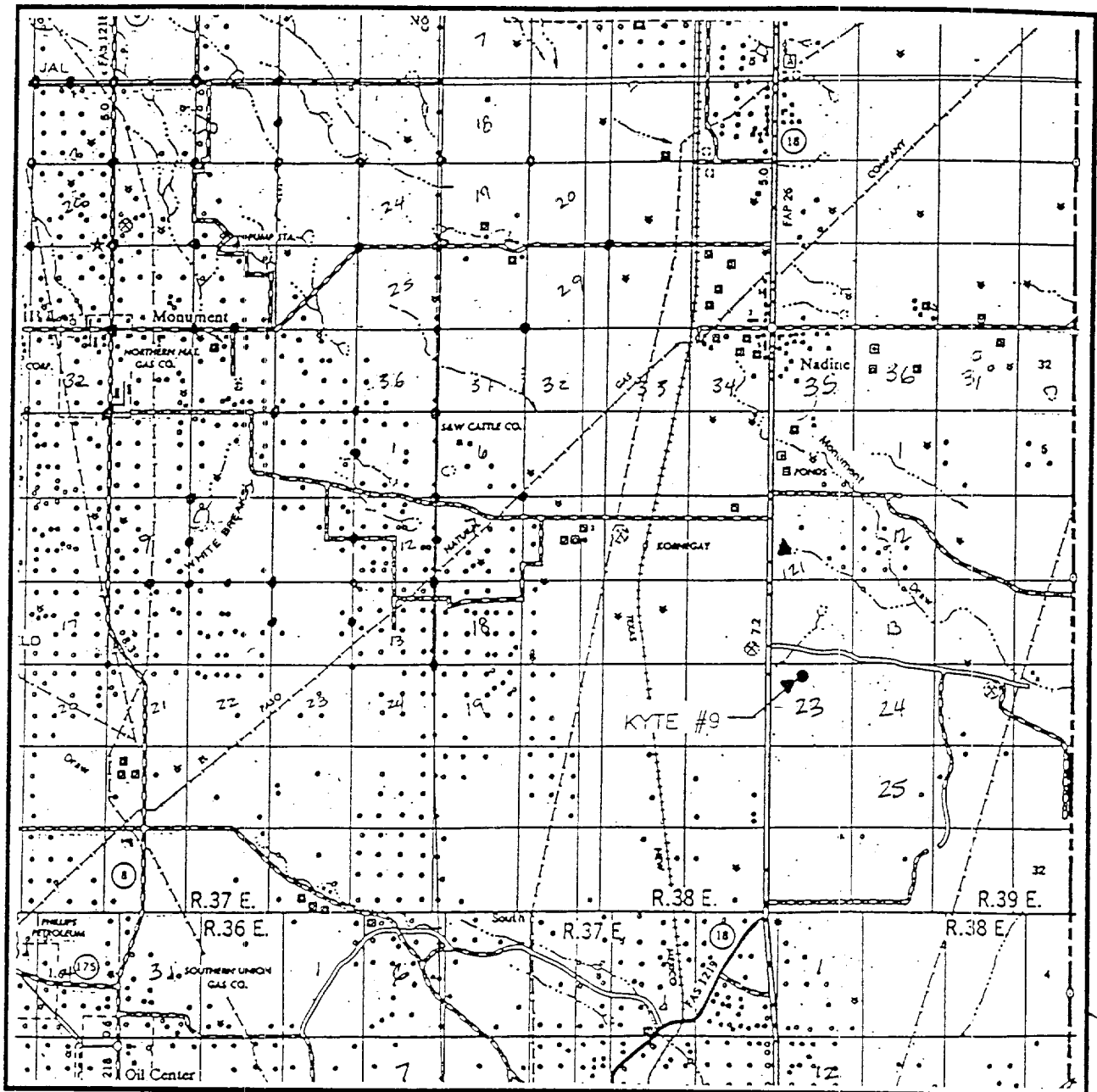

SCALE 1" = 2 MILES

SEC. 23 TWP. 20-S RGE. 38-E

SURVEY N.M.P.M.

COUNTY LEA

DESCRIPTION 660' FNL & 1980' FNL

ELEVATION 3567

OPERATOR FALCON CREEK RESOURCES

LEASE KYTE

JOHN WEST ENGINEERING
HOBBS, NEW MEXICO

(505) 393-3117

BLOWOUT PREVENTER SYSTEM

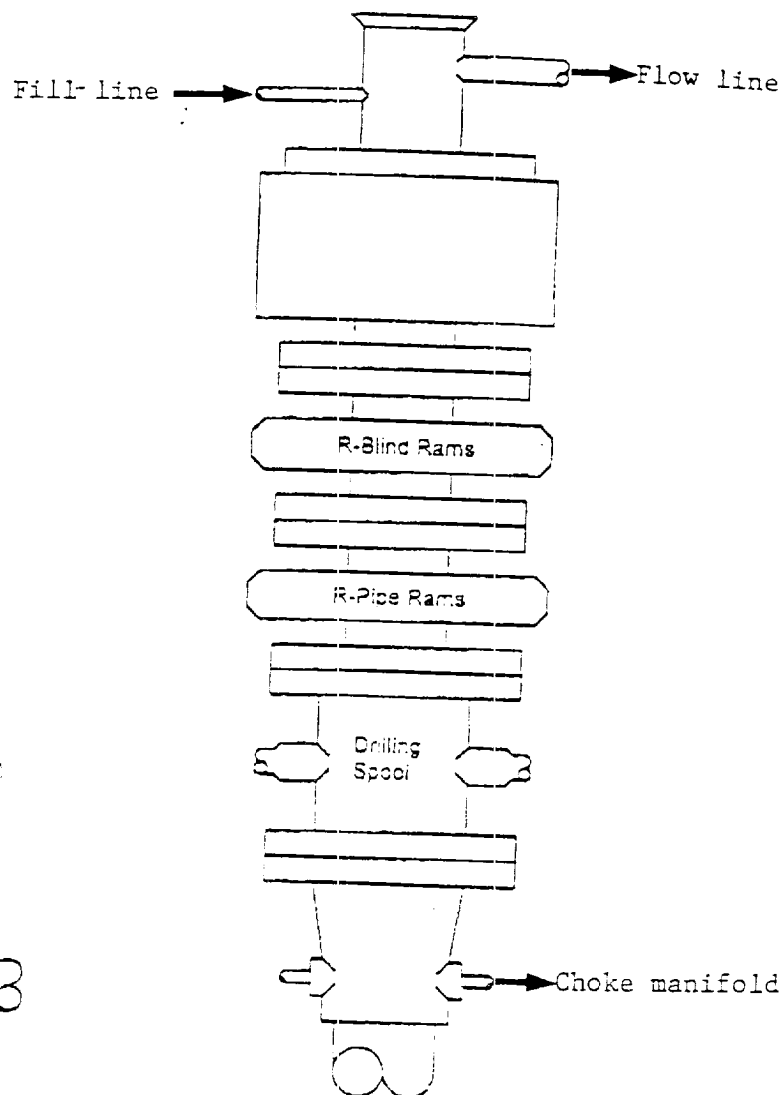

Type 900 Series
3000 psi WP

Choke Manifold Assembly for 3M WP System

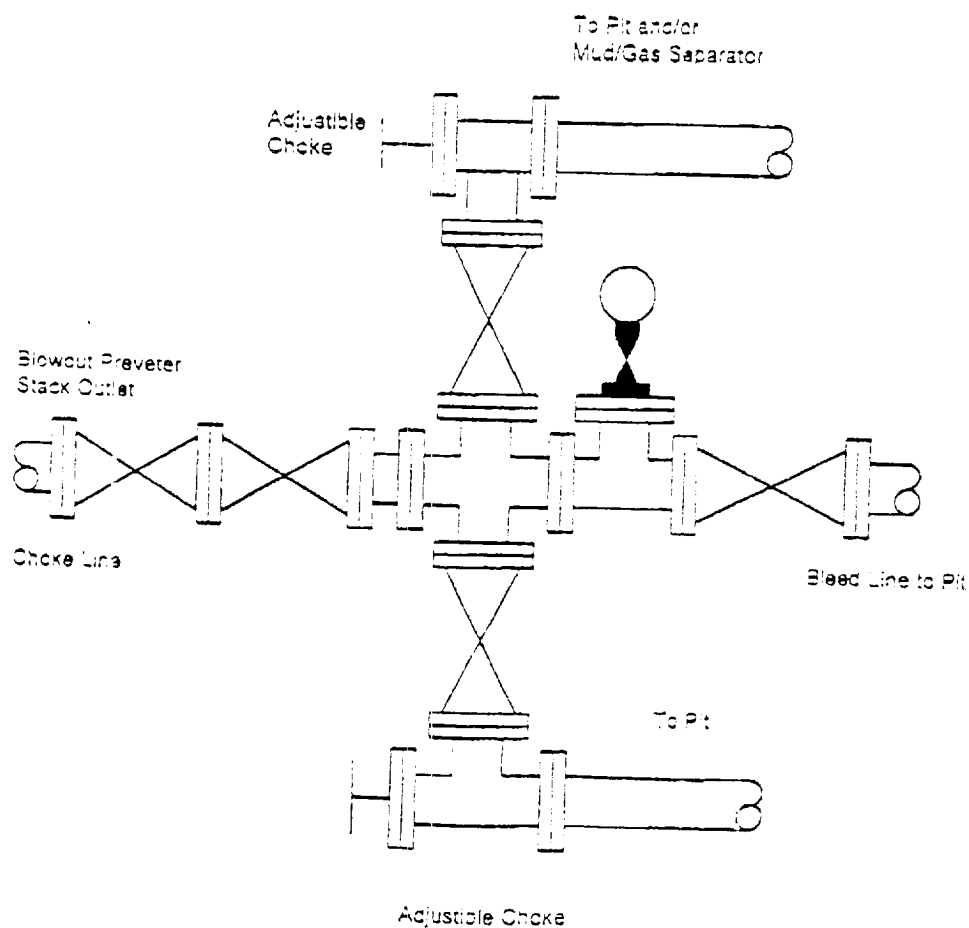

8/11/21

Received
Hobbs
Oct