

DISTRICT I  
P. O. Box 19  
Hobbs, NM 88241-1980

State of New Mexico  
Energy, Minerals, and Natural Resources Department

Form C-102  
Revised 02-10-94  
Instructions on back

DISTRICT II  
P. O. Drawer DD  
Artesia, NM 88211-0719

**OIL CONSERVATION DIVISION**  
P. O. Box 2088  
Santa Fe, New Mexico 87504-2088

Submit to the Appropriate  
District Office  
State Lease - 4 copies  
Fee Lease - 3 copies

DISTRICT III  
1000 Rio Brazos Rd.  
Aztec, NM 87410

☒ AMENDED REPORT

DISTRICT IV  
P. O. Box 2088  
Santa Fe, NM 87507-2088

**WELL LOCATION AND ACREAGE DEDICATION PLAT**

1 API Number 30-025-34557	2 Pool Code 96665	3 Pool Name West Ojo Chiso (Morrow)
4 Property Code 018928	5 Property Name GAUCHO UNIT	6 Well Number 3
7 OGRID No. 020305	8 Operator Name SANTA FE ENERGY RESOURCES, INC.	9 Elevation 3450'

**10 SURFACE LOCATION**

UL or lot no. N	Section 20	Township 22 SOUTH	Range 34 EAST, N.M.P.M.	Lot Ida	Feet from the 660'	North/South line SOUTH	Feet from the 1650'	East/West line WEST	County LEA
--------------------	---------------	----------------------	----------------------------	---------	-----------------------	---------------------------	------------------------	------------------------	---------------

**11 BOTTOM HOLE LOCATION IF DIFFERENT FROM SURFACE**

UL or lot no.	Section	Township	Range	Lot Ida	Feet from the	North/South line	Feet from the	East/West line	County
---------------	---------	----------	-------	---------	---------------	------------------	---------------	----------------	--------

12 Dedicated Acres 320	13 Joint or Infill	14 Consolidation Code	15 Order No.
---------------------------	--------------------	-----------------------	--------------

NO ALLOWABLE WELL BE ASSIGNED TO THIS COMPLETION UNTIL ALL INTERESTS HAVE BEEN CONSOLIDATED OR A NON-STANDARD UNIT HAS BEEN APPROVED BY THE DIVISION

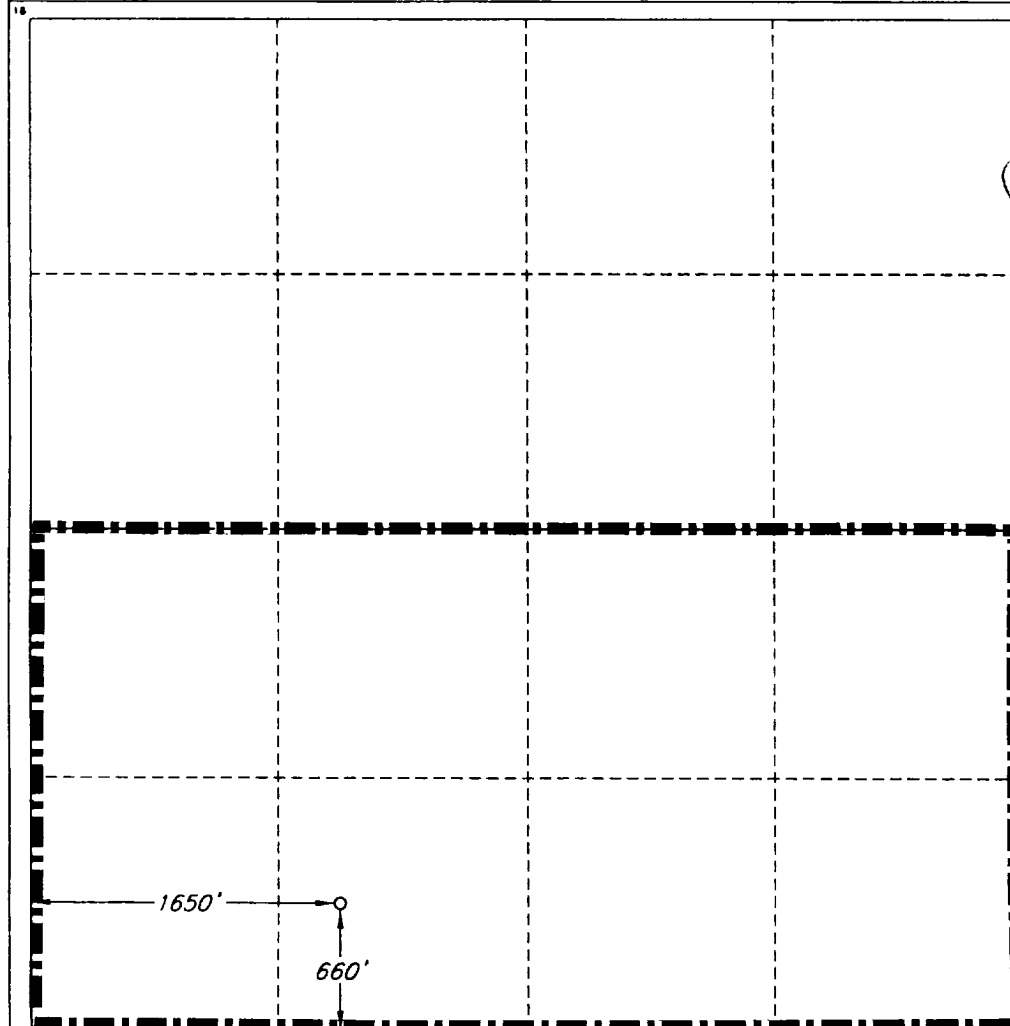

**OPERATOR CERTIFICATION**

I hereby certify that the information contained herein is true and complete to the best of my knowledge and belief.

Signature  
*Terry McCullough*  
Printed Name  
Terry McCullough  
Title  
Sr. Production Clerk  
Date  
January 7, 1999

**SURVEYOR CERTIFICATION**

I hereby certify that the well location shown on this plat was plotted from field notes of actual surveys made by me or under my supervision, and that the same is true and correct to the best of my belief.

Date of Survey  
NOVEMBER 11, 1998  
Signature  
Professional Surveyor  
ROGER M. ROBBINS  
NEW MEXICO  
REGISTERED PROFESSIONAL SURVEYOR  
12128  
Certificate  
ROGER M. ROBBINS, S.S. #12128  
JOB #61425 / 46 SW / JSJ