

District I  
PO Box 1980, Hobbs, NM 88241-1980  
District II  
811 South First, Artesia, NM 88210  
District III  
1000 Rio Brazos Rd., Aztec, NM 87410  
District IV  
2040 South Pacheco, Santa Fe, NM 87505

State of New Mexico  
Energy, Minerals & Natural Resources Department

OIL CONSERVATION DIVISION  
2040 South Pacheco  
Santa Fe, NM 87505

Form C-101

Revised October 18, 1994

Instructions on back  
Submit to Appropriate District Office  
State Lease - 6 Copies  
Fee Lease - 5 Copies

☐ AMENDED REPORT

APPLICATION FOR PERMIT TO DRILL, RE-ENTER, DEEPEN, PLUGBACK, OR ADD A ZONE

<sup>1</sup> Operator Name and Address. Capataz Operating, Inc. PO Box 10549 Midland, TX 79702		<sup>2</sup> OGRID Number 3659
		<sup>3</sup> API Number 30-025-34734
<sup>4</sup> Property Code 24991	<sup>5</sup> Property Name Picayune	<sup>6</sup> Well No. 1

<sup>7</sup> Surface Location

UL or lot no.	Section	Township	Range	Lot Idn	Feet from the	North/South line	Feet from the	East/West line	County
5	11	20S	38E	J	1980	South	1980	East	Lea

<sup>8</sup> Proposed Bottom Hole Location If Different From Surface

UL or lot no.	Section	Township	Range	Lot Idn	Feet from the	North/South line	Feet from the	East/West line	County
<sup>9</sup> Proposed Pool 1 House, Abo					<sup>10</sup> Proposed Pool 2 House, Drinkard				

<sup>11</sup> Work Type Code N	<sup>12</sup> Well Type Code O	<sup>13</sup> Cable/Rotary R	<sup>14</sup> Lease Type Code P	<sup>15</sup> Ground Level Elevation 3575
<sup>16</sup> Multiple No	<sup>17</sup> Proposed Depth 7800	<sup>18</sup> Formation Abo	<sup>19</sup> Contractor Patterson	<sup>20</sup> Spud Date 11/03/99

<sup>21</sup> Proposed Casing and Cement Program

Hole Size	Casing Size	Casing weight/foot	Setting Depth	Sacks of Cement	Estimated TOC
12-1/2	8-5/8"	24#	1600'	975	Surf
7-7/8	5-1/2	17#	7800'	795	1600'

<sup>22</sup> Describe the proposed program. If this application is to DEEPEN or PLUG BACK give the data on the present productive zone and proposed new productive zone. Describe the blowout prevention program, if any. Use additional sheets if necessary.

Drill 11" hole to 1600'. Run & cement 8-5/8" 24# casing. Circulate cement to Surface. Log, evaluate & run 5-1/2" casing if indicated.

Permit Expires 1 Year From Approval  
Date Unless Drilling Underway

<sup>23</sup> I hereby certify that the information given above is true and complete to the best of my knowledge and belief.

Signature:

Printed name:

H Scott Davis

Title:

Agent

OIL CONSERVATION DIVISION

Approved by:

ORIGINAL SIGNED BY CHRIS WILLIAMS  
DISTRICT I SUPERVISOR

Title:

Approval Date:

OCT 20 1999

Expiration Date:

JP  
m

DISTRICT I  
P. O. Box 1980  
Hobbs, NM 88241-1980

State of New Mexico  
Bureau of Minerals, and Natural Resources Department

Form C-102  
Revised 02-10-94

Instructions on back

DISTRICT II  
P. O. Drawer DD  
Artesia, NM 88211-0719

DISTRICT III  
1000 Rio Brazos Rd.  
Aztec, NM 87410

**OIL CONSERVATION DIVISION**  
P. O. Box 2088  
Santa Fe, New Mexico 87504-2088

Submit to the Appropriate  
District Office  
State Lease - 4 copies  
Fee Lease - 3 copies

☐ AMENDED REPORT

DISTRICT IV  
P. O. Box 2088  
Santa Fe, NM 87507-2088

**WELL LOCATION AND ACREAGE DEDICATION PLAT**

1 API Number <b>30-025-34734</b>	2 Pool Code <b>33210</b>	3 Pool Name <b>House, Abo</b>
4 Property Code <b>24991</b>	5 Property Name <b>PICAYUNE</b>	6 Well Number <b>1</b>
7 OGRID No. <b>3659</b>	8 Operator Name <b>CAPATAZ OPERATING, INC.</b>	9 Elevation <b>3575'</b>

**10 SURFACE LOCATION**

UL or lot no.	Section	Township	Range	Lot Ida	Feet from the	North/South line	Feet from the	East/West line	County
<b>J</b>	<b>11</b>	<b>20 SOUTH</b>	<b>38 EAST, N.M.P.M.</b>		<b>1980'</b>	<b>SOUTH</b>	<b>1980'</b>	<b>EAST</b>	<b>LEA</b>

**"BOTTOM HOLE LOCATION IF DIFFERENT FROM SURFACE**

UL or lot no.	Section	Township	Range	Lot Ida	Feet from the	North/South line	Feet from the	East/West line	County

12 Dedicated Acres <b>40</b>	13 Joint or Infill	14 Consolidation Code	15 Order No.
---------------------------------	--------------------	-----------------------	--------------

NO ALLOWABLE WELL BE ASSIGNED TO THIS COMPLETION UNTIL ALL INTERESTS HAVE BEEN  
CONSOLIDATED OR A NON-STANDARD UNIT HAS BEEN APPROVED BY THE DIVISION

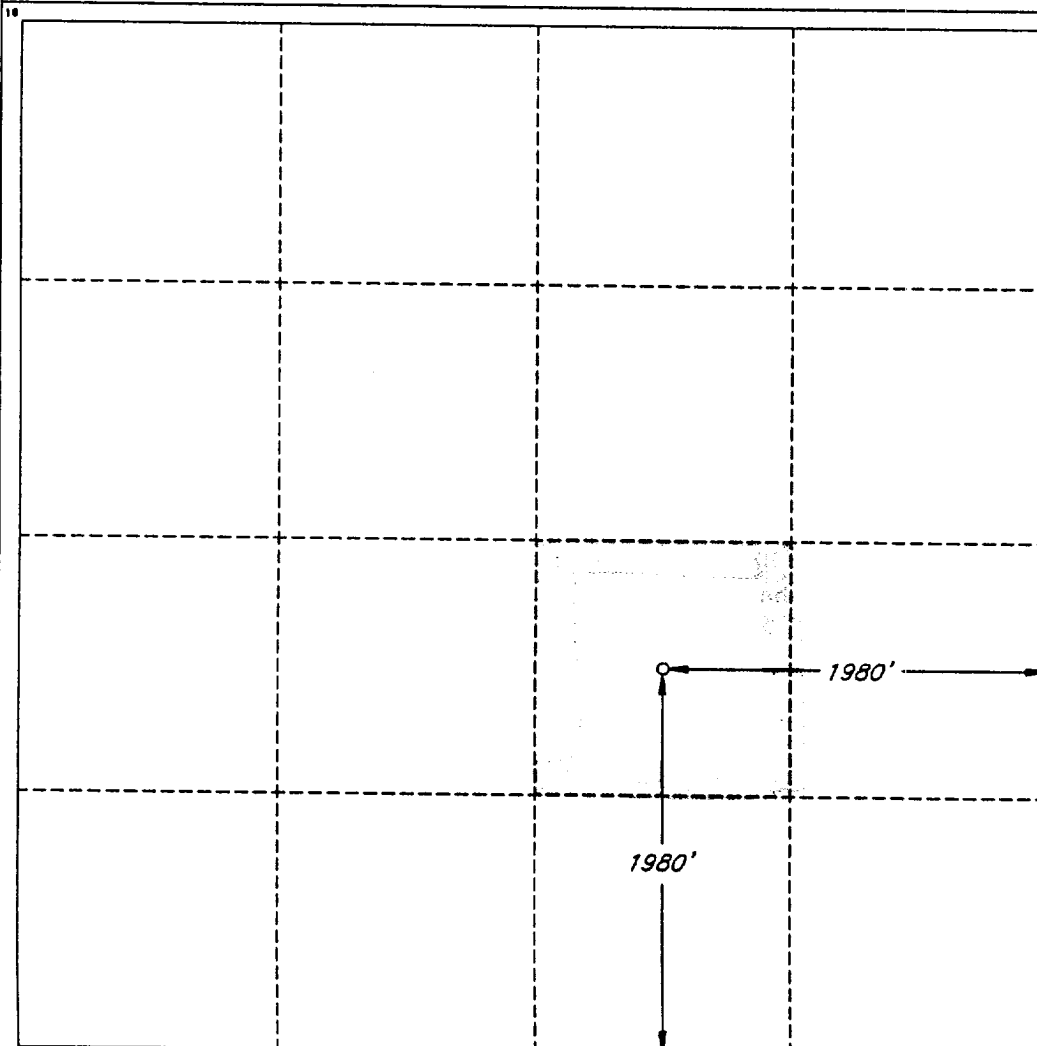

**OPERATOR CERTIFICATION**

I hereby certify that the information  
contained herein is true and complete  
to the best of my knowledge and belief.

Signature

**H. Scott Davis**

Printed Name

**Agent**

Title

**10/13/99**

Date

**SURVEYOR CERTIFICATION**

I hereby certify that the well  
location shown on this plat was  
plotted from field notes of actual  
surveys made by me or under  
my supervision, and that the  
same is true and correct to the  
best of my belief.

Date of Survey

**OCTOBER 6, 1999**

Signature and Seal of  
Professional Surveyor

Certificate No.

**V. L. BEZNER**

**R.P.S. #7920**

**JOB #65574 / 70 SE / V.H.B.**

## BLOWOUT PREVENTER

3000 PSI WP

### THE FOLLOWING CONSTITUTE MINIMUM BLOWOUT PREVENTER REQUIREMENTS

- A. One double gate blowout preventer with lower rams for pipe and upper rams blind, all hydraulically controlled.
- B. Opening on preventers between rams to be flanged, studded or clamped and at least two inches in diameter.
- C. All connections from operating manifold to preventers to be all steel hose or tube a minimum of one inch in diameter.
- D. The available closing pressure shall be at least 15% in excess of that required with sufficient volume to operate (close, open and re-close) the preventers.
- E. All connections to and from preventers to have a pressure rating equivalent to that of the BOP's.
- F. Manual controls to be installed before drilling cement plug.
- G. Valve to control flow through drill pipe to be located on rig floor.
- H. All chokes will be adjustable. Choke spool may be used between rams.

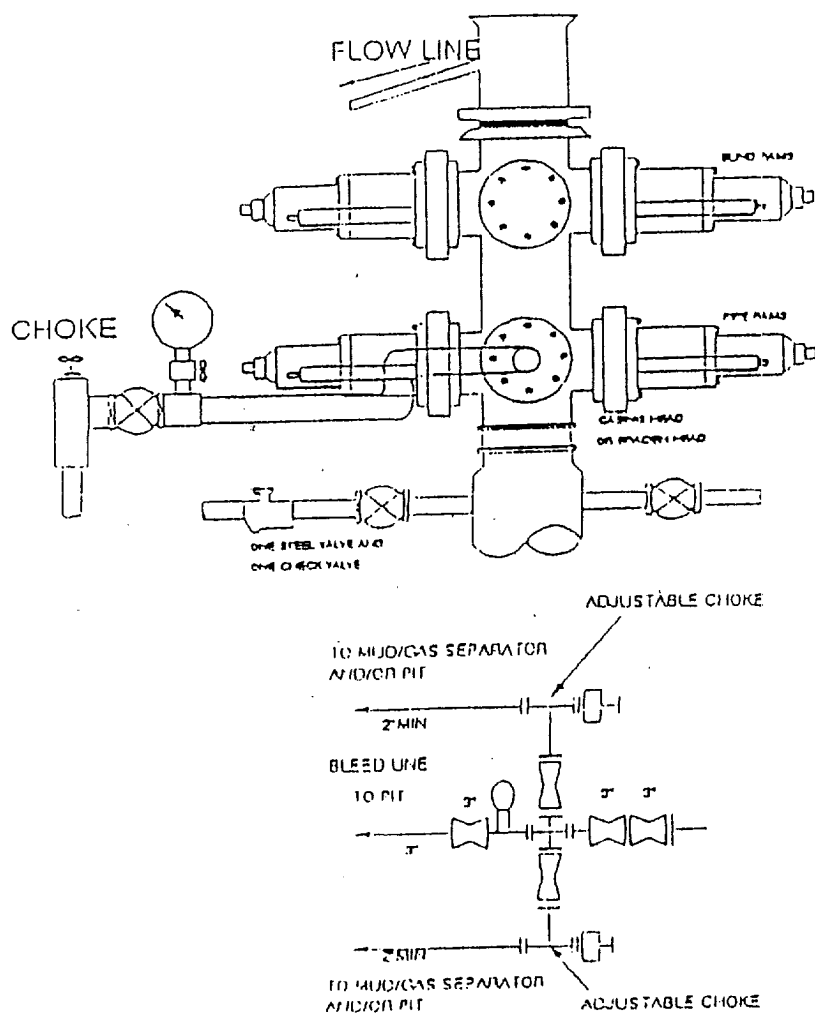

WILL BE RELEASED  
CONFIDENTIAL LOGS  
INDICATE WHEN  
ABOVE DATE DOES NOT

ELF  
2/6/2000