

DISTRICT I
P. O. Box 1980
Hobbs, NM 88241-1980

State of New Mexico
Energy, Minerals, and Natural Resources Department

Form C-102
Revised 02-10-94
Instructions on back

DISTRICT II
P. O. Drawer DD
Artesia, NM 88211-0719

OIL CONSERVATION DIVISION

P. O. Box 2088
Santa Fe, New Mexico 87504-2088

Submit to the Appropriate
District Office
State Lease - 4 copies
Fee Lease - 3 copies

☐ AMENDED REPORT

DISTRICT III
1000 Rio Brazos Rd.
Aztec, NM 87410

DISTRICT IV
P. O. Box 2088
Santa Fe, NM 87507-2088

WELL LOCATION AND ACREAGE DEDICATION PLAT

1 API Number 30-025-35118		2 Pool Code 96665		3 Pool Name Ojo Chiso Morrow, West					
4 Property Code 24635		5 Property Name BELL LAKE UNIT						6 Well Number 21	
7 OGRID No. 20305		8 Operator Name SANTA FE SNYDER CORPORATION						9 Elevation 3431'	
10 SURFACE LOCATION									
UL or lot no. L	Section 32	Township 22 SOUTH	Range 34 EAST, N.M.P.M.	Lot Ida	Feet from the 1340'	North/South line SOUTH	Feet from the 660'	East/West line WEST	County LEA
"BOTTOM HOLE LOCATION IF DIFFERENT FROM SURFACE"									
UL or lot no.	Section	Township	Range	Lot Ida	Feet from the	North/South line	Feet from the	East/West line	County
12 Dedicated Acres 320		13 Joint or Infill		14 Consolidation Code		15 Order No.			

NO ALLOWABLE WELL BE ASSIGNED TO THIS COMPLETION UNTIL ALL INTERESTS HAVE BEEN
CONSOLIDATED OR A NON-STANDARD UNIT HAS BEEN APPROVED BY THE DIVISION

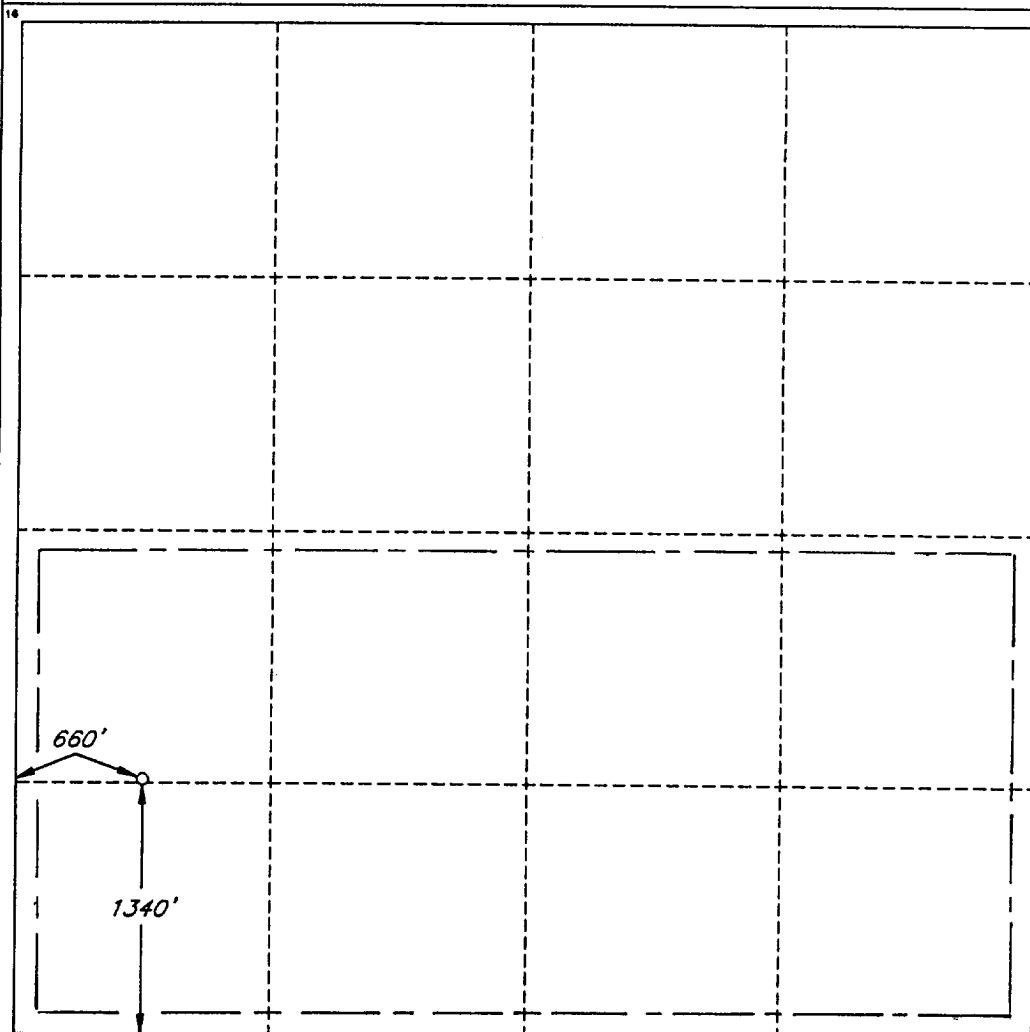

OPERATOR CERTIFICATION

I hereby certify that the information
contained herein is true and complete
to the best of my knowledge and belief.

Signature: *James P. "Phil" Stinson*
Printed Name: James P. "Phil" Stinson
Title: Agent for Santa Fe Snyder
Date: 7-26-2000

SURVEYOR CERTIFICATION

I hereby certify that the well
location shown on this plat was
plotted from field notes of actual
surveys made by me or under
my supervision, and that the
same is true and correct to the
best of my belief.

Date of Survey
JULY 20, 2000

Signature and Seal of
Professional Surveyor

Certificate No.
V. L. BEZNER R.P.S. #7920
JOB #70567 / 46 SW / V.H.B.