

DISTRICT I
P.O. Box 1980, Hobbs, NM 88241-1980

DISTRICT II
P.O. Drawer 80, Artesia, NM 86211-0719

DISTRICT III
1000 Rio Brancos Rd., Artesia, NM 87410

DISTRICT IV
P.O. Box 2088, Santa Fe, NM 87504-2088

State of New Mexico

Energy, Minerals and Natural Resources Department

OIL CONSERVATION DIVISION

P.O. Box 2088
Santa Fe, New Mexico 87504-2088

Form C-102

Revised February 10, 1994

Submit to Appropriate District Office

State Lease - 4 Copies

Fee Lease - 3 Copies

NOV 27 2000

☐ AMENDED REPORT

WELL LOCATION AND ACREAGE DEDICATION PLAT

API Number <u>30-25-35386</u>	Pool Code <u>33820</u>	Pool Name <u>JALMAT (TN-YT-7R)</u>
Property Code <u>25185</u>	Property Name <u>CLOSSON "B" FEDERAL</u>	Well Number <u>40</u>
OGRID No. <u>184860</u>	Operator Name <u>MELROSE OPERATING COMPANY</u>	Elevation <u>3572</u>

Surface Location

UL or lot No. <u>C</u>	Section <u>19</u>	Township <u>22 S</u>	Range <u>36 E</u>	Lot Idn	Feet from the <u>660</u>	North/South line <u>NORTH</u>	Feet from the <u>1650</u>	East/West line <u>WEST</u>	County <u>LEA</u>
---------------------------	----------------------	-------------------------	----------------------	---------	-----------------------------	----------------------------------	------------------------------	-------------------------------	----------------------

Bottom Hole Location If Different From Surface

UL or lot No.	Section	Township	Range	Lot Idn	Feet from the	North/South line	Feet from the	East/West line	County
Dedicated Acres <u>40</u>	Joint or Infill	Consolidation Code	Order No.						

NO ALLOWABLE WILL BE ASSIGNED TO THIS COMPLETION UNTIL ALL INTERESTS HAVE BEEN CONSOLIDATED
OR A NON-STANDARD UNIT HAS BEEN APPROVED BY THE DIVISION

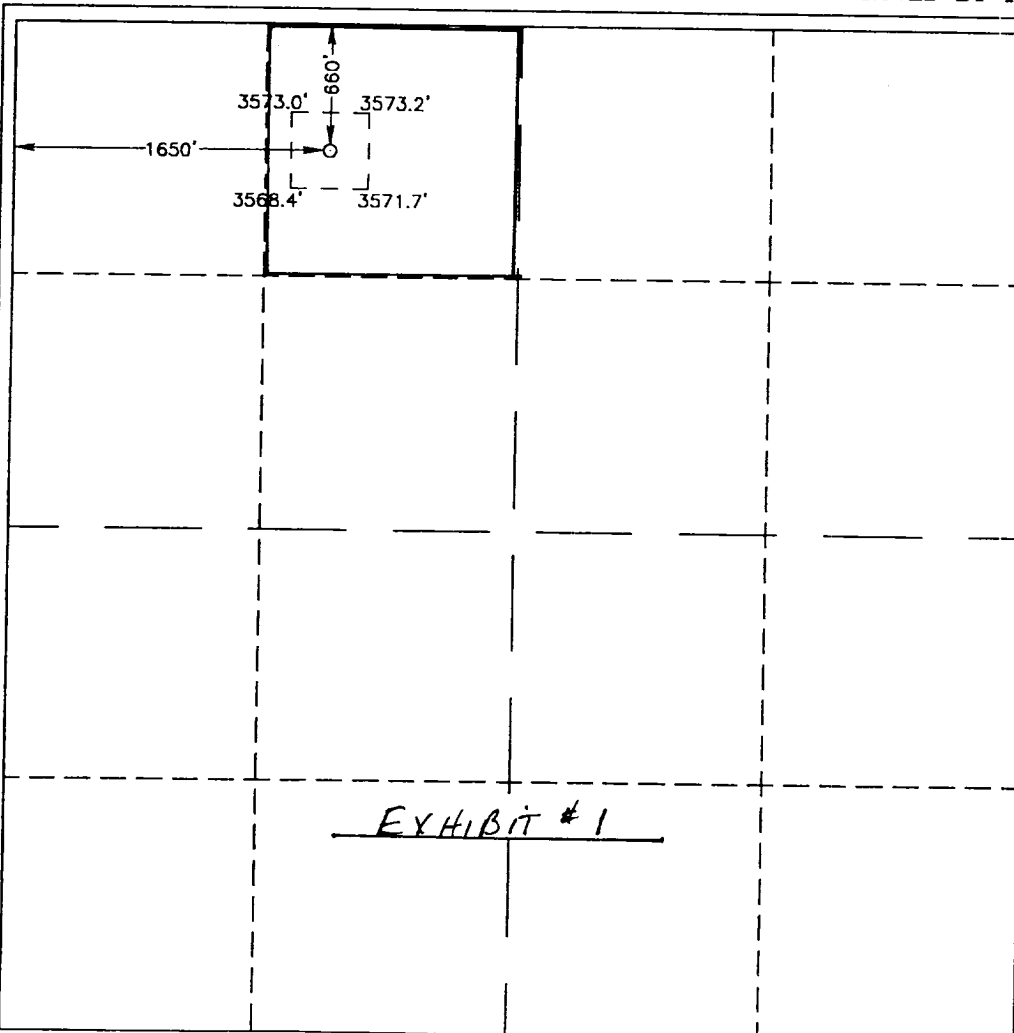

OPERATOR CERTIFICATION

I hereby certify the information contained herein is true and complete to the best of my knowledge and belief.

[Signature]
Signature

ANN E. Ritchie
Printed Name

Regulatory Agent
Title

12/01/00
Date

SURVEYOR CERTIFICATION

I hereby certify that the well location shown on this plat was plotted from field notes of actual surveys made by me or under my supervision and that the same is true and correct to the best of my belief.

NOVEMBER 17, 2000

Date Surveyed 12/21/00 JLP

[Signature]
Signature & Seal of Professional Surveyor

W.O. Num 00-11-1489

Certificate No. RONALD EIDSON, 3238
GARY C EIDSON, 12841