

Lease #41478

Form C-101

NEW MEXICO OIL CONSERVATION COMMISSION

NOTICE OF INTENTION TO DRILL

See Rules 101 and 1104.

If changes in the proposed plan are considered advisable, a copy of this notice showing such changes will be returned to the sender. Submit this notice in triplicate. One copy will be returned following approval.

The Texas Company Fort Worth, Texas

Place

March 14, 1952

Date

Notice hereby is given that it is our intention to commence the drilling of a well to be known as

The Texas Company, State of New Mexico "A" well No. 5 in Lot 1

Company or Operator

Lease

of Sec. 2, T. 21-S, R. 33-E, N. M., P. M., Lynch Pool, Lea County.

The well is 990 feet from (N.) line and 330 feet from

(E.) line of the above section.

(Give location from section lines. Cross out wrong directions.)

If state land the oil and gas lease is No. B-163 Assignment No.

If patented land the owner is

Address

If government land the permittee is

Address

The lessee is The Texas Company

Address Houston, Texas

We propose to drill well with drilling equipment as follows: Cable

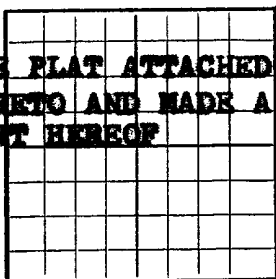
SEE FLAT ATTACHED
HERE TO AND MADE A
PART HEREOF

AREA 640 ACRES

LOCATE WELL CORRECTLY

The status of a bond for this well in conformance with Rule 101 of the General Rules and Regulations of the Commission is as follows: \$10,000 blanket surety bond of Maryland Casualty Co. has been filed with State Geologist.

We propose to use the following strings of casing and to land or cement them as indicated:

Size of Hole	Size of Casing	Weight Per Foot	New or Second Hand	Depth	Landed or Cemented	Sacks Cement
17"	13-3/8"	40#	New	130'	Mudded	-
12-1/2"	10-3/4"	32.75#	New	800'	Mudded	-
10-3/4"	8-5/8"	28#	New	1400'	Mudded	-
8-3/4"	5-1/2"	15.50#	New	3700'	Cemented to surface with 450 sx.	-

If changes in the above plans become advisable we will notify you before cementing or landing casing. We estimate that the first productive oil or gas sand should occur at a depth of about 3600 feet.

Additional information: FORMATIONS EXPECTED:

Top of Water Sand	950'	Top of 1st Productive Oil	3600'
Top of Anhydrite	1630'	Total Depth	3750'
Top of Salt	1760'	Well to be completed as an oil well producing from the Yates Section.	
Base of Salt	3315'		
Top of Yates	3600'		

Approved: MAR 17 1952, 19

except as follows:

THE TEXAS COMPANY

Company or Operator

By

Position

Send communications regarding well to:

Name The Texas Company

Address P.O. Box 1720

Fort Worth, Texas

By

Title

ams

OIL CONSERVATION COMMISSION

Oil & Gas Inspector

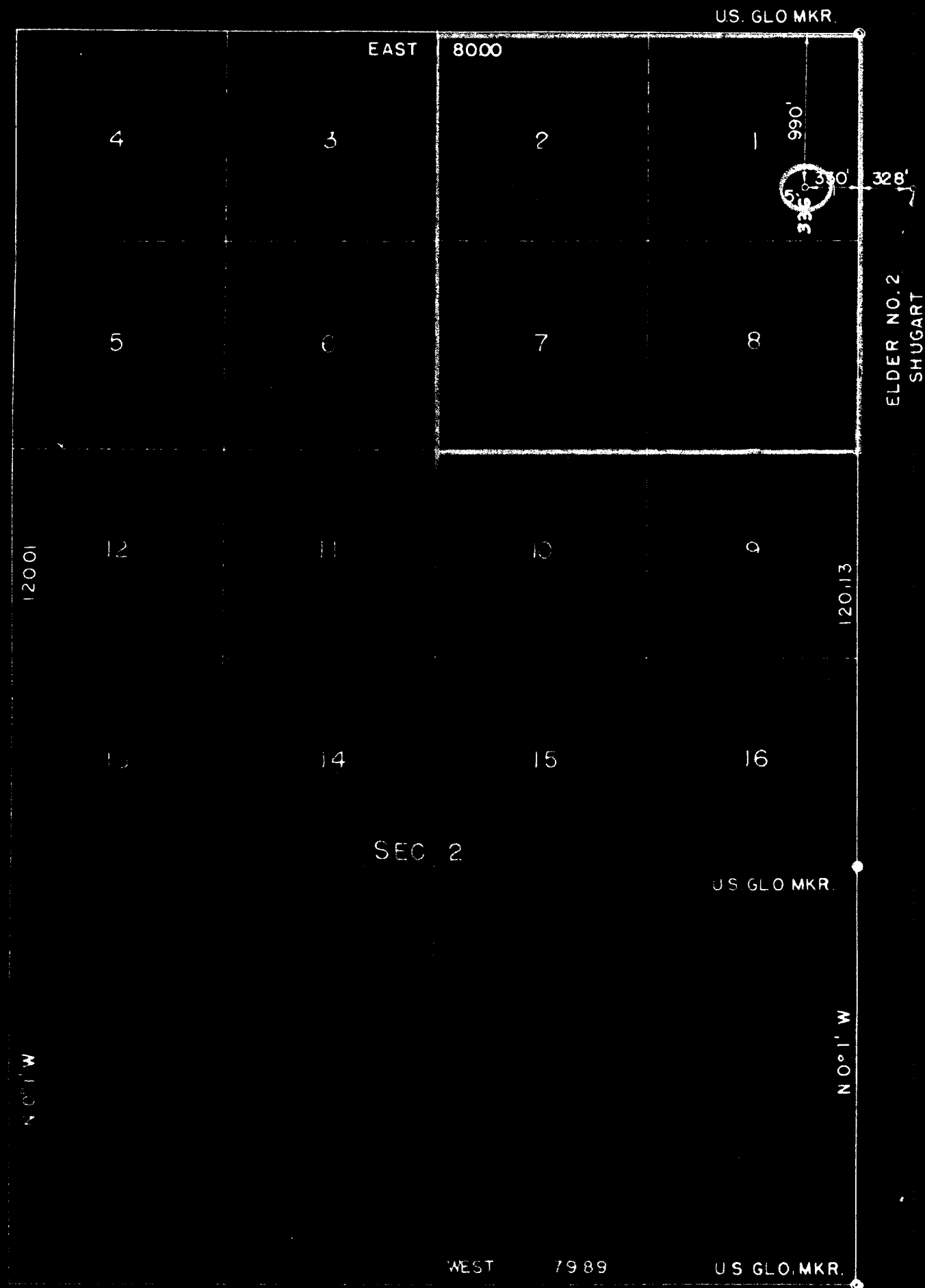

THE TEXAS COMPANY

STATE OF NEW MEXICO 'A' LEASE

LOCATION OF WELL NO 5

SEC 2 T-21-S R-33-E

LEA COUNTY, NEW MEXICO

DRAWN BY: WJH

DATE 3-11-52

SCALE 1"= 800'

FILE NO.