

NOTICE OF INTENTION TO DRILL

Notice must be given to the Oil Conservation Commission or its proper agent and approval obtained before drilling begins. If changes in the proposed plan are considered advisable, a copy of this notice showing such changes must be returned to the sender. Submit this notice in triplicate. One copy will be returned following approval. See instructions in Rules and Regulations of the Commission.

Midland, Texas

February 24, 1951

Place

Date

OIL CONSERVATION COMMISSION, Santa Fe, New Mexico,

Gentlemen:

You are hereby notified that it is our intention to commence the drilling of a well to be known as \_\_\_\_\_

FRED TURNER, JR. ET AL

well No. 1 in Center of Tract 11

Company or Operator

Lease

of Sec. 6, T. 21-S, R. 32-E, N. M., P. M., Wildcat Field, Lea County.

N

The well is 3200 feet (N) (S.) of the North line and 2072.2 feet (E.) (W) of the West line of Section.

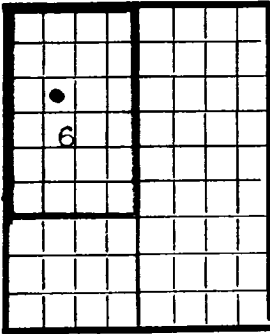

AREA 640 ACRES

LOCATE WELL CORRECTLY

(Give location from section or other legal subdivision lines. Cross out wrong directions.)

If state land the oil and gas lease is No. \_\_\_\_\_ Assignment No. \_\_\_\_\_

If patented land the owner is \_\_\_\_\_

Address \_\_\_\_\_

If government land the permittee is Herbert Aid

Address 203 West Dallas, Artesia, New Mexico

The lessee is Fred Turner, Jr.

Address Box 910, Midland, Texas

We propose to drill well with drilling equipment as follows: Rotary Rig.

The status of a bond for this well in conformance with Rule 39 of the General Rules and Regulations of the Commission is as follows: Bond #SY50912 - \$10,000.00 - Full Force & Effect

We propose to use the following strings of casing and to land or cement them as indicated:

Table with 7 columns: Size of Hole, Size of Casing, Weight Per Foot, New or Second Hand, Depth, Landed or Cemented, Sacks Cement. Rows include 13-3/4, 9-3/4, and 7-7/8 casing sizes.

If changes in the above plan become advisable we will notify you before cementing or landing casing. We estimate that the first productive oil or gas sand should occur at a depth of about 3200 feet.

Additional information:

SEE PLAT ATTACHED

Approved \_\_\_\_\_, 19\_\_\_\_ except as follows:

Sincerely yours,

FRED TURNER, JR.

Company or Operator

By [Signature]

Position Office Manager

Send communications regarding well to:

Name Fred Turner, Jr.

Address Box 910, Midland, Texas

OIL CONSERVATION COMMISSION, By \_\_\_\_\_ Title \_\_\_\_\_

WELL LOCATION SURVEY      LAT

COMPANY      FRED TURNER, JR., ET AL

LEASE      FEDERAL

WELL NO.      1

RECEIVED  
 MAR 5 1951  
 COMMISSION  
 OFFICE

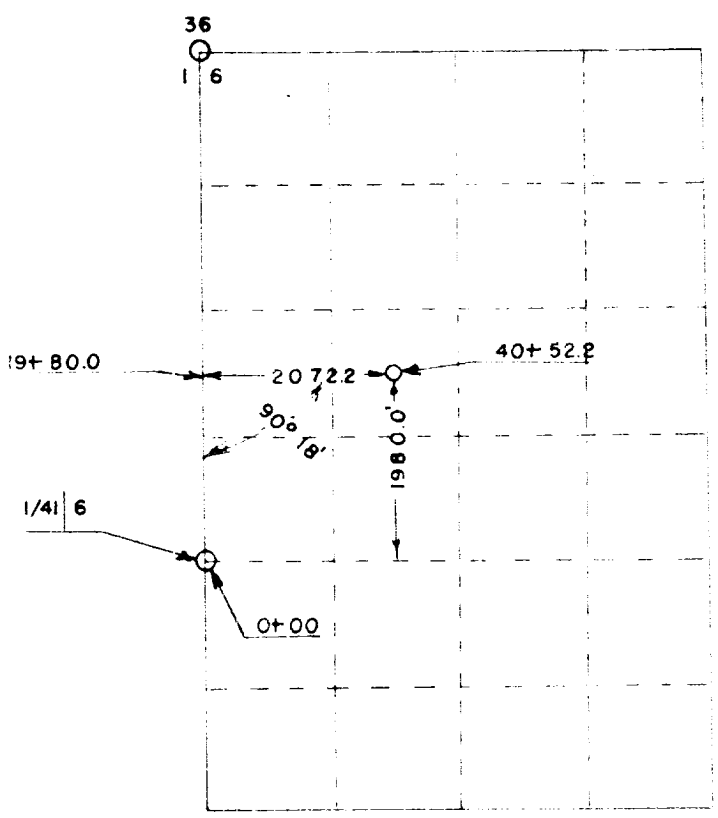

SEC. 6, TWP. 21 S., R. 32 E., N.M.P.M

I HEREBY CERTIFY THAT THIS SURVEY WAS MADE  
 BY ME AND IS CORRECT TO THE BEST OF MY KNOWLEDGE.

*John W. West*  
 JOHN W. WEST, PE & LS NO. 676.

FEB 15, 1951