

W.W. STUDDERT
MEMBER
AMERICAN SOCIETY OF
CIVIL ENGINEERS

REGISTERED ENGINEERS
& LAND SURVEYORS

ARIZONA
COLORADO
IDAHO
LOUISIANA
MONTANA
NEVADA
NEW MEXICO
OKLAHOMA
TEXAS
UTAH
WYOMING

STUDDERT ENGINEERS, INC.
CIVIL ENGINEERS
221 SOUTH COLORADO
MIDLAND, TEXAS

S33 | S34

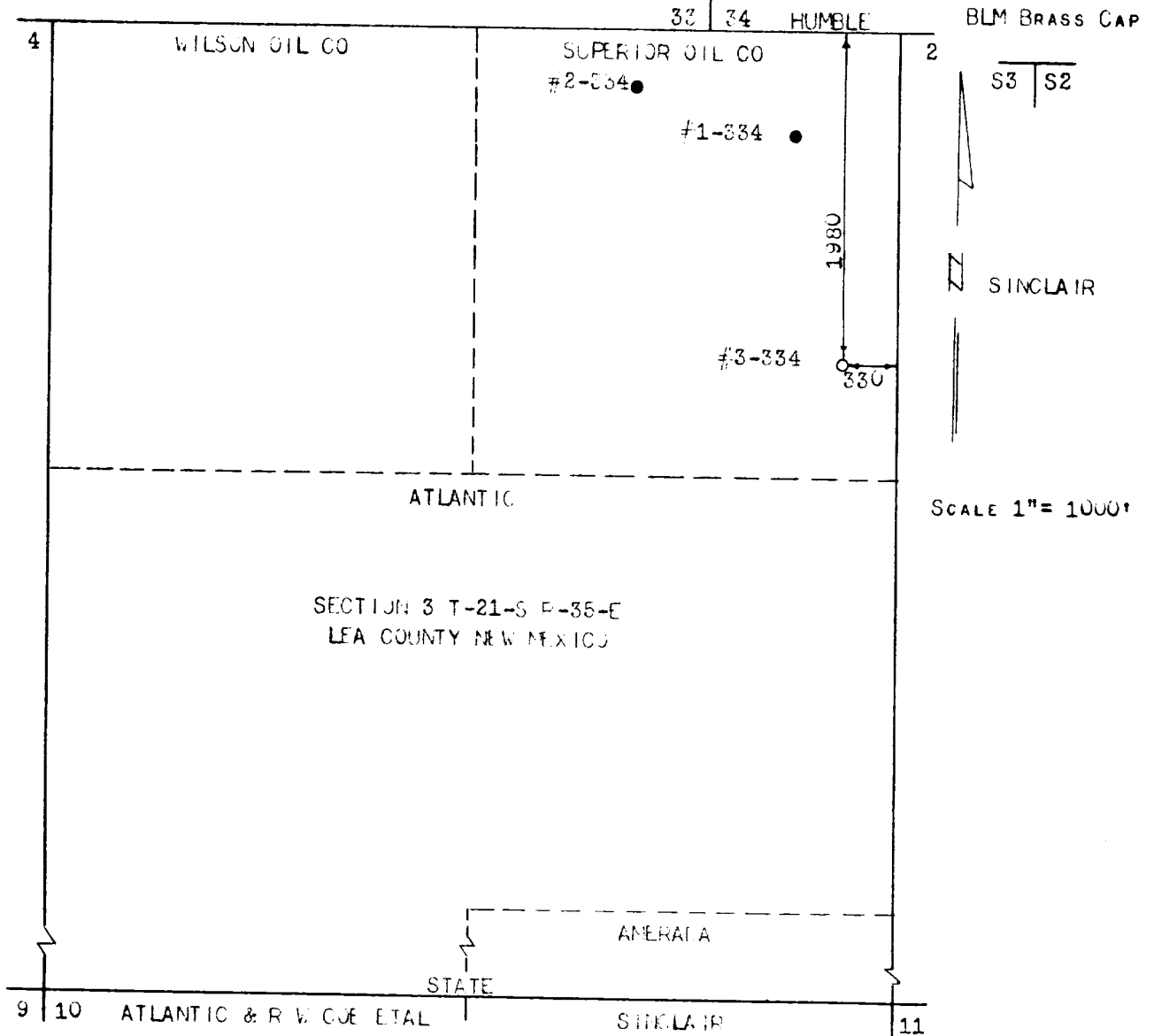

W.W. STUDDERT, REGISTERED PROFESSIONAL ENGINEER AND LAND
SURVEYOR #388 HEREBY CERTIFIES THAT THIS WELL LOCATION WAS
STAKED ON THE GROUND UNDER HIS SUPERVISION AND THAT THIS PLAT
IS TRUE AND CORRECT.

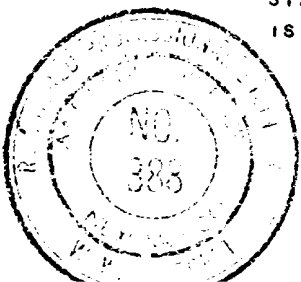

W.W. Studdert
W.W. STUDDERT

MARCH 7, 1956

NEW MEXICO
OIL CONSERVATION COMM. ON

Form C-128

Well Location and/or Gas Proration Plat

Date 3-8-56

Operator The Superior Oil Company Lease State "334"

Well No. 3-334 Section 3 Township 21-S Range 4-35-E NMPM

Located 1980 Feet From N Line, 370 Feet From E Line,

LEA

County, New Mexico. G. L. Elevation 3605' KB (Estimated)

Name of Producing Formation Yates sand Pool UNDESIGNATED Dedicated Acreage 40

(Note: All distances must be from outer boundaries of Section)

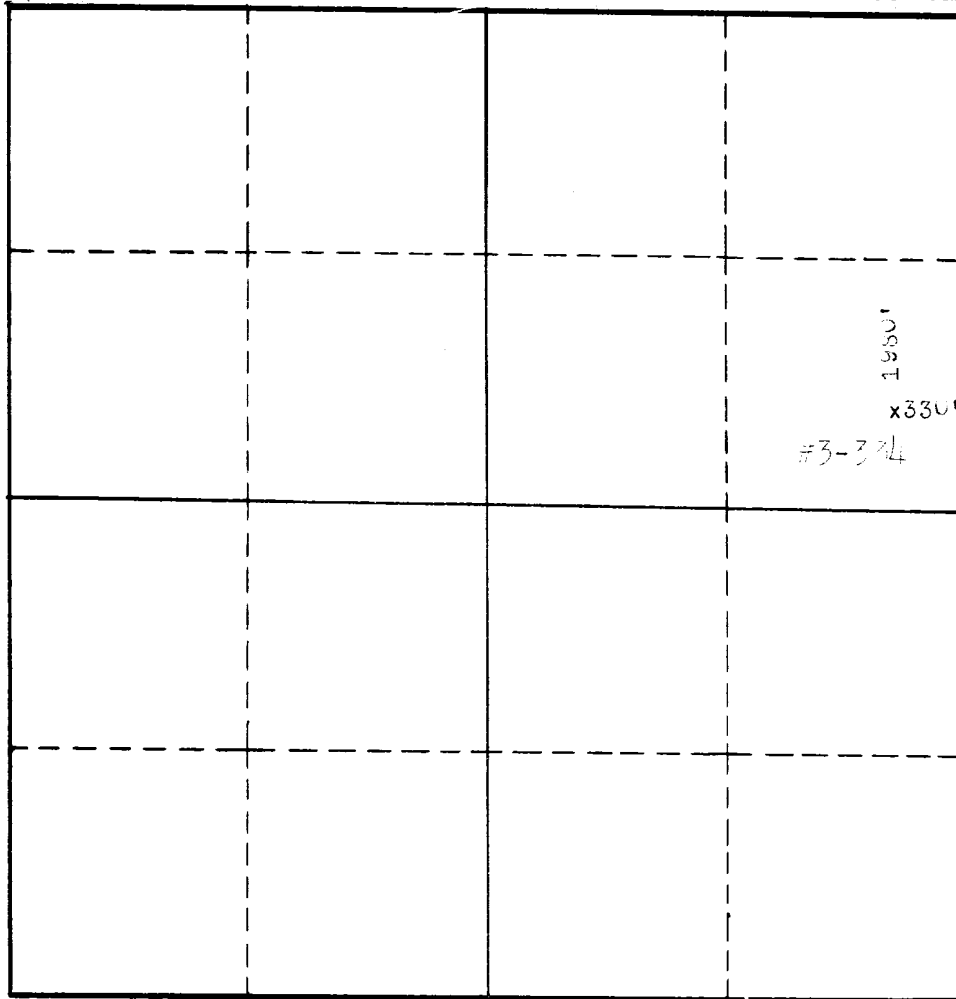

SCALE: 1" = 1000'

1. Is this Well a Dual Comp. ? Yes No x.
2. If the answer to Question 1 is yes, are there any other dually completed wells within the dedicated acreage? Yes No x.

This is to certify that the above plat was prepared from field notes of actual surveys made by me or under my supervision and that the same are true and correct to the best of my knowledge and belief.

Name D. H. Collins, Jr. D. H. Collins, Jr.
Position Petroleum Engineer
Representing The Superior Oil Company
Address Midland, Texas

Date Surveyed March 7, 1956
[Signature]
Registered Professional Engineer and/or
Land Surveyor
