

NEW MEXICO OIL CONSERVATION COMMISSION

Santa Fe, New Mexico

NOTICE OF INTENTION TO DRILL OR RECOMPLETE

Notice must be given to the District Office of the Oil Conservation Commission and approval obtained before drilling or recompletion begins. If changes in the proposed plan are considered advisable, a copy of this notice showing such changes will be returned to the sender. Submit this notice in **QUINTUPLICATE**. One copy will be returned following approval. See additional instructions in Rules and Regulations of the Commission.

Monument, New Mexico

(Place)

July 31, 1957

(Date)

OIL CONSERVATION COMMISSION
SANTA FE, NEW MEXICO

Gentlemen:

You are hereby notified that it is our intention to commence the (Drilling) (~~Recompletion~~) of a well to be known as
Amerada Petroleum Corporation

(Company or Operator)

W. H. Merchant

(Lease)

Well No. **1**, in **"T"** The well is

(Unit)

located **1900** feet from the **South** line and **660** feet from the

East

line of Section **10**, T **21-S**, R **35-E**, NMPM.

(GIVE LOCATION FROM SECTION LINE) **Wildest** Pool, **Lea** County

D	C	B	A
E	F	G	H
L	K	J	I
M	N	O	P

2-35-E

If State Land the Oil and Gas Lease is No.

If patented land the owner is **The Merchant Livestock Company**

Address **Carlsbad, New Mexico**

We propose to drill well with drilling equipment as follows: **Rotary tools all the way.**

The status of plugging bond is **Blanket**

Drilling Contractor **Howard P. Halmes Drilling Co.**
Box 667 - Hobbs, New Mexico

We intend to complete this well in the **Bone Spring** formation at an approximate depth of **8000'** feet.

CASING PROGRAM

We propose to use the following strings of Casing and to cement them as indicated:

Size of Hole	Size of Casing	Weight per Foot	New or Second Hand	Depth	Sacks Cement
12 1/2" & 11"	8-5/8"	24 1/2	New	1750'	1,000
7-7/8"	5-1/2"	15.5 1/2	New	8000'	500

If changes in the above plans become advisable we will notify you immediately.

ADDITIONAL INFORMATION (If recompletion give full details of proposed plan of work.)

AUG 5 1957

Approved....., 19.....

Except as follows:

CEMENT MUST BE CIRCULATED BEHIND

8 5/8"

CASING.

OIL CONSERVATION COMMISSION

By **E. J. Fisher**

Engineer District 1

Title

Sincerely yours,

Amerada Petroleum Corporation

(Company or Operator)

By **H. C. Cap...**

Position **District Superintendent**

Send Communications regarding well to

Name **Amerada Petroleum Corporation**

Address **Drawer "D"**

Monument, New Mexico

NEW MEXICO OIL CONSERVATION COMMISSION
DUPLICATE
Well Location and Acreage Dedication Plat

Section A.

Date 7-31-57

Operator Amerada Pet. Corp. Lease W. H. Merchant's
Well No. 1 Unit Letter I Section 10 Township 21 S Range 35 E NMPM
Located 1980 Feet From South Line, 660 Feet From East Line
County Lea G. L. Elevation _____ Dedicated Acreage _____ Acres
Name of Producing Formation Permian Pool Wildcat

1. Is the Operator the only owner* in the dedicated acreage outlined on the plat below?
Yes X No _____.
2. If the answer to question one is "no," have the interests of all the owners been consolidated by communitization agreement or otherwise? Yes _____ No _____. If answer is "yes," Type of Consolidation _____
3. If the answer to question two is "no," list all the owners and their respective interests below:

Owner

Land Description

Section B

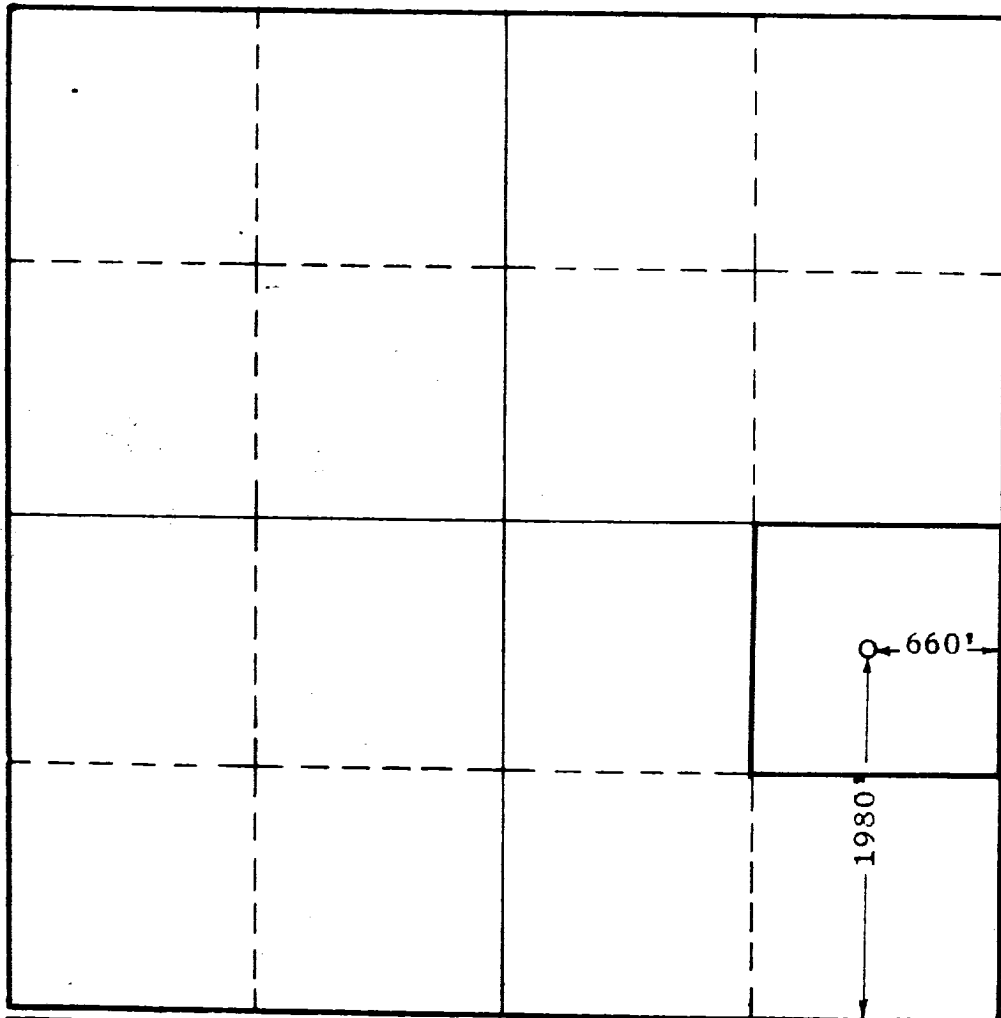

This is to certify that the information in Section A above is true and complete to the best of my knowledge and belief.

Amerada Petroleum Corporation

(Operator)

D. C. Capel
(Representative)

Denver 20, Kansas, E.H.

Address

This is to certify that the well location shown on the plat in Section B was plotted from field notes of actual surveys made by me or under my supervision and that the same is true and correct to the best of my knowledge and belief.

Date Surveyed 7-31-57

John W. West
Registered Professional
Engineer and/or Land Surveyor.

Certificate No. 676