

STAKING PLAT

CHARM OIL COMPANY      Wilson State      4  
Operator                      Lease                      Well

Lea County, New Mexico

2310 feet from north and 990 feet from east lines of

Section 11, Township 21, Range 35

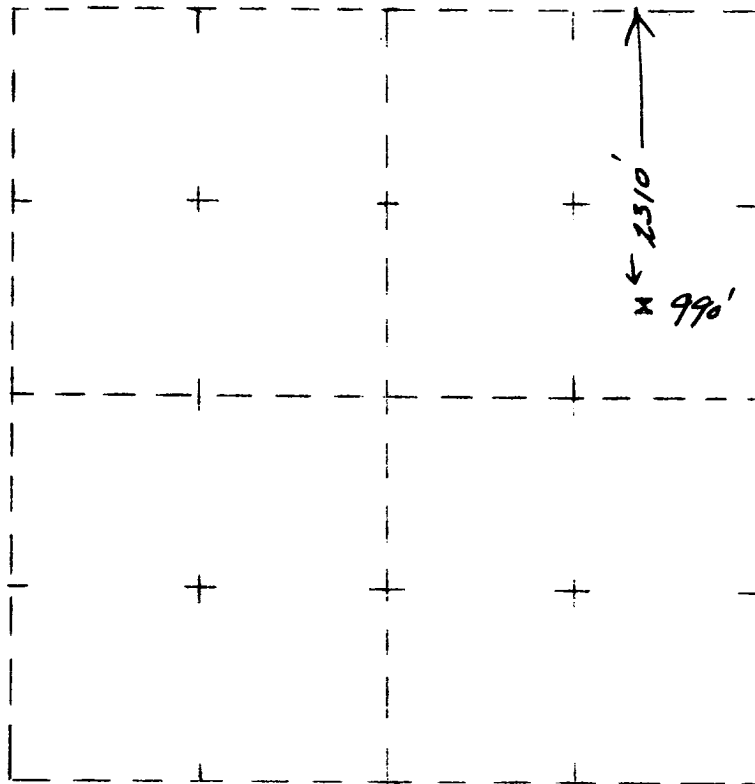

Certificate

The undersigned is registered as a Land Surveyor in the State of New Mexico and hereby swears that this plat was prepared from field notes made under his direction, and that it is true and correct to the best of his knowledge and belief.

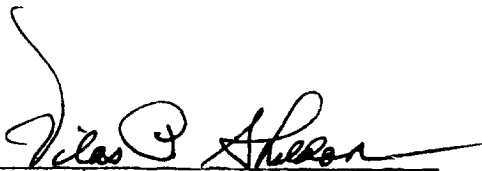
  
Vilas P. Sheldon

## APPENDIX A

The following table shows the results of the analysis of variance for the effect of the treatment on the response variable. The results are presented in the form of a table with the following columns: Source of Variation, Sum of Squares, Degrees of Freedom, Mean Square, and F-value. The results are as follows:

Source of Variation	Sum of Squares	Degrees of Freedom	Mean Square	F-value
Treatment	10.00	1	10.00	10.00
Error	90.00	19	4.74	
Total	100.00	20		

The results of the analysis of variance show that the treatment has a significant effect on the response variable. The F-value for the treatment is 10.00, which is greater than the critical value of 5.99 at the 0.05 level of significance. Therefore, we reject the null hypothesis and conclude that the treatment has a significant effect on the response variable.