

NEW MEXICO OIL CONSERVATION COMMISSION
Well Location and Acreage Dedication Plat

Section A.

Date August 20, 1957

Operator Shell Oil Company Lease State N.
Well No. 4 Unit Letter I Section 23 Township -21-3 Range -35-3 NMPM
Located 1980 Feet From south Line, 990 Feet From east Line
County Lee G. L. Elevation 3597 Dedicated Acreage 320 Acres
Name of Producing Formation Yates (Gas) Pool Bumont

1. Is the Operator the only owner* in the dedicated acreage outlined on the plat below?
Yes X No .
2. If the answer to question one is "no," have the interests of all the owners been consolidated by communitization agreement or otherwise? Yes No . If answer is "yes," Type of Consolidation
3. If the answer to question two is "no," list all the owners and their respective interests below:

Owner

Land Description

<u>Owner</u>	<u>Land Description</u>

Section B

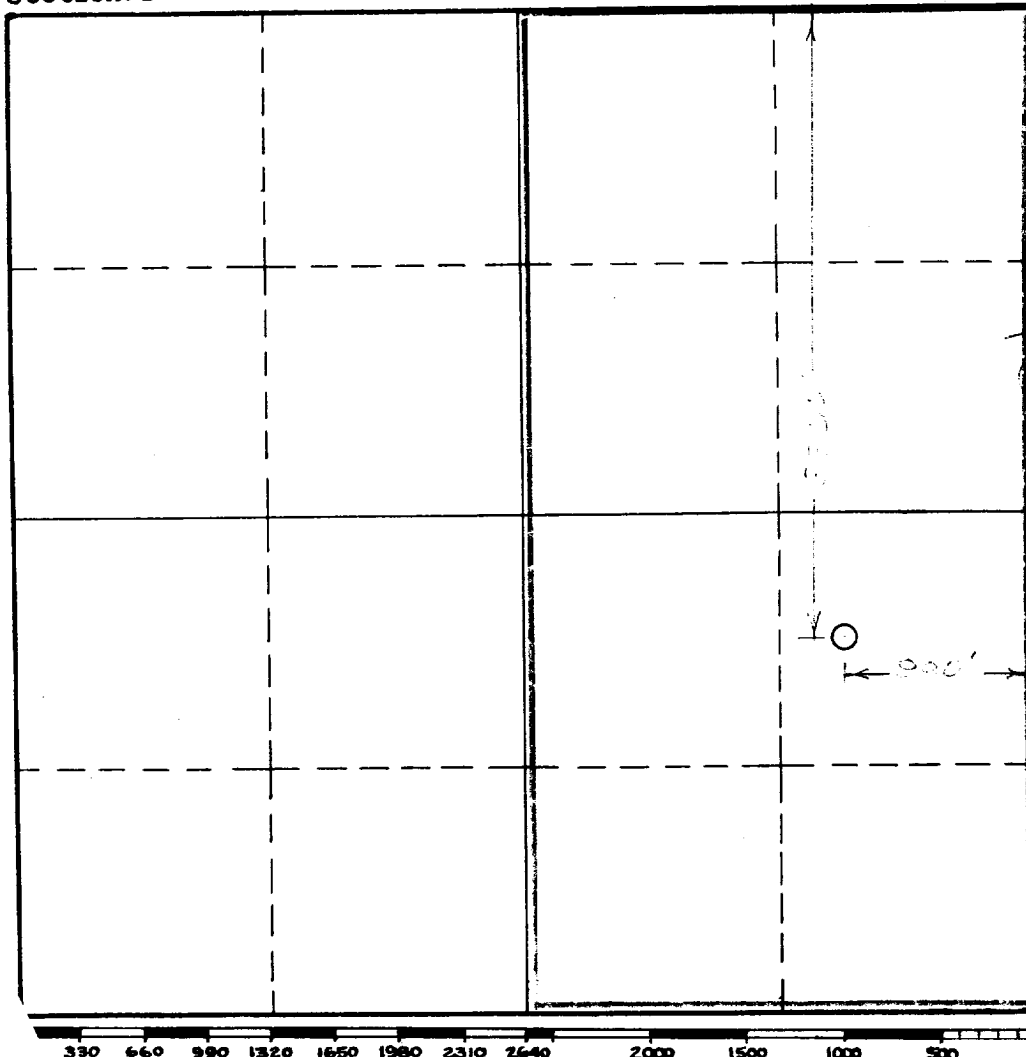

This is to certify that the information in Section A above is true and complete to the best of my knowledge and belief.

Shell Oil Company
(Operator)

A. Revill
(Representative)

Box 1957, Hobbs, New Mexico
Address

This is to certify that the well location shown on the plat in Section B was plotted from field notes of actual surveys made by me or under my supervision and that the same is true and correct to the best of my knowledge and belief.

Date Surveyed

Registered Professional
Engineer and/or Land Surveyor.

Certificate No.

(See instructions for completing this form on the reverse side)

INSTRUCTIONS FOR COMPLETION:

1. Operator shall furnish and certify to the information called for in Section A.
2. Operator shall outline the dedicated acreage for both oil and gas wells on the plat in Section B.
3. A registered professional engineer or land surveyor registered in the State of New Mexico or approved by the Commission shall show on the plat the location of the well and certify this information in the space provided.
4. All distances shown on the plat must be from the outer boundaries of Section.
5. If additional space is needed for listing owners and their respective interests as required in question 3, Section A, please use space below

* "Owner" means the person who has the right to drill into and to produce from any pool and to appropriate the production either for himself or for himself and another. (65-3-29 (e) NMSA 1953 Comp.)

DUPLICATE

NEW MEXICO
OIL CONSERVATION COMMISSION

Gas Well Plat

Date March 22, 1954

Shell Oil Company State "H" 4
Operator Lease Well No.

Name of Producing Formation Yates Pool Jalco

No. Acres Dedicated to the Well 160

SECTION 13 TOWNSHIP 21 RANGE 35

<u>Amesbury</u> <u>WEE</u>		<u>Shell</u> <u>H</u> <u>O</u>	<u>Shell</u> <u>H</u> <u>O</u>
			<u>O</u>
<u>Amesbury</u>		<u>Shell</u> <u>H</u> <u>O</u>	<u>TC</u> <u>180'</u>
	<u>State</u>		<u>O</u>

I hereby certify that the information given above is true and complete to the best of my knowledge.

Original signed by
B. Nevill

Name B. Nevill
Position Division Exploitation Engineer
Representing Shell Oil Company
Address P. O. Box 1957, Hobbs, New Mexico

(over)

INSTRUCTIONS

1. Is this gas well a dual completion? Yes **X** No
2. If the answer to Question 1 is Yes, are there any other dually completed wells within the dedicated acreage? Yes No **X**

A separate plat must be filed for each gas well, outlining the area dedicated to such well and showing the location of all other wells (oil and gas) within the outlined area.

Mail in duplicate to the district office for the district in which the well is located.