

State of New Mexico  
Energy, Minerals & Natural Resources Department

Form C-1  
Revised February 10, 1964  
Instructions on back  
Submit to Appropriate District Office  
State Lease - 4 Copies  
Fee Lease - 3 Copies

☒ AMENDED REPORT

API Number		Pool Code	Pool Name
30-025-03497		76480	Eumont Yates 7 Rivers Queen
Property Code	Property Name		Well Number
002830	State C Comm		2
OGRID No.	Operator Name		Elevation
004537	Citation Oil & Gas Corp.		3626

UL or lot no.	Section	Township	Range	Lot Ida	Feet from the	North/South line	Feet from the	East/West line	County
H	24	21S	35E		1650	North	330	East	Lea

Bottom Hole Location If Different From Surface									
UL or lot no.	Section	Township	Range	Lot Idn	Feet from the	North/South line	Feet from the	East/West line	County
12 Dedicated Acres	13 Joint or Infill	14 Consolidation Code		15 Order No.					
200									
NO ALLOWABLE WILL BE ASSIGNED TO THIS COMPLETION DEED. ALL DEEDS									

NO ALLOWABLE WILL BE ASSIGNED TO THIS COMPLETION UNTIL ALL INTERESTS HAVE BEEN CONSOLIDATED  
OR A NON-STANDARD UNIT HAS BEEN APPROVED BY THE DIVISION

OR A NON-STANDARD UNIT HAS BEEN APPROVED BY THE DIVISION				
16				<p><b>17 OPERATOR CERTIFICATION</b></p> <p>I hereby certify that the information contained herein is true and complete to the best of my knowledge and belief.</p> <p style="font-size: 1.2em;"><i>Sharon Ward</i></p> <hr/> <p>Signature      Sharon Ward</p> <hr/> <p>Printed Name      Prod. Reg. Supv.</p> <hr/> <p>Title      2-28-95</p> <hr/> <p>Date</p>
			1650  2 2310  2y 990	
		24		
				<p><b>18 SURVEYOR CERTIFICATION</b></p> <p>I hereby certify that the well location shown on this plat was plotted from field notes of actual surveys made by me or under my supervision, and that the same is true and correct to the best of my belief.</p> <hr/> <p>Date of Survey</p> <hr/> <p>Signature and Seal of Professional Surveyor:</p>  <hr/> <p>Certificate Number</p>

Revised 5/1/57

## NEW MEXICO OIL CONSERVATION COMMISSION

Well Location and Acreage Dedication Plat

HOBBBS OFFICE OCC

## Section A.

Date October 10, 1957

Operator Shell Oil Company Lease State C Com  
 Well No. 2 Unit Letter H Section 24 Township -21-S Range -35-E NMPM  
 Located 1650 Feet From north Line, 330 Feet From east Line  
 County Lea G. L. Elevation 3626 DF Dedicated Acreage 200 Acres  
 Name of Producing Formation Yates Pool Fumont

1. Is the Operator the only owner\* in the dedicated acreage outlined on the plat below?  
Yes ☒ No ☐.
2. If the answer to question one is "no," have the interests of all the owners been consolidated by communitization agreement or otherwise? Yes ☐ No ☐. If answer is "yes," Type of Consolidation \_\_\_\_\_
3. If the answer to question two is "no," list all the owners and their respective interests below:

OwnerLand Description

## Section B

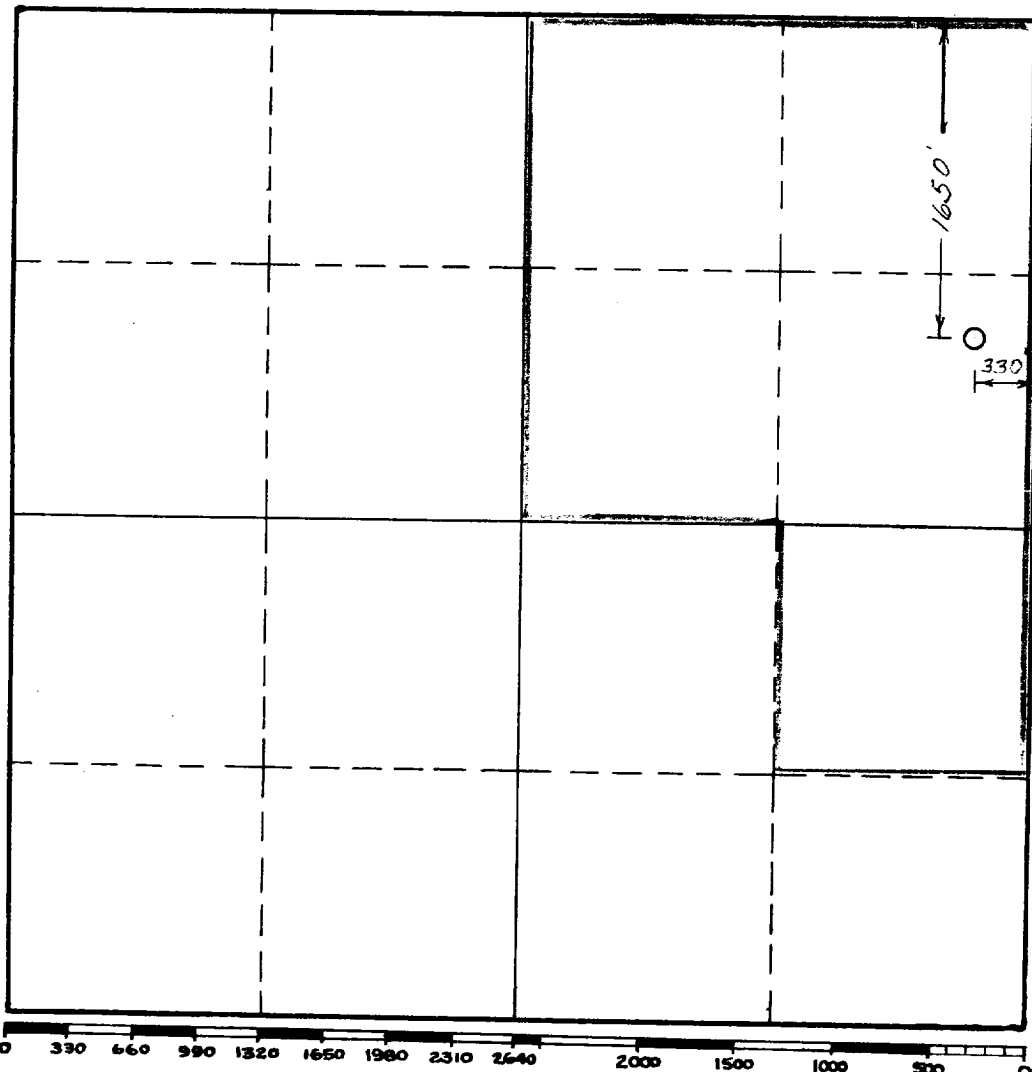

This is to certify that the information in Section A above is true and complete to the best of my knowledge and belief.

Shell Oil Company  
(Operator)

Original Signed By  
Rex C. Cabaniss Rex C. Cabaniss  
(Representative)

Box 1957, Hobbs, New Mexico  
Address

This is to certify that the well location shown on the plat in Section B was plotted from field notes of actual surveys made by me or under my supervision and that the same is true and correct to the best of my knowledge and belief.

Date Surveyed \_\_\_\_\_

Registered Professional  
Engineer and/or Land Surveyor.

Certificate No. \_\_\_\_\_

(See instructions for completing this form on the reverse side)

INSTRUCTIONS FOR COMPLETION:

1. Operator shall furnish and certify to the information called for in Section A.
2. Operator shall outline the dedicated acreage for both oil and gas wells on the plat in Section B.
3. A registered professional engineer or land surveyor registered in the State of New Mexico or approved by the Commission shall show on the plat the location of the well and certify this information in the space provided.
4. All distances shown on the plat must be from the outer boundaries of Section.
5. If additional space is needed for listing owners and their respective interests as required in question 3, Section A, please use space below

\* "Owner" means the person who has the right to drill into and to produce from any pool and to appropriate the production either for himself or for himself and another. (65-3-29 (e) NMSA 1953 Comp.)