

NEW MEXICO
OIL CONSERVATION COMMISSION

Form C-128

Well Location and/or Gas Proration Plat

Date FEB. 16, 1956

Operator BEAHO CORP.

Lease ATLANTIC STATE

Well No. 1 Section 25 Township 21S Range 35E NMPM

Located 330 Feet From EAST Line, 990 Feet From SOUTH Line,

LEA

County, New Mexico. G. L. Elevation 5618.8

Name of Producing Formation _____ Pool _____ Dedicated Acreage _____

(Note. All distances must be from outer boundaries of Section)

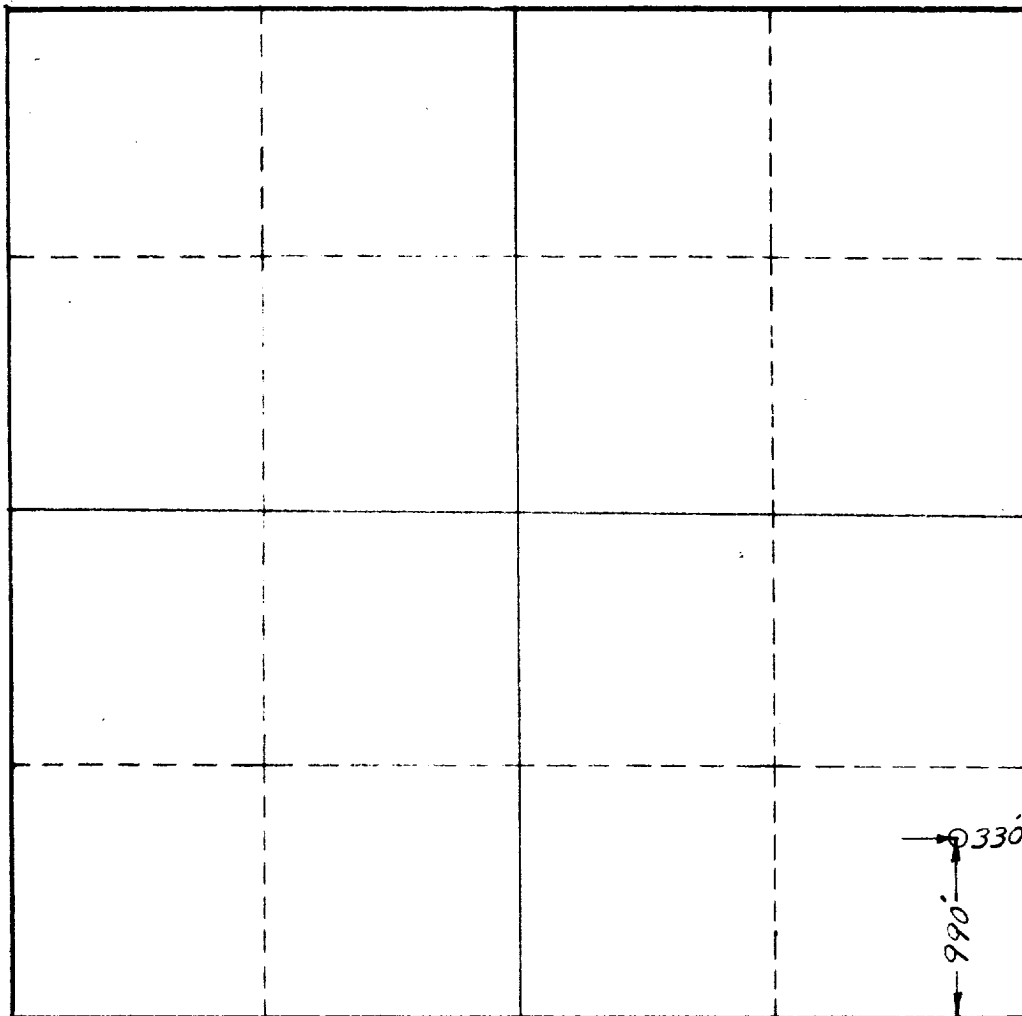

SCALE: 1" = 1000'

1. Is this Well a Dual Comp. ? Yes ___ No ___.
2. If the answer to Question 1 is yes, are there any other dually completed wells within the dedicated acreage ? Yes ___ No ___

This is to certify that the above plat was prepared from field notes of actual surveys made by me or under my supervision and that the same are true and correct to the best of my knowledge and belief.

Name _____
Position _____
Representing _____
Address _____

Date Surveyed DEC. 8, 1955
John W. West
Registered Professional Engineer and/or
Land Surveyor

NEW MEXICO OIL CONSERVATION COMMISSION
Santa Fe, New Mexico

NOTICE OF INTENTION TO DRILL OR RECOMPLETE

Notice must be given to the District Office of the Oil Conservation Commission and approval obtained before drilling or recompletion begins. If changes in the proposed plan are considered advisable, a copy of this notice showing such changes will be returned to the sender. Submit this notice in QUINTUPLICATE. One copy will be returned following approval. See additional instructions in Rules and Regulations of the Commission.

Hobbs, New Mexico

(Place)

December 12, 1955

(Date)

OIL CONSERVATION COMMISSION
SANTA FE, NEW MEXICO

Gentlemen:

You are hereby notified that it is our intention to commence the (Drilling) (Recompletion) of a well to be known as

Reaho Corporation

(Company or Operator)

Atlantic State

(Lease)

Well No. 1, in P (Unit) The well is

located 330 feet from the South line and 990 feet from the

East

line of Section 25, T. 21S, R. 35E, NMPM.

(GIVE LOCATION FROM SECTION LINE)

Jalmat

Pool, Lea County

If State Land the Oil and Gas Lease is No. B-1671

If patented land the owner is

Address

We propose to drill well with drilling equipment as follows: Rotary to Total Depth

The status of plugging bond is Applied for

Drilling Contractor La Mance Drilling Company

We intend to complete this well in the Yates

formation at an approximate depth of 4000 feet.

CASING PROGRAM

We propose to use the following strings of Casing and to cement them as indicated:

Size of Hole	Size of Casing	Weight per Foot	New or Second Hand	Depth	Sacks Cement
11"	8-5/8"	24#	New	300 ft.	Circulate
7-7/8"	5 1/2"	15.5#	Used	4000 ft.	250 sbs.

If changes in the above plans become advisable we will notify you immediately.

ADDITIONAL INFORMATION (If recompletion give full details of proposed plan of work.)

This for superceded by Form C-101-

DEC 16 1955

Approved, 19.....
Except as follows:

OIL CONSERVATION COMMISSION

By

Title

Sincerely yours,

REAHO CORPORATION

(Company or Operator)

By

Homer D. Key, Vice-President

Send Communications regarding well to

Name Reaho Corporation

Address 1316 Mercantile Bank Bldg.

Dallas 1, Texas.