

NEW MEXICO OIL CONSERVATION COMMISSION
Santa Fe, New Mexico

Form C-101
Revised (12/1/55)

Lease No. 41485

NOTICE OF INTENTION TO DRILL

HOBBS OFFICE OCC

Notice must be given to the District Office of the Oil Conservation Commission and approval obtained before drilling or recompletion begins. If changes in the proposed plan are considered advisable, a copy of this notice showing such changes will be returned to the sender. Submit this notice in QUINTUPPLICATE. One copy will be returned following approval. See additional instructions in Rules and Regulations of the Commission. If State Land submit 6 Copies Attach Form G-128 in triplicate to first 3 copies of form C-101

Midland, Texas

September 16, 1959

(Place)

(Date)

OIL CONSERVATION COMMISSION
SANTA FE, NEW MEXICO

Gentlemen:

You are hereby notified that it is our intention to commence the Drilling of a well to be known as

TEXACO Inc.

(Company or Operator)

State of New Mexico "BZ" NCT-5

(Lease)

Well No. 2, in C The well is

(Unit)

located 660 feet from the North line and 1980 feet from the

West

line of Section 29, T. 21-S, R. 35-E, NMPM.

(GIVE LOCATION FROM SECTION LINE) Undesignated Pool, Lea County

If State Land the Oil and Gas Lease is No. B-158

If patented land the owner is ---

Address ---

We propose to drill well with drilling equipment as follows: Rotary

The status of plugging bond is \$10,000 blanket surety bond of Maryland Casualty Co. has been filed with State Geologist.

Drilling Contractor Not known at present

We intend to complete this well in the Yates formation at an approximate depth of 3900 feet.

CASING PROGRAM

We propose to use the following strings of Casing and to cement them as indicated:

Size of Hole	Size of Casing	Weight per Foot	New or Second Hand	Depth	Backs Cement
11"	8-5/8"	24#	New	200	200
6-3/4"	2-7/8"	6.5#	New	3900	400

If changes in the above plans become advisable we will notify you immediately.

ADDITIONAL INFORMATION (If recompletion give full details of proposed plan of work.)

FORMATIONS EXPECTED:

Top of Anhydrite 1830'
" " Yates 3700'
Total Depth 3900'

SEP 17 1959

Approved: _____, 19_____
Except as follows:

OIL CONSERVATION COMMISSION

By _____ Engineer District 1

Sincerely yours,

TEXACO Inc.

(Company or Operator)

By

J. J. Velten

Position Division Civil Engineer

Send Communications regarding well to

Name TEXACO Inc.

Address P.O. Box 3109, Midland, Texas

HOBBS OFFICE OCC

1950 SEP 17 AM 10:01

This well is to be drilled as a tubingless completion and will conform with the requirements of OCC Rule 107 (e), as follows:

1. The proposed total depth is less than 5,000'.
2. The well is not a wildcat but will serve to extend the Wilson Pool.
3. No unusual corrosion problems are anticipated. The BHP at 3,803' in Texaco's State of New Mexico "BZ" NCT-5 Well No. 1 is 1455 psi, a normal pressure at that depth.
4. This well is not to be dualled.
5. A string of 2 7/8" O.D. tubing is to be used in lieu of casing.

In view of this conformance to the provisions of Rule 107 (e), it is respectfully requested that this well be approved for tubingless completion by the District Supervisor as permitted by this same rule.

NEW MEXICO OIL CONSERVATION COMMISSION

Well Location and Acreage Dedication Plat

Section A.

NOV 16 1958
OFFICE 000

Operator TEXACO Inc. Lease State of New Mexico "BZ" NCT-5
Well No. 2 Unit Letter "C" Section 29 Township 29S Range 30E NMPN
Located 660 Feet From North Line, 1980 Feet From West Line
County Lea G. L. Elevation 3645 Dedicated Acreage 40 Acres
Name of Producing Formation Yates Pool Undesignated

1. Is the Operator the only owner* in the dedicated acreage outlined on the plat below?
Yes X No .
2. If the answer to question one is "no," have the interests of all the owners been consolidated by communitization agreement or otherwise? Yes No . If answer is "yes," Type of Consolidation
3. If the answer to question two is "no," list all the owners and their respective interests below:

Owner

Land Description

Section B

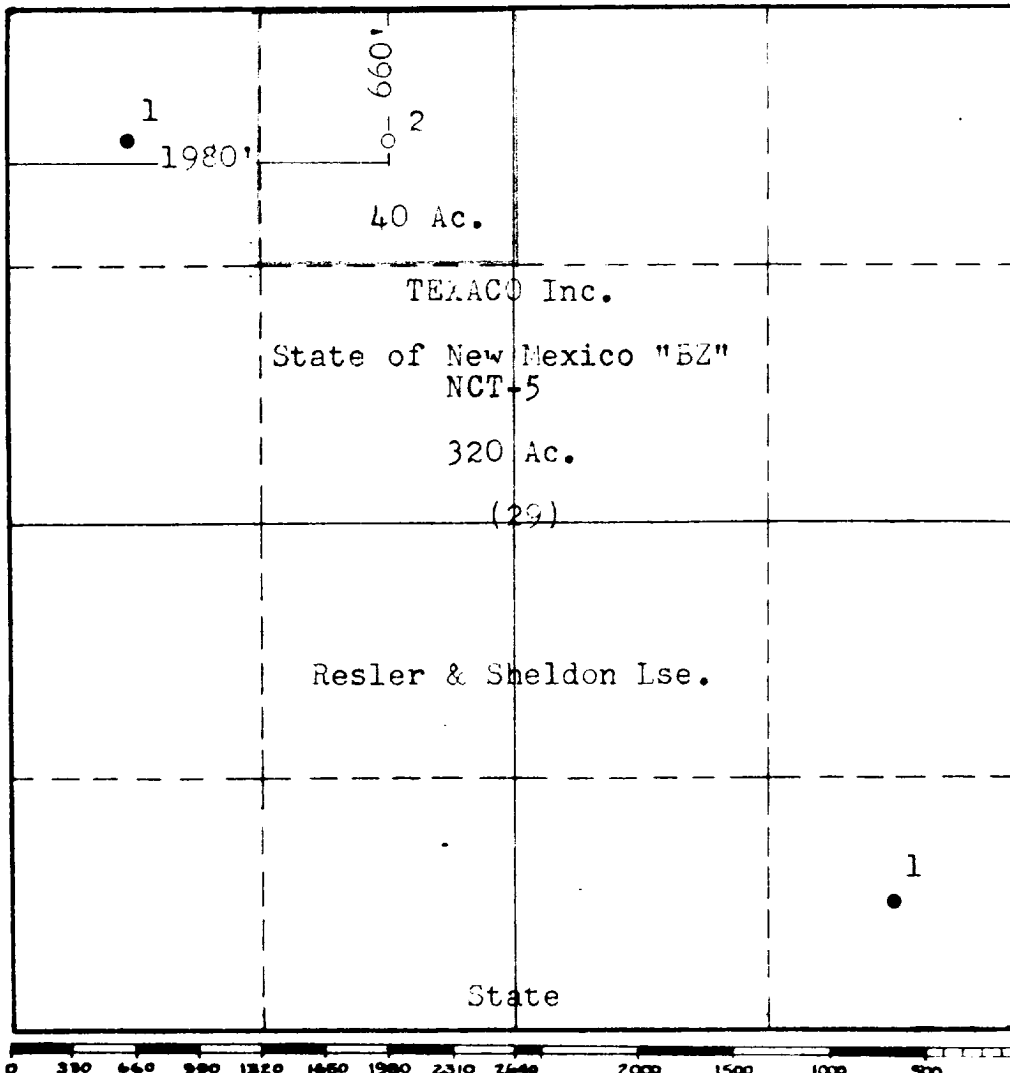

This is to certify that the information in Section A above is true and complete to the best of my knowledge and belief.

TEXACO Inc.

(Operator)

(Representative)

Division Civil Engineer

P.O. Box 3109, Midland, Texas

Address

This is to certify that the well location shown on the plat in Section B was plotted from field notes of actual surveys made by me or under my supervision and that the same is true and correct to the best of my knowledge and belief.

Date Surveyed 9-15-59

[Signature]
Registered Professional Engineer and/or Land Surveyor.

Certificate No. 8174