

Submit to Appropriate  
District Office  
State Lease - 4 copies  
Fee Lease - 3 copies

State of New Mexico  
Energy, Minerals and Natural Resources Department

Form C-102  
Revised 1-1-89

OIL CONSERVATION DIVISION

DISTRICT I  
P.O. Box 1980, Hobbs, NM 88240

P.O. Box 2088

Santa Fe, New Mexico 87504-2088

DISTRICT II  
P.O. Drawer DD, Artesia, NM 88210

SIMULTANEOUS DEDICATED

DISTRICT III  
1000 Rio Brazos Rd., Aztec, NM 87410

WELL LOCATION AND ACREAGE DEDICATION PLAT

All Distances must be from the outer boundaries of the section

Operator <b>CHEVRON U.S.A. INC.</b>			Lease <b>JF JANDA NGTD COM.</b>		Well No. <b>1</b>
Unit Letter <b>T</b>	Section <b>2</b>	Township <b>21 SOUTH</b>	Range <b>36 EAST</b>	County <b>NMPM LEA</b>	
Actual Footage Location of Well: <b>1980</b> feet from the <b>SCUTIN</b> line and <b>660</b> feet from the <b>WEST</b> line					
Ground Level Elev.	Producing Formation <b>7Rivers/Queen/Penrose</b>		Pool <b>Eumont Gas</b>		Dedicated Acreage: <b>320 Acres</b>
<p>1. Outline the acreage dedicated to the subject well by colored pencil or hatchure marks on the plat below.</p> <p>2. If more than one lease is dedicated to the well, outline each and identify the ownership thereof (both as to working interest and royalty).</p> <p>3. If more than one lease of different ownership is dedicated to the well, have the interest of all owners been consolidated by communization, unitization, force-pooling, etc.?</p> <p><input type="checkbox"/> Yes <input type="checkbox"/> No If answer is "yes" type of consolidation _____</p> <p>If answer is "no" list of owners and tract descriptions which have actually been consolidated. (Use reverse side of this form necessary.) _____</p> <p>No allowable will be assigned to the well unit all interests have been consolidated (by communization, unitization, force-pooling, otherwise) or until a non-standard unit, eliminating such interest, has been approved by the Division.</p>					

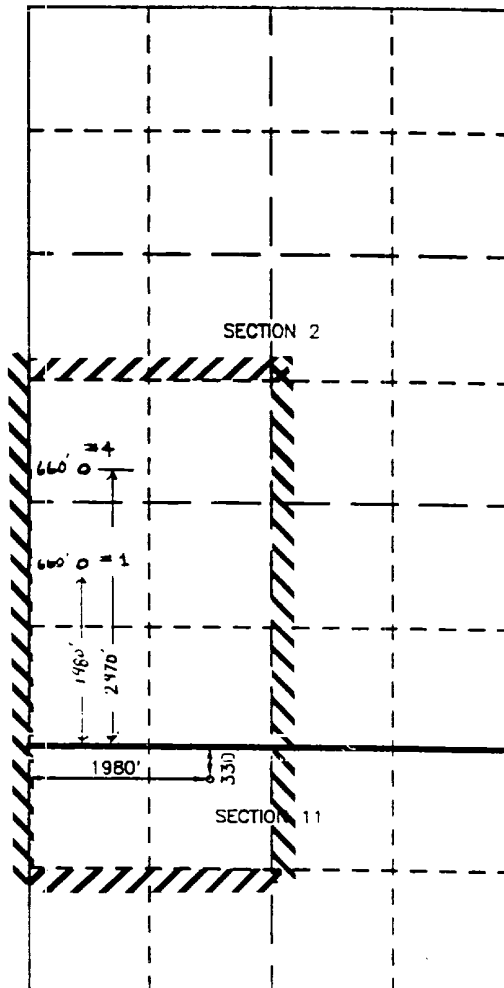

OPERATOR CERTIFICATION

I hereby certify the the information  
contained herein is true and complete to the  
best of my knowledge and belief.

Signature

*Rory Matthews*

Printed Name

Rory Matthews

Position

Technical Assistant

Company

Chevron U.S.A. Inc.

Date

2-14-94

SURVEYOR CERTIFICATION

I hereby certify that the well location shown  
on this plat was plotted from field notes of  
actual surveys made by me or under my  
supervision, and that the same is true and  
correct to the best of my knowledge and  
belief.

Date Surveyed

Signature & Seal of  
Professional Surveyor

Certificate No.

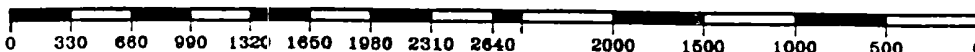

**NEW MEXICO OIL CONSERVATION COMMISSION  
WELL LOCATION AND ACREAGE DEDICATION PLAT**

Form C-102  
Supersedes C-11  
Effective 1-1-65

All distances must be from the outer boundaries of the Section.

Operator <b>Chevron U.S.A. Inc.</b>			Lessee <b>J. F. Janda (NCT-D) Com</b>		Well No. <b>1</b>
Unit Letter <b># T</b>	Section <b>2</b>	Township <b>21 S</b>	Range <b>36 E</b>	County <b>Lea</b>	
Actual Footage Location of Well: <b>1980</b> feet from the <b>South</b> line and <b>660</b> feet from the <b>West</b> line					
Ground Level Elev. <b>1980</b>	Producing Formation <b>Queen Penrose</b>		Pool <b>Eumont</b>	Dedicated Acreage: <b>320</b> Acres	

1. Outline the acreage dedicated to the subject well by colored pencil or hachure marks on the plat below.
2. If more than one lease is dedicated to the well, outline each and identify the ownership thereof (both as to working interest and royalty).
3. If more than one lease of different ownership is dedicated to the well, have the interests of all owners been consolidated by communitization, unitization, force-pooling, etc?

☒ Yes    ☐ No    If answer is "yes," type of consolidation Communitization

If answer is "no," list the owners and tract descriptions which have actually been consolidated. (Use reverse side of this form if necessary.) \_\_\_\_\_

No allowable will be assigned to the well until all interests have been consolidated (by communitization, unitization, forced-pooling, or otherwise) or until a non-standard unit, eliminating such interests, has been approved by the Commission.

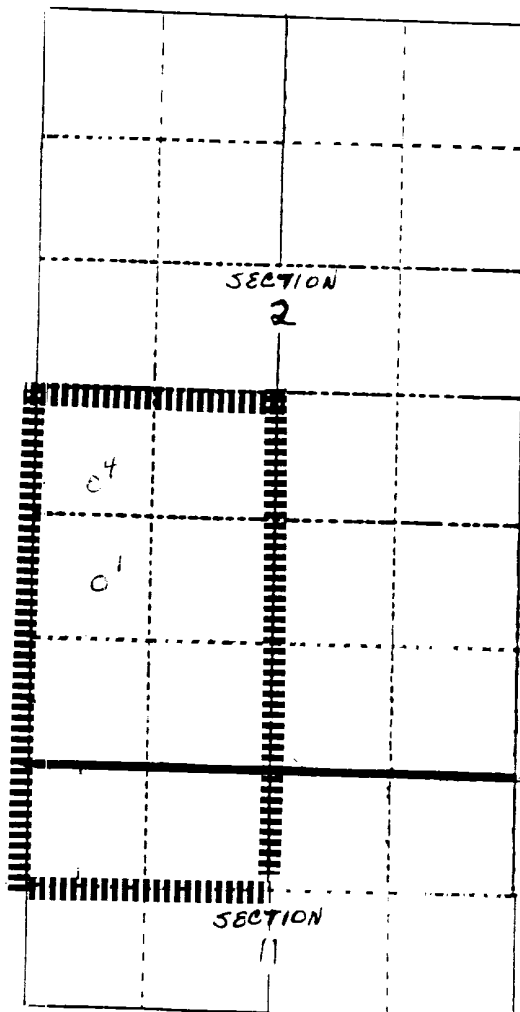

**CERTIFICATION**

I hereby certify that the information contained herein is true and complete to the best of my knowledge and belief.

*Nita Rice*

Name

Nita Rice

Position

Technical Assistant

Company

Chevron U.S.A. Inc.

Date

December 1, 1992

I hereby certify that the well location shown on this plat was plotted from field notes of actual surveys made by me or under my supervision, and that the same is true and correct to the best of my knowledge and belief.

Date Surveyed

Registered Professional Engineer  
and/or Land Surveyor

NEW MEXICO OIL CONSERVATION COMMISSION

Well Location and Acreage Dedication Plat

Section A.

Operator Gulf Oil Corporation Lease J. F. Janda Date July 29, 1958  
Well No. 1 Unit Letter T Section 2 Township 21-S Range 13-E NMPM  
Located 660 Feet From West Line, 1980 Feet From South Line  
County Lea G. L. Elevation 3534' Dedicated Acreage 320\* Acres  
Name of Producing Formation Queen Pool Eumont Gas

1. Is the Operator the only owner\* in the dedicated acreage outlined on the plat below?  
Yes \_\_\_\_\_ No X.
2. If the answer to question one is "no," have the interests of all the owners been consolidated by communitization agreement or otherwise? Yes X No \_\_\_\_\_. If answer is "yes," Type of Consolidation Communitization Agreement
3. If the answer to question two is "no," list all the owners and their respective interests below: \*Hearing for 320-acre non-standard gas proration unit was held July 24, 1958, in Santa Fe, New Mexico.

Owner

Land Description

Section B • -Oil Well

☼ -Dual (Gas-Oil)

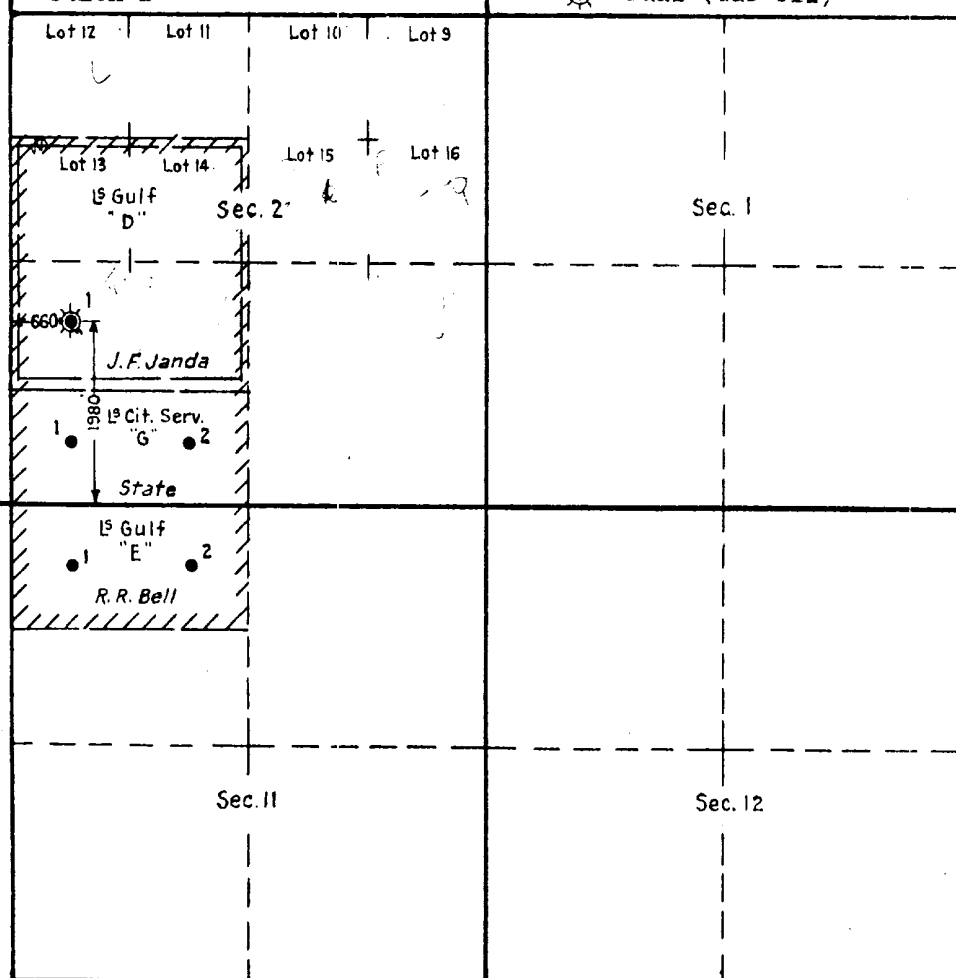

----- Lease Line  
//////// Acreage Dedicated

This is to certify that the information in Section A above is true and complete to the best of my knowledge and belief.

Gulf Oil Corporation  
(Operator)

(Representative)  
P. O. Box 1290  
Fort Worth 1, Texas  
Address

This is to certify that the well location shown on the plat in Section B was plotted from field notes of actual surveys made by me or under my supervision and that the same is true and correct to the best of my knowledge and belief.

Date Surveyed \_\_\_\_\_

Registered Professional  
Engineer and/or Land Surveyor.

Certificate No. \_\_\_\_\_

(See instructions for completing this form on the reverse side)

INSTRUCTIONS FOR COMPLETION:

1. Operator shall furnish and certify to the information called for in Section A.
2. Operator shall outline the dedicated acreage for both oil and gas wells on the plat in Section B.
3. A registered professional engineer or land surveyor registered in the State of New Mexico or approved by the Commission shall show on the plat the location of the well and certify this information in the space provided.
4. All distances shown on the plat must be from the outer boundaries of Section.
5. If additional space is needed for listing owners and their respective interests as required in question 3, Section A, please use space below

\* "Owner" means the person who has the right to drill into and to produce from any pool and to appropriate the production either for himself or for himself and another. (65-3-29 (e) NMSA 1953 Comp.)

NEW MEXICO  
OIL CONSERVATION COMMISSION

Gas Well Plat

CORRECTED

Date 11-17-55

Gulf Oil Corporation  
Operator

J. F. Janda "D"  
Lease

1  
Well No.

Name of Producing Formation Queen Pool Eumont Gas

No. Acres Dedicated to the Well 240

Application for 240-acre Non-Standard  
Gas Production Unit approved  
Administrative Order NSF-201

SECTION 2 TOWNSHIP -21-S RANGE -36-E

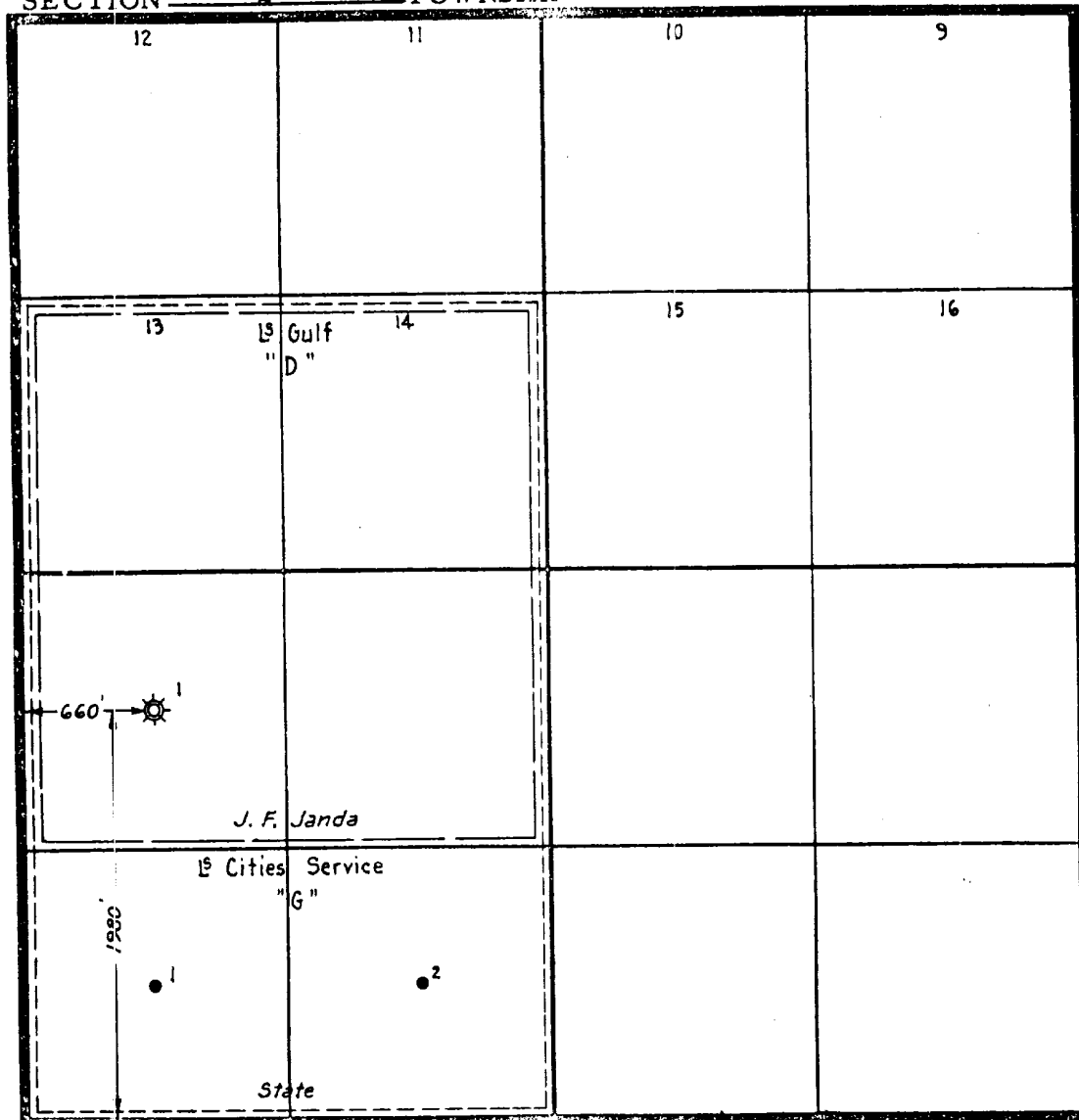

I hereby certify that the information given above is true and complete to the best of my knowledge.

- - Oil Well
- ☀ - Gas Well
- - Lease Line
- - Acreage Dedicated

Name J. R. Sherman J. R. She  
Position Division Gas Engineer  
Representing Gulf Oil Corporation  
Address P. O. Box 1290, Fort Worth 1,

(over)

### INSTRUCTIONS

1. Is this gas well a dual completion? Yes \_\_\_\_ No x
2. If the answer to Question 1 is Yes, are there any other dually completed wells within the dedicated acreage? Yes \_\_\_\_\_ No \_\_\_\_\_

A separate plat must be filed for each gas well, outlining the area dedicated to such well and showing the location of all other wells (oil and gas) within the outlined area.

Mail in duplicate to the district office for the district in which the well is located.

NEW MEXICO  
OIL CONSERVATION COMMISSION

Gas Well Plat

Date 11-22-54

Gulf Oil Corporation J. F. Jansa "D" 1  
Operator Lease Well No.

Name of Producing Formation Queen Pool Eumont Gas

No. Acres Dedicated to the Well 160

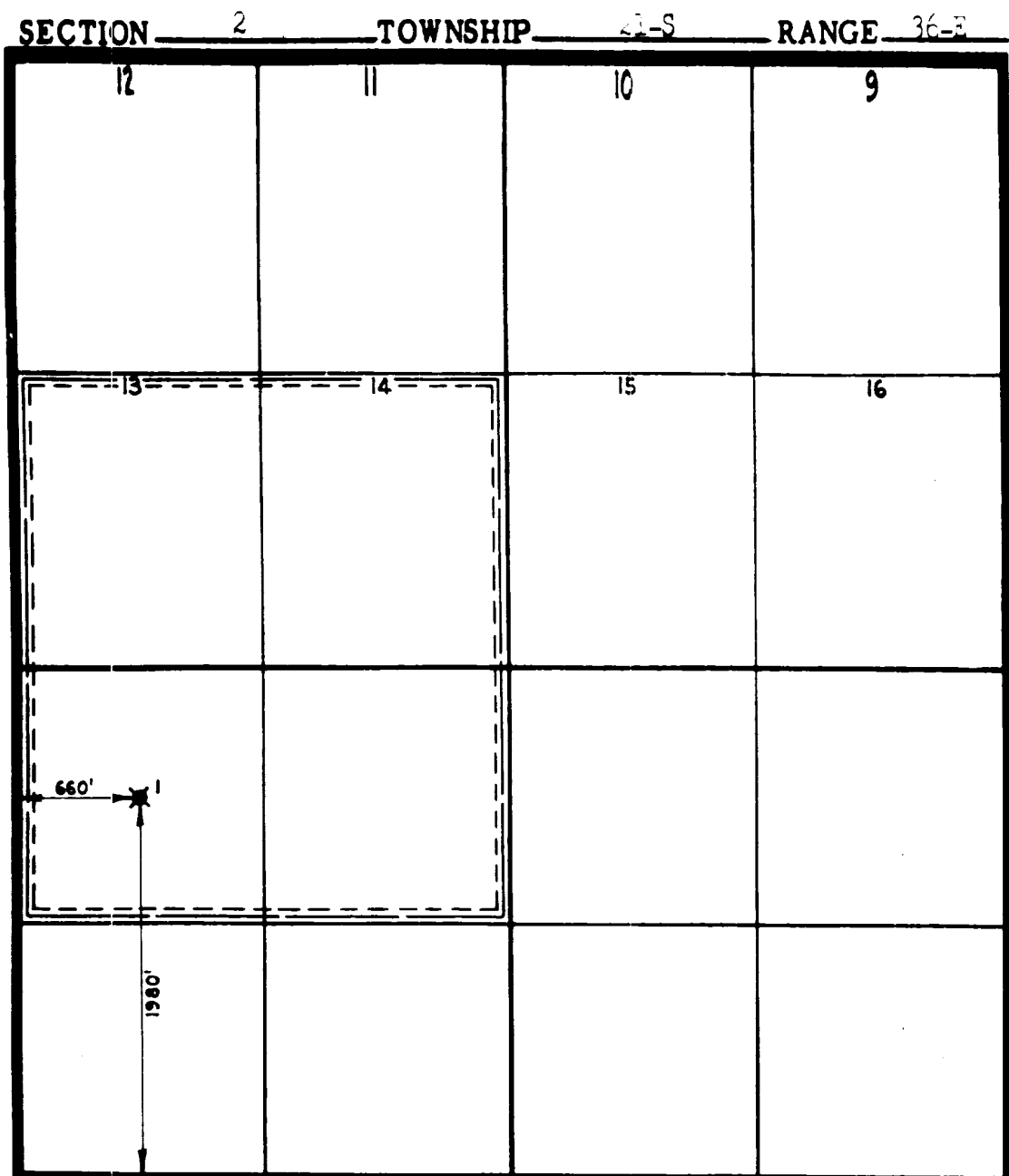

I hereby certify that the information given above is true and complete to the best of my knowledge.

- ★ - Gas Well
- - Lease Line
- - Acres Dedicated

Name T. J. Rhoads  
Position Division Gas Engineer  
Representing Gulf Oil Corporation

### INSTRUCTIONS

1. Is this gas well a dual completion? Yes \_\_\_\_\_ No x
2. If the answer to Question 1 is Yes, are there any other  
dually completed wells within the dedicated acreage?  
Yes \_\_\_\_\_ No \_\_\_\_\_

A separate plat must be filed for each gas well, outlining the area dedicated to such well and showing the location of all other wells (oil and gas) within the outlined area.

Mail in duplicate to the district office for the district in which the well is located.