

## NEW MEXICO OIL CONSERVATION COMMISSION

Santa Fe, New Mexico

## NOTICE OF INTENTION TO DRILL

Notice must be given to the Oil Conservation Commission or its proper agent and approval obtained before drilling begins. If changes in the proposed plan are considered advisable, a copy of this notice showing such changes will be returned to the sender. Submit this notice in triplicate. One copy will be returned following approval. See additional instructions in Rules and Regulations of the Commission.

Hobbs, New Mexico.

September 12, 1936

OIL CONSERVATION COMMISSION,  
Santa Fe, New Mexico.

Gentlemen:

You are hereby notified that it is our intention to commence the drilling of a well to be known as

~~Me-Tex Supply Company~~ Wallace State

Well No. 3 in Lot 14

Company or Operator Lease  
of Sec. 3, T. 21S, R. 37E, N. M. P. M., Eunice Field, Lea County.

N.

The well is 3300 feet (N.) of the South line and 1980 feet

(E.) of the West line of Sec. 3, Twp. 21S, R. 37E

(Give location from section or other legal subdivision lines. Cross out wrong directions.)

If state land the oil and gas lease is No. Assignment No.

If patented land the owner is

Address

If government land the permittee is

Address

The lessee is

Address

AREA 640 ACRES  
LOCATE WELL CORRECTLY

We propose to drill well with drilling equipment as follows: Rotary

The status of a bond for this well in conformance with Rule 39 of the General Rules and Regulations of the Commission is as follows: Already on file

We propose to use the following strings of casing and to land or cement them as indicated:

| Size of Hole | Size of Casing | Weight Per Foot | New or Second Hand | Depth | Landed or Cemented | Sacks Cement |
|--------------|----------------|-----------------|--------------------|-------|--------------------|--------------|
|              | 10"            | 40#             | Second hand        | 250'  | Cemented           | To surface   |
|              | 7 5/8"         | 28#             | New & S.H.         | 2700' | "                  | 900 sacks    |
|              | 5 1/2"         | 20#             | New & S.H.         | 3750' | "                  | 40 "         |

If changes in the above plan become advisable we will notify you before cementing or landing casing. We estimate that the first productive oil or gas sand should occur at a depth of about 3760 feet.

Additional information:

It is our intention of saving the bradenhead gas between the 7 5/8" casing and the 5 1/2" casing, as is provided in Circular #2 of the Oil Conservation Commission.

Approved SEP 14 1936, 19  
except as follows:

Sincerely yours,

~~Me-Tex Supply Company~~ Operator

Subject to special regulations for drilling and casing wells in this area

By *W. H. Bussey*  
Position President

Send communication regarding well to

OIL CONSERVATION COMMISSION,

By *F. J. Vesely*

Name Me-Tex Supply Company

Title Oil &amp; Gas Inspector

Address P.O. Box 356, Hobbs, New Mexico.

## OIL CONSERVATION DIVISION

STATE OF NEW MEXICO  
ENERGY AND MINERAL RESOURCES DEPARTMENT

P. O. BOX 2688

SANTA FE, NEW MEXICO 87501

Form C-102  
Revised 10-1-79

All distances must be from the outer boundaries of the Section.

|   |                                     |                               |  |                      |
|---|-------------------------------------|-------------------------------|--|----------------------|
| Operator<br><b>Me-Tex Supply Co.</b>  |                                     | Lease<br><b>Wallace State</b> |  | Well No.<br><b>3</b> |
| Unit Letter<br><b>N</b>   | Section<br><b>3</b>                 | Township<br><b>21 South</b>   | Range<br><b>36 East</b>                | County<br><b>Lea</b> |
| Actual Footage Location of Well:<br><b>330</b> feet from the <b>South</b> line and <b>1980</b> feet from the <b>West</b> line |                                     |                               |  |                      |
| Ground Level Elev.  | Producing Formation<br><b>Zucen</b> | Pool<br><b>Element</b>        | Dedicated Acreage:<br><b>240</b> Acres |                      |

1. Outline the acreage dedicated to the subject well by colored pencil or hatchure marks on the plat below.
2. If more than one lease is dedicated to the well, outline each and identify the ownership thereof (both as to working interest and royalty).
3. If more than one lease of different ownership is dedicated to the well, have the interests of all owners been consolidated by communitization, unitization, force-pooling, etc?

☐ Yes ☐ No If answer is "yes," type of consolidation \_\_\_\_\_

If answer is "no," list the owners and tract descriptions which have actually been consolidated. (Use reverse side of this form if necessary.) \_\_\_\_\_

No allowable will be assigned to the well until all interests have been consolidated (by communitization, unitization, forced-pooling, or otherwise) or until a non-standard unit, eliminating such interests, has been approved by the Division.

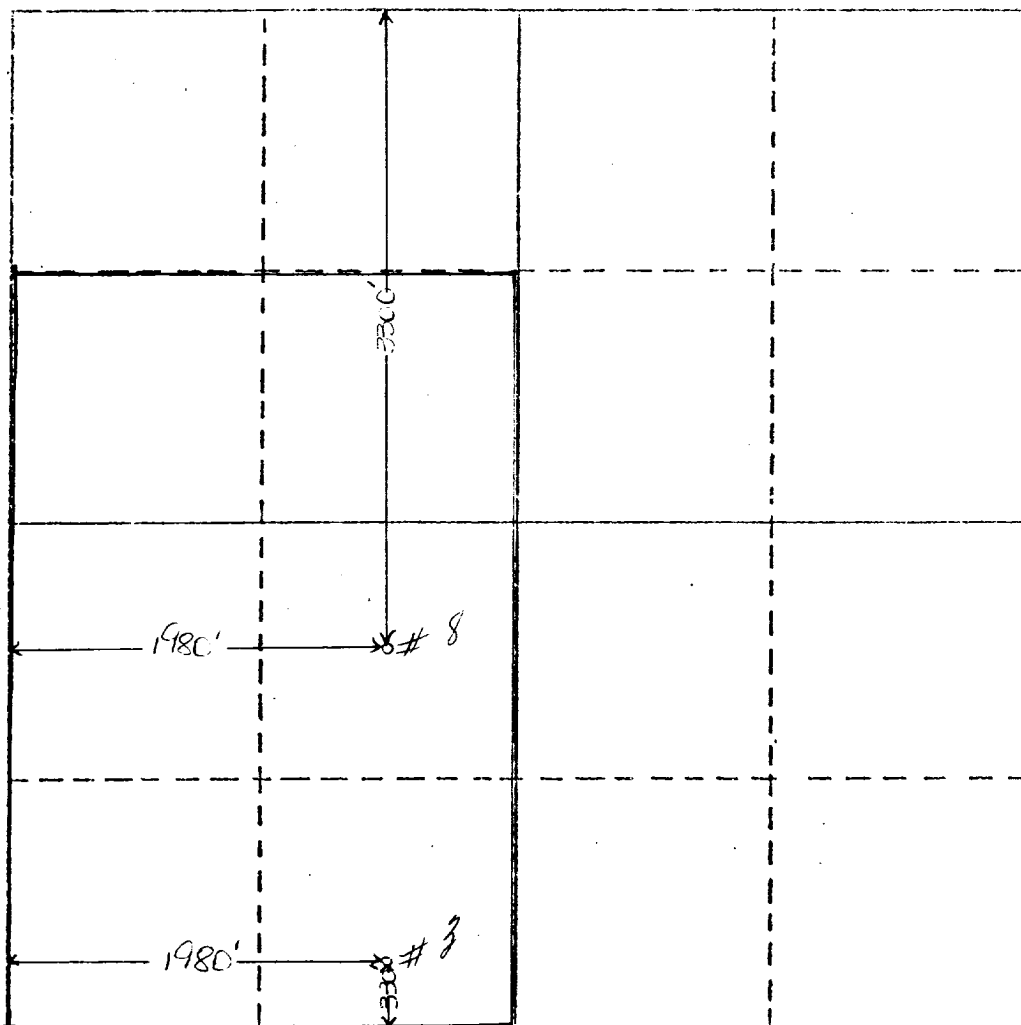

## CERTIFICATION

I hereby certify that the information contained herein is true and complete to the best of my knowledge and belief.

Name

**Judy Landusky**

Position

**Agent**

Company

**Me-Tex Supply Co.**

Date

**August 25, 1980**

I hereby certify that the well location shown on this plat was plotted from field notes of actual surveys made by me or under my supervision, and that the same is true and correct to the best of my knowledge and belief.

Date Surveyed

Registered Professional Engineer  
and/or Land Surveyor

Certificate No.

3 330 660 990 1320 1650 1980 2310 2640 2970 3300 3630 3960 4290 4620 4950 5280 5610 5940 6270 6600

**NEW MEXICO OIL CONSERVATION COMMISSION**  
**WELL LOCATION AND ACREAGE DEDICATION PLAT**

FORM C-128  
 Revised 5/1/57

SEE INSTRUCTIONS FOR COMPLETING THIS FORM ON THE REVERSE SIDE

**SECTION A**

|  |  |                        |                               |                      |  |
|--|--|------------------------|-------------------------------|----------------------|--|
| Operator<br><b>Me-Tex Supply Company</b>   |  |                        | Lease<br><b>Wallace State</b> |                      | Well No.<br><b>3</b>                   |
| Unit Letter<br><b>N</b>  | Section<br><b>3</b>                                    | Township<br><b>21S</b> | Range<br><b>36E</b>           | County<br><b>Lea</b> |  |
| Actual Footage Location of Well:<br><b>3300</b> feet from the <b>South</b> line and <b>1980</b> feet from the <b>West</b> line |  |                        |                               |                      |  |
| Ground Level Elev.   | Producing Formation<br><b>Yates-Seven Rivers Queen</b> |                        | Pool<br><b>Eumont Gas</b>     |                      | Dedicated Acreage:<br><b>240</b> Acres |

1. Is the Operator the only owner in the dedicated acreage outlined on the plat below? YES ☒ NO \_\_\_\_ . ("Owner" means the person who has the right to drill into and to produce from any pool and to appropriate the production either for himself or for himself and another. (65-3-29 (e) NMSA 1935 Comp.)
2. If the answer to question one is "no," have the interests of all the owners been consolidated by communitization agreement or otherwise? YES \_\_\_\_ NO \_\_\_\_ . If answer is "yes," Type of Consolidation \_\_\_\_
3. If the answer to question two is "no," list all the owners and their respective interests below:

| Owner | Land Description |
|-------|------------------|
|       |                  |

**SECTION B**

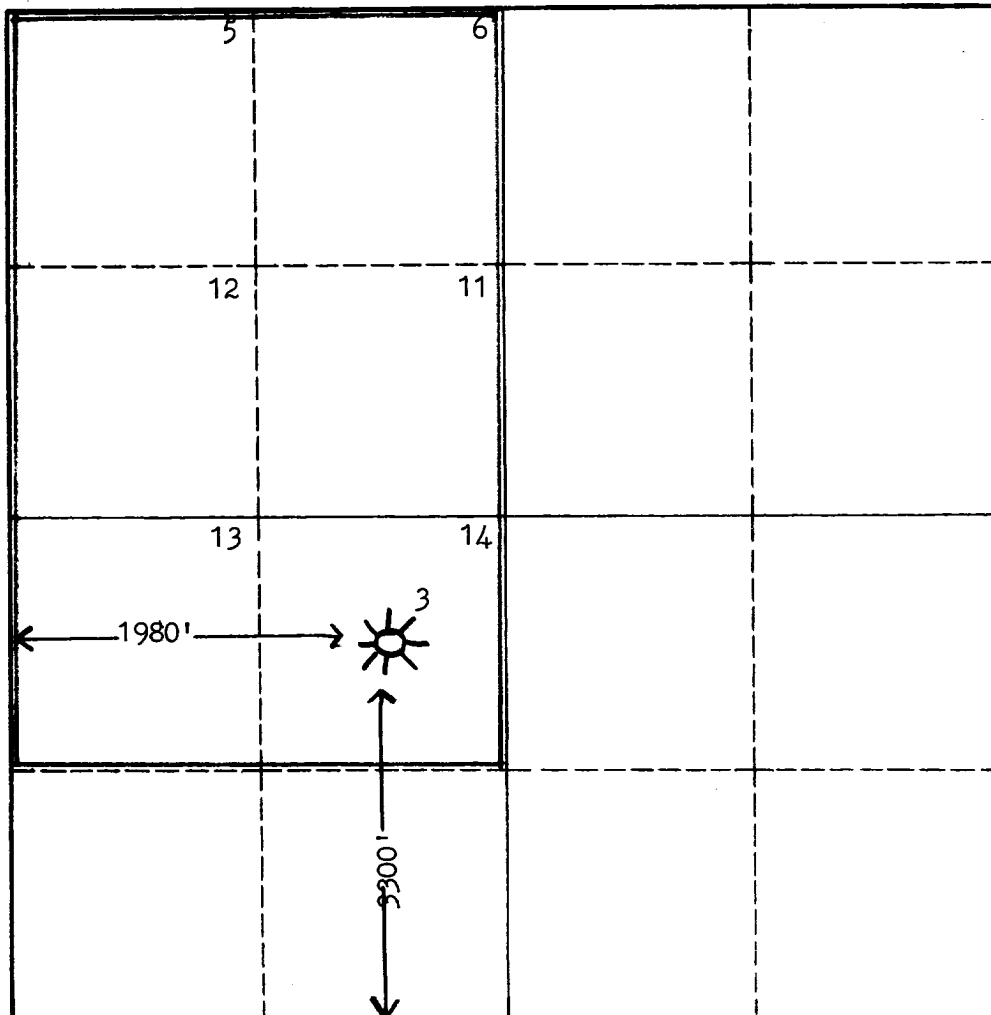

**CERTIFICATION**

I hereby certify that the information in SECTION A above is true and complete to the best of my knowledge and belief.

Name  
**R. F. Montgomery**  
 Position  
**Geologist**  
 Company  
**Me-Tex Supply Company**  
 Date  
**12/12/66**

I hereby certify that the well location shown on the plat in SECTION B was plotted from field notes of actual surveys made by me or under my supervision, and that the same is true and correct to the best of my knowledge and belief.

Date Surveyed  
 Registered Professional Engineer and/or Land Surveyor

Certificate No.

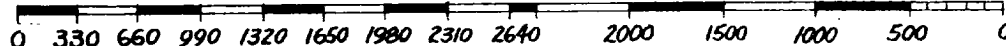

## INSTRUCTIONS FOR COMPLETION OF FORM C-128

1. Operator shall furnish and certify to the information called for in Section A.
2. Operator shall outline the dedicated acreage for *both* oil and gas wells on the plat in Section B.
3. A registered professional engineer or land surveyor registered in the State of New Mexico or approved by the Commission shall show on the plat the location of the well and certify this information in the space provided.
4. All distances shown on the plat must be from the outer boundaries of the Section.
5. If additional space is needed for listing owners and their respective interests as required in question 3 of Section A, please use space below.