

APPROVED

COPY TO O. G. S.

Form 9-331a
(Feb. 1951)

OCT 30 1962

(SUBMIT IN TRIPLICATE)

HOBBS

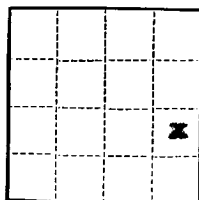
Budget Bureau No. 42-R358.4.
Form Approved.Land Office **Las Cruces**Lease No. **031740 (b)**Unit **Lot I**E. W. STANDLEY
DISTRICT ENGINEERUNITED STATES
DEPARTMENT OF THE INTERIOR
GEOLOGICAL SURVEY

SUNDRY NOTICES AND REPORTS ON WELLS

NOTICE OF INTENTION TO DRILL.....	<input checked="" type="checkbox"/>	SUBSEQUENT REPORT OF WATER SHUT-OFF.....	
NOTICE OF INTENTION TO CHANGE PLANS.....		SUBSEQUENT REPORT OF SHOOTING OR ACIDIZING.....	
NOTICE OF INTENTION TO TEST WATER SHUT-OFF.....		SUBSEQUENT REPORT OF ALTERING CASING.....	
NOTICE OF INTENTION TO RE-DRILL OR REPAIR WELL.....		SUBSEQUENT REPORT OF RE-DRILLING OR REPAIR.....	
NOTICE OF INTENTION TO SHOOT OR ACIDIZE.....		SUBSEQUENT REPORT OF ABANDONMENT.....	
NOTICE OF INTENTION TO PULL OR ALTER CASING.....		SUPPLEMENTARY WELL HISTORY.....	
NOTICE OF INTENTION TO ABANDON WELL.....			

(INDICATE ABOVE BY CHECK MARK NATURE OF REPORT, NOTICE, OR OTHER DATA)

October 29

, 19 62

Meyer B-4
Well No. **24** is located **3450** ft. from **{N}** line and **660** ft. from **{E}** line of sec. **4**
Lot I **Sec. 4** **21-S** **36-E** **NMPM**
Oil Center Elinebry **Len** **New Mexico**
(Field) (County or Subdivision) (State or Territory)

The elevation of the derrick floor above sea level is ft.

DETAILS OF WORK

(State names of and expected depths to objective sands; show sizes, weights, and lengths of proposed casings; indicate mudding jobs, cementing points, and all other important proposed work)

It is intended to drill a well at the above location with rotary tools, to an approximate total depth of 6275' in the Elinebry formation. Casing will be cemented in accordance with USGS regulations and other special requirements will be complied with.

The following casing program is planned: 7 5/8" OD 24# H-40 set at 1300' with 400 sx cnt. Cement to return to surface; 4 1/2" OD 9.5 & 11.6# J-55 set at 6275' with 320 sx cnt. Cement to return to 2400'.

Permission to produce this well upon completion is also requested.

I understand that this plan of work must receive approval in writing by the Geological Survey before operations may be commenced.

Company **Continental Oil Company**Address **Box 68****Elmice, New Mexico**

By

Title **District Superintendent**

0/4 USGS/5 plats; NMOCC 2/2 plats; WAM;
WAR/plat; Pan Am-Hobbs-3; Atl-Ros-2;
Calif. Oil Co-Houst. & Mid-1 ea; File

NEW MEXICO OIL CONSERVATION COMMISSION
WELL LOCATION AND ACREAGE DEDICATION PLAT

FORM C-128
Revised 3/1/57

SEE INSTRUCTIONS FOR COMPLETING THIS FORM ON THE REVERSE SIDE

SECTION A

Operator CONTINENTAL OIL CO.		Lease 1992 NOV 5 AM 8:27		Well No. 24
Unit Letter I	Section 4	Township 21 SOUTH	Range 36 EAST	County LEA
Actual Footage Location of Well: 3450 feet from the NORTH line and 660 feet from the EAST line				
Ground Level Elev. -	Producing Formation Ministry	Pool Oil Center Ministry	Dedicated Acreage: 40 Acres	

1. Is the Operator the only owner in the dedicated acreage outlined on the plat below? YES ☒ NO ☐ . ("Owner" means the person who has the right to drill into and to produce from any pool and to appropriate the production either for himself or for himself and another. (65-3-29 (e) NMSA 1935 Comp.)
2. If the answer to question one is "no," have the interests of all the owners been consolidated by communitization agreement or otherwise? YES ☐ NO ☐ . If answer is "yes," Type of Consolidation _____
3. If the answer to question two is "no," list all the owners and their respective interests below:

Owner	Land Description

SECTION B

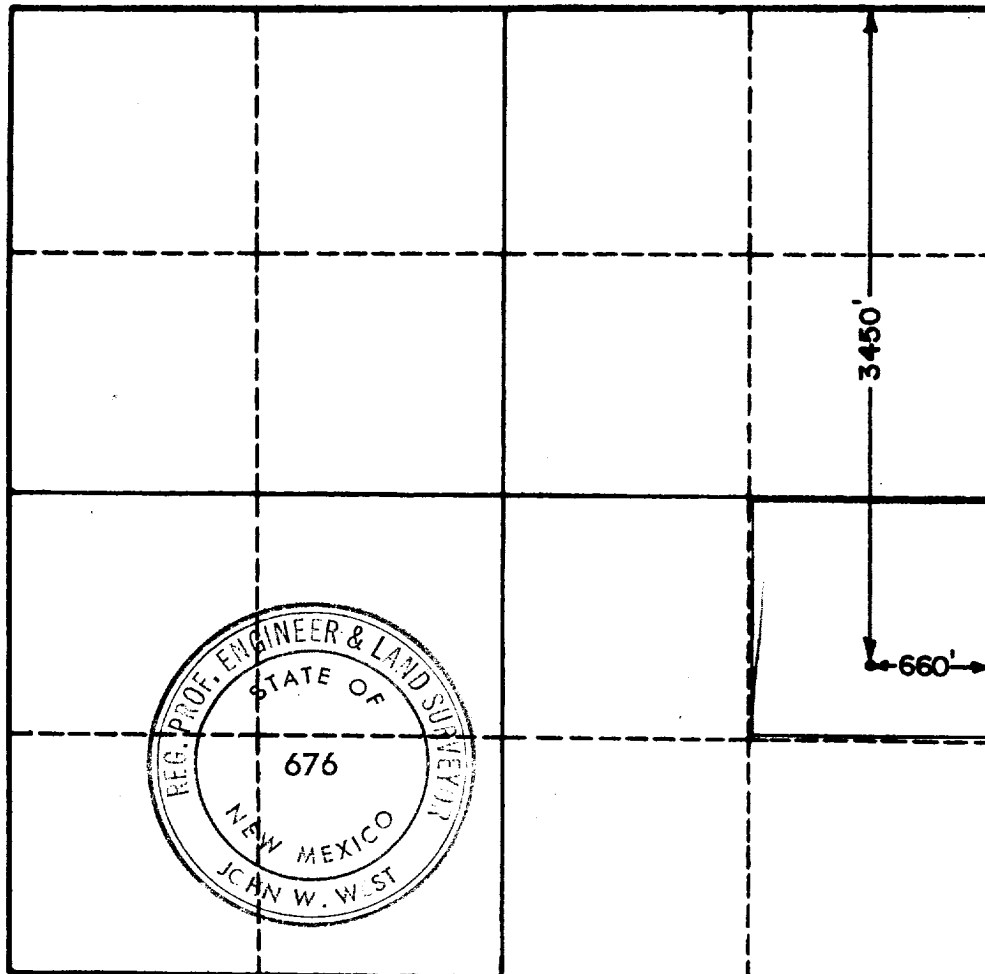

CERTIFICATION

I hereby certify that the information in SECTION A above is true and complete to the best of my knowledge and belief.

Name J. R. Baker
Position District Superintendent
Company Continental Oil Company
Date 10-27-62

I hereby certify that the well location shown on the plat in SECTION B was plotted from field notes of actual surveys made by me or under my supervision, and that the same is true and correct to the best of my knowledge and belief.

Date Surveyed 10-27-62
Registered Professional Engineer and/or Land Surveyor, JOHN W. WEST
Certificate No. N.M. - P.E. & L.S. NO. 676