

**NEW MEXICO OIL CONSERVATION COMMISSION**  
Santa Fe, New Mexico

**NOTICE OF INTENTION TO DRILL**

Notice must be given to the Oil Conservation Commission or its proper agent and approval obtained before drilling begins. If changes in the proposed plan are considered advisable, a copy of this notice showing such changes will be returned to the sender. Submit this notice in triplicate. One copy will be returned following approval. See additional instructions in Rules and Regulations of the Commission.

Tulsa, Oklahoma

April 21st, 1936

OIL CONSERVATION COMMISSION,  
Santa Fe, New Mexico

Place

Date

Gentlemen:

You are hereby notified that it is our intention to commence the drilling of a well to be known as \_\_\_\_\_

Gulf Oil Corporation Of Pa. Ball-Hansay Well No. 9 in Center of Lot 5

Company or Operator Ball-Hansay Lease Union Field, Lea County, N. M. P. M.

The well is \_\_\_\_\_ feet [N.] [S.] of the \_\_\_\_\_ line and \_\_\_\_\_ feet [E.] [W.] of the \_\_\_\_\_ line of Center of Lot 5

(Give location from section or other legal subdivision lines. Crossout wrong directions.)

If state land the oil and gas lease is No. B-250 Assignment No. \_\_\_\_\_

If patented land the owner is \_\_\_\_\_

Address \_\_\_\_\_

If government land the permittee is \_\_\_\_\_

Address \_\_\_\_\_

The lessee is Gulf Oil Corporation Of Pennsylvania

Address Tulsa, Oklahoma

We propose to drill well with drilling equipment as follows: Rotary tools

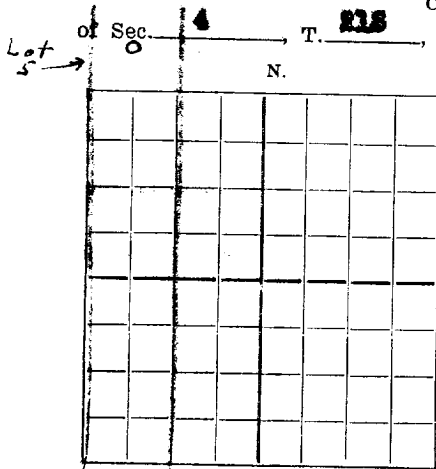

AREA 640 ACRES  
LOCATE WELL CORRECTLY

The status of a bond for this well in conformance with Rule 39 of the General Rules and Regulations of the Commission is as follows: \_\_\_\_\_

We propose to use the following strings of casing and to land or cement them as indicated:

Size of Hole	Size of Casing	Weight Per Foot	New or Second Hand	Depth	Landed or Cemented	Sacks Cement
18-5/4	10-5/4	52.75	New	250'	Cemented	250
9-7/8	7-5/8	26.4	New	1500'	Cemented	325
6-5/4	5-1/2	17	New	5650'	Cemented	300

If changes in the above plan become advisable we will notify you before cementing or landing casing. We estimate that the first productive oil or gas sand should occur at a depth of about 3650 feet.

Additional information: \_\_\_\_\_

Approved \_\_\_\_\_, 19\_\_\_\_  
except as follows:

Subject to special regulations for  
drilling and casing wells in this

OIL CONSERVATION COMMISSION,

By [Signature]  
Title Oil & Gas Inspector

Sincerely yours,

Gulf Oil Corporation Of Pennsylvania

Company or Operator

By [Signature]

Position General Superintendent

Send communication regarding well to

Name S. G. Sanderson

Address Tulsa, Oklahoma

DUPLICATE

APR 23 1936

# UNITED STATES DEPARTMENT OF JUSTICE FEDERAL BUREAU OF INVESTIGATION

MEMORANDUM FOR THE DIRECTOR, FBI

TO : SAC, NEW YORK (100-100000) FROM : SAC, NEW YORK (100-100000)

RE : [Illegible]

100-100000

ALL INFORMATION CONTAINED HEREIN IS UNCLASSIFIED

DATE 10/1/80 BY [Illegible]

100-100000	100-100000	100-100000	100-100000	100-100000	100-100000	100-100000
100-100000	100-100000	100-100000	100-100000	100-100000	100-100000	100-100000
100-100000	100-100000	100-100000	100-100000	100-100000	100-100000	100-100000

100-100000

ALL INFORMATION CONTAINED HEREIN IS UNCLASSIFIED

DATE 10/1/80 BY [Illegible]

100-100000