

N MEXICO OIL CONSERVATION COMMISSION
Santa Fe, New Mexico

NOTICE OF INTENTION TO DRILL

Notice must be given to the Oil Conservation Commission or its proper agent and approval obtained before drilling begins. If changes in the proposed plan are considered advisable, a copy of this notice showing such changes will be returned to the sender. Submit this notice in triplicate. One copy will be returned following approval. See additional instructions in Rules and Regulations of the Commission.

Tulsa, Oklahoma.

November 6th, 1936

Place

Date

OIL CONSERVATION COMMISSION,
Santa Fe, New Mexico.

Gentlemen:

You are hereby notified that it is our intention to commence the drilling of a well to be known as

Gulf Oil Corporation

Orcutt C

Well No. **8** in **Lot 7**

of Sec. **6**, T. **21S**, R. **36E**, N. M. P. M., **Eunice** Field, **Lea** County.

N.

The well is _____ feet (N.) (S.) of the _____ line and _____ feet

(E.) (W.) of the _____ line of **Center of Lot 7**

(Give location from section or other legal subdivision lines. Cross out wrong directions.)

If state land the oil and gas lease is No. **B-244**. Assignment No. _____

If patented land the owner is _____

Address _____

If government land the permittee is _____

Address _____

The lessee is **Gulf Oil Corporation**

Address **Tulsa, Oklahoma.**

We propose to drill well with drilling equipment as follows: **Rotary Tools**

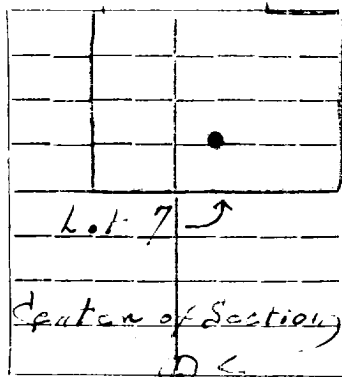

AREA 640 ACRES
LOCATE WELL CORRECTLY

The status of a bond for this well in conformance with Rule 39 of the General Rules and Regulations of the Commission is as follows: _____

We propose to use the following strings of casing and to land or cement them as indicated:

Size of Hole	Size of Casing	Weight Per Foot	New or Second Hand	Depth	Landed or Cemented	Sacks Cement
13-5/4	10-5/4	32.75	New	300'	Cemented	250
9-7/8	7-5/8	22	New	1200'	"	325
6-5/4	5-1/2	17	New	3735'	"	300

If changes in the above plan become advisable we will notify you before cementing or landing casing. We estimate that the first productive oil or gas sand should occur at a depth of about **3735** feet.

Additional information: _____

Approved _____, 19____
except as follows: _____

Sincerely yours,

Gulf Oil Corporation

Company or Operator

By *S. G. Sanderson*

Position **General Superintendent**

Send communication regarding well to

Name **S. G. Sanderson**

Address **Tulsa, Oklahoma.**

OIL CONSERVATION COMMISSION,

By *F. J. Cady*

Title _____

NR