

Submit to Appropriate  
District Office  
State Leases - 4 copies  
Fee Leases - 3 copies

State of New Mexico  
Energy, Minerals and Natural Resources Department

Form C-102  
Revised 1-1-89

OIL CONSERVATION DIVISION

P.O. Box 2088  
Santa Fe, New Mexico 87504-2088

DISTRICT I  
P.O. Box 1980, Hobbs, NM 88240

DISTRICT II  
P.O. Drawer DD, Artesia, NM 88210

DISTRICT III  
1000 Rio Brazos Rd., Aztec, NM 87410

WELL LOCATION AND ACREAGE DEDICATION PLAT

All Distances must be from the outer boundaries of the section

Operator DOYLE HARTMAN			Lease STATE "A" COM		Well No. 4
Unit Letter A	Section 8	Township 21 South	Range 36 East	County Lea	
Actual Footage Location of Well: 660 feet from the North line and 660 feet from the East line					
Ground level Elev. 3578	Producing Formation Yates-7R-Qn-Penrose		Pool Eumont (Y-7R QN) Pro Gas		Dedicated Acreage: 280 Acres

- Outline the acreage dedicated to the subject well by colored pencil or hatchure marks on the plat below.
- If more than one lease is dedicated to the well, outline each and identify the ownership thereof (both as to working interest and royalty).  
See Attached
- If more than one lease of different ownership is dedicated to the well, have the interest of all owners been consolidated by communitization, unitization, force-pooling, etc.?  
☒ Yes ☐ No If answer is "yes" type of consolidation Force Pooling Order R-9332  
If answer is "no" list the owners and tract descriptions which have actually been consolidated. (Use reverse side of this form if necessary).  
No allowable will be assigned to the well until all interests have been consolidated (by communitization, unitization, forced-pooling, or otherwise) or until a non-standard unit, eliminating such interest, has been approved by the Division.

OPERATOR CERTIFICATION

I hereby certify that the information contained herein is true and complete to the best of my knowledge and belief.

Signature  
Printed Name  
Michael Stewart  
Position  
Engineer  
Company  
Doyle Hartman  
Date  
March 27, 1991

SURVEYOR CERTIFICATION

I hereby certify that the well location shown on this plat was plotted from field notes of actual surveys made by me or under my supervision, and that the same is true and correct to the best of my knowledge and belief.

Date Surveyed  
June 4, 1990  
Signature & Seal of Professional Surveyor  
Certificate No. JOHN W. WEST, 676  
RONALD J. EIDSON, 3239

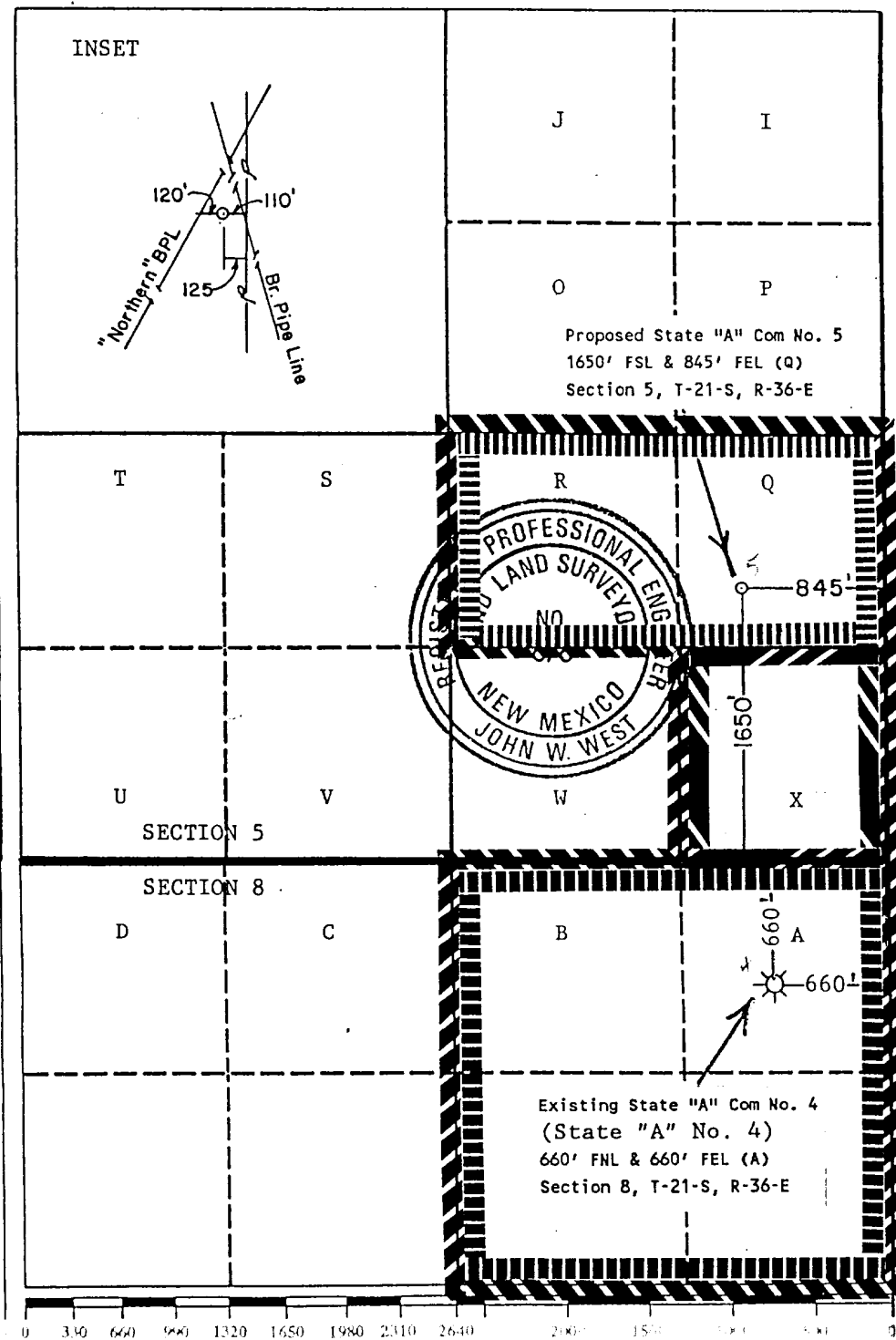

STATE "A" COM  
TRACT OWNERSHIP  
NMOCD ORDER R-9332

NE/4 SE/4 and SE/4 SE/4 Section 5; NE/4 Section 8 all  
in Township 21 South, Range 36 East, NMPM, Lea County,  
New Mexico

Operator of the Communitized Area: Doyle Hartman

DESCRIPTION OF LEASES COMMITTED

Tract No. 1

Lease Serial No.: B-2456  
Lease Date: 1-24-34  
Lease Term: 5 years and as long thereafter as oil or gas  
is produced  
Lessor: State of New Mexico  
Original Lessee: Stephen Chandler  
Present Ownership of  
Operating Rights: Doyle Hartman - 87.5%  
James A. Davidson - 12.5%  
100.0%  
Description of Land  
Committed: N/2 SE/4 Section 5, T-21-S, R-36-E, NMPM,  
Lea County, New Mexico from surface down to  
the base of Eumont Gas Pool interval  
Number of Acres: 80.00  
Royalty Rate: 12.50%

Tract No. 2

Lease Serial No.: B-1673  
Lease Date: 1-30-33  
Lease Term: 5 years and as long thereafter as oil or gas  
is produced  
Lessor: State of New Mexico  
Original Lessee: Atlantic Oil Producing Company  
Present Ownership of  
Operating Rights: Doyle Hartman 100%  
Description of Land  
Committed: SE/4 SE/4 Section 5, T-21-S, R-36-E, NMPM,  
Lea County, New Mexico from surface to the  
base of the Eumont Gas Pool interval  
Number of Acres: 40.00

Tract No. 3

Lease Serial No.: A-1350

Lease Date: 11-26-28

Lease Term: 5 years and as long thereafter as oil or gas  
is produced

Lessor: State of New Mexico

Original Lessee: Devonian Oil Company

Present Lessee: Doyle Hartman 87.50%  
James A. Davidson 12.50%  
100.00%

Description of Land  
Committed: NE/4 Section 8, T-21-S, R-36-E, NMPM,  
Lea County, New Mexico from the surface  
down to the base of the Eumont Gas Pool  
interval

Number of Acres: 160.00

Royalty Rate: 12.50%