

Submit to Appropriate  
District Office  
State Lease - 4 copies  
Fee Lease - 3 copies

State of New Mexico  
Energy, Minerals and Natural Resources Department

Form C-102  
Revised 1-1-89

OIL CONSERVATION DIVISION

DISTRICT I  
P.O. Box 1980, Hobbs, NM 88240

P.O. Box 2088  
Santa Fe, New Mexico 87504-2088

DISTRICT II  
P.O. Drawer DD, Artesia, NM 88210

DISTRICT III  
1000 Rio Brazos Rd., Aztec, NM 87410

WELL LOCATION AND ACREAGE DEDICATION PLAT

All Distances must be from the outer boundaries of the section

Operator ARCO OIL AND GAS COMPANY			Lease STATE 176		Well No. #4
Unit Letter G	Section 19	Township 21S	Range 36E	County NMPM	LEA
Actual Footage Location of Well: 1650 feet from the NORTH line and 2310 feet from the WEST line					
Ground level Elev. 3645'	Producing Formation YATES/7-RIVERS/QUEEN			Pool EUMONT	Dedicated Acreage: 275 Acres

1. Outline the acreage dedicated to the subject well by colored pencil or hatchure marks on the plat below.
2. If more than one lease is dedicated to the well, outline each and identify the ownership thereof (both as to working interest and royalty).
3. If more than one lease of different ownership is dedicated to the well, have the interest of all owners been consolidated by communitization, unitization, force-pooling, etc?  
☐ Yes ☐ No If answer is "yes" type of consolidation \_\_\_\_\_  
If answer is "no" list the owners and tract descriptions which have actually been consolidated. (Use reverse side of this form if necessary.) \_\_\_\_\_  
No allowable will be assigned to the well until all interests have been consolidated (by communitization, unitization, forced-pooling, or otherwise) or until a non-standard unit, eliminating such interest, has been approved by the Division.

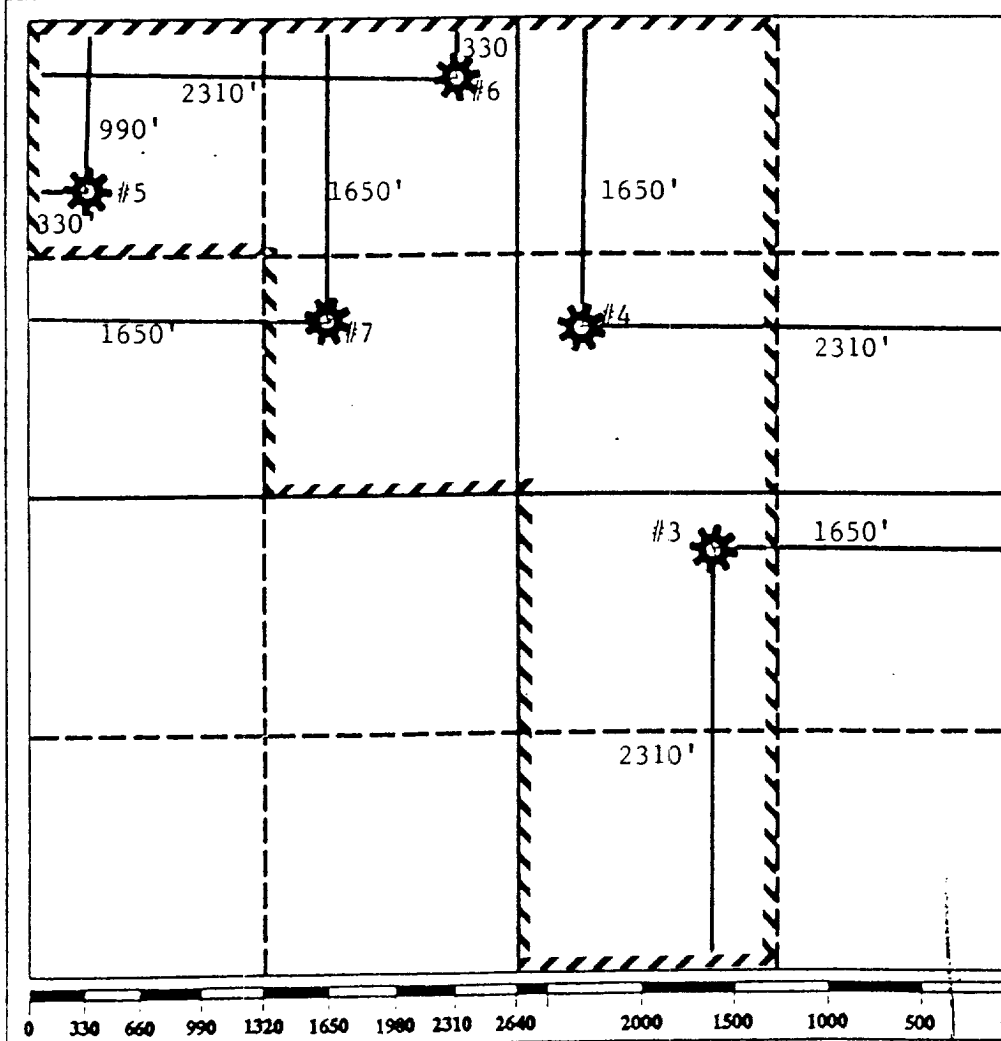

OPERATOR CERTIFICATION

I hereby certify that the information contained herein is true and complete to the best of my knowledge and belief.

Signature  
*Evelyn E. Gilson*  
Printed Name  
EVELYN E. GILSON  
Position  
ENGINEERING TECHNICIAN  
Company  
ARCO OIL AND GAS COMPANY  
Date  
JUNE 14, 1993

SURVEYOR CERTIFICATION

I hereby certify that the well location shown on this plat was plotted from field notes of actual surveys made by me or under my supervision, and that the same is true and correct to the best of my knowledge and belief.

Date Surveyed

Signature & Seal of  
Professional Surveyor

Certificate No.

NSL-3281(SD)

**NEW MEXICO OIL CONSERVATION COMMISSION  
WELL LOCATION AND ACREAGE DEDICATION PLAT**

Form C-102  
Supersedes C-128  
Effective 1-1-65

All distances must be from the outer boundaries of the Section.

Operator <b>Atlantic Richfield Company</b>			Lease <b>State 176</b>		Well No. <b>4</b>
Unit Letter <b>G</b>	Section <b>19</b>	Township <b>21S</b>	Range <b>36E</b>	County <b>Lea</b>	
Actual Footage Location of Well:					
<b>1650</b>		feet from the <b>North</b>	line and	<b>2310</b>	feet from the <b>East</b> line
Ground Level Elev: <b>3645'</b>	Producing Formation <b>Queen Gas</b>		Pool <b>Eumont</b>		Dedicated Acreage: <b>275</b> Acres

1. Outline the acreage dedicated to the subject well by colored pencil or hachure marks on the plat below.
2. If more than one lease is dedicated to the well, outline each and identify the ownership thereof (both as to working interest and royalty).
3. If more than one lease of different ownership is dedicated to the well, have the interests of all owners been consolidated by communitization, unitization, force-pooling, etc?

☐ Yes    ☐ No    If answer is "yes," type of consolidation \_\_\_\_\_

If answer is "no," list the owners and tract descriptions which have actually been consolidated. (Use reverse side of this form if necessary.) \_\_\_\_\_

No allowable will be assigned to the well until all interests have been consolidated (by communitization, unitization, forced-pooling, or otherwise) or until a non-standard unit, eliminating such interests, has been approved by the Commission.

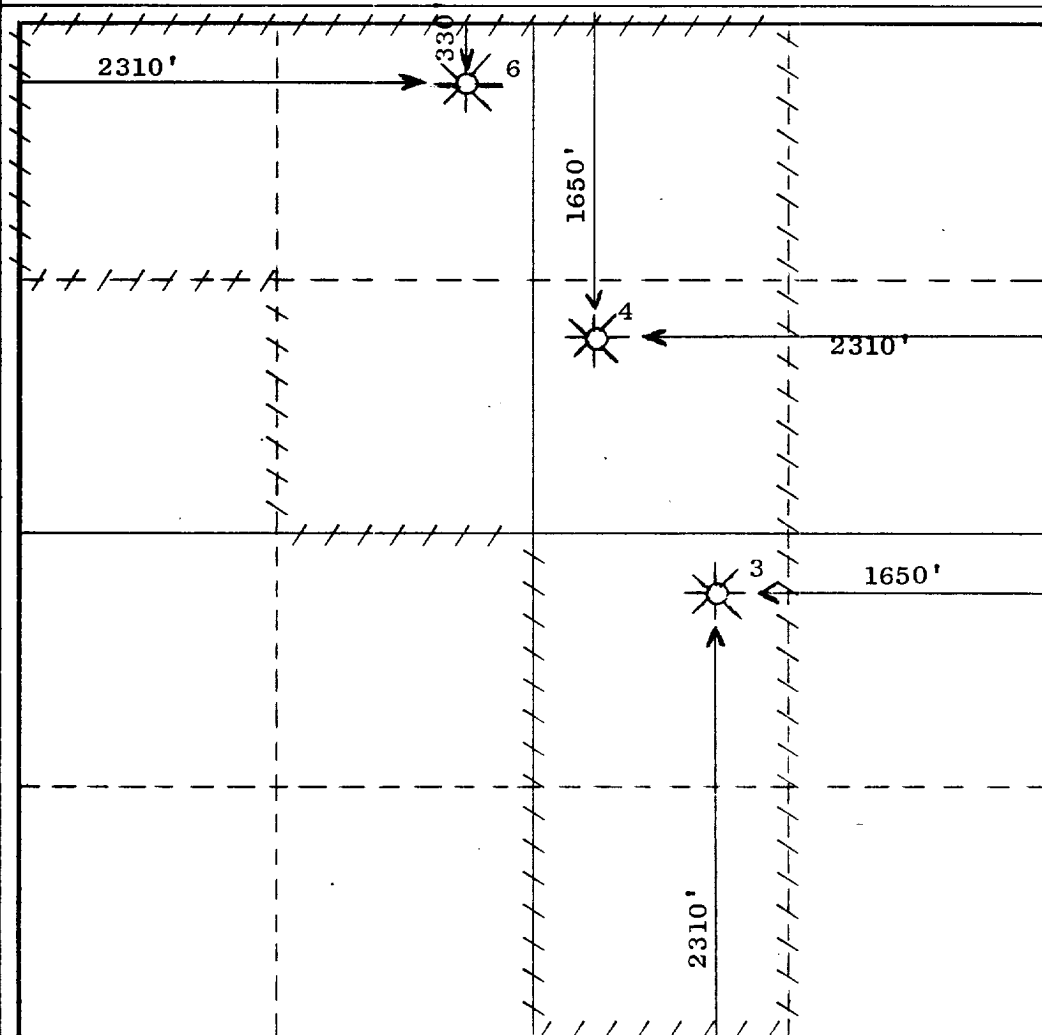

**CERTIFICATION**

*I hereby certify that the information contained herein is true and complete to the best of my knowledge and belief.*

Name \_\_\_\_\_  
Position \_\_\_\_\_  
Dist. Drlg. Supt.  
Company  
**Atlantic Richfield Company**  
Date  
**6/29/77**

*I hereby certify that the well location shown on this plat was plotted from field notes of actual surveys made by me or under my supervision, and that the same is true and correct to the best of my knowledge and belief.*

Date Surveyed \_\_\_\_\_

Registered Professional Engineer  
and/or Land Surveyor

Certificate No. \_\_\_\_\_

0 330 660 990 1320 1650 1980 2310 2640 2000 1500 1000 500 0

10/15/1977  
OIL CONSERVATION COMM.  
HOBBS, N. M.