

NEW MEXICO OIL CONSERVATION COMMISSION
Well Location and Acreage Dedication Plat

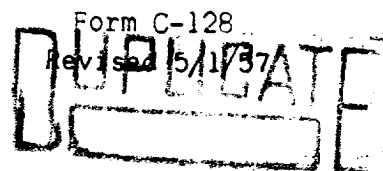

Section A.

Date July 3, 1958

Operator Gulf Oil Corp. Lease Harry Leonard NCT-A
Well No. 8 Unit Letter N Section 22 Township 21 South Range 36 East NMPM
Located 1980 Feet From East Line, 660 Feet From South Line
County Lea G. L. Elevation 3569.85 Dedicated Acreage 40 Acres
Name of Producing Formation Queen Pool Sumont Gas

1. Is the Operator the only owner* in the dedicated acreage outlined on the plat below?
Yes X No .
2. If the answer to question one is "no," have the interests of all the owners been consolidated by communitization agreement or otherwise? Yes No . If answer is "yes," Type of Consolidation
3. If the answer to question two is "no," list all the owners and their respective interests below:

Owner

Land Description

<u>Owner</u>	<u>Land Description</u>

Section B

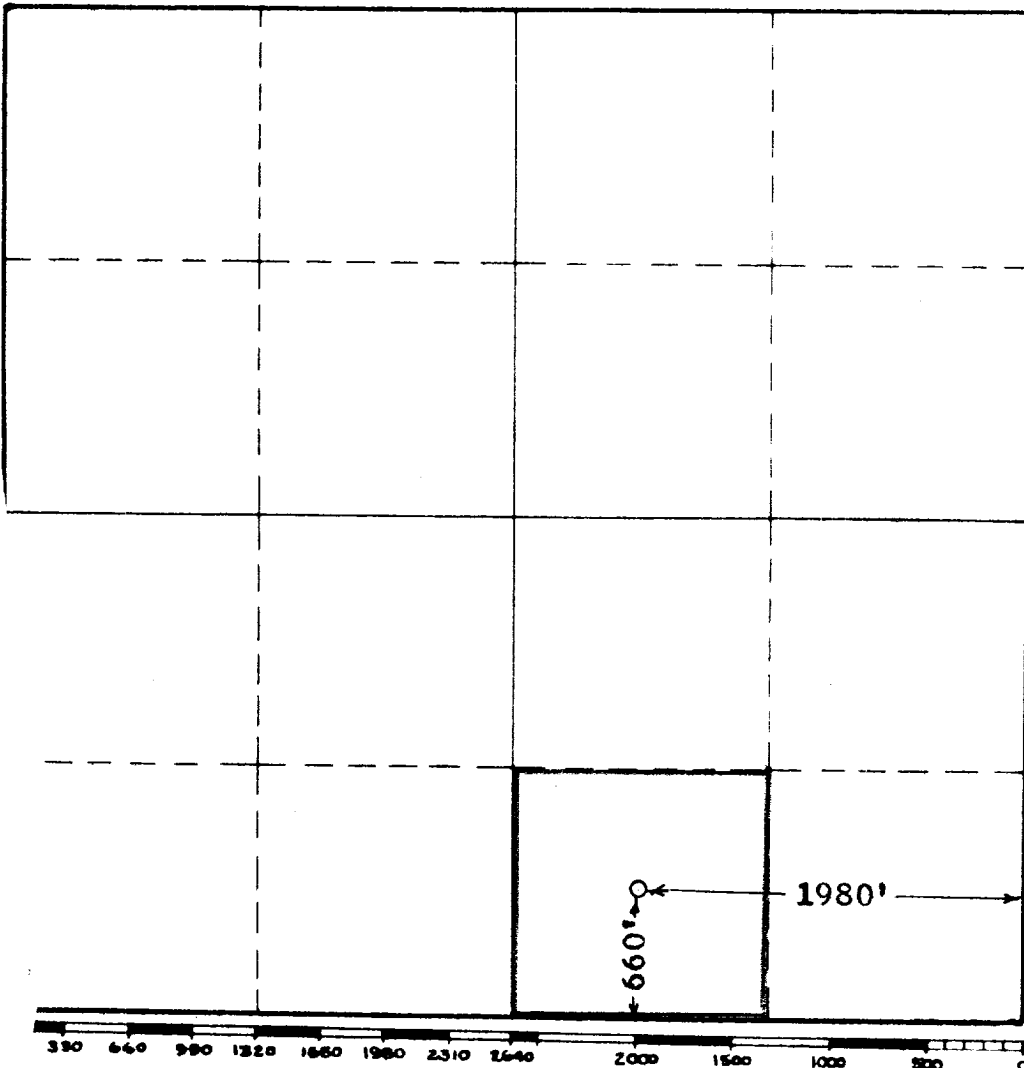

This is to certify that the information in Section A above is true and complete to the best of my knowledge and belief.

Gulf Oil Corporation

(Operator)

C. F. Taylor
(Representative)

Area Production Supt.

Box 2167 - Hobbs, New Mexico

Address

This is to certify that the well location shown on the plat in Section B was plotted from field notes of actual surveys made by me or under my supervision and that the same is true and correct to the best of my knowledge and belief.

Date Surveyed July 2, 1958

John W. West
Registered Professional
Engineer and/or Land Surveyor.

Certificate No. 676

(See instructions for completing this form on the reverse side)