

Revised 5/1/57

NEW MEXICO OIL CONSERVATION COMMISSION

Well Location and Acreage Dedication Plat

Section A.

Date

NOV 18 1957
HOBBS OFFICE OCC

Operator HUMBLE OIL & REFG. CO Lease New Mexico State "G" AM 10:36
 Well No. 9 Unit Letter "G" Section 23 Township 21-S Range 36-E T.M.P.M.
 Located 1980' Feet From North Line, 1980 Feet From East Line
 County Lea G. L. Elevation _____ Dedicated Acreage 40 Acres
 Name of Producing Formation Queen Pool Eumont

1. Is the Operator the only owner* in the dedicated acreage outlined on the plat below?
 Yes ☒ No ☐.
2. If the answer to question one is "no," have the interests of all the owners been consolidated by communitization agreement or otherwise? Yes ☐ No ☐. If answer is "yes," Type of Consolidation _____
3. If the answer to question two is "no," list all the owners and their respective interests below:

OwnerLand Description

Section B

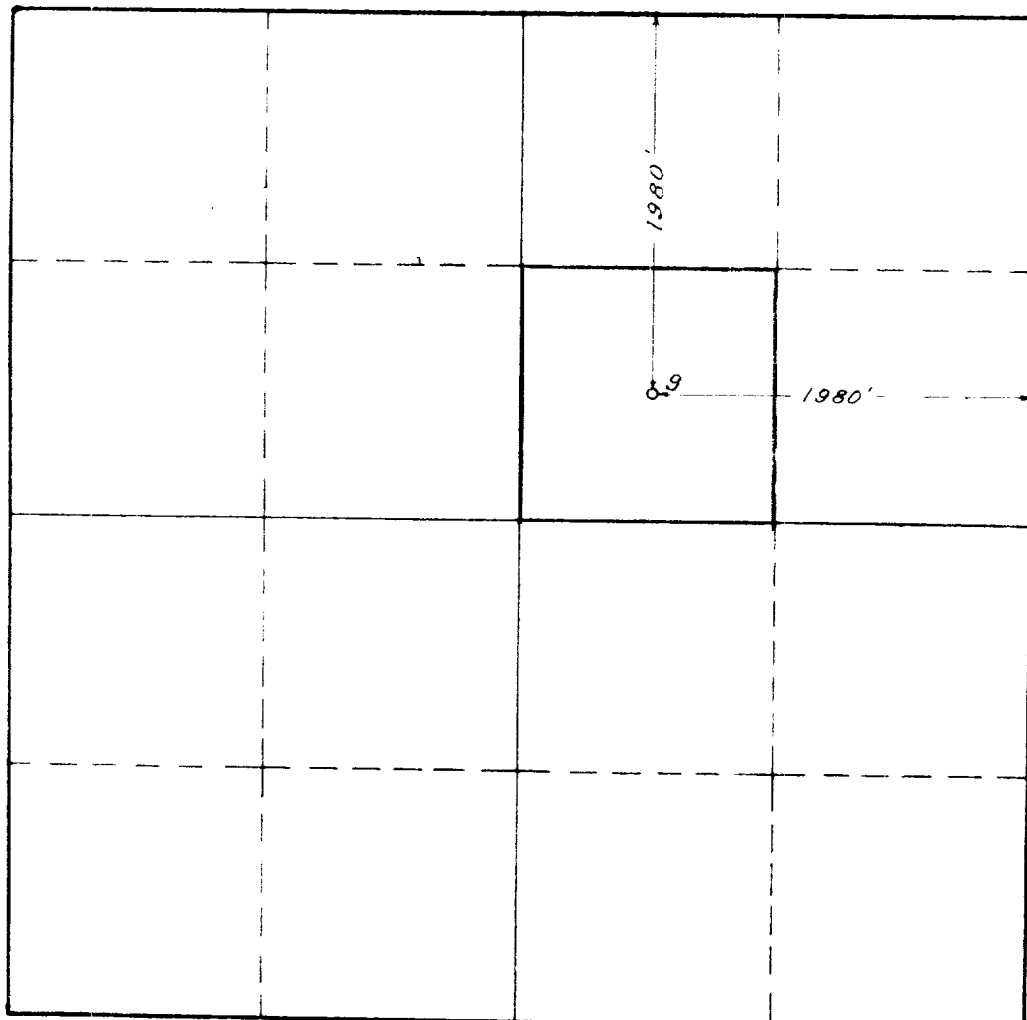

This is to certify that the information in Section A above is true and complete to the best of my knowledge and belief.

HUMBLE OIL & REFG. CO

(Operator)

Henry J. Madson
 (Representative)
 Assistant Division Supt.
 Box 1600 Midland, Texas
 Address

This is to certify that the well location shown on the plat in Section B was plotted from field notes of actual surveys made by me or under my supervision and that the same is true and correct to the best of my knowledge and belief.

Date Surveyed 11-14-57

E. T. Mahan
 Registered Professional
 Engineer and/or Land Surveyor.

Certificate No. 1513

LEASE NO. 37722

W.L.A. - 2424